

NOTES:

- 1) All bearings are based on Arkansas North State Plane Coordinate system.  
2) The research completed for this survey includes:  
ALTA/ACSM Land Title Survey portion of NW 1/4 of the SW 1/4 of section 28, T14N, R4E, Jonesboro, AR.  
dated 11-27-12 prepared by Associated Engineering & Testing, LLC.  
3) All corner monuments set are 1/2 cedar, unless otherwise noted on the plat.  
4) Corner monuments set by Associated Engineering & Testing, LLC.  
5) Flood Plain: This tract does not lie within the 100-yr Flood Plain per Flood Insurance rate map of Craighead Co., AR, and incorporated areas, Community Panel No. 0803 (C0132 C, dated 09-27-91 (revised 06-25-07).  
This tract does lie within a Zone "X" Flood Plain, per the map referenced above.  
6) Current Zoning: C-2 (25' front setback, 10' side setback, 20' rear setback)

LEGEND

These standard symbols will be found in the drawing.

- TELEPHONE BOX
- ELECTRIC TRANSFORMER
- TRAFFIC SIGNAL BOX
- ELECTRIC BOX
- TRAFFIC SIGNAL POLE
- POWER POLE
- TELEPHONE MARKER
- TELEPHONE MANHOLE
- TELEPHONE PEDESTAL
- EXISTING SEWER MANHOLE
- PROPOSED SEWER MANHOLE
- COY WIRE
- LIGHT POLE
- WOOD FENCE

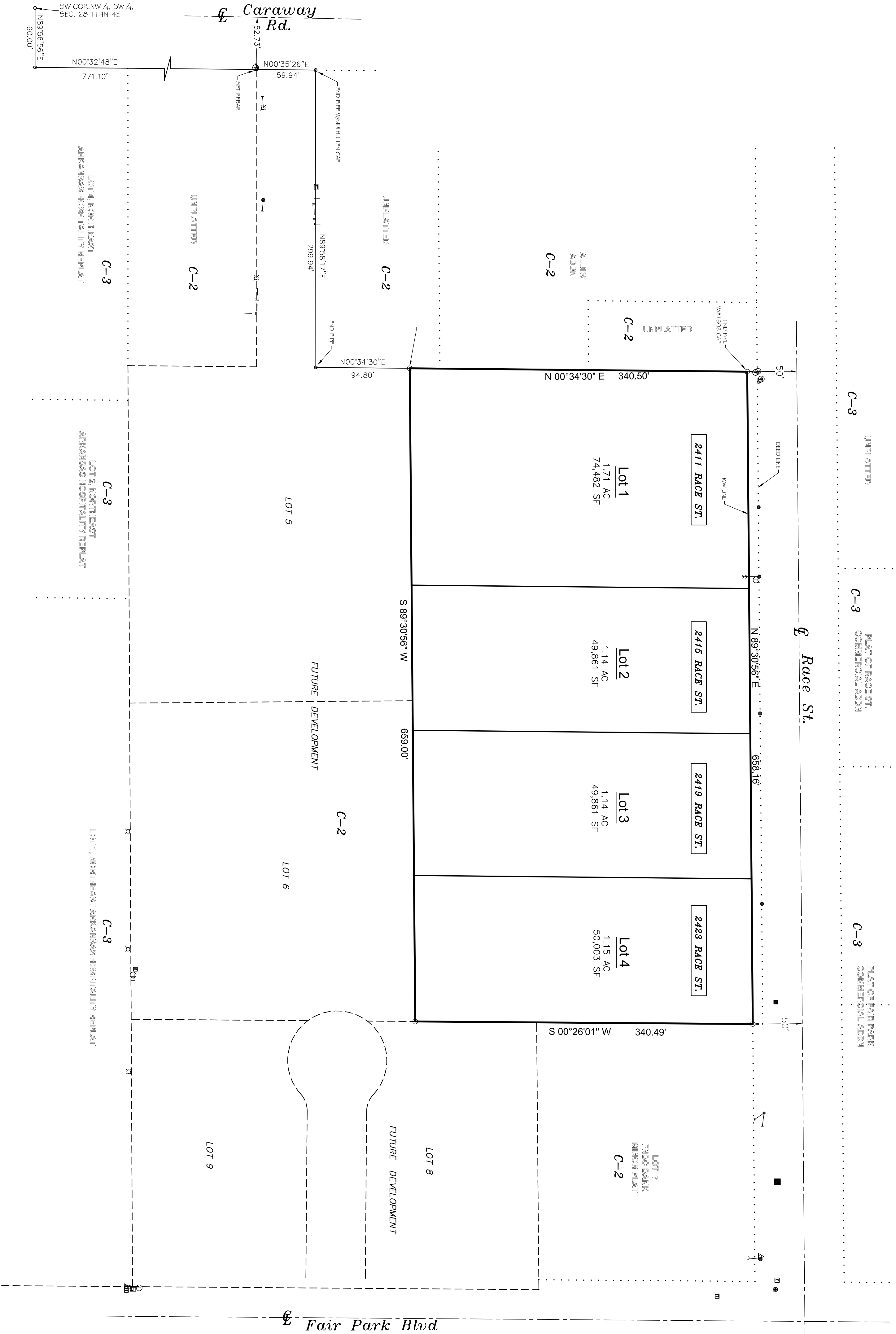

FAIR PARK CROSSING - PHASE ONE  
JONESBORO, ARKANSAS

CERTIFICATE OF OWNERSHIP:

We hereby certify that we are the owners of the property shown and described hereon, that we adopt the plan of subdivision and dedicate perpetual use of all streets and easements as noted.

Prateek Gera (Fair Park Crossing, LLC)

CERTIFICATE OF SURVEY:

To all parties interested in this to these premises: I hereby certify that I have prior to this day made a survey of the above described property as shown on the Plat of Survey hereon. The property lines and corner monuments, to the best of my knowledge and ability, are correctly established. The improvements are as shown on the Plat of Survey. Encroachments, if any, as disclosed by Survey, are shown hereon.

LEGAL DESCRIPTION:

A part of the Northwest Quarter of the Southwest Quarter of Section 28, Township 14, North, Range 4, East, Craighead County, Arkansas being more particularly described as follows:  
From the Southwest corner of said Northwest Quarter of the Southwest Quarter, run N89°56'56"E a distance of 60.00 ft. to a point;  
thence N00°32'48"E a distance of 771.10 ft. to a point;  
thence N00°35'26"E a distance of 59.94 ft. to a point;  
thence N89°58'17"E a distance of 299.94 ft. to a point;  
thence N00°34'30"E a distance of 94.80 ft. to the POINT-OF-BEGINNING;  
thence continue N00°34'30"E a distance of 340.50 ft. to a point;  
thence S00°26'01"W a distance of 340.49 ft. to a point;  
thence S89°30'56"W a distance of 659.00 ft. to the point of beginning, containing 5.15 acres, and being subject to all easements of record.

ENGINEERS	PLANNERS	SURVEYORS
Civilogic		
203 Southwest Dr.-Jonesboro, AR-(870)932-7880-www.civilogic.net		

Date 11-12-19	Scale 1"=60'	Job No. 118111	Sheet No.
Section 28	Township 14N	Range 04E	County CRAIGHEAD
Drawn By: RE		Checked by: GH	1 of 1
ONLY COPIES WITH VIOLET COLORED SIGNATURE ARE ORIGINAL CIVILOGIC COPIES			
© 2019, Civilogic			

RECORD PLAT  
FAIR PARK CROSSING - PHASE ONE  
JONESBORO, ARKANSAS  
FOR  
FAIR PARK CROSSING, LLC

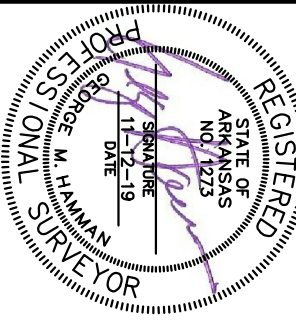
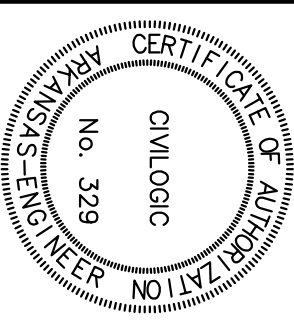

JOB NO.: 118111  
SHEET NUMBER

1 of 1

VICINITY MAP  
Scale: 1"=2000 ft.