

Overman Buildings, Inc.  
1100 Pace Road  
Pocahontas, AR 72455

05/02/2019

SALE

Total: \$2,940.00

Visa

xxxxxxxxxxxx7998

Exp. Date: xx / xx  
Entry Mode: Keyed  
Name: SEXTON, STEPHEN G

Auth. Code: 02753C  
Trans. ID: PK0219056412  
Terminal ID: -

QuickBooks Trans. No:  
Merchant No.: 5247710003904489  
AID

Thank you for your business

CUSTOMER COPY

\*Approximate 6 1/2' clearance in center of vault

## OVERMAN BUILDINGS

### SHOP/CABIN/HOUSE CONTRACT

1100 PACE ROAD, POCAHONTAS, AR 72455

870-609-1900

NAME Steve Sexton SIZE 24X24X14 DATE 5/2/19  
PHONE 870-273-5456 EMAIL \_\_\_\_\_  
LOCATION OF CONSTRUCTION 2612 Gallaway Lane, Jonesboro, AR IN CITY LIMITS? Y  
WHAT COUNTY? Craighead MAILING ADDRESS same 72404  
Foundation: DIRT WOOD SLAB UPGRADED SLAB STEM WALL/SLAB WE POUR? Y (N)  
WINDOW SIZE AND NUMBER 4-3x5 Vinyl  
DOOR SIZE AND NUMBER 1-3' house door; 1-9x7 manual lift insulated  
GARAGE DOOR COLOR CHOICE: BROWN CLAY WICKER ALMOND WHITE WHITE  
ADDITIONAL COMMENTS 24x24 wood floor with posts down the center  
over a customer provided slab to provide a second story;  
studs @ 16"; trusses @ 2'; all vaulted trusses except end trusses; house  
wrap vapor barrier; customer to provide concrete slab, no stairs - customer  
will build later  
WALL COLOR \_\_\_\_\_ ROOF COLOR \_\_\_\_\_ TRIM COLOR \_\_\_\_\_  
BASE PRICE 7,550  
DOORS —  
WINDOWS 680  
INTERIOR FRAMING —  
INSULATION —  
SOFFIT/FASCIA —  
PORCH —  
CONCRETE/FOUNDATION —  
ROOF EXTENSION —  
EXCAVATION (DIRT WORK) —  
HOUSE WRAP 650  
STUDS AT 16" 700  
TRUSSES AT 2' 480  
OTHER 24x24 wood floor 3,750  
OTHER posts for floor support 500  
OTHER insulated door 100  
OTHER vaulted trusses 330  
TOTAL 14,740

PAYMENT AGREEMENT  
TOTAL PRICE 14,740  
MINIMUM 20% DEPOSIT - 2,940  
PAYMENT METHOD CC  
BALANCE DUE 11,800  
REQUIRED? Y (N) 20% DUE WHEN  
FOUNDATION IS COMPLETED - —  
BALANCE DUE —  
REQUIRED? Y (N) 20% DUE WHEN  
FRAMING IS COMPLETED - —  
BALANCE DUE UPON COMPLETION  
OF CONSTRUCTION 11,800  
ESTIMATED TIME TO CONSTRUCTION:  
12-14 weeks from deposit

\*\*PRICES LISTED INCLUDE A 3% DISCOUNT FOR CASH/CHECK PAYMENTS. CREDIT CARD CUSTOMERS WILL BE CHARGED FULL PRICE.

I have reviewed the information listed above and understand that the building I am ordering will be constructed based on that information. I understand that the deposit money will not be refunded if I refuse the building or cancel my order. I understand and agree to the payment terms listed above and agree to pay the balance due in full upon completion of construction.

Signed [Signature] Date 5/2/19

Overman Buildings Representative Kenny Weigman



# OVERMAN BUILDINGS

1100 PACE ROAD, POCAHONTAS, AR 72455  
870-609-1900

## DOOR AND WINDOW CONSTRUCTION DIAGRAM

NAME Steve Sexton SIZE 24x24x14 DATE 5/2/19

PHONE 870-273-5456

LOCATION OF CONSTRUCTION 2612 Gallaway Lane, Jonesboro, AR

PLEASE INDICATE SIZE OF BUILDING, LOCATION AND SIZE OF GARAGE DOORS, WINDOWS, AND WALK DOORS ON THE DIAGRAM LOCATED BELOW.

MARK LOCATIONS USING DISTANCE FROM CORNERS (EXAMPLE-4' FROM CORNER), OR CENTER OF WALL, ETC.

PLEASE MARK LOCATION OF ANY LEAN TO, ROOF EXTENSION OR PORCH. USE AVAILABLE SPACE TO MAKE ANY NOTES NECESSARY. PLEASE MARK LOCATION OF SURROUNDING STRUCTURES, DRIVEWAYS, OR ROADS.

E

24

S

24

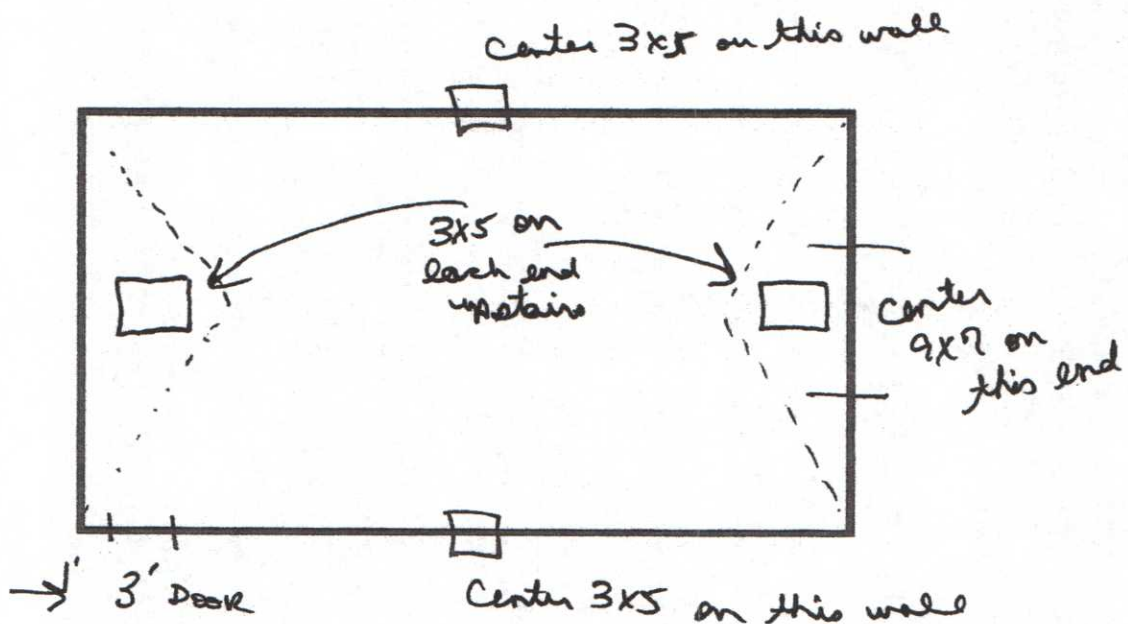

W

I HAVE REVIEWED THE INFORMATION ABOVE AND UNDERSTAND THAT THE BUILDING I AM ORDERING WILL BE CONSTRUCTED BASED ON THIS INFORMATION.

Signed [Signature] Date 5/2/19

On Behalf Of Overman Buildings Kenny Waymon