

C/L MATTHEWS AVE

R-2

LEGEND

These standard symbols will be found in the drawing.

- FOUND CORNER AS NOTED
- SET 1/2" REBAR W/ CAP
- ⊙ FD COTTON PICKER SPINDLE
- ⊕ HIGHWAY RIGHT OF WAY MARKER
- ⊙ FOUND REBAR
- △ CALCULATED CORNER
- FENCE LINE
- ELECTRIC
- ⊙ SET PK NAIL
- ⊕ POWER POLE

PROPERTY ZONED R-2
25' FRONT BUILDING S/B
20' REAR BUILDING S/B
7.5' SIDEYARD SETBACK

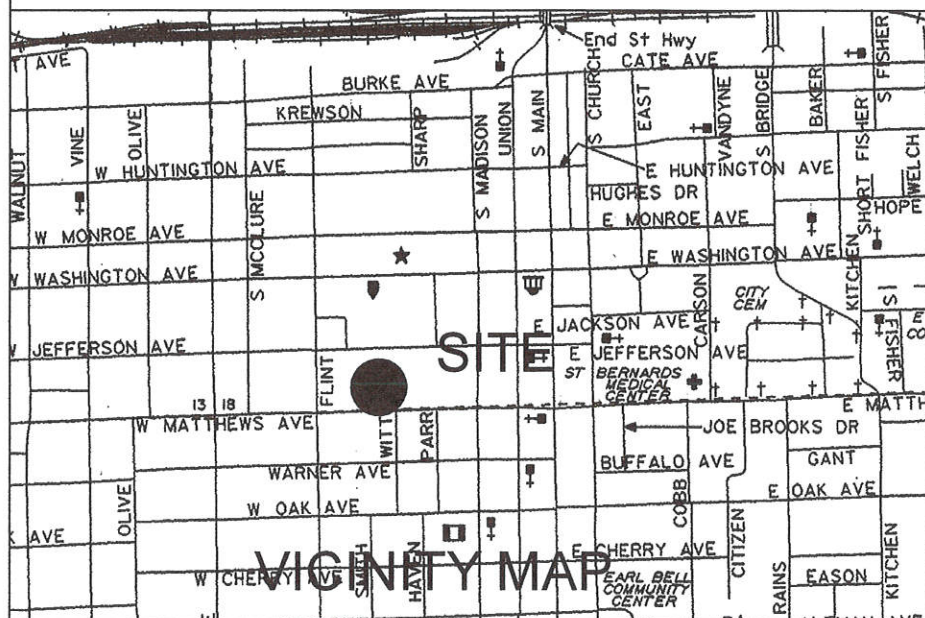

REVISED 6/24/2019- ADDED FLOOD DATA

DESCRIPTION:

A REPLAT OF THE WEST HALF OF LOT 7 IN BLOCK 11 OF FLINT'S ADDITION TO THE CITY OF JONESBORO, ARKANSAS AND LESS AND EXCEPT THE SOUTH 90 FEET OF THE WEST 2.5 FEET THEREOF. AND THE WEST HALF OF THE EAST HALF OF LOT 7 IN BLOCK 11 OF FLINT'S ADDITION TO THE CITY OF JONESBORO, ARKANSAS AS SHOWN BY PLAT IN THE OFFICE OF CIRCUIT CLERK AND EX-OFFICIO RECORDER, CRAIGHEAD COUNTY, ARKANSAS AND BEING MORE PARTICULARLY DESCRIBED AS FOLLOWS:

Beginning at the Northwest corner of aforesaid Lot 7;
thence South 89°56'58" East 112.54 feet; thence South 00°07'17" West 182.41 feet; thence North 89°59'03" West 109.98 feet; thence North 00°07'17" East 90.21 feet; thence South 88°56'21" West 2.56 feet; thence North 00°07'17" East 92.32 feet to the point of beginning proper, having an area of 20302.32 square feet, 0.47 acres more or less and being subject to all public and private roads and easements.

OWNER CERTIFICATION:

WE HEREBY CERTIFY THAT WE THE OWNERS OF THE PROPERTY SHOWN AND DESCRIBED HEREON AND THAT WE ADOPT THE PLAN OF THE SUBDIVISION AND DEDICATED PERPETUAL USE OF ALL STREETS AND EASEMENTS AS NOTED AND WE FURTHER CERTIFY THAT WE HAVE READ AND ACKNOWLEDGED THE FOLLOWING STATEMENT.

[Signature]

[Signature]

SURVEYORS NOTES:

- BEARINGS ARE STATE PLANE GRID BEARINGS(NAD 83 DATUM)AS PER GPS OBSERVATION ON SITE DURING SURVEY AND ARE TO BE USE TO DEFINE THE GENERAL DIRECTION AND TRUE ANGLE AT THE INTERSECTION OF THE PROPERTY AND LAND LINES.
- PROPERTY IS SUBJECT TO UTILITY SERVICES AND UNDERGROUND UTILITY LINES NOT LOCATED.
- REFERENCE DATA: DEED 2018R-004770

SURVEYOR'S CERTIFICATION:

THIS IS TO CERTIFY I HAVE ON THIS DATE SURVEYED THE ABOVE DESCRIBED PROPERTY IN ACCORDANCE WITH MONUMENTS FOUND THIS PLAT CONFORMS TO THAT SURVEYED.

H&S HIME PROFESSIONAL SURVEYING SERVICES
2619 CARAWAY RD. STE. "D"
JONESBORO, ARKANSAS 72401

City of Jonesboro	DATE 6/28/19
FILE # PP19-32	
CITY PLANNER	
CITY ENGINEER	
CITY SURVEYOR	
CITY WATER & LIGHT	

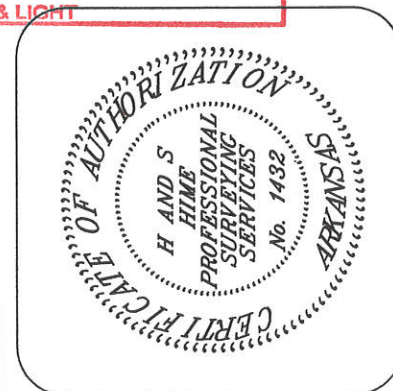
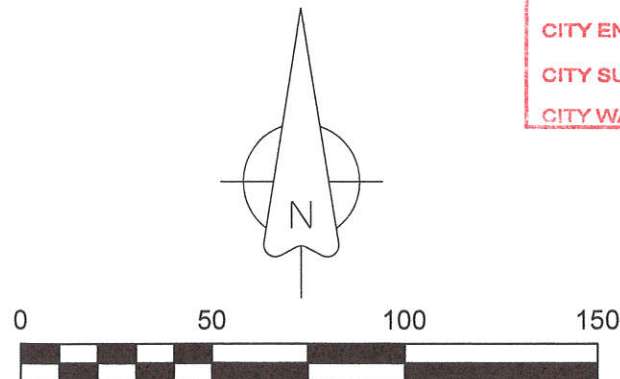

HANNAH CARTER REPLAT	
OF	
A PART OF LOT 7 IN BLOCK 11 OF FLINT'S ADDITION TO THE CITY OF JONESBORO, ARKANSAS	
drawn: H. HIME	date: 6-04-2019
client: HANNAH CARTER	

H&S HIME PROFESSIONAL SURVEYING SERVICES
2619 CARAWAY RD - STE. "D"
JONESBORO, ARKANSAS 72401
PHONE: 870-972-1288
FAX: 870-972-1011
E-MAIL: hshime_butch@yahoo.com