

SURVEYOR'S NOTES:

1. SURVEYOR HAS MADE NO INVESTIGATION OR INDEPENDENT SEARCH FOR EASEMENTS OF RECORD OR ANY OTHER FACTS WHICH AN ACCURATE TITLE SEARCH MAY DISCLOSE.
2. BASIS OF BEARING: RECORD PLAT, SPRING VALLEY SUBDIVISION - 1ST ADDITION, BY TROY L. SHEETS, P.S. 596, RECORDED IN BOOK 179, PAGE 93, DATED APRIL 19, 1973.
3. THE FOLLOWING DOCUMENTS WERE USED IN THE CONSTRUCTION OF THIS SURVEY:
 - RECORD PLAT, SPRING VALLEY SUBDIVISION - 1ST ADDITION, BY TROY L. SHEETS, P.S. 596, RECORDED IN BOOK 179, PAGE 93, DATED APRIL 19, 1973.
4. SUBJECT PROPERTY IS ZONED R-1, SINGLE-FAMILY LOW DENSITY DISTRICT.
5. R-1 ZONING BUILDING SETBACKS:
 - STREET SETBACK: 25'
 - SIDE SETBACK: 7.5'
 - REAR SETBACK: 25'
6. FIELD NOTES ARE RECORDED IN HKB FIELD BOOK 1137, PAGES 46-47.
7. FIELD WORK WAS COMPLETED ON JULY 9, 2012.

CURVE TABLE:

CURVE #	LENGTH	RADIUS	DELTA	CHORD DIRECTION	CHORD LENGTH
C1	26.12'	85.62'	17°28'45"	N09°30'48"E	26.02'

City of **Jonesboro** ARKANSAS DATE **7/10/12** FILE # **RP12-35**

FINAL APPROVAL
 PRELIMINARY (NOT FOR RECORDING)

APPROVED BY: *[Signature]*

PLANNING DEPT
ENGINEERING DEPT

LEGEND:

- FOUND MONUMENT (AS NOTED)
- SET 5/8" REBAR W/ ORANGE PLASTIC CAP STAMPED "M.A. DANIELS P.S. 1563"

CERTIFICATE OF REPLAT:

THIS IS TO CERTIFY THAT HAYWOOD, KENWARD, BARE AND ASSOCIATES INC., PROFESSIONAL LAND SURVEYORS, HAVE REPLATTED THE FOLLOWING PARCEL OF LAND:

LOTS 10 AND 11 OF BLOCK A OF SPRING VALLEY SUBDIVISION, FIRST ADDITION, JONESBORO, CRAIGHEAD COUNTY, ARKANSAS.

SAID REPLAT SHALL BE HERE-IN-AFTER DESIGNATED AND REFERRED TO AS:

HARP'S SPRING VALLEY ADDITION
TO THE CITY OF JONESBORO, CRAIGHEAD COUNTY, ARKANSAS.

WE BEING THE AGENTS DO HEREBY DEDICATE TO THE PUBLIC USE FOREVER, ALL THE STREETS OF WIDTH, LENGTH, AND LOCATION, AS SHOWN ON THE PLAT HEREON, AND SAID AGENTS DO HEREBY DEDICATE ALL EASEMENTS TO THE PUBLIC USE FOR THE EXPRESS PURPOSE INDICATED. SAID EASEMENTS SHALL NOT BE USED FOR INGRESS/EGRESS BY THE PUBLIC.

SIGNED THIS 11th DAY OF July 2012

BY NAME Iris Joan Harp TITLE P.O.A.

SIGNATURE Iris Joan Harp

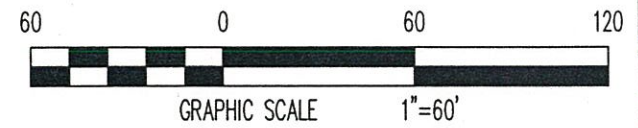

BASIS OF BEARING: RECORD PLAT, SPRING VALLEY SUBDIVISION - 1ST ADDITION, BY TROY L. SHEETS, P.S. 596, RECORDED IN BOOK 179, PAGE 93, DATED APRIL 19, 1973.

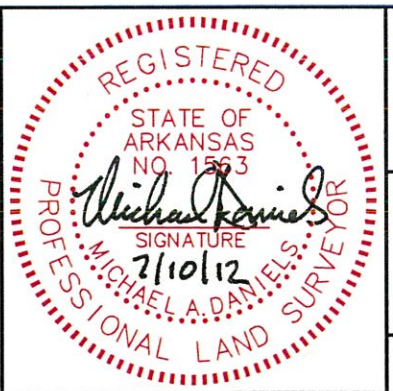
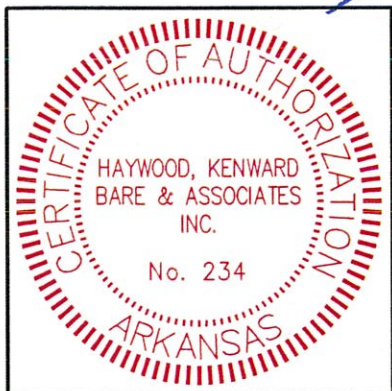

RECORD REPLAT

HARP'S SPRING VALLEY ADDITION
JONESBORO, CRAIGHEAD COUNTY, ARKANSAS

HAYWOOD, KENWARD, BARE & ASSOCIATES, INC.
CIVIL ENGINEERING - SURVEYING - PLANNING
1801 LATOURETTE DRIVE
JONESBORO, ARKANSAS 72404
TEL 870-932-2019 FAX 870-932-1076

REVISIONS		
DATE	BY	DESCRIPTION
SURVEY INDEX CODE 500-14N-03E-0-35-340-16-1563		
PROJECT NO. H057-0001-05		
DRAWN BY JJN	CHECKED BY MAD	
SHEET 1 OF 1	SCALE 1"=60'	
DATE 07/10/12	DRAWING NO. B-216	

COPYRIGHT 2012, ALL RIGHTS RESERVED

CLIENT
HOMER HARP