

**METROPOLITAN AREA PLANNING COMMISSION**

Jonesboro - Craighead County

PRELIMINARY APPROVAL

FINAL APPROVAL

AS NOTED

DISAPPROVED

TABLED

*[Signature]* Chairman  
*[Signature]* Secretary  
 9-14-78 Date

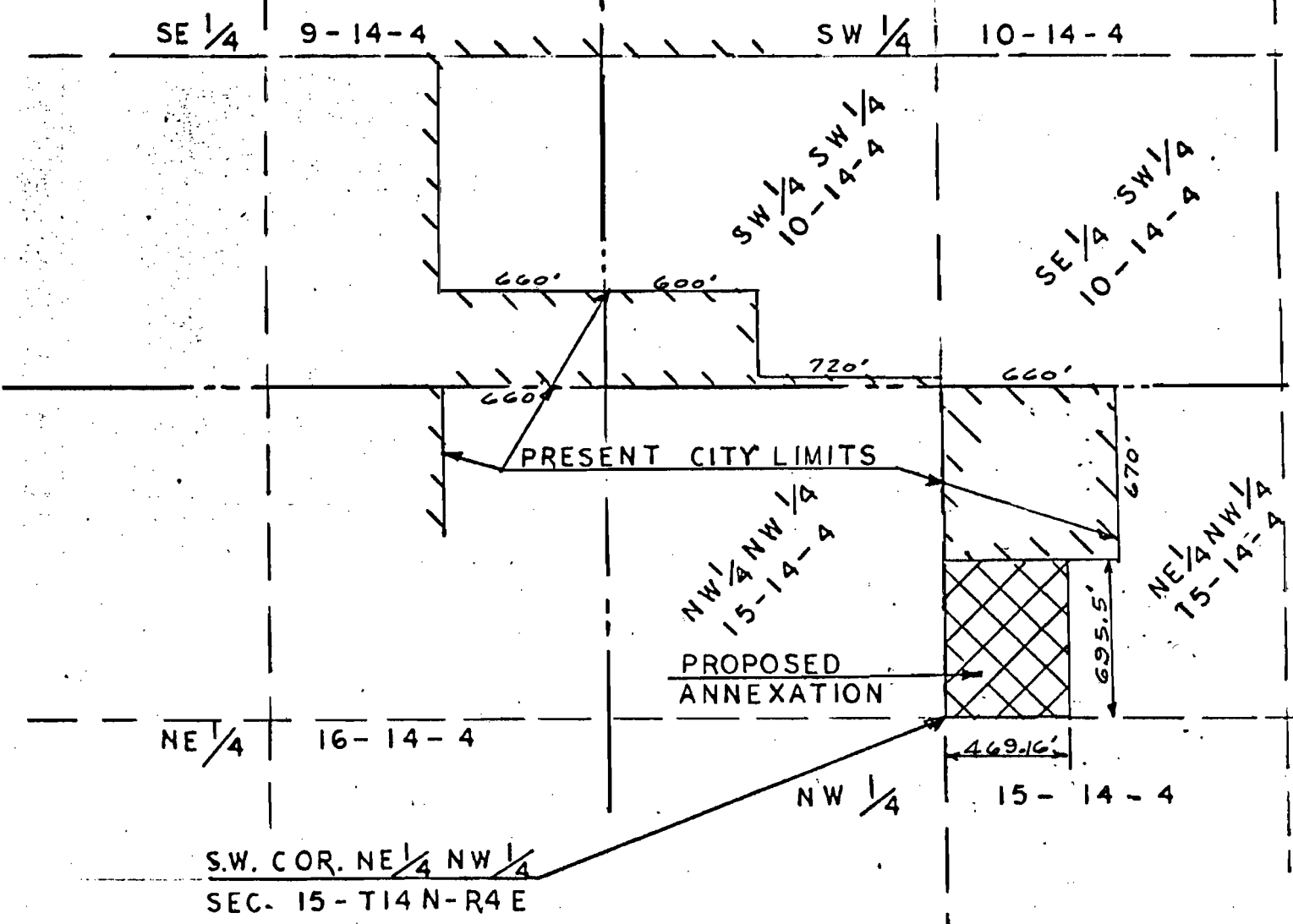

**DESCRIPTION:**

A part of the NE 1/4 of the NW 1/4 of Section 15-Township 14 North-Range 4 East, being more particularly described as follows: Begin at the Southwest Corner of the NE 1/4 NW 1/4 of Section 15 aforesaid; thence North along the 40 acre line 650.0'; thence N89° 11'E 469.16'; thence South 650.0' to the South line of said NE 1/4 NW 1/4; thence S89° 11'W 469.16' along the 40 acre line to the point of beginning, containing 7.00 acres.

**HAYWOOD, KENWARD & ASSOCIATES, INC.**

CIVIL ENGINEERS - SURVEYORS  
 603 SOUTHWEST DRIVE  
 JONESBORO, ARKANSAS 72401

*[Signature]*

PROPOSED ANNEXATION TO CITY OF JONESBORO, ARK.

LOCATION MAP	SCALE 1"=660'	DRAWN BY CLB
DATE 7-5-78	APPROVED BY	DRAWING NUMBER I-124