



ASSUMED

LOT 10, BLK. 1
MEYERS ADD. 1

UN-NAMED TRACT
LATOURETTE PROPERTY

SE COR. LOT 10, BLK. 1
MEYERS ADDITION
JONESBORO, ARKANSAS
P.O.B.

N88°43'53"E
56.00'

DOUBLE BROWN PROPERTY
N88°43'53"E
161.00'

10' ALLEY

N00°05'12"E
10.00'

888°43'53"W
161.00'

S00°05'12"W
10.00'

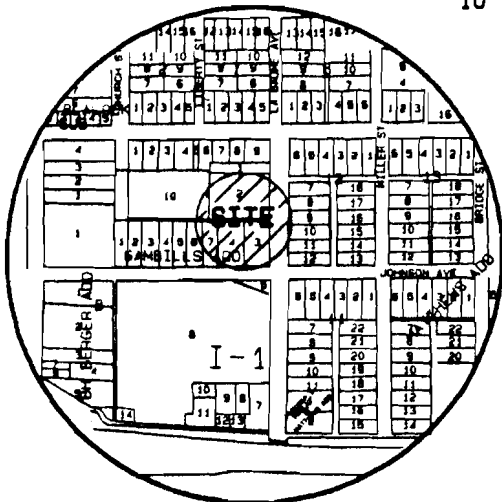

VICINITY MAP
NTS

COBB SURVEY
SW 1/4 NE 1/4
SEC. 18, T14N - R4E

LABAUME ST.

JOHNSON AVE.

LEGAL DESCRIPTION:

THE 10.00' ALLEY LYING NORTH OF LOTS 3 & 4 OF COBB'S SURVEY OF THE SOUTHWEST QUARTER OF THE NORTHEAST QUARTER OF SECTION 18, TOWNSHIP 14 NORTH, RANGE 4 EAST AND LYING SOUTH OF A UN-NAMED TRACT OF LAND AS SHOWN ON THE PLAT OF MEYERS ADDITION TO THE CITY OF JONESBORO ARKANSAS, ALL BEING MORE PARTICULARLY DESCRIBED AS FOLLOWS:

BEGIN AT THE SOUTHEAST CORNER OF LOT 10 OF BLOCK 1 OF MEYERS ADDITION TO JONESBORO ARKANSAS; THENCE N88°43'53"E - 56.00' TO THE POINT OF BEGINNING PROPER; THENCE N88°43'53"E - 161.00'; THENCE S0°05'12"W - 10.00'; THENCE S88°43'53"W - 161.00'; THENCE N0°05'12"E - 10.00' TO THE POINT OF BEGINNING PROPER CONTAINING 1609.55 SQUARE FEET MORE OR LESS

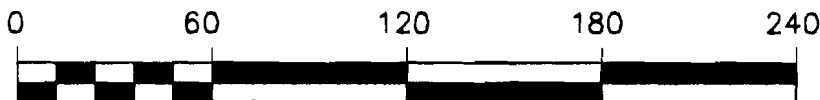

GRAPHIC SCALE 1"=60'

ALLEY ABANDONMENT

THE 10.00' ALLEY LYING NORTH OF LOTS 3 & 4 OF COBB'S SURVEY OF THE SW 1/4 OF THE NE 1/4 OF SEC. 18, T14N, R4E AND LYING SOUTH OF A UN-NAMED TRACT OF LAND AS SHOWN ON THE PLAT OF MEYERS ADDITION TO THE CITY JONESBORO ARKANSAS

HAYWOOD, KENWARD, BARE & ASSOCIATES, INC.

CIVIL ENGINEERING - SURVEYING - PLANNING
3301 E. HIGHLAND DRIVE
JONESBORO, ARKANSAS 72401
TEL 870-932-2018 FAX 870-932-1078

REVISIONS

DATE	BY	DESCRIPTION

DRAWN BY	SHEET
R. MATTHEWS	1 OF 1
DATE	SCALE
03/29/00	1"=60'
JOB NO.	DRAWING NO.
300353	U-61

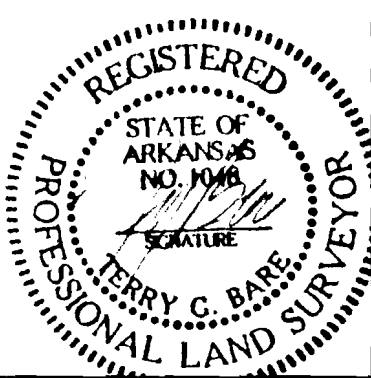

DOUBLE BROWN
PROPERTIES, INC.