

LEGEND

- = BOUNDARY LINE
- = ADJACENT PROPERTY LINES
- = EASEMENT LINES
- = FOUND "X"
- = FOUND IRON PIPE W/ PLS #1549 CAP
- = SET 1 1/4" IRON PIPE W/ PLS #1549 CAP

**EXISTING R-2 ZONING
REQUESTED C-1 ZONING**

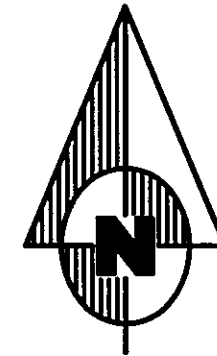

BEARING BASIS
(PREVIOUS SURVEYS)



GRAPHIC SCALE
IN FEET

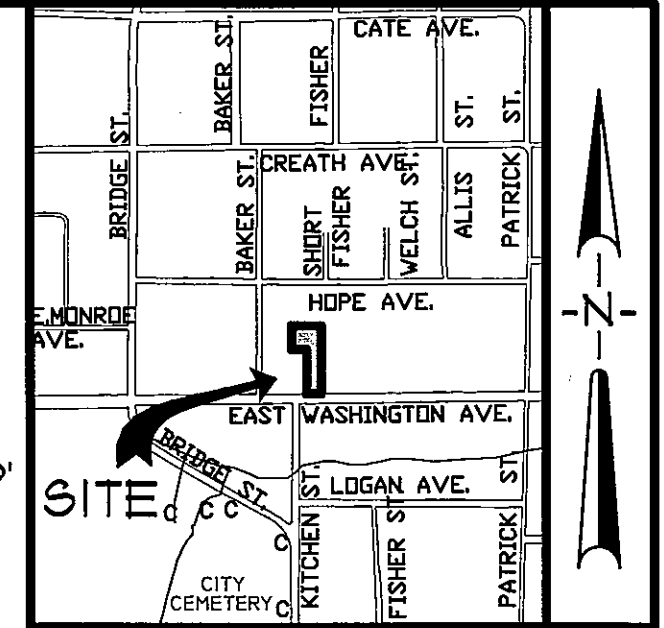

VICINITY SKETCH
NOT TO SCALE

OWNER'S CERTIFICATION

I HEREBY CERTIFY THAT I AM THE OWNER OF THE PROPERTY AS DESCRIBED HEREON, AND THAT I REQUEST THE ZONING CHANGE AS

NOTED.

Jimmy Cooper
 JIMMY COOPER
 VICE PRESIDENT
 ST. BERNARDS REGIONAL MEDICAL CENTER

SURVEYOR'S CERTIFICATION

I HEREBY CERTIFY THAT ASSOCIATED ENGINEERING AND TESTING, LLC HAS THIS DATE MADE A BOUNDARY SURVEY OF THE ABOVE DESCRIBED PROPERTY AS SHOWN HEREON AND THAT SAID SURVEY IS ACCURATE AND CORRECT TO THE BEST OF MY KNOWLEDGE AND BELIEF. THERE ARE NO APPARENT ABOVE GROUND ENCROACHMENTS OTHER THAN AS SHOWN OR STATED HEREON AND THAT THIS SURVEY WAS MADE IN ACCORDANCE WITH THE "ARKANSAS MINIMUM STANDARDS FOR PROPERTY SURVEYS AND PLATS" IN EFFECT ON THIS DATE.

DATE OF BOUNDARY SURVEY: 03/27/09

DESCRIPTION

A PARCEL OF LAND LYING IN THE SOUTHEAST QUARTER OF SECTION 18, TOWNSHIP 14 NORTH, RANGE 4 EAST, CRAIGHEAD COUNTY, ARKANSAS, BEING A PART OF LOTS 1 AND 2, BLOCK 1, WASHINGTON ADDITION AND PART OF AN ABANDONED ALLEY LYING WITHIN THE FOLLOWING DESCRIPTION, BEING MORE PARTICULARLY DESCRIBED AS FOLLOWS:

BEGINNING AT THE SOUTHWEST CORNER OF LOT 2, BLOCK 1, WASHINGTON ADDITION: THENCE NORTH 02°09'03" EAST ALONG THE WEST LINE OF SAID LOT 2, 148.13 FEET TO THE NORTHWEST CORNER OF SAID LOT 2: THENCE NORTH 88°23'01" WEST ALONG THE NORTH LINE OF LOT 3, BLOCK 1, WASHINGTON ADDITION, 50.17 FEET TO THE NORTHWEST CORNER OF SAID LOT 3: THENCE NORTH 02°09'03" EAST DEPARTING SAID NORTHWEST CORNER, 19.32 FEET TO A POINT ON THE NORTH LINE OF LOT 1, BLOCK 1, WASHINGTON ADDITION: THENCE SOUTH 81°16'13" EAST ALONG SAID NORTH LINE, 98.88 FEET TO THE NORTHEAST CORNER OF SAID LOT 1: THENCE SOUTH 02°29'09" WEST DEPARTING SAID NORTHEAST CORNER AND ALONG THE EAST LINE OF SAID LOTS 1 AND 2, 225.55 FEET TO THE SOUTHEAST CORNER OF SAID LOT 2: THENCE NORTH 88°23'01" WEST DEPARTING SAID SOUTHEAST CORNER OF LOT 2 AND ALONG THE SOUTH LINE OF LOT 2 AND THE NORTHERLY RIGHT OF WAY LINE OF WASHINGTON AVENUE, 47.39 FEET TO THE POINT OF BEGINNING

CONTAINING IN ALL 14,815 SQ.FT. OR 0.34 ACRES, MORE OR LESS.

SUBJECT TO EASEMENT, RESTRICTIONS, RESERVATIONS AND RIGHTS-OF-WAY OF RECORD.

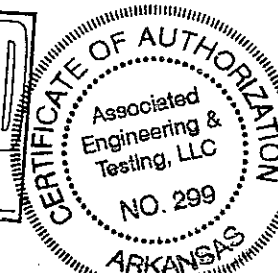
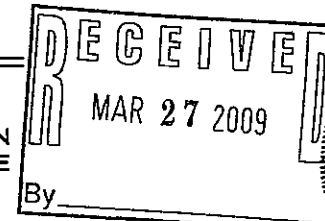

PATRICK W. LEMLEY
 PROFESSIONAL SURVEYOR
 ARKANSAS CERTIFICATE NO. 1549

NOTE: TO BE VALID, COPIES MUST HAVE ORIGINAL SURVEYOR'S SIGNATURE AND SURVEYOR'S SEAL.

ASSOCIATED ENGINEERING AND TESTING, LLC
 CIVIL ENGINEERING, LAND SURVEYING AND MATERIALS TESTING
 103 SOUTH CHURCH STREET - P.O. BOX 1462 - JONESBORO, AR 72403
 PH: 870-932-3594 FAX: 870-935-1263

**ST. BERNARDS REGIONAL MEDICAL CENTER
 REZONING PLAT
 JONESBORO, ARKANSAS**

DRAWN: MLP	CHECKED: FWL	DATE: 03/27/09	SHEET
SCALE: 1" = 30'	CADD FILE: 06101-20	DWG#: 0414182.0101	1 OF 1

REV	DATE	REVISIONS	DRAWN	CHK'D