

VICINITY MAP

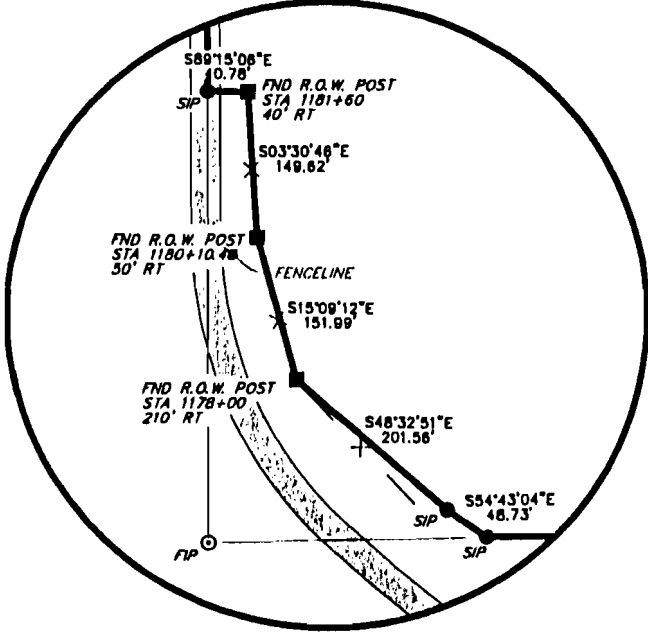

ENLARGEMENT
SCALE 1"=200'

APPLICATION FOR REZONING:
 WE BEING THE OWNER\AGENT OF THE FOLLOWING DESCRIBED PARCEL OF LAND DO
 HEREBY REQUEST THE CITY OF JONESBORO, ARKANSAS TO REZONE SAME FROM
 RESIDENTIAL-1 (R-1) TO INDUSTRIAL - 1 (I-1):

ALL THAT PART OF THE NORTH HALF OF THE SOUTHEAST QUARTER OF SECTION 36,
 TOWNSHIP 14 NORTH - RANGE 4 EAST, LYING NORTHEAST OF U.S. HIGHWAY NO. 63, LESS
 AND EXCEPT MOORE ROAD RIGHT OF WAY, CONTAINING 74.55 ACRES MORE OR LESS,
 SUBJECT TO ALL RIGHTS OF WAYS AND EASEMENTS OF RECORD.

SIGNED THIS 17TH OF AUGUST, 2001
 BY Bob Maloney TITLE: OWNER
 BY _____ TITLE: _____
 BY _____ TITLE: _____

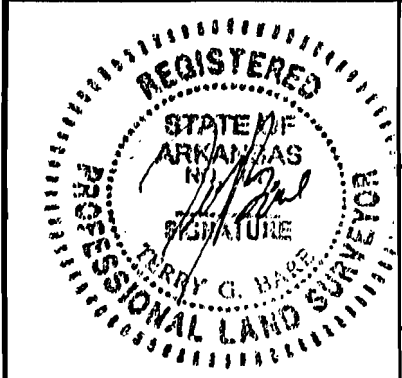
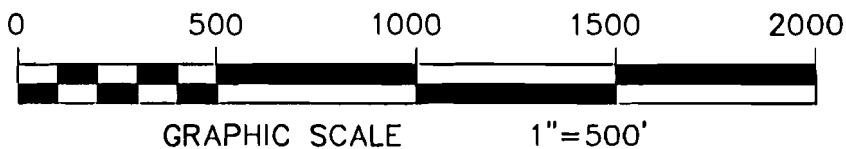

REZONING APPLICATION

THE N 1/2 OF THE SE 1/4
 OF SECT. 36, T14N - R4E
 CRAIGHEAD COUNTY ARKANSAS

HAYWOOD, KENWARD, BARE & ASSOCIATES, INC.
 CIVIL ENGINEERING - SURVEYING - PLANNING
 3301 E. HIGHLAND DRIVE
 JONESBORO, ARKANSAS 72401
 TEL 870-932-2019 FAX 870-932-1078

REVISIONS		
DATE	BY	DESCRIPTION

DRAWN BY	SHEET
MD	1 OF 1
DATE	SCALE
8/13/01	1"=500'
JOB NO.	DRAWING NO.
300522	I-218

CLIENT
 R.E.S.