

BRANDON WOOD, P.E., P.S.
ENGINEERING & SURVEYING
11120 N. 1035
BROOKLAND, AR 72417
PH: (870) 850-7547
FAX: (870) 850-7548
WWW.BRANDONWOODSURVEYING.COM

DATE: 02/27/17
BY: BSW

REZONING PLAT: AG-1 REQUESTING I-1
TRACT 1 & PART OF TRACT 2 OF
MAYME GRIFFIN / LIBERTY BANK MINOR PLAT
JONESBORO, CRAIGHEAD COUNTY, ARKANSAS
CLIENT: SAI REAL ESTATE LLC

BRANDON G. WOOD
ARCHITECTURAL SERVICES
1817



OWNER'S CERTIFICATION
WE DO HEREBY CERTIFY THAT WE ARE THE OWNERS OF THE ABOVE DESCRIBED PROPERTY AND HAVE CAUSED SAME TO BE SURVEYED AND REQUEST A REZONING OF SAID PROPERTY FROM AG-1 TO I-1.

PRINTED NAME: _____
SIGNATURE: _____
TITLE: _____

SURVEYOR'S NOTES:
1. SURVEYOR HAS MADE NO INVESTIGATION OR INDEPENDENT SEARCH FOR EASEMENTS OF RECORD OR ANY OTHER FACTS THAT AN ACCURATE TITLE SEARCH MAY DISCLOSE.
2. THE FOLLOWING DOCUMENTS WERE USED AS REFERENCES FOR THIS SURVEY:
a. SURVEY PLAT - MAYME GRIFFIN / LIBERTY BANK MINOR PLAT, BY G. HAMMAN P.S. # 173, CRAIGHEAD COUNTY COURTHOUSE, PLAT BOOK 'C', PAGE 175, DATED 06/30/2005.
b. DEED - SAI REAL ESTATE LLC, CRAIGHEAD COUNTY COURTHOUSE, DOCUMENT # 2017R-024043, DATED 12/29/2017.

DESCRIPTION:
A PART OF THE NORTHWEST QUARTER OF THE NORTHEAST QUARTER OF SECTION 26, TOWNSHIP 14 NORTH, RANGE 4 EAST, CRAIGHEAD COUNTY, ARKANSAS MORE PARTICULARLY DESCRIBED AS FOLLOWS:
COMMENCING AT THE NORTH QUARTER CORNER OF SAID SECTION 26 THENCE SOUTH 00°27'27" WEST 67.72 FEET, THENCE NORTH 89°20'24" EAST 800.51 FEET TO THE POINT OF BEGINNING, THENCE NORTH 89°23'56" EAST 176.42 FEET, THENCE NORTH 89°05'33" EAST 326.32 FEET, THENCE SOUTH 00°38'05" EAST 230.23 FEET, THENCE SOUTH 00°31'47" WEST 888.58 FEET, THENCE SOUTH 88°04'15" WEST 501.24 FEET, THENCE SOUTH 00°28'05" EAST 249.85 FEET, THENCE SOUTH 00°28'05" EAST 249.85 FEET TO THE POINT OF BEGINNING PROPER, HAVING AN AREA OF 563,457.1 SQUARE FEET, 12.93 ACRES MORE OR LESS, BEING SUBJECT TO ALL PUBLIC AND PRIVATE ROADS AND EASEMENTS.

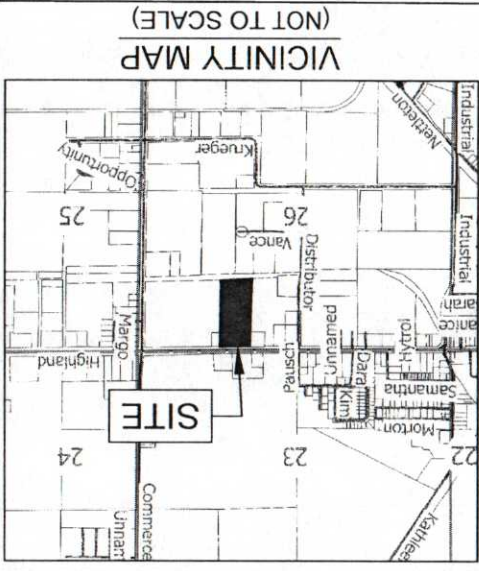

SURVEYOR'S CERTIFICATION
I, BRANDON G. WOOD, CERTIFY THAT THE SURVEY SHOWN HEREON WAS MADE IN ACCORDANCE WITH THE REQUIREMENTS OF ARKANSAS STANDARDS OF PRACTICE FOR PROPERTY BOUNDARY SURVEYS AND PLATS.
BRANDON G. WOOD, P.S. # 1817

