

R-1 ZONING  
CARTER LANE  
N89° 55' 57" E 591.47'

R-1 ZONING

CURRENT ZONING R-1  
PROPOSED ZONING C-4

LOT 4

LOT 5

690° 00' 00" W  
220.02'

600° 45' 47" W 658.06

R-1 ZONING

R-1 ZONING

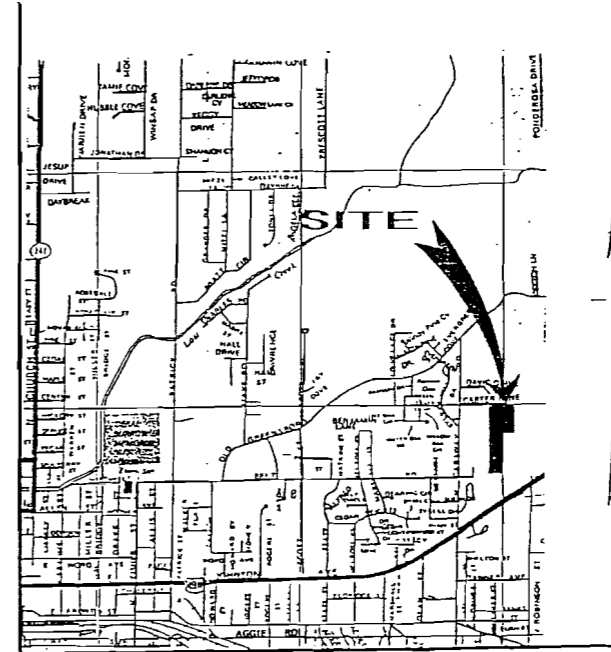

VICINITY SKETCH  
NOT TO SCALE

DESCRIPTION

LOT 4 OF HATTIAH WEISS SUBDIVISION OF THE SOUTH HALF OF THE SOUTH QUARTER OF SECTION 9, TOWNSHIP 14 NORTH, RANGE 4 EAST, CRAIGHEAD COUNTY, ARKANSAS. ALSO, ALL OF LOT 5 OF HATTIAH WEISS SUBDIVISION OF THE SOUTH HALF OF SECTION 9, TOWNSHIP 14 NORTH, RANGE 4 EAST, CRAIGHEAD COUNTY, ARKANSAS LESS THE EAST 220 FEET OF THE SOUTH 658 FEET THEREOF.

CONTAINING IN ALL 634,806 SQ. FT. OR 14.573 ACRES, MORE OR LESS.

SUBJECT TO EASEMENTS, RESTRICTIONS, RESERVATIONS AND RIGHTS-OF-WAY RECORD.

Sec. 9/14/4

Sec. 16/14/4

CARAWAY ROAD

EAST 590.0'

WEST 371.44'

220.02' 30" PUBLIC RIGHTWAY PER PLAT

N.W. CORNER OF SECTION 16,  
TOWNSHIP 14 NORTH, RANGE 4  
EAST, CRAIGHEAD CO., AR.

R-1 ZONING

R-1 ZONING

R-1 ZONING