

TURTLE CREEK GREENWAY PHASE-I SECTION II & SECTION III & SECTION IV A CITY OF JONESBORO, ARKANSAS

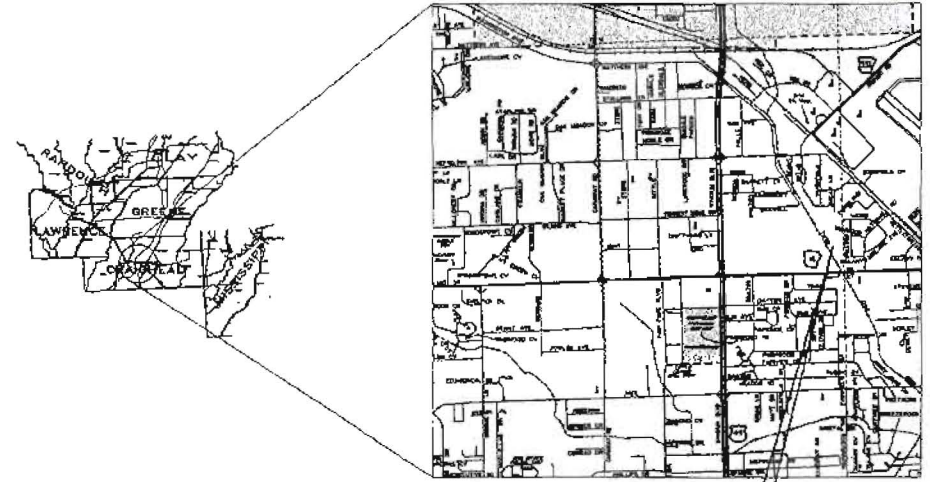

INDEX TO SHEETS

- 1 COVER SHEET
- 2 SECTION II OVERALL LAYOUT
- 3 SECTION II - PLAN & PROFILE STA. 0+00 - 10+00
- 4 SECTION II - PLAN & PROFILE STA. 10+00 - 19+46
- 5 HIGHLAND DRIVE TRAILHEAD EXISTING TOPOGRAPHY
- 6 HIGHLAND DRIVE TRAILHEAD PROPOSED SITE PLAN
- 7 SECTION III OVERALL LAYOUT
- 8 SECTION III - PLAN & PROFILE STA. 0+00 - 9+08
- 9 SECTION III - PLAN & PROFILE STA. 9+08 - 15+50
- 10 VIKING STREET TRAILHEAD PROPOSED SITE PLAN
- 11 SECTION IV A - OVERALL LAYOUT
- 12 SECTION IV A - PLAN & PROFILE STA. 15+30-20+06
- 13 DETAILS



BEFORE CONSTRUCTION BEGINS
CALL 800-462-8888
FOR UNDERGROUND UTILITY LOCATIONS
CALL THE ARKANSAS ONE CALL CENTER

NOVEMBER 2009

JASON A. MACDONALD, E.J.

LANCE POWELL, P.E.

SUBMITTED BY:
ENR
CONSULTING ENGINEERS



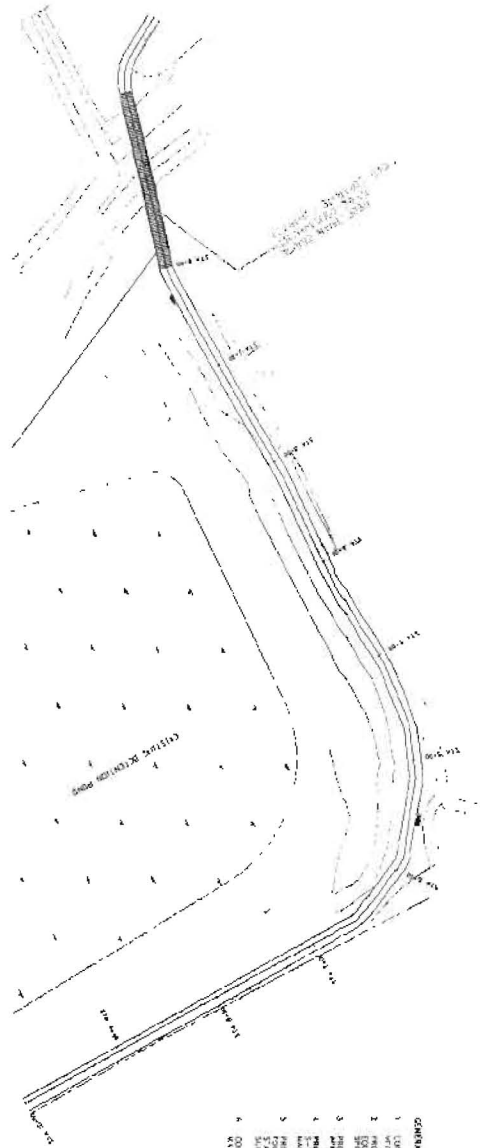

- GENERAL NOTES:
1. CONTRACTOR SHALL BE RESPONSIBLE FOR OBTAINING ALL NECESSARY PERMITS AND APPROVALS FROM ALL AFFECTED AGENCIES AND AGENCIES.
 2. CONTRACTOR SHALL BE RESPONSIBLE FOR OBTAINING ALL NECESSARY PERMITS AND APPROVALS FROM ALL AFFECTED AGENCIES AND AGENCIES.
 3. CONTRACTOR SHALL BE RESPONSIBLE FOR OBTAINING ALL NECESSARY PERMITS AND APPROVALS FROM ALL AFFECTED AGENCIES AND AGENCIES.
 4. CONTRACTOR SHALL BE RESPONSIBLE FOR OBTAINING ALL NECESSARY PERMITS AND APPROVALS FROM ALL AFFECTED AGENCIES AND AGENCIES.
 5. CONTRACTOR SHALL BE RESPONSIBLE FOR OBTAINING ALL NECESSARY PERMITS AND APPROVALS FROM ALL AFFECTED AGENCIES AND AGENCIES.
 6. CONTRACTOR SHALL BE RESPONSIBLE FOR OBTAINING ALL NECESSARY PERMITS AND APPROVALS FROM ALL AFFECTED AGENCIES AND AGENCIES.
 7. CONTRACTOR SHALL BE RESPONSIBLE FOR OBTAINING ALL NECESSARY PERMITS AND APPROVALS FROM ALL AFFECTED AGENCIES AND AGENCIES.
 8. CONTRACTOR SHALL BE RESPONSIBLE FOR OBTAINING ALL NECESSARY PERMITS AND APPROVALS FROM ALL AFFECTED AGENCIES AND AGENCIES.
 9. CONTRACTOR SHALL BE RESPONSIBLE FOR OBTAINING ALL NECESSARY PERMITS AND APPROVALS FROM ALL AFFECTED AGENCIES AND AGENCIES.
 10. CONTRACTOR SHALL BE RESPONSIBLE FOR OBTAINING ALL NECESSARY PERMITS AND APPROVALS FROM ALL AFFECTED AGENCIES AND AGENCIES.

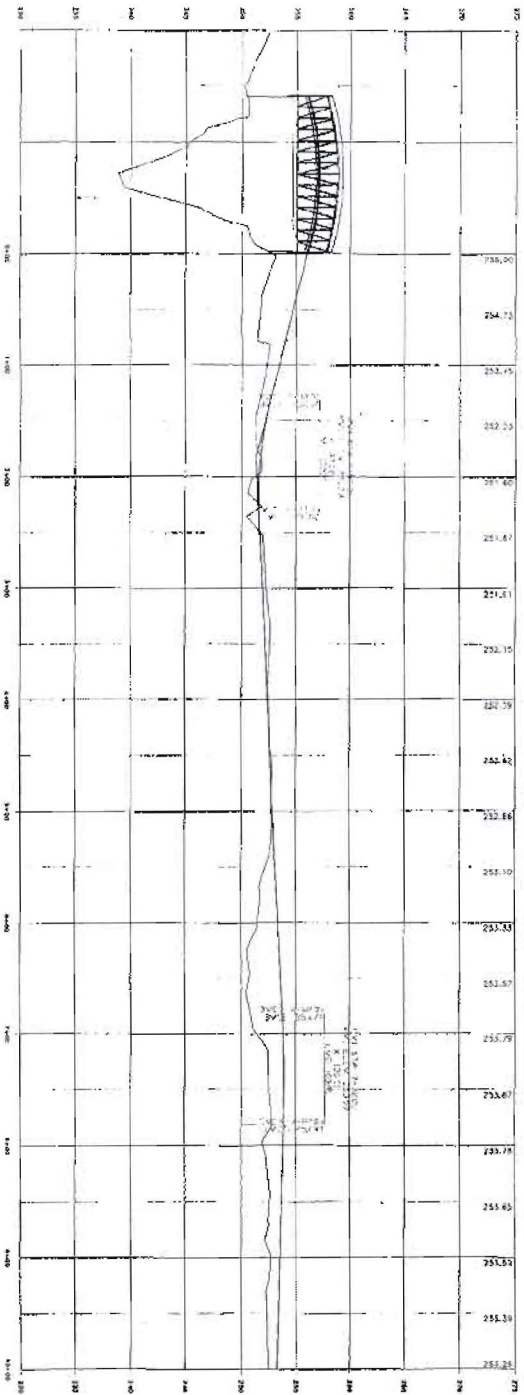

Date	Revision	Designed JWW	Checked JSS	Drawn MHL	Approved JSS	<p>ENRGS CONSULTING ENGINEERS 1001 W. UNIVERSITY BLVD LITTLE ROCK, AR 72202 TEL: (501) 325-1400 FAX: (501) 325-1402</p>	<p>TURTLE CREEK GREENWAY - PHASE I SECTION II & SECTION III & SECTION IV A CITY OF JONESBORO, ARKANSAS</p>	<p>SECTION II OF PHASE I PLAN AND PROFILE STA 0+00 - 10+00</p>	Scale 1" = 40' x 1" = 5'	Job No. 8-07-11
									Date November 2009	Sheet 3



FIG. 142 11-43

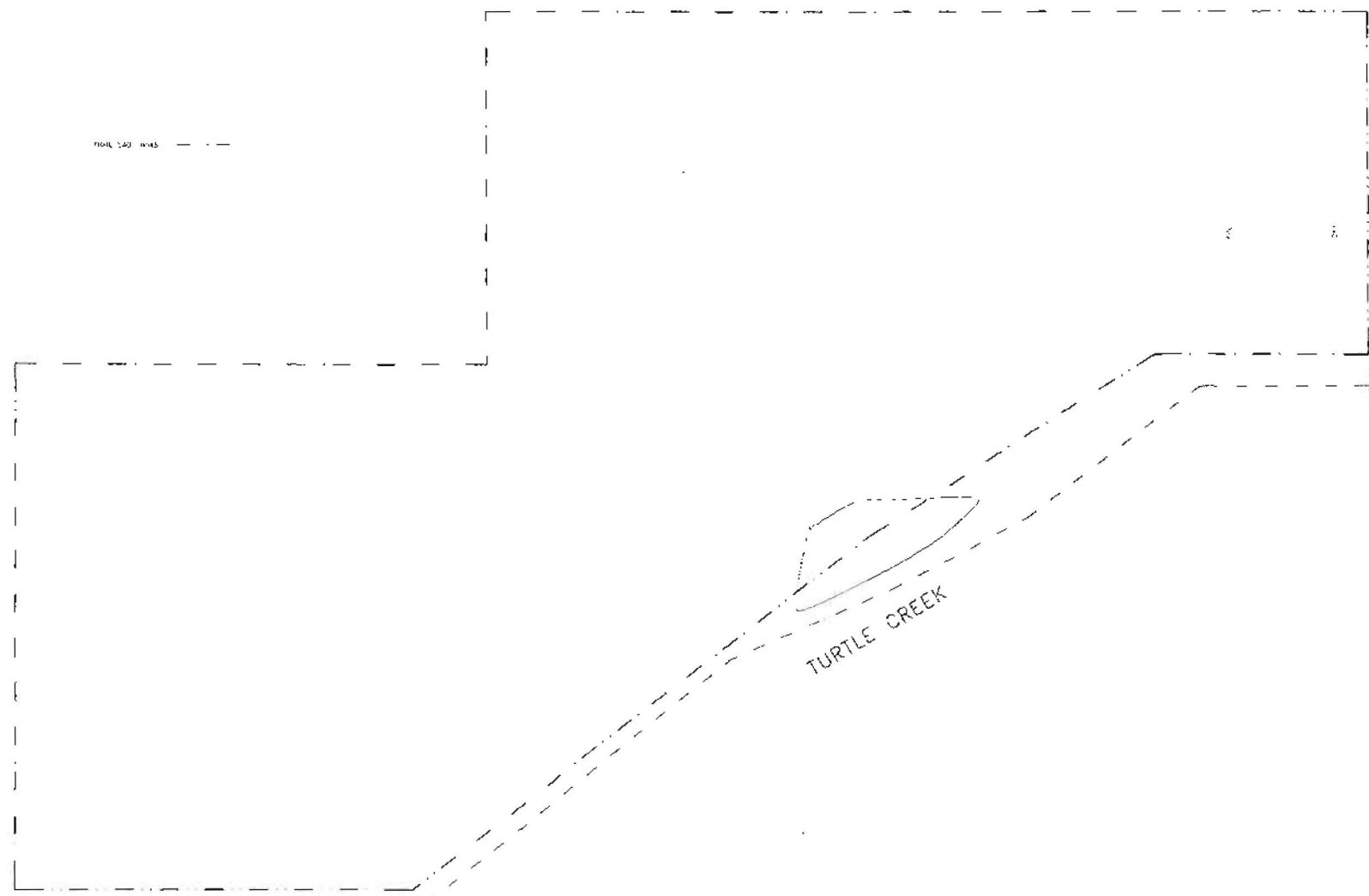

HIGHLAND DRIVE

TURTLE CREEK



Date	Revision	By

Designed	JAM
Checked	JSS
Drawn	NLH
Approved	JSS

NRS
CONSULTING ENGINEERS

3124 L. MATTHEWS AVE
JONESBORO, AR 72401
(501) 932-8316
FAX (501) 932-0413

TEXARKANA • SGT SPRING • JONESBORO

TURTLE CREEK GREENWAY - PHASE I
SECTION II & SECTION III AND SECTION IV A
CITY OF JONESBORO, ARKANSAS

HIGHLAND DRIVE TRAILHEAD
EXISTING TOPOGRAPHY

Scale	Job No.
1"=100'	08-07-01
Date	Sheet
NOVEMBER 2009	5

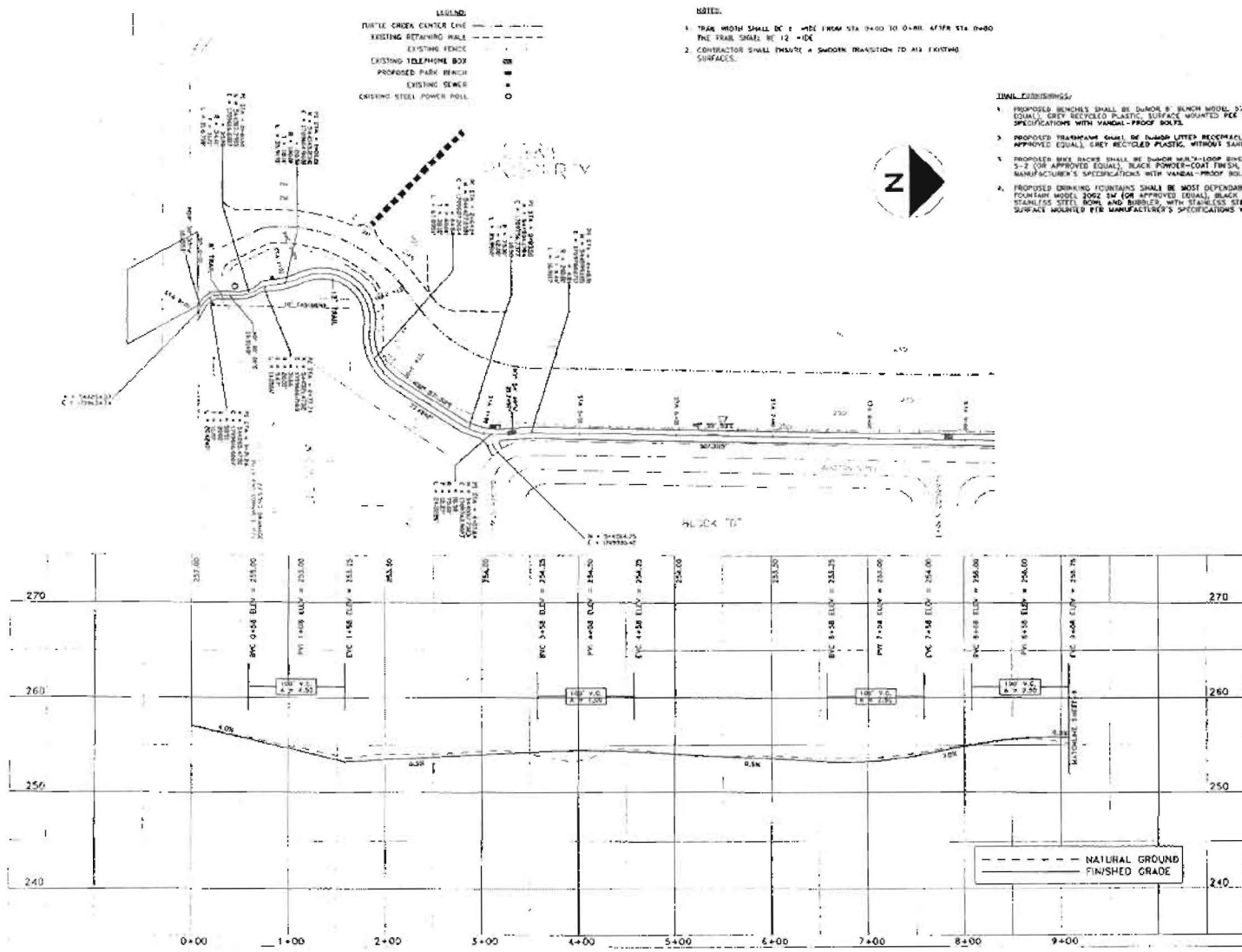

- LEGEND**
- TURTLE CREEK CENTER LINE
 - EXISTING RETAINING WALL
 - EXISTING FENCE
 - EXISTING TELEPHONE BOX
 - PROPOSED PARK BENCH
 - EXISTING SEWER
 - EXISTING STEEL POWER POLE

- NOTES:**
1. TRAIL WIDTH SHALL BE 2' WIDE FROM STA 0+00 TO 0+80 AFTER STA 0+80 THE TRAIL SHALL BE 12' WIDE
 2. CONTRACTOR SHALL ENSURE A SMOOTH TRANSITION TO ALL EXISTING SURFACES.

- FINAL ESTIMATES:**
1. PROPOSED BENCHES SHALL BE 24"X48" 8" BUNCH WOOD, 57%-60% (OR APPROVED EQUAL) GREY RECYCLED PLASTIC, SURFACE MOUNTED PER MANUFACTURER'S SPECIFICATIONS WITH VANDAL-PROOF BOLTS.
 2. PROPOSED TRASHMANS SHALL BE 24"X30" LITTER RECEPTACLE WOOD, 44% (OR APPROVED EQUAL), GREY RECYCLED PLASTIC, WITHOUT SAND URN.
 3. PROPOSED BENCH BACKS SHALL BE 24"X30" WOOD-LOOP BENCH MODEL 125-30 3-2 (OR APPROVED EQUAL), BLACK POWDER-COAT FINISH, SURFACE MOUNTED PER MANUFACTURER'S SPECIFICATIONS WITH VANDAL-PROOF BOLTS.
 4. PROPOSED DRINKING FOUNTAINS SHALL BE MOST DEPENDABLE FOUNTAINS DRINKING FOUNTAIN MODEL 2062 24" (OR APPROVED EQUAL), BLACK POWDER-COAT FINISH, STAINLESS STEEL BOWL AND BODIES WITH STAINLESS STEEL SURFACE CANNES SURFACE MOUNTED PER MANUFACTURER'S SPECIFICATIONS WITH VANDAL-PROOF BOLTS.



Date Revision By	Designed JAM Checked JSS Drawn BLH Approved JSS	 NRS CONSULTING ENGINEERS <small>2114 E. MATHERS AVE. JONESBORO, AR 72403 (870) 872-5216 FAX (870) 872-0432</small>	TURTLE CREEK GREENWAY - PHASE 1 SECTION II & SECTION III & SECTION IV A A CITY OF JONESBORO, ARKANSAS	SECTION III OF PHASE I PLAN & PROFILE STA 0+00 - 9+00	Scale 1/4" = 1'-0" V, 1" = 30' H Date NOVEMBER 2009	Job No. JB-07-01 Sheet 8
------------------------	--	---	--	--	--	--

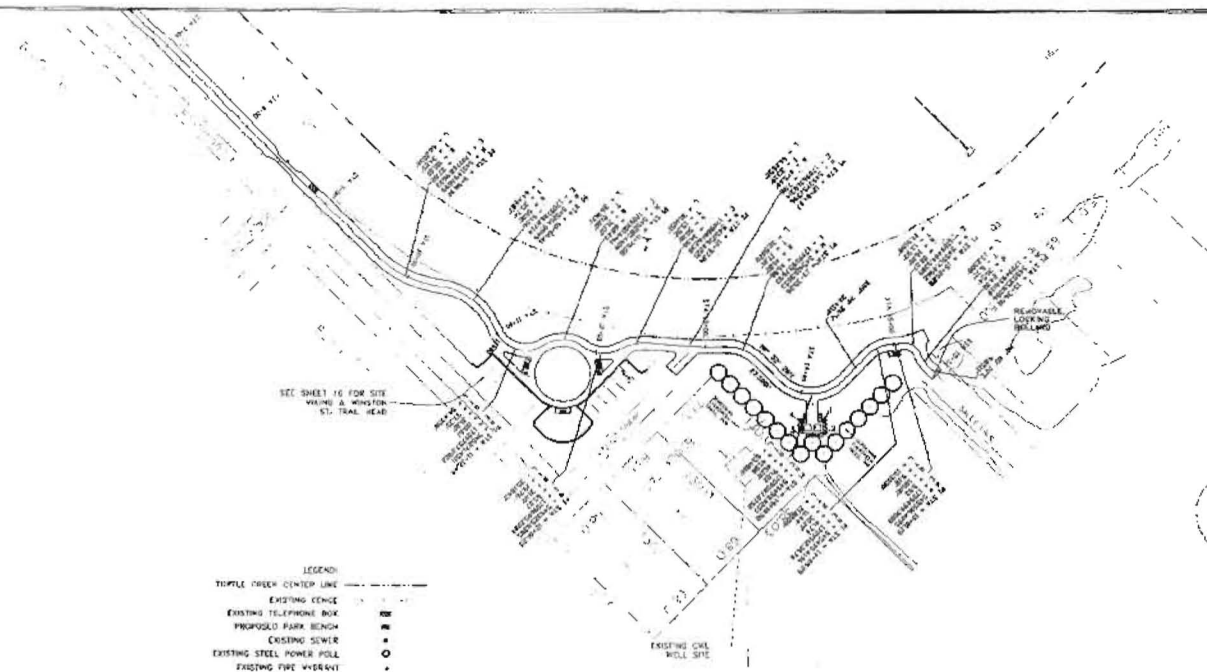

- TRAIL FURNISHINGS:**
1. PROPOSED BENCHES SHALL BE 24"X48" 4" BENCH MODEL 07-0006 (OR APPROVED EQUAL) GREY RECYCLED PLASTIC SURFACE MOUNTED PER MANUFACTURER'S SPECIFICATIONS WITH VANDAL-PROOF BOLTS.
 2. PROPOSED TRASHCANS SHALL BE 24"X30" LITTER RECEPTACLE MODEL 44PL (OR APPROVED EQUAL) GREY RECYCLED PLASTIC WITHOUT LAMP SHADE.
 3. PROPOSED BIKE RACKS SHALL BE 24"X48" MULTI-LOOP BIKE RACK MODEL 135-20 34" X 2" (OR APPROVED EQUAL) BLACK POWDER-COAT FINISH SURFACE MOUNTED PER MANUFACTURER'S SPECIFICATIONS WITH VANDAL-PROOF BOLTS.
 4. PROPOSED DRINKING FOUNTAINS SHALL BE MOST DEFENDABLE FOUNTAINS DRINKING FOUNTAIN MODEL 2002 24" FOR APPROVED EQUAL BLACK POWDER-COAT FINISH STAINLESS STEEL BOWL AND BUBBLER WITH STAINLESS STEEL SURFACE CARRIER SURFACE MOUNTED PER MANUFACTURER'S SPECIFICATIONS WITH VANDAL-PROOF BOLTS.

- NOTES:**
1. TRAIL WIDTH SHALL BE 8' WIDE FROM STA. 9+32 TO 14+45, AFTER STA. 0+00 THE TRAIL SHALL BE 12' WIDE.
 2. CONTRACTOR SHALL ENSURE A SMOOTH TRANSITION TO ALL EXISTING SURFACES.
 3. PORTA-TOILETS CONCRETE PAD SHALL BE SET TO AN ELEVATION OF 256.43.

LAT. SURVEY POINTS:

POINT	NORTHING	EASTING
1	543009.00	1709556.26
2	543016.14	1709803.43
3	543022.74	1709516.80
4	543495.64	1709608.35

- LEGEND:**
- TURTLE CREEK CENTER LINE
 - EXISTING FENCE
 - EXISTING TELEPHONE BOX
 - PROPOSED PARK BENCH
 - EXISTING SEWER
 - EXISTING STEEL POWER POLE
 - EXISTING FIRE W/REENT

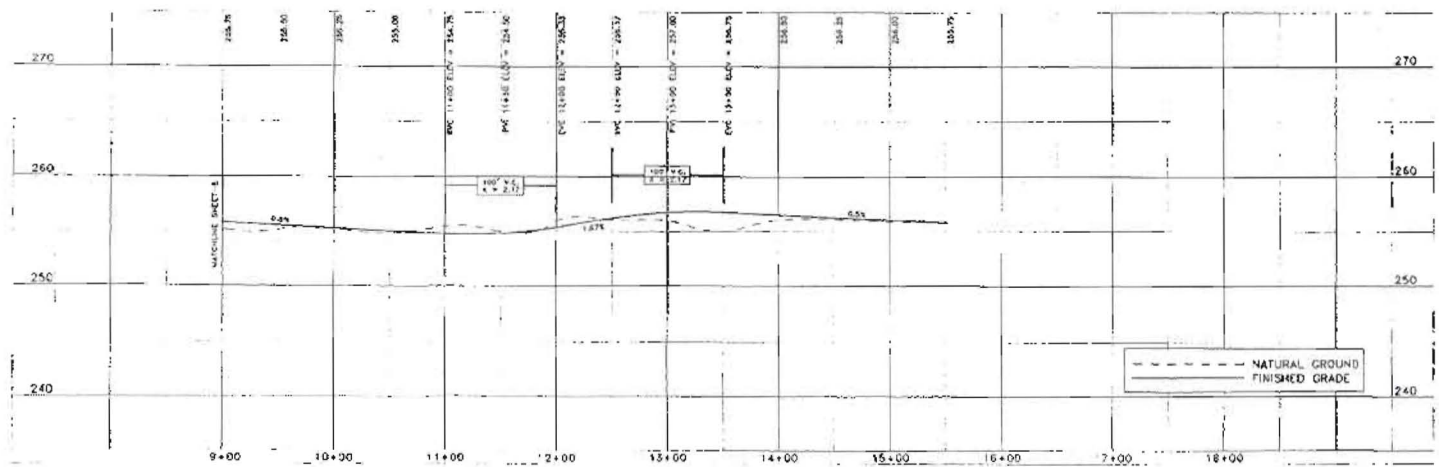

Date	Revision	Designed JAM Checked JSS Drawn NEM Approved JSS	 <small>2114 E. MATTHEWS AVE. JONESBORO, AR 72401 (870) 932-3334 FAX (870) 932-0432</small>	TURTLE CREEK GREENWAY - PHASE 1 SECTION II & SECTION III & SECTION IV A A CITY OF JONESBORO, ARKANSAS	SECTION III OF PHASE I PLAN & PROFILE STA 9+00 - 15+52	Scale 1/4" = 1'-0" Date NOVEMBER 2009	Job No JB-07-01 Sheet 9
------	----------	--	---	--	---	--	----------------------------------

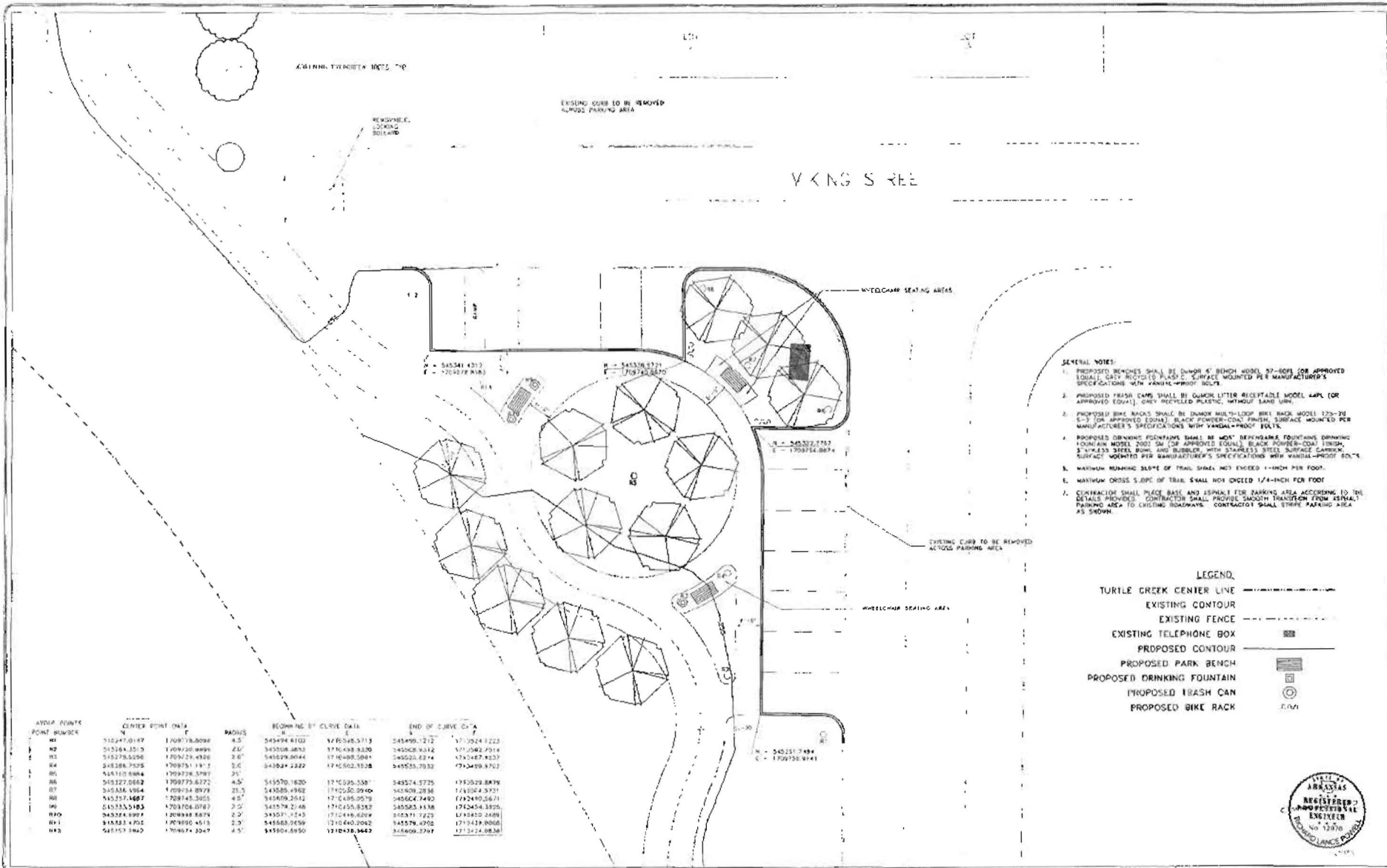

- GENERAL NOTES:**
1. PROPOSED BENCHES SHALL BE DUNN 4' BENCH MODEL 87-808 (OR APPROVED EQUAL). GREY RECYCLED PLASTIC SURFACE MOUNTED PER MANUFACTURER'S SPECIFICATIONS WITH VANDAL-PROOF BOLTS.
 2. PROPOSED TRASH CANS SHALL BE DUNN LITTER RECEPTACLE MODEL 44PL (OR APPROVED EQUAL). GREY RECYCLED PLASTIC WITHOUT SAND LINER.
 3. PROPOSED BIKE RACKS SHALL BE DUNN MULTI-LOOP BWT BACK MODEL 173-28 (S-3) (OR APPROVED EQUAL). BLACK POWDER-COAT FINISH. SURFACE MOUNTED PER MANUFACTURER'S SPECIFICATIONS WITH VANDAL-PROOF BOLTS.
 4. PROPOSED DRINKING FOUNTAINS SHALL BE WOLF DRINKING FOUNTAINS DRINKING FOUNTAIN MODEL 2007 SM (OR APPROVED EQUAL). BLACK POWDER-COAT FINISH. 3" X 1/8" STEEL BOWL AND BUBBLER WITH STAINLESS STEEL SURFACE CARRIER SURFACE MOUNTED PER MANUFACTURER'S SPECIFICATIONS WITH VANDAL-PROOF BOLTS.
 5. MAXIMUM RUNNING SLOPE OF TRAIL SHALL NOT EXCEED 1-INCH PER FOOT.
 6. MAXIMUM CROSS SLOPE OF TRAIL SHALL NOT EXCEED 1/4-INCH PER FOOT.
 7. CONTRACTOR SHALL PLACE BASE AND ASPHALT FOR PARKING AREA ACCORDING TO THE DETAILS PROVIDED. CONTRACTOR SHALL PROVIDE SMOOTH TRANSITION FROM ASPHALT PARKING AREA TO EXISTING ROADWAYS. CONTRACTOR SHALL STRENGTHEN PARKING AREA AS SHOWN.

- LEGEND**
- TURTLE CREEK CENTER LINE
 - EXISTING CONTOUR
 - EXISTING FENCE
 - EXISTING TELEPHONE BOX
 - PROPOSED CONTOUR
 - PROPOSED PARK BENCH
 - PROPOSED DRINKING FOUNTAIN
 - PROPOSED TRASH CAN
 - PROPOSED BIKE RACK



START POINT POINT NUMBER	CENTER POINT DATA		RADIUS	BEGINNING OF CURVE DATA		END OF CURVE DATA	
	N	E		N	E	N	E
R1	51247.0187	1709738.8098	4.5	545494.6103	1745545.5713	545499.1212	1745544.2223
R2	512518.2578	1709730.8899	2.0	545708.3852	1745438.8320	545628.6312	1745582.2914
R3	512778.2286	1709724.4938	2.0	545828.8044	1745400.5884	545825.8274	1745487.8237
R4	512886.7525	1709751.1817	2.0	545924.2222	1745502.1828	545925.7032	1745409.8702
R5	512910.8884	1709728.3787	2.5	545970.1820	1745526.3581	545974.5775	1745528.8878
R6	512927.8882	1709775.6272	4.5	54585.4982	1745550.2940	545808.2838	1745304.5731
R7	512937.1687	1709745.3025	4.5	545879.2642	1745485.0579	545864.7492	1745490.2671
R8	512938.1882	1709704.0787	2.5	545878.2148	1745455.8387	545885.1438	1745484.3928
R9	512924.8884	1709848.8874	2.0	545871.2143	1745448.4074	545871.7223	1745452.2688
R10	512933.4302	1709890.4513	2.0	545883.8659	1745440.2042	545879.4702	1745438.8068
R11	512937.3942	1709874.2047	4.5	545884.8850	1745438.3442	545886.3747	1745432.0838

Date	Revision	By	Designed: JMM Checked: JSS Drawn: NJH Approved: JSS	 2114 E. MATTHEWS AVE. GREENSBORO, IN 47040 (317) 937-4374 FAX: (317) 937-2432	TURTLE CREEK GREENWAY - PHASE I SECTION II & SECTION III & SECTION IV A CITY OF JONESBOR, ARKANSAS	VIKING & WINSTON STREET TRAILHEAD PROPOSED SITE PLAN	Scale: 1"=10' Date: NOVEMBER 2009	Job No.: 08-07-01 Sheet: 10
------	----------	----	--	--	---	--	--------------------------------------	--------------------------------



- GENERAL NOTES**
1. ALL UTILITIES, EXISTING AND PROPOSED SHALL BE AS SHOWN ON THE SHEETS. TECHNICAL SPECIFICATIONS:
 2. THE CONTRACTOR SHALL BE RESPONSIBLE FOR OBTAINING ALL NECESSARY PERMITS AND APPROVALS FROM THE APPROPRIATE AGENCIES. THE CONTRACTOR SHALL BE RESPONSIBLE FOR OBTAINING ALL NECESSARY PERMITS AND APPROVALS FROM THE APPROPRIATE AGENCIES. THE CONTRACTOR SHALL BE RESPONSIBLE FOR OBTAINING ALL NECESSARY PERMITS AND APPROVALS FROM THE APPROPRIATE AGENCIES.
 3. THE CONTRACTOR SHALL BE RESPONSIBLE FOR OBTAINING ALL NECESSARY PERMITS AND APPROVALS FROM THE APPROPRIATE AGENCIES. THE CONTRACTOR SHALL BE RESPONSIBLE FOR OBTAINING ALL NECESSARY PERMITS AND APPROVALS FROM THE APPROPRIATE AGENCIES.
 4. THE CONTRACTOR SHALL BE RESPONSIBLE FOR OBTAINING ALL NECESSARY PERMITS AND APPROVALS FROM THE APPROPRIATE AGENCIES. THE CONTRACTOR SHALL BE RESPONSIBLE FOR OBTAINING ALL NECESSARY PERMITS AND APPROVALS FROM THE APPROPRIATE AGENCIES.
 5. THE CONTRACTOR SHALL BE RESPONSIBLE FOR OBTAINING ALL NECESSARY PERMITS AND APPROVALS FROM THE APPROPRIATE AGENCIES. THE CONTRACTOR SHALL BE RESPONSIBLE FOR OBTAINING ALL NECESSARY PERMITS AND APPROVALS FROM THE APPROPRIATE AGENCIES.
 6. THE CONTRACTOR SHALL BE RESPONSIBLE FOR OBTAINING ALL NECESSARY PERMITS AND APPROVALS FROM THE APPROPRIATE AGENCIES. THE CONTRACTOR SHALL BE RESPONSIBLE FOR OBTAINING ALL NECESSARY PERMITS AND APPROVALS FROM THE APPROPRIATE AGENCIES.
 7. THE CONTRACTOR SHALL BE RESPONSIBLE FOR OBTAINING ALL NECESSARY PERMITS AND APPROVALS FROM THE APPROPRIATE AGENCIES. THE CONTRACTOR SHALL BE RESPONSIBLE FOR OBTAINING ALL NECESSARY PERMITS AND APPROVALS FROM THE APPROPRIATE AGENCIES.
 8. THE CONTRACTOR SHALL BE RESPONSIBLE FOR OBTAINING ALL NECESSARY PERMITS AND APPROVALS FROM THE APPROPRIATE AGENCIES. THE CONTRACTOR SHALL BE RESPONSIBLE FOR OBTAINING ALL NECESSARY PERMITS AND APPROVALS FROM THE APPROPRIATE AGENCIES.
 9. THE CONTRACTOR SHALL BE RESPONSIBLE FOR OBTAINING ALL NECESSARY PERMITS AND APPROVALS FROM THE APPROPRIATE AGENCIES. THE CONTRACTOR SHALL BE RESPONSIBLE FOR OBTAINING ALL NECESSARY PERMITS AND APPROVALS FROM THE APPROPRIATE AGENCIES.
 10. THE CONTRACTOR SHALL BE RESPONSIBLE FOR OBTAINING ALL NECESSARY PERMITS AND APPROVALS FROM THE APPROPRIATE AGENCIES. THE CONTRACTOR SHALL BE RESPONSIBLE FOR OBTAINING ALL NECESSARY PERMITS AND APPROVALS FROM THE APPROPRIATE AGENCIES.

1. CONTRACTOR SHALL BE RESPONSIBLE FOR OBTAINING ALL NECESSARY PERMITS AND APPROVALS FROM THE APPROPRIATE AGENCIES. THE CONTRACTOR SHALL BE RESPONSIBLE FOR OBTAINING ALL NECESSARY PERMITS AND APPROVALS FROM THE APPROPRIATE AGENCIES.
2. CONTRACTOR SHALL BE RESPONSIBLE FOR OBTAINING ALL NECESSARY PERMITS AND APPROVALS FROM THE APPROPRIATE AGENCIES. THE CONTRACTOR SHALL BE RESPONSIBLE FOR OBTAINING ALL NECESSARY PERMITS AND APPROVALS FROM THE APPROPRIATE AGENCIES.
3. CONTRACTOR SHALL BE RESPONSIBLE FOR OBTAINING ALL NECESSARY PERMITS AND APPROVALS FROM THE APPROPRIATE AGENCIES. THE CONTRACTOR SHALL BE RESPONSIBLE FOR OBTAINING ALL NECESSARY PERMITS AND APPROVALS FROM THE APPROPRIATE AGENCIES.
4. CONTRACTOR SHALL BE RESPONSIBLE FOR OBTAINING ALL NECESSARY PERMITS AND APPROVALS FROM THE APPROPRIATE AGENCIES. THE CONTRACTOR SHALL BE RESPONSIBLE FOR OBTAINING ALL NECESSARY PERMITS AND APPROVALS FROM THE APPROPRIATE AGENCIES.
5. CONTRACTOR SHALL BE RESPONSIBLE FOR OBTAINING ALL NECESSARY PERMITS AND APPROVALS FROM THE APPROPRIATE AGENCIES. THE CONTRACTOR SHALL BE RESPONSIBLE FOR OBTAINING ALL NECESSARY PERMITS AND APPROVALS FROM THE APPROPRIATE AGENCIES.
6. CONTRACTOR SHALL BE RESPONSIBLE FOR OBTAINING ALL NECESSARY PERMITS AND APPROVALS FROM THE APPROPRIATE AGENCIES. THE CONTRACTOR SHALL BE RESPONSIBLE FOR OBTAINING ALL NECESSARY PERMITS AND APPROVALS FROM THE APPROPRIATE AGENCIES.
7. CONTRACTOR SHALL BE RESPONSIBLE FOR OBTAINING ALL NECESSARY PERMITS AND APPROVALS FROM THE APPROPRIATE AGENCIES. THE CONTRACTOR SHALL BE RESPONSIBLE FOR OBTAINING ALL NECESSARY PERMITS AND APPROVALS FROM THE APPROPRIATE AGENCIES.
8. CONTRACTOR SHALL BE RESPONSIBLE FOR OBTAINING ALL NECESSARY PERMITS AND APPROVALS FROM THE APPROPRIATE AGENCIES. THE CONTRACTOR SHALL BE RESPONSIBLE FOR OBTAINING ALL NECESSARY PERMITS AND APPROVALS FROM THE APPROPRIATE AGENCIES.
9. CONTRACTOR SHALL BE RESPONSIBLE FOR OBTAINING ALL NECESSARY PERMITS AND APPROVALS FROM THE APPROPRIATE AGENCIES. THE CONTRACTOR SHALL BE RESPONSIBLE FOR OBTAINING ALL NECESSARY PERMITS AND APPROVALS FROM THE APPROPRIATE AGENCIES.
10. CONTRACTOR SHALL BE RESPONSIBLE FOR OBTAINING ALL NECESSARY PERMITS AND APPROVALS FROM THE APPROPRIATE AGENCIES. THE CONTRACTOR SHALL BE RESPONSIBLE FOR OBTAINING ALL NECESSARY PERMITS AND APPROVALS FROM THE APPROPRIATE AGENCIES.

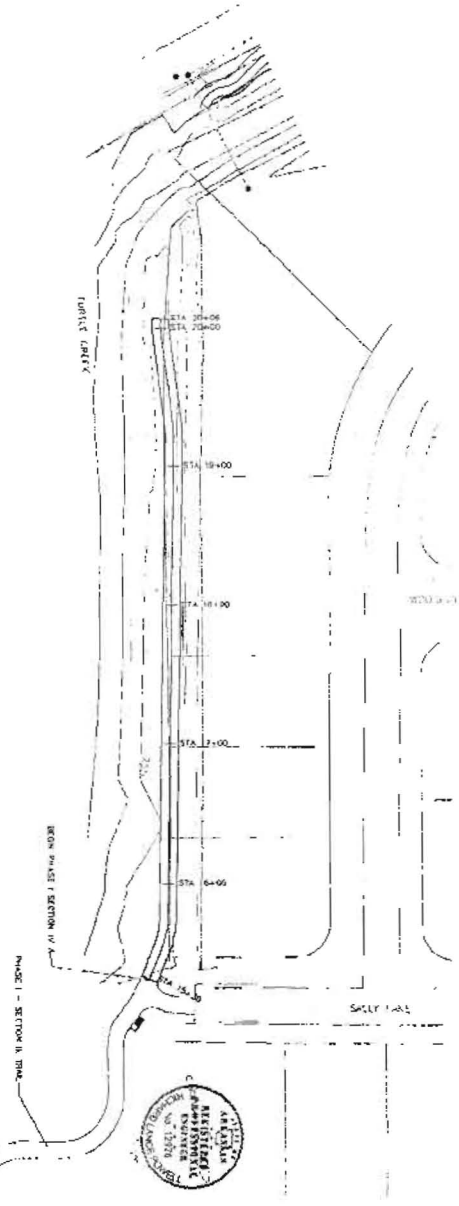

LEGEND

TOP OF DRIVE PAWK

FINISHED GRADE

OVERHEAD POWER

MANHOLE STATION

Date	Revision	Checked Down	Approved	Job No. 11
				Job No. 11
TURTLE CREEK GREENWAY - PHASE I SECTION II & SECTION III & SECTION IV A CITY OF JONESBORO, ARKANSAS				
SECTION IV A OF PHASE I OVERBALL LAYOUT				
Scale	Date	Sheet	Job No.	Job No.
1" = 40'	November 2008	11	11	11

LEGEND:
 TOP OF BENCH MARK
 FINISHED GRADE
 DRAINAGE POWER
 SANITARY SEWER

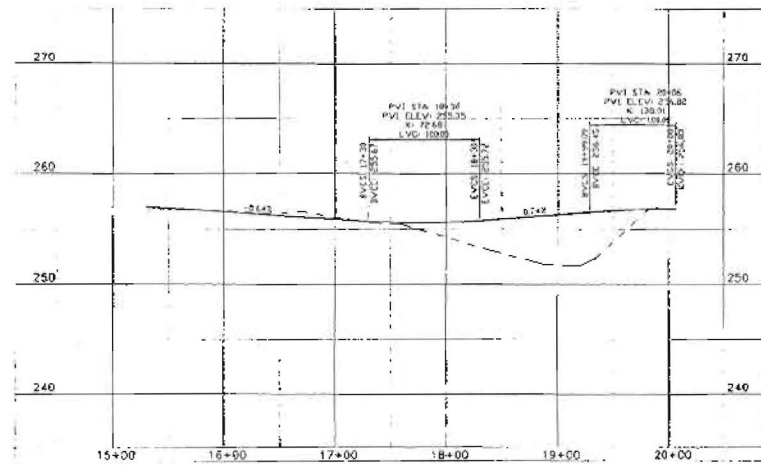
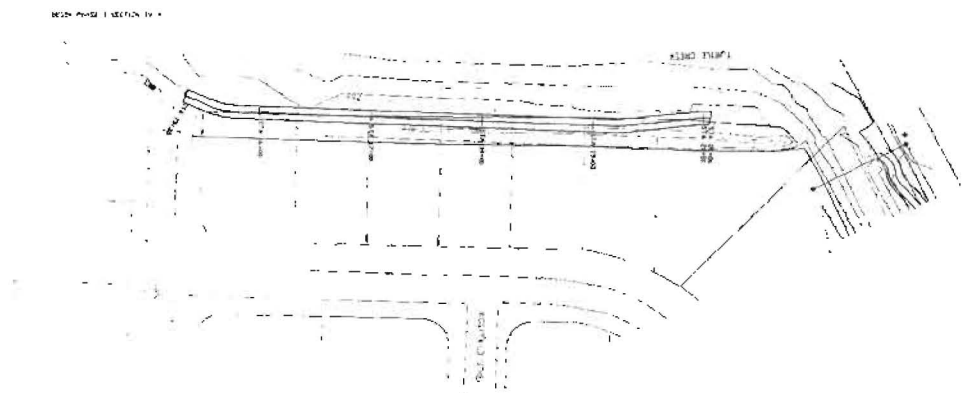

--- NATURAL GROUND
 — FINISHED GRADE



Date	Revision	By

Designed	JAM
Checked	JSS
Drawn	NLR
Approved	JSS

NRS
 CONSULTING ENGINEERS
 2114 E. BATHWATER AVE
 JONESBORO, AR 72401
 (870) 937-5418
 FAX (870) 932-2432
 ARKANSAS • MISSISSIPPI • MISSOURI

TURTLE CREEK GREENWAY - PHASE I
 SECTION II & SECTION III & SECTION IV A
 CITY OF JONESBORO, ARKANSAS

SECTION IV A OF PHASE I
 PLAN & PROFILE STA. 15+30 - 20+06

Scale	Job No.
1" = 50'	AR-07-01
Date	Sheet
NOVEMBER 2009	12

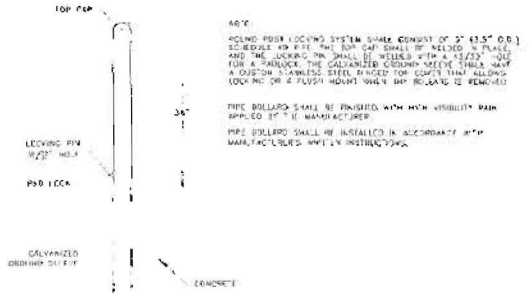

60°C
 RING-PIN LOCKING SYSTEM SHALL CONSIST OF 2" (51.5" O.D.)
 TO BE MADE OF STEEL. THE TOP CAP SHALL BE WELDED TO THE PIN.
 AND THE LOCKING PIN SHALL BE WELDED TO THE RING. THE RING
 FOR A "PINLOCK" THE GALVANIZED COATING SHALL HAVE A
 A CUSTOM STAINLESS STEEL FINISH FOR CORNERS THAT ALLOWS
 LOCKING ON A FLUSH MOUNT WHEN THE BOLLARD IS REMOVED.

TYPE BOLLARD SHALL BE FINISHED WITH HIGH VISIBILITY PAINT
 APPLIED BY THE MANUFACTURER.

THE BOLLARD SHALL BE INSTALLED IN ACCORDANCE WITH
 MANUFACTURER'S INSTALLATION INSTRUCTIONS.

REMOVABLE LOCKING BOLLARD DETAIL
 N.T.S.



SECTION - TYPE "D" ACCESS RAMP
 N.T.S.

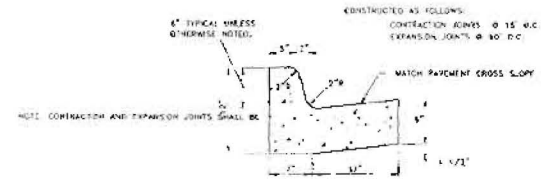

COMBINATION CURB AND GUTTER
 N.T.S.

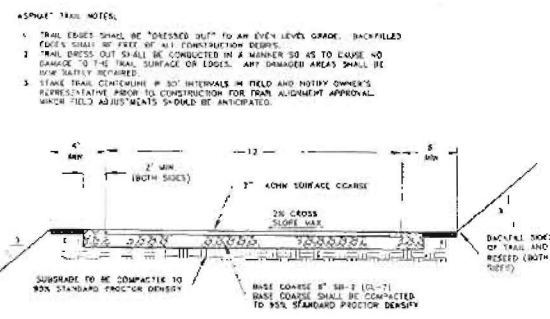

ASPHALT WALKING TRAIL DETAIL
 N.T.S.

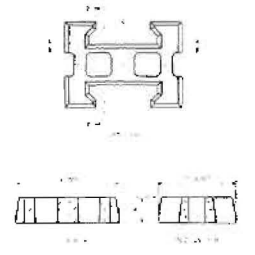

ARMORLOC CL 3510 UNIT
 N.T.S.

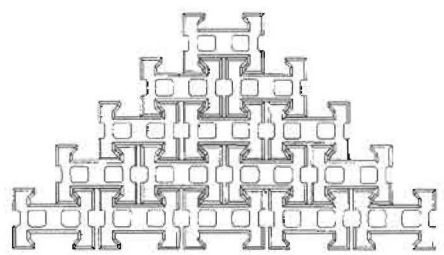

ARMORLOC 3510 LOCKING LAYOUT
 N.T.S.

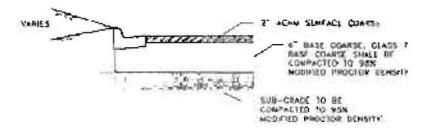

PARKING LOT SECTION DETAIL
 N.T.S.

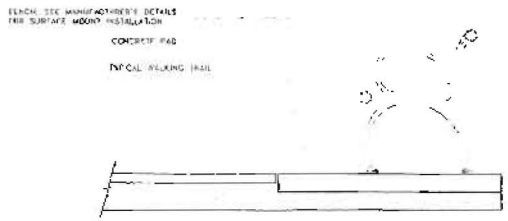

BENCH LOCATION DETAIL
 N.T.S.

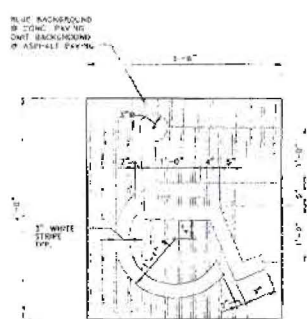

PARKING STALL SYMBOL
 1" = 1'-0"

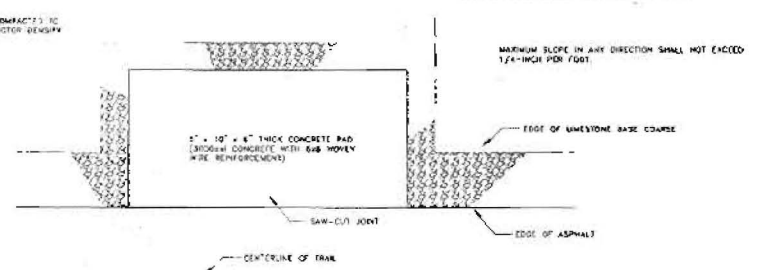

REST/TRASH RECEPTACLE AREA
 N.T.S.



Date	Revision	By

Designed	JAM
Checked	JSS
Drawn	MJR
Approved	JSS

NRS CONSULTING ENGINEERS

2114 E. WASHINGTON AVE
 JONESBORO, AR 72403
 (870) 972-3214
 FAX: (870) 932-0432

EXPLANATION • NOT SPECIFIED • DATE 03/20/09

TURTLE CREEK GREENWAY - PHASE I
 SECTION II & SECTION III & SECTION IV A
 CITY OF JONESBORO, ARKANSAS

DETAILS

Scale	Job No.
N.T.S.	0-27-09
Date	Sheet
NOVEMBER 2009	13