

DESCRIPTION

A PART OF THE NORTHWEST QUARTER OF THE SOUTHWEST QUARTER, ALL BEING IN SECTION 32, TOWNSHIP 14 NORTH, RANGE 4 EAST, CRAIGHEAD COUNTY, ARKANSAS, BEING MORE PARTICULARLY DESCRIBED AS FOLLOWS:

COMMENCING AT THE SOUTHWEST CORNER OF THE NORTHWEST QUARTER OF THE SOUTHWEST QUARTER OF SECTION 32, TOWNSHIP 14 NORTH, RANGE 4 EAST, CRAIGHEAD COUNTY, ARKANSAS: THENCE NORTH 00°08'14" EAST ALONG THE WEST LINE OF SECTION 32 A DISTANCE OF 218.64 FEET: THENCE NORTH 89°41'55" EAST DEPARTING FROM SAID WEST LINE A DISTANCE OF 51.89 FEET TO THE POINT OF BEGINNING: THENCE NORTH 00°21'04" A DISTANCE OF 240.00 FEET: THENCE NORTH 89°41'55" EAST A DISTANCE OF 136.15 FEET: THENCE SOUTH 57°52'30" EAST A DISTANCE OF 194.36 FEET: THENCE SOUTH 00°18'05" EAST A DISTANCE OF 285.92 FEET: THENCE SOUTH 89°41'55" WEST A DISTANCE OF 71.12 FEET: THENCE NORTH 48°55'41" WEST A DISTANCE OF 227.15 FEET: THENCE SOUTH 89°41'55" WEST A DISTANCE OF 58.42 FEET TO THE POINT OF BEGINNING.

CONTAINING IN ALL 86,951 SQ. FT. OR 2.00 ACRES, MORE OR LESS.
 SUBJECT TO ALL EASEMENTS, RESTRICTIONS, RESERVATIONS, AND RIGHTS- OF-WAY OF RECORD.

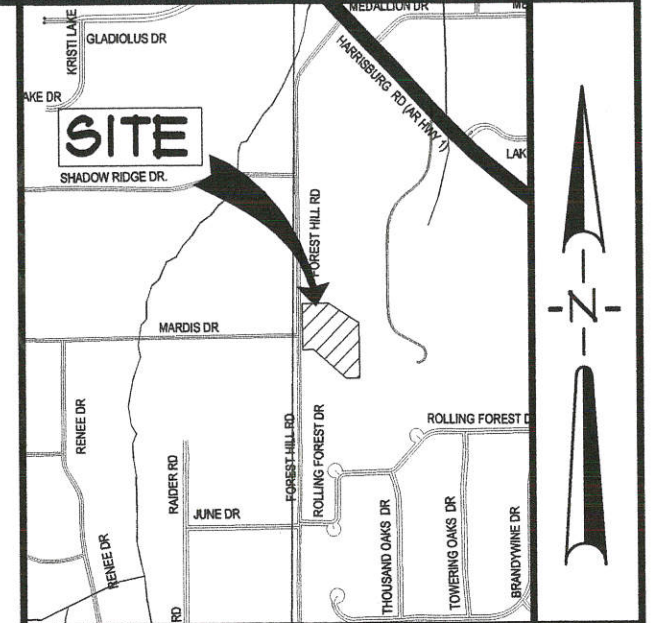

VICINITY SKETCH
NOT TO SCALE

SURVEYOR'S CERTIFICATION

I HEREBY CERTIFY THAT I, KEVIN L. SCRAPE HAS THIS DATE MADE A BOUNDARY SURVEY OF THE ABOVE DESCRIBED PROPERTY AS SHOWN HEREON AND THAT SAID SURVEY IS ACCURATE AND CORRECT TO THE BEST OF MY KNOWLEDGE AND BELIEF. THERE ARE NO APPARENT ABOVE GROUND ENCROACHMENTS OTHER THAN AS SHOWN OR STATED HEREON AND THAT THIS SURVEY WAS MADE IN ACCORDANCE WITH THE "ARKANSAS MINIMUM STANDARDS FOR PROPERTY AND PLATS" IN EFFECT ON THIS DATE.

DATE OF BOUNDARY SURVEY: 08/05/2013

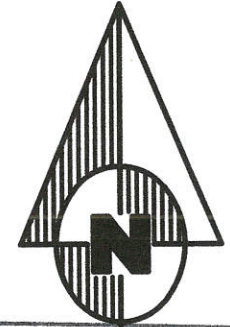

City of **Jonesboro** ARKANSAS
 DATE **8/7/13**
 FILE # **MP 13-22**
 FINAL APPROVAL
 PRELIMINARY (NOT FOR RECORDING)
 APPROVED BY: *[Signature]*
 PLANNING DEPT
 ENGINEERING DEPT



NOTE: TO BE VALID, COPIES MUST HAVE ORIGINAL SURVEYOR'S SIGNATURE AND SURVEYOR'S SEAL.

OWNER'S CERTIFICATION

WE HEREBY CERTIFY THAT WE ARE THE OWNERS OF PROPERTY AS DESCRIBED HEREON, THAT WE ADOPT THE PLAN OF SUBDIVISION AND DEDICATE THE PERPETUAL USE OF ALL STREETS AND EASEMENTS AS NOTED.

DAVID W. PERRY, EXECUTIVE DIRECTOR

LEGEND

- = BOUNDARY LINE
- F.I.P. = FOUND IRON PIPE
- S.I.P. = SET IRON PIPE W/ PLS #1631 CAP
- = EXISTING O/H ELECTRIC LINE
- = EXISTING SANITARY SEWER LINE
- = EXISTING U/G TELEPHONE LINE
- = EXISTING WATER LINE
- = EXISTING POWER POLE
- SSMH = EXISTING SANITARY SEWER MANHOLE
- = EXISTING WATER VALVE
- = EXISTING TELEPHONE PEDISTAL
- = EXISTING FIRE HYDRANT

BEARING BASIS

(STATE PLANE COORDINATES - ARKANSAS NORTH ZONE)

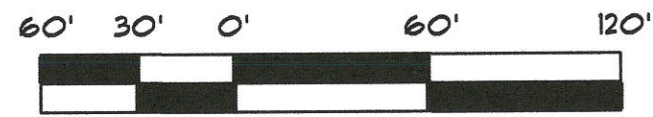

GRAPHIC SCALE

IN FEET

SURVEYOR'S NOTES

1. THIS SURVEY WAS PREPARED FOR ARKANSAS BAPTIST CHILDREN'S HOME.
2. THE FOLLOWING DOCUMENTS WERE USED TO CONDUCT THIS SURVEY:
 A. A SURVEY BY CLARENCE W. McALISTER DATED 02/10/2000,
 B. A SURVEY BY CLAY KENWARD DATED 05/16/84,

KEVIN L. SCRAPE, P.S.
 PROFESSIONAL SURVEYOR
 3901 MARDISWOOD COVE - JONESBORO, ARKANSAS
 PH: 870-243-1887

ARKANSAS BAPTIST CHILDREN'S HOME
 MINOR PLAT
 JONESBORO, ARKANSAS

DRAWN: KLS	CHECKED: KLS	DATE: 08/05/13	SHEET 1 OF 1
SCALE: 1" = 60'	CADD FILE: 13512	DWG#: 13512-04	