

PATSY HANSEN WOOD REQUESTS PERMISSION TO PLACE A MOBILE HOME ON A LOT LOCATED AT 801 Craighead Road CONTAINING ONE RESIDENTIAL STRUCTURE. PETITION REQUIREMENTS AND SETBACKS AS INDICATED ARE SUFFICIENT. PROPERTY IS ZONED RESIDENTIAL ONE (R-1)

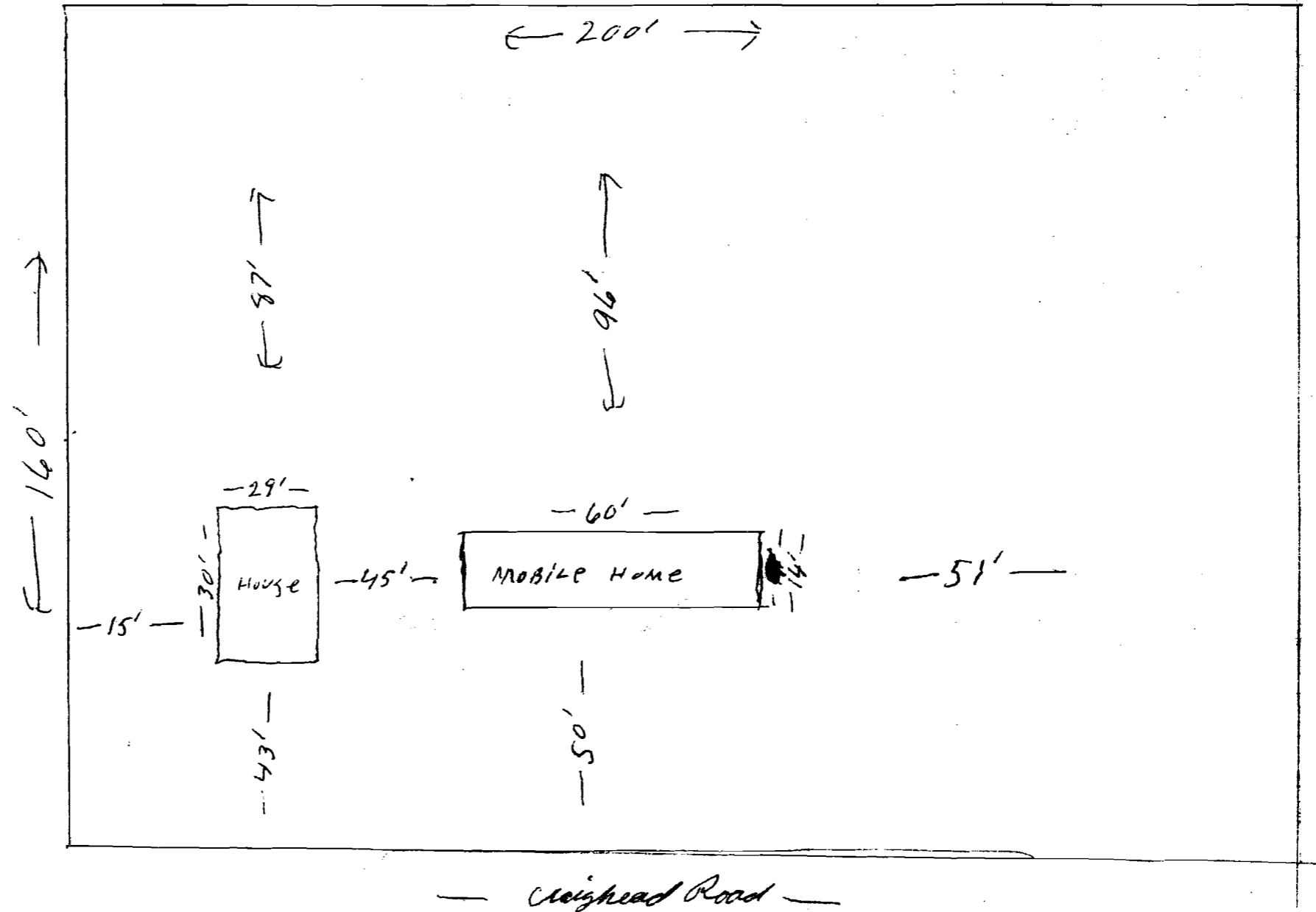

PETITION FOR LOCATING MOBILE HOMES
ON SINGLE LOTS INSIDE CITY

1. Obtain signatures of 65% of residents living within 600 feet of mobile home location.
2. Furnish plot plan.
3. Assess mobile home.
4. Obtain building permit.
5. Licensed electrician and plumber must be used.
6. Obtain moving permit when required.

DATE 9-27-1983

WE THE UNDERSIGNED DO HEREBY CONSENT THAT A MOBILE HOME MAY BE LOCATED AT

801 Craighood Road BY Patsy Hansen Wood

AND CERTIFY THAT WE ARE RESIDENTS IN THE NEIGHBORHOOD WITHIN SIX HUNDRED (600) FEET ON SUCH MOBILE HOME LOCATION.

*MOBILE HOMES TO BE PLACED ON LOTS WITH EXISTING STRUCTURE ARE GRANTED FOR THE USE OF THE IMMEDIATE FAMILY OF THE EXISTING STRUCTURE. THIS MOBILE HOME SHALL NOT BE USED AT ANY LATER DATE AS RENTAL PROPERTY.

NAME

ADDRESS

Mr Opal Inboden	749 Craighood Road
Carl W. Brooks	744 Craighood Rd
Ruby Coffey	742 Craighood Rd
Dorothy Sane	737 Craighood Rd
Janie Wilson	739 Craighood Rd
Walter McDaniel	734 Craighood
A J James	738 Craighood Rd
Becky Smith	740 Craighood Rd
Clara Lousaly	901 Twin Oaks
Dona McClint	814 Craighood Rd
Allen Mc Clint	816 Craighood Road
Betty Jones	2710 Wood St.
Jack R. Jones	2710 Wood St
Deane Brogdon	746 Craighood Rd.
Lois Brogdon	746 Craighood Rd.
Larry Rice	911 Twin Oaks
Wm. S. Swain	907 Twin Oaks
Sandra Clark	915 Twin Oaks
Ella L. Williams	921 Twin Oaks