

AG-1

N89°17'20"E 1319.50'

PIPE

ASSURANCE

N-1

DRAINAGE DITCH

1307.08'

N40°01'16"W

MOORE'S DITCH

6.3'

ZONING REQUESTED I-1

AG-1

1306.24'

S89°07'35"E

R-2

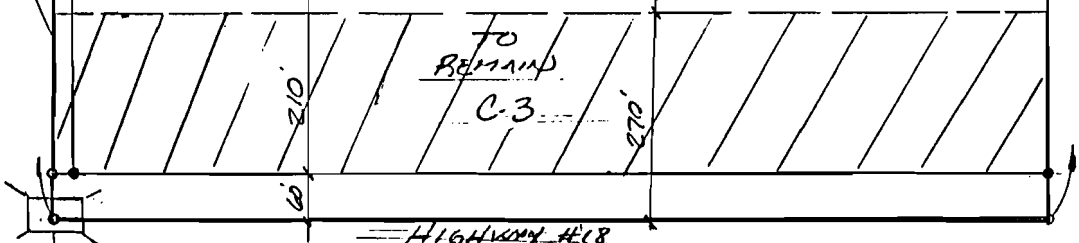
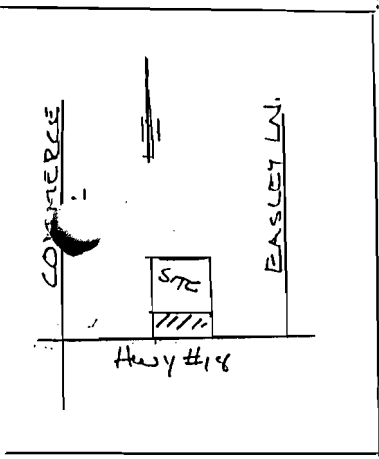

HIGHWAY #18

S89°10'00"W

AG-1

C-3

J AND R INDUSTRIAL DEVELOPEMENT
 REQUEST REZONING OF
 SOUTHEAST QUARTER OF THE SOUTHWEST QUARTER OF
 OF SECTION 24, TOWNSHIP 14 NORTH, Range 4 EAST, CRAIGHEAD COUNTY,
 ARKANSAS AND LESS AND EXCEPT THE SOUTH 270 FEET OF SAID
 SOUTHEAST QUARTER OF THE SOUTHWEST QUARTER TO REMAIN C-3

I-1 ZONING REQUESTED

AG-1 to I-1

H10
 RZ96-42

206 units + 37 = 243