

FLOOD PLAIN: THIS TRACT DOES LIE WITHIN THE 100-YR FLOOD PLAIN PER FLOOD INSURANCE RATE MAP OF CRAIGHEAD CO., ARK. AND INCORPORATED AREAS. COMMUNITY PANEL NO. 05031C0132 C. DATED 09/27/91. THIS TRACT DOES LIE WITHIN A ZONE "X" FLOOD PLAIN. PER THE MAP REFERENCED ABOVE.

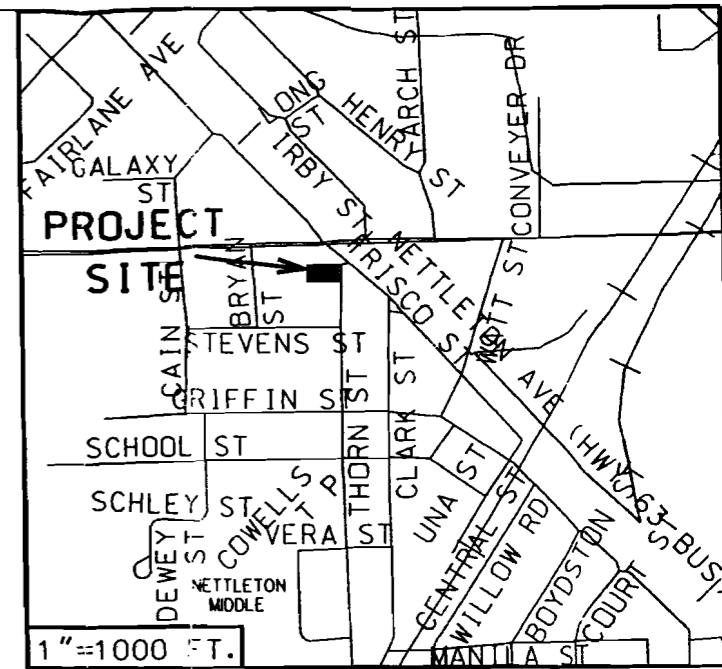

LEGAL DESCRIPTION:
The North Half of Lot 8 of Thorn's Addition to the City of Jonesboro, Ark. as shown by plat in Deed Record 20 page 125 in the office of the Circuit Court Clerk and Ex-Officio Recorder, Craighead County, Jonesboro, Arkansas.

OWNER'S CERTIFICATION:
We hereby certify that we are the owners of the property shown and described hereon, that we adopt the plan of subdivision and dedicate perpetual use of all streets and easements as noted.

[Handwritten Signature]

CERTIFICATE OF SURVEY:

To all parties interested in Title to these premises: I hereby certify that I have prior to this day made a survey of the above described property as shown on the Plat of Survey hereon. The property lines and corner monuments, to the best of my knowledge and ability, are correctly established. Encroachments, if any, as disclosed by Survey, are shown hereon.

By *[Handwritten Signature]* Date _____
George M. Hamman
R.L.S. #1273
REGISTERED
STATE OF ARKANSAS
NO. 1173
PROFESSIONAL LAND SURVEYOR
GEORGE M. HAMMAN

**EXISTING C-3 ZONING
REQUESTED R-2 ZONING**

HNE ENGINEERS - SURVEYORS
2311 E. NETTLETON AVE.
JONESBORO, AR 72401
HAMMAN NEWELL ENGINEERING (870) 932-7880

REZONING PLAT
NO. LOT 8, THORN'S ADDN.
FOR
MAX DACUS, JR.
JONESBORO, ARKANSAS

JOB NO. 105005 DATE 01-17-05
© 2005, Hamman Newell Engineering RE
ONLY COPIES WITH VIOLET COLORED SIGNATURE
ARE VALID HNE COPIES **DRWR 5**