

NOTES:

- 1) THIS SURVEY AND PLAT ARE THE PROPERTY OF THE SURVEYOR AND ARE INTENDED FOR THE SOLE USE AND BENEFIT OF THE SURVEYOR & CLIENT.
- 2) THIS SURVEY WAS COMPLETED USING A PENTAX PCS-2S AND HAS A CLOSURE PRECISION OF 1' IN 100,000', AND AN ANGULAR ERROR OF 00°00'00" PER ANGLE, AND WAS NOT ADJUSTED.
- 3) THE CLOSURE PRECISION OF THE PLAT IS IN EXCESS OF 1' IN 15,000'.
- 4) THE RESEARCH COMPLETED FOR THIS SURVEY INCLUDES LEGAL DESCRIPTION PROVIDED, OUR OWN RESEARCH AT THE COURTHOUSE.
- 5) ALL PINS SET ARE 1/2" REBAR, UNLESS NOTED OTHERWISE.
- 6) OWNER: GARY EZELL
- 7) FLOOD PLAIN: THIS TRACT DOES NOT LIE WITHIN THE 100-YR FLOOD PLAIN PER FLOOD INSURANCE RATE MAP OF CRAIGHEAD CO., ARK. AND INCORPORATED AREAS, COMMUNITY PANEL NO. 05031C0131 C, DATED 09/27/91. THIS TRACT DOES LIE WITHIN A ZONE "X" FLOOD PLAIN, PER THE MAP REFERENCED ABOVE.

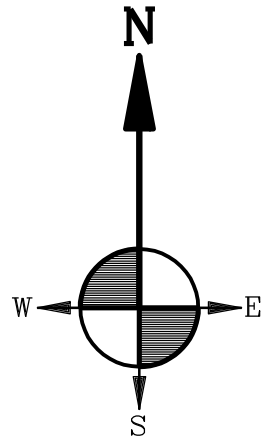

Scale: 1"=200 ft.

EXISTING R-1 ZONING
REQUESTED C-3 ZONING

OWNER'S CERTIFICATION:

We hereby certify that we are the owners of the property shown and described hereon, that we adopt the plan of subdivision and dedicate perpetual use of all streets and easements as noted.

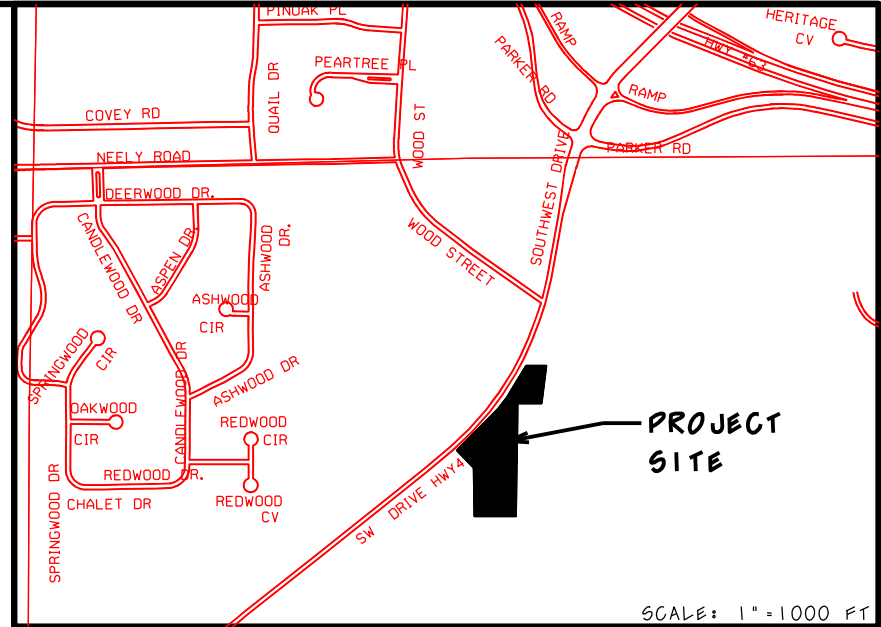

CERTIFICATE OF SURVEY:

To all parties interested in Title to these premises: I hereby certify that I have prior to this day made a survey of the above described property as shown on the Plat of Survey hereon. The property lines and corner monuments, to the best of my knowledge and ability, are correctly established: the improvements are as shown on the Plat of Survey. Encroachments, if any, as disclosed by Survey, are shown hereon.

By _____ Date _____
George M. Hamman
R.L.S.

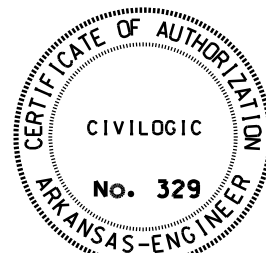
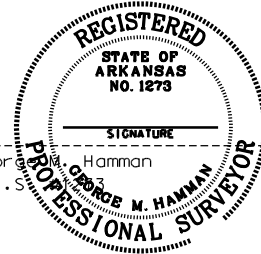

Civilogic

ENGINEERS - SURVEYORS
203 SOUTHWEST DR.
JONESBORO, AR 72401
(870) 932-7880

REZONING PLAT
LOT 2, EZELL SOUTHWEST DRIVE
MINOR PLAT
JONESBORO, ARKANSAS

JOB NO. 106148 DATE 05-11-07

© 2006, Civilogic

RE

ONLY COPIES WITH VIOLET COLORED SIGNATURE
ARE VALID CIVIOLOGIC COPIES

DRWR 5