

GRAPHIC SCALE 1"=50'

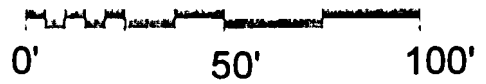

20' DRAINAGE EASEMENT

Curve	Delta Angle	Radius	Arc
1	1°55'27"	641.22	21.5

C/L FAIRMONT DR.

C/L KEYSTONE DR.

DESCRIPTION: 20' DRAINAGE Easement

A PART OF THE NORTHWEST QUARTER OF SECTION 8, TOWNSHIP 14 NORTH, RANGE 4 EAST, CRAIGHEAD COUNTY, ARKANSAS AND BEING MORE PARTICULARLY AS FOLLOWS.

Beginning at the Southwest corner of Lot 7 in Block "D" of Forest Green Subdivision, Phase III to the City of Jonesboro, Arkansas; thence along a curve to the left having a Delta 0°00'00" and a length 21.53 feet, thence North 1°42'57" East 237.44 feet, thence North 54°27'38" East 25.13 feet, thence South 1°42'57" West 260.63 feet to the point of beginning proper.

OWNER CERTIFICATION

We hereby certify that we are the owners of the property shown and described hereon and that we adopt the plan of Subdivision and dedicated perpetual use of all Streets and easements as noted

SURVEYORS CERTIFICATION

This is to certify that I have on this date, surveyed the above described property in accordance with Monuments found and this plan conforms to that survey

08/02/2001

DATE

HERBERT HIME
LAND SURVEYING
8000 EAST JOHNSON AVE
JONESBORO, ARKANSAS 72401

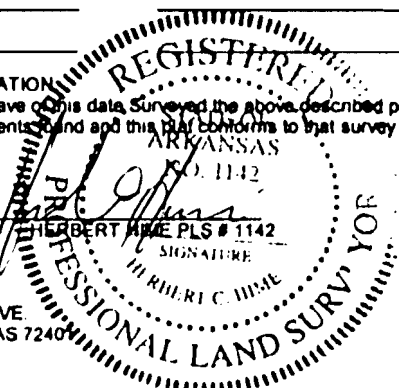

THOMAS GREEN

FAIRMONT

HWY 141