

NE COR. LOT 97 COLLEGE PLACE SUBDIVISION  
(NE COR. LOT 4 TERRACE APTS. 2nd REPLAT OF PART OF COLLEGE PLACE SUB.)

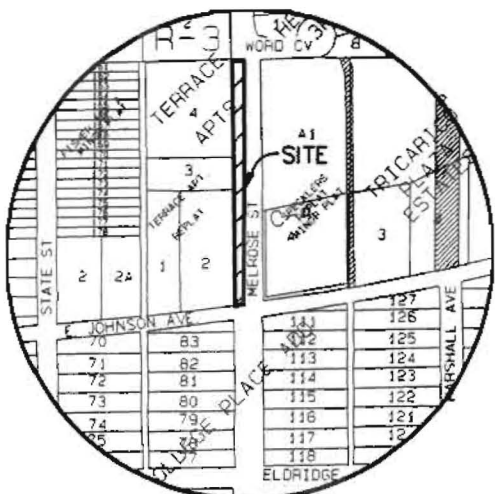

ASSUMED



VICINITY MAP  
NTS

ALLEY

TERRACE APTS. 2nd REPLAT OF PART OF COLLEGE PLACE SUB

N89°35'00"E  
15.00'

EXISTING  
60'

30' 30'

EXISTING  
75'

30' ASPHALT  
PAVING

N00°00'00"E  
626.00'

625.37'  
S00°00'00"W

Φ MELROSE ST.

CHORD:  
S87°11'36"W  
15.02'  
R=2817.32'  
L=15.02'

Φ JOHNSON  
AVE.

**LEGAL DESCRIPTION:**

THE WESTERLY 15.0' OF MELROSE STREET RIGHT OF WAY LYING ADJACENT TO THE TERRACE APARTMENTS SECOND REPLAT OF A PART OF COLLEGE PLACE SUBDIVISION OF JONESBORO, CRAIGHEAD COUNTY, ARKANSAS BEING MORE PARTICULARLY DESCRIBED AS FOLLOWS:

BEGIN AT THE NORTHEAST CORNER OF LOT 97 OF THE COLLEGE PLACE SUBDIVISION OF JONESBORO, CRAIGHEAD COUNTY, ARKANSAS, THENCE; N89°35'00"E - 15.00'; THENCE S0°00'00"W - 625.37 TO A POINT ON THE NORTH RIGHT OF WAY OF JOHNSON AVENUE BEING ON A CURVE TO THE RIGHT WHOSE RADIUS EQUALS 2817.83'; THENCE ALONG SAID CURVE (CHORD BEARS S87°11'36"W - 15.02') A DISTANCE OF 15.02'; THENCE N0°00'00"E - 626.00' TO THE POINT OF BEGINNING CONTAINING 9385.40 SQUARE FEET MORE OR LESS SUBJECT TO ALL RIGHTS OF WAY AND EASEMENTS OF RECORD.



GRAPHIC SCALE 1"=100'

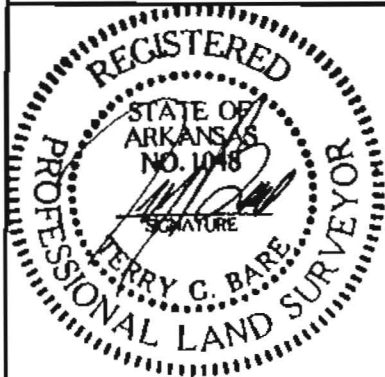

CLIENT  
BRIAN GIBBS COMPANIES

**STREET ABANDONMENT**

THE WESTERLY 15.0' OF STREET RIGHT OF WAY LYING ADJACENT TO THE TERRACE APARTMENTS 2nd REPLAT OF COLLEGE PLACE SUB. OF JONESBORO, CRAIGHEAD CO., ARKANSAS

**HAYWOOD, KENWARD, BARE & ASSOCIATES, INC.**

CIVIL ENGINEERING - SURVEYING - PLANNING  
3301 E. HIGHLAND DRIVE  
JONESBORO, ARKANSAS 72401  
TEL 870-932-2019 FAX 870-932-1076

REVISIONS

DATE	BY	DESCRIPTION

DRAWN BY J.D.G.	SHEET 1 OF 1
DATE 04/10/00	SCALE 1"=100'
JOB NO. 200227	DRAWING NO. Q-107