

C-3

C-3

HIGHLAND DR.

EXISTING ZONING AG-1.  
MAPC RECOMMENDATION TO APPROVE AS C-3 L.U. ON 03-11-14.  
CITY COUNCIL 1ST READING & WAIVED 2ND READING 03-18-14.  
CITY COUNCIL 3RD READING SCHEDULED FOR 04-01-14.

1 C-3

5

AG-1

I-2

2 C-3

2005 MARGO LN.  
22034.8 SQ. FT.  
0.51 ACRES

I-1

I-2

2008 COMMERCE DR.  
18956.4 SQ. FT.  
0.44 ACRES

2009 MARGO LN.  
22066.4 SQ. FT.  
0.51 ACRES

I-1

I-2

2010 COMMERCE DR.  
18894.2 SQ. FT.  
0.43 ACRES

AG-1

I-1

AG-1

AG-1

NOTES:

- 1) ALL BEARINGS ARE BASED ON ARKANSAS NORTH STATE PLANE COORDINATE SYSTEM.
- 2) THE CLOSURE PRECISION OF THE PLAT IS IN EXCESS OF: LOT 3 - 1' IN 500,000'.  
LOT 4 - 1' IN 120,000'.  
LOT 6 - 1' IN 190,000'.  
LOT 7 - 1' IN 500,000'.
- 3) THE RESEARCH COMPLETED FOR THIS SURVEY INCLUDES LEGAL DESCRIPTION PROVIDED.
- 4) ALL CORNER MONUMENTS SET ARE 3/8" REBAR, UNLESS OTHERWISE NOTED.
- 5) OWNER: JACK AND JANE ELAM
- 6) FLOOD PLAIN: ALL FOUR LOTS LIE WITHIN THE 100-YR FLOOD PLAIN PER FLOOD INSURANCE RATE MAP OF CRAIGHEAD CO., AR, AND INCORPORATED AREAS, COMMUNITY PANEL NO. 05031C0151 C, DATED 09/27/91.

CERTIFICATE OF SURVEY:

To all parties interested in Title to these premises: I hereby certify that I have prior to this day made a survey of the above described property as shown on the Plat of Survey hereon. The property lines and corner monuments, to the best of my knowledge and ability, are correctly established: the improvements are as shown on the Plat of Survey. Encroachments, if any, as disclosed by Survey, are shown hereon.

REZONING REQUEST

2008 COMMERCE DR. - EXISTING: AG-1  
2010 COMMERCE DR. - EXISTING: AG-1  
2005 MARGO LN. - EXISTING: AG-1  
2009 MARGO LN. - EXISTING: AG-1  
REQUESTED ALL: C-3 L.U.

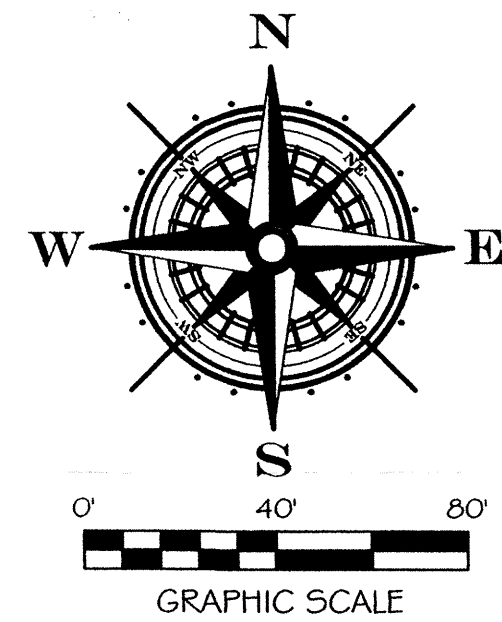
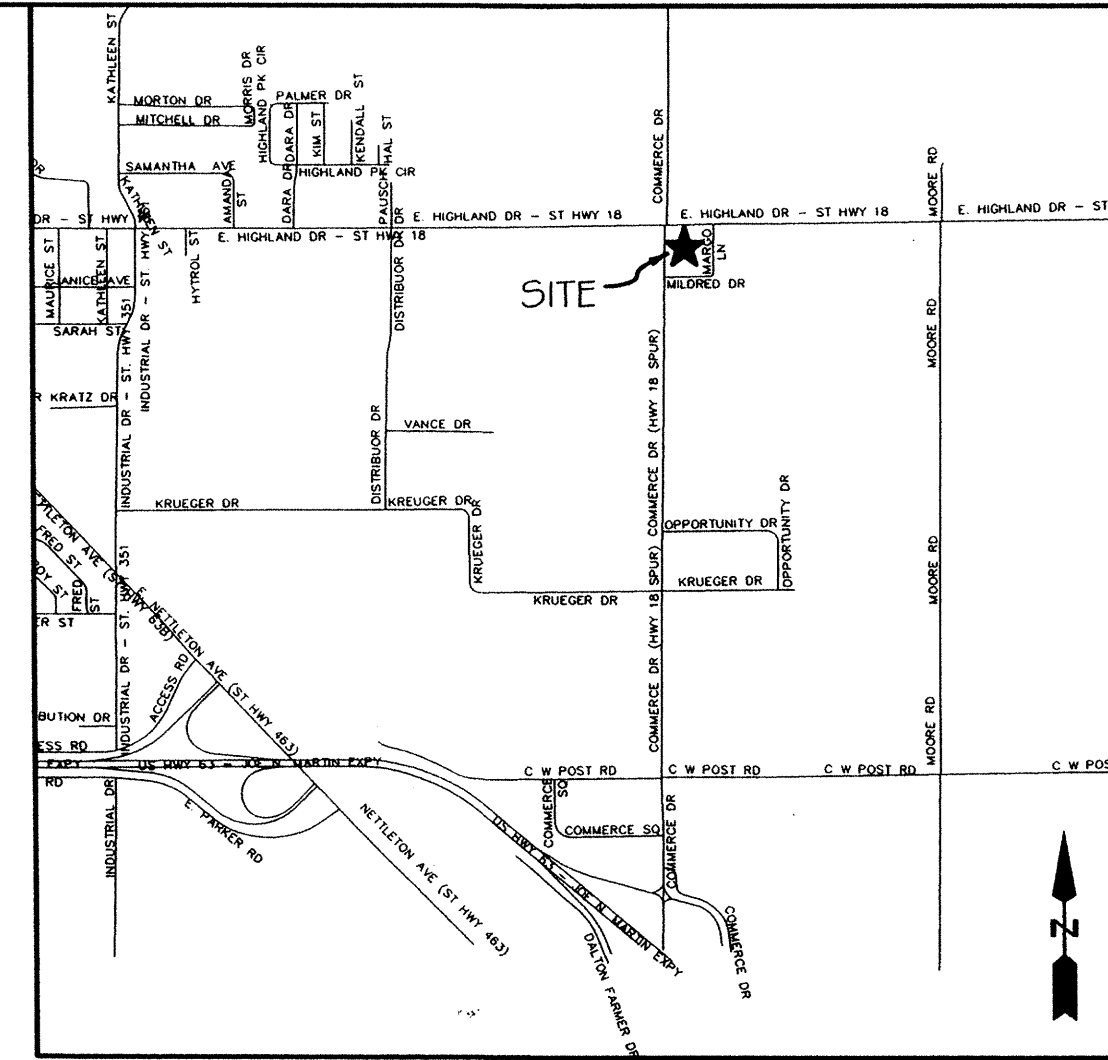

LEGAL DESCRIPTION:

**2008 COMMERCE DR.:**  
Lot 3 in Block "A", of Lazy Acres, Craighead County, Arkansas, the same being a part of the Northwest Quarter of the Northwest Quarter of Section 25, Township 14 North, Range 4 East, subject to all easements of record.  
AND  
**2010 COMMERCE DR.**  
Lot 4 in Block "A", of Lazy Acres, Craighead County, Arkansas, the same being a part of the Northwest Quarter of the Northwest Quarter of Section 25, Township 14 North, Range 4 East, subject to all easements of record.  
AND  
**2005 MARGO LANE:**  
Lot 6 in Block "A", of Lazy Acres, Craighead County, Arkansas, the same being a part of the Northwest Quarter of the Northwest Quarter of Section 25, Township 14 North, Range 4 East, subject to all easements of record.  
AND  
**2009 MARGO LANE:**  
Lot 7 in Block "A", of Lazy Acres, Craighead County, Arkansas, the same being a part of the Northwest Quarter of the Northwest Quarter of Section 25, Township 14 North, Range 4 East, subject to all easements of record.

Drawn By: RE	Checked by: GH
Date: 03-20-14	Job No. 114026
Scale: 1" = 40'	Sheet No.
Township: 14N	Range: 04E
Section: 25	County: CRAIGHEAD
	1 of 1

ENGINEERS PLANNERS SURVEYORS

**Civilogic**

203 Southwest Dr., Jonesboro, AR - (870) 932-7880 - www.civilogic.net

**REZONING PLAT**  
FOR  
**BERK, JOHNSON, SUMMERS,  
& BEASON**  
JONESBORO, ARKANSAS

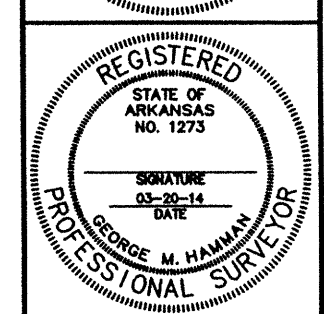
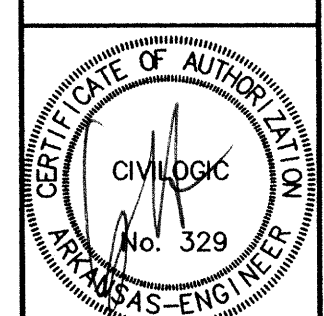

SHEET NUMBER  
**1 of 1**