

**DESCRIPTION OF AREA TO BE REZONED**

The area to be rezoned is located in the northeast corner of the intersection of Highland Drive and Arkansas State Highway No. 112. The area is currently zoned I-2 and is being rezoned to A-1. The area is bounded by Highland Drive to the north, Arkansas State Highway No. 112 to the east, and an unnamed road to the south and west.

**OWNER'S CERTIFICATION**

I, *W. Blum*, the owner of the above described property, hereby certify that the information provided in this application is true and correct to the best of my knowledge and belief.

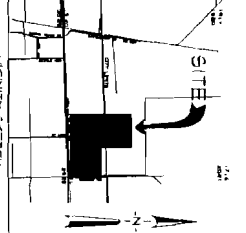

**VICINITY SKETCH**

- LEGEND**
- Site
  - Highway
  - Other

**DESCRIPTION**

The area to be rezoned is located in the northeast corner of the intersection of Highland Drive and Arkansas State Highway No. 112. The area is currently zoned I-2 and is being rezoned to A-1. The area is bounded by Highland Drive to the north, Arkansas State Highway No. 112 to the east, and an unnamed road to the south and west.

**SUBMITTER'S CERTIFICATION**

I, *W. Blum*, the submitter of this application, hereby certify that the information provided in this application is true and correct to the best of my knowledge and belief.

ASSOCIATED ENGINEERING AND SURVEYING, INC.  
 REGISTERED PROFESSIONAL ENGINEERS AND SURVEYORS  
 1100 N. W. 11th St., Ft. Lauderdale, FL 33304  
 PHONE: (305) 441-1111  
 FAX: (305) 441-1112  
 WEBSITE: WWW.AESINC.COM