

NORTH 1/4 COR.
SEC.29, T-14-R4
P.O.B.

BEARINGS BASED ON PREVIOUS SURVEY
DATED 06/23/03.

CERTIFICATE OF SURVEY:

THIS IS TO CERTIFY THAT HAYWOOD, KENWARD, BARE AND ASSOCIATES INC., PROFESSIONAL LAND SURVEYORS HAVE SURVEYED THE FOLLOWING PARCEL OF LAND:

A PART OF THE NORTHEAST QUARTER OF THE NORTHWEST QUARTER OF SECTION 29, TOWNSHIP 14 NORTH, RANGE 04 EAST, JONESBORO, CRAIGHEAD COUNTY, ARKANSAS, BEING MORE PARTICULARLY DESCRIBED AS FOLLOWS:

TRACT 1

BEGIN AT THE NORTH QUARTER CORNER OF SECTION 29, TOWNSHIP 14 NORTH, RANGE 04 EAST, JONESBORO, CRAIGHEAD COUNTY, ARKANSAS: THENCE SOUTH 01°00'18" WEST, 1316.75 FEET; THENCE SOUTH 89°54'02" WEST, 659.55 FEET; THENCE CONTINUE SOUTH 89°54'02" WEST, 329.78 FEET; THENCE NORTH 00°59'03" EAST, 851.94 FEET, TO THE POINT OF BEGINNING PROPER (1); THENCE CONTINUE NORTH 00°59'03" EAST, 400.05 FEET, TO THE SOUTH RIGHT OF WAY LINE OF ARKANSAS HIGHWAY 18; THENCE ALONG SAID RIGHT OF WAY LINE AS FOLLOWS; SOUTH 89°55'24" EAST, 318.12 FEET; SOUTH 83°18'56" EAST, 11.52 FEET; THENCE SOUTH 00°58'35" WEST, DEPARTING SAID RIGHT OF WAY LINE, 398.72 FEET; THENCE NORTH 89°55'24" WEST, TO THE POINT OF BEGINNING PROPER (1), CONTAINING 3.03 ACRES MORE OR LESS, SUBJECT TO ALL RIGHTS-OF-WAY AND EASEMENTS OF RECORD.

TRACT 2

BEGIN AT THE NORTH QUARTER CORNER OF SECTION 29, TOWNSHIP 14 NORTH, RANGE 04 EAST, JONESBORO, CRAIGHEAD COUNTY, ARKANSAS: THENCE SOUTH 01°00'18" WEST, 1316.75 FEET; THENCE SOUTH 89°54'02" WEST, 659.55 FEET, TO THE POINT OF BEGINNING PROPER (2); THENCE CONTINUE SOUTH 89°54'02" WEST, 329.78 FEET; THENCE NORTH 00°59'03" EAST, 851.94 FEET; THENCE SOUTH 89°55'24" EAST, 329.64 FEET; THENCE SOUTH 00°58'35" WEST, 850.93 FEET; TO THE POINT OF BEGINNING PROPER (2), CONTAINING 6.44 ACRES MORE OR LESS, SUBJECT TO ALL RIGHTS-OF-WAY AND EASEMENTS OF RECORD.

OWNERS CERTIFICATION:

I HEREBY CERTIFY THAT I AM THE OWNER OF THE ABOVE DESCRIBED PROPERTY AND I HEREBY REQUEST A REZONING FROM (R-1) SINGLE FAMILY MEDIUM DENSITY DISTRICT TO (C-4 LU-O) NEIGHBORHOOD COMMERCIAL DISTRICT - LIMITED USE OVERLAY

SIGNED THIS 17TH DAY OF MARCH, 2009

Dorothy Hill
DOROTHY HILL
Connie Woods
CONNIE WOODS

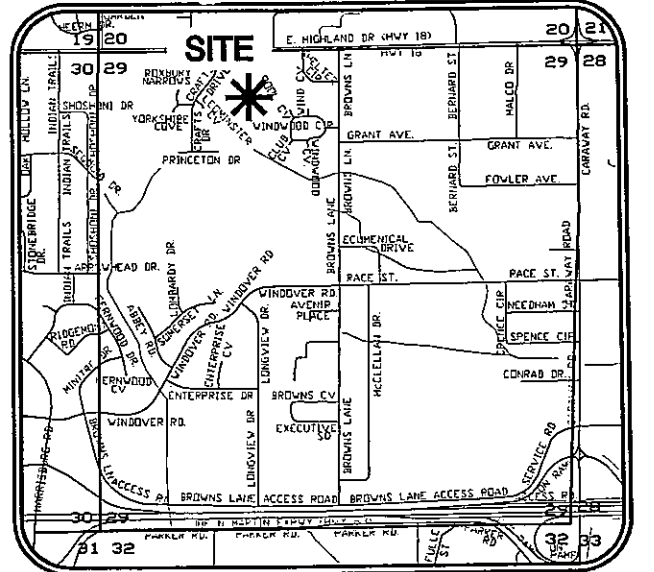
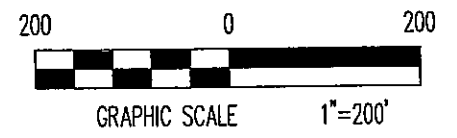

VICINITY MAP

(NOT TO SCALE)

LEGEND:

- FOUND MONUMENT (AS NOTED)
- SET 5/8" REBAR W/ CAP
- △ COMPUTED POINT (NOT MONUMENTED)

TRACT 1:
C-4 LU-O TO INCLUDE:
AUTOMATED TELLER MACHINE
BANK OR FINANCIAL INSTITUTION
MEDICAL SERVICE / OFFICE
OFFICE / GENERAL
RESTAURANT / GENERAL
RETAIL / SERVICE

TRACT 2:
C-4 LU-O TO INCLUDE:
AUTOMATED TELLER MACHINE
BANK OR FINANCIAL INSTITUTION
MEDICAL SERVICE / OFFICE
OFFICE / GENERAL
SERVICE

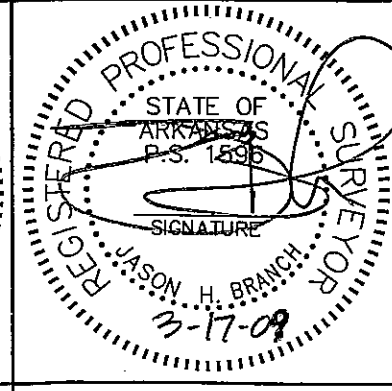
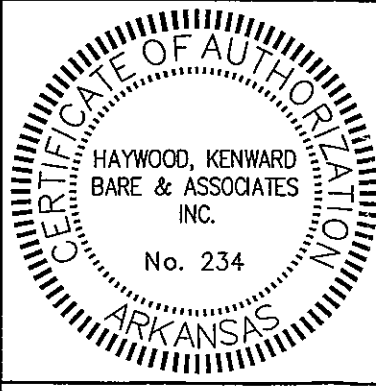

REZONING PLAT

A PART OF THE NORTHEAST QUARTER OF THE NORTHWEST QUARTER OF SECTION 29, TOWNSHIP 14 NORTH, RANGE 4 EAST, JONESBORO, CRAIGHEAD COUNTY, ARKANSAS

HAYWOOD, KENWARD, BARE & ASSOCIATES, INC.
CIVIL ENGINEERING - SURVEYING - PLANNING
1801 LATOURETTE DRIVE
JONESBORO, ARKANSAS 72404
TEL 870-932-2019 FAX 870-932-1076

REVISIONS		
DATE	BY	DESCRIPTION
SURVEY INDEX CODE		
PROJECT NO. H027-0002-12		
DRAWN BY JHB	CHECKED BY JEB	
SHEET 1 OF 1	SCALE 1"=200'	
DATE 03/17/09	DRAWING NO. B-151	

COPYRIGHT 2008, ALL RIGHTS RESERVED

CLIENT
DOROTHY HILL & CONNIE WOODS

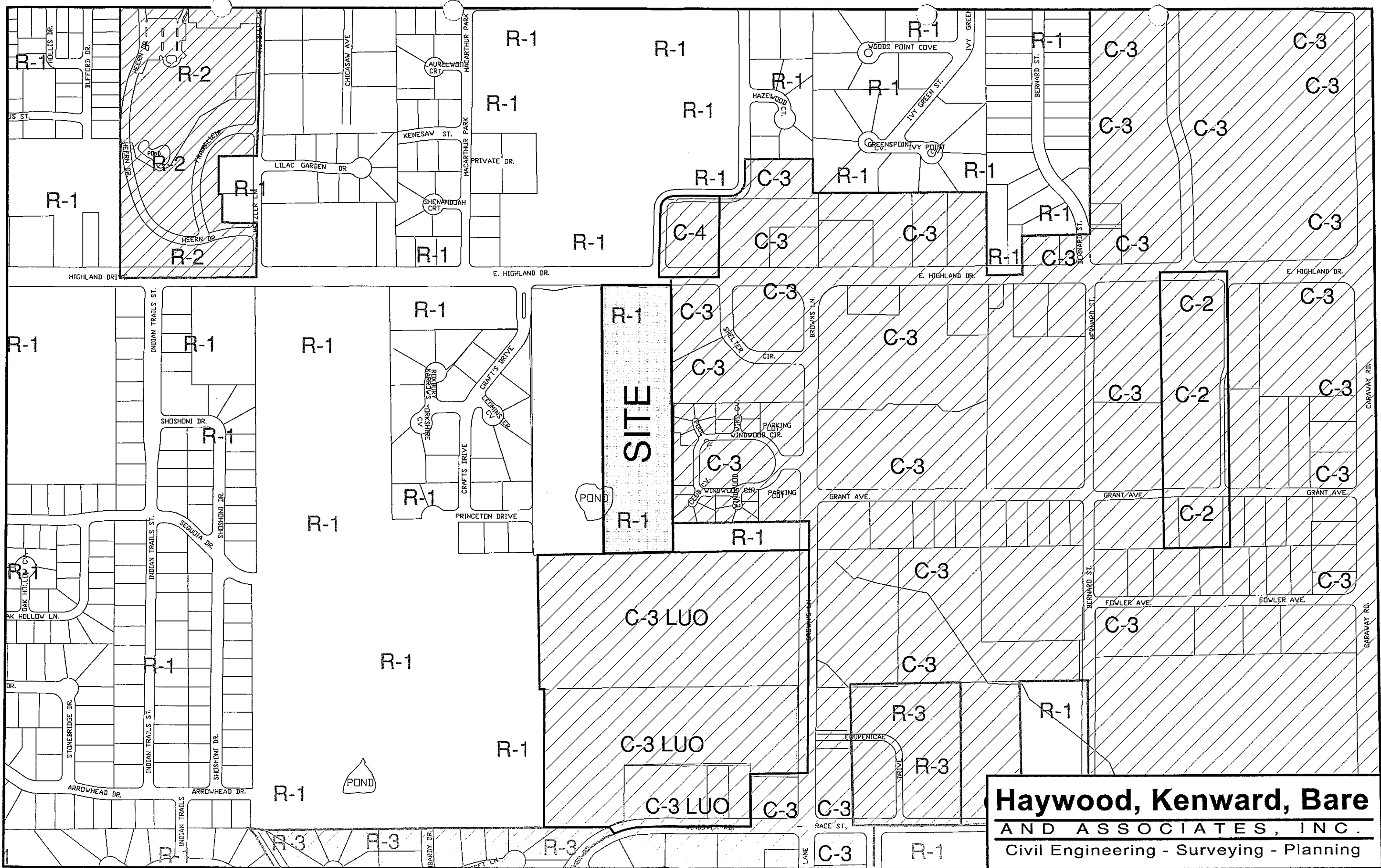

Haywood, Kenward, Bare
 AND ASSOCIATES, INC.
 Civil Engineering - Surveying - Planning