



AIA® Document G701™ – 2017

Change Order

PROJECT: (Name and address)
Cemetery Maintenance Building
City of Jonesboro
Jonesboro, Arkansas

CONTRACT INFORMATION:
Contract For: General Construction
Date: September 08, 2017

CHANGE ORDER INFORMATION:
Change Order Number: 001
Date:

OWNER: (Name and address)
City of Jonesboro
300 South Church Street
Jonesboro, Arkansas 72401

ARCHITECT: (Name and address)
Brackett-Krennerich & Associates P.A.
100 E. Huntington Ave. Suite D
Jonesboro, AR 72401

CONTRACTOR: (Name and address)
AWT Constructors, LLC
2629 Hwy 91 W
Jonesboro, AR 72404

THE CONTRACT IS CHANGED AS FOLLOWS:

(Insert a detailed description of the change and, if applicable, attach or reference specific exhibits. Also include agreed upon adjustments attributable to executed Construction Change Directives.)

Complete site work in accordance with plan sheet C001 revised 01-26-18.....Add \$63,734.90
(See attached documentation for details/breakdown)

The original Contract Sum was	\$	485,880.00
The net change by previously authorized Change Orders	\$	0.00
The Contract Sum prior to this Change Order was	\$	485,880.00
The Contract Sum will be increased by this Change Order in the amount of	\$	63,734.90
The new Contract Sum including this Change Order will be	\$	549,614.90

The Contract Time will be increased by Thirty (30) days.
The new date of Substantial Completion will be May 9, 2018

NOTE: This Change Order does not include adjustments to the Contract Sum or Guaranteed Maximum Price, or the Contract Time, that have been authorized by Construction Change Directive until the cost and time have been agreed upon by both the Owner and Contractor, in which case a Change Order is executed to supersede the Construction Change Directive.

NOT VALID UNTIL SIGNED BY THE ARCHITECT, CONTRACTOR AND OWNER.

Brackett-Krennerich & Associates P.A.
ARCHITECT (Firm name)

SIGNATURE

Kyle Cook, President
PRINTED NAME AND TITLE

February 9, 2018
DATE

AWT Constructors, LLC
CONTRACTOR (Firm name)

SIGNATURE

Wayne Tate
PRINTED NAME AND TITLE

2-9-18
DATE

City of Jonesboro
OWNER (Firm name)

SIGNATURE

Mayor Harold Perrin, Mayor
PRINTED NAME AND TITLE

DATE



February 6, 2018

Kyle Cook

Brackett Krennerich Architects

RE: Cemetery Maintenance Building

Change order request

Complete site work in accordance with plan sheet C001 revised 01-26-18

1. Additional fill and grading	400.00
2. Concrete curb and gutter, walk and swale	15,972.00
3. Asphalt and markings	24,848.00
4. Sod, seeding and topsoil	5,502.00
5. Parking bumpers (7)	292.00
6. Remove tree	300.00
7. Layout	500.00
8. Testing	250.00
9. Circuit for water heater	450.00
10. Circuit for grinder pump	3015.00
11. Supervision and job overhead	5500.00

Total cost 57,029.00

Plus 10% overhead and profit 5702.90

Plus additional bond and insurance 1003.00

Total this request **63,734.90**

For your consideration

Wayne Tate

Wayne Tate



**BRACKETT
KRENNERICH**

architects

Architect's Proposal Request (PR)

Project:	Cemetery Maintenance Building	PR #	One (1)
	City of Jonesboro	Project #	10217
	Jonesboro, Arkansas	Date	01.29.18

Owner:	City of Jonesboro	Architect:	Brackett-Krennerich & Associates P.A. 100 E. Huntington Ave. Suite D Jonesboro, AR 72401
---------------	-------------------	-------------------	---

Attn: Wixson Huffstetler – Owners Representative
Craig Light – Owners Representative

Contractor: AWT Constructors, LLC
2629 Hwy 91 W
Jonesboro, AR 72404

- Owner (email)
- Contractor (email)
- Consultant (email)
- Field (email)
- Other _____ (email)

Attn: Wayne Tate

Please submit an itemized quotation fro changes in the Contract Sum and/or Time incidental to proposed modifications to the Contract Documents described herein. **This is not a change order nor a direction to proceed with the work described herein.**

Description:

Exterior Site Improvements

The attached site plan and grading plan indicate modifications to the initial scope of work. The modifications are indicated as "delta 4" on the attached C001 drawings, as well as, modified grading to the site.

1. Omit gutter edge detail in areas shown and provide curb and gutter (detail 3/C001). Gutter edge condition to remain at drainage swale area.
2. Omit parking space and bumper where indicated and relocate another parking space to the east side of accessible parking area as indicated.
3. Provide asphalt paving at south side of building in lieu of crushed stone.
4. Provide new concrete curb and gutter along edge of newly paved south parking area.

Attachments: *(List documents that support description)*

C001 – Site Plan (Architectural)

C002 – Site Development Plan (Grading Plan)

Issued by:

Kyle Cook, A.I.A. (Architect)

(Printed name and title)

Task	Rev	Checked	Rev	Date
1	01/28/18	PK	01/28/18	PK
2	01/28/18	PK	01/28/18	PK
3	01/28/18	PK	01/28/18	PK
4	01/28/18	PK	01/28/18	PK
5	01/28/18	PK	01/28/18	PK
6	01/28/18	PK	01/28/18	PK
7	01/28/18	PK	01/28/18	PK
8	01/28/18	PK	01/28/18	PK
9	01/28/18	PK	01/28/18	PK
10	01/28/18	PK	01/28/18	PK

Commission Number
10217
C002
Date: May 30, 2017

ASSOCIATED ENGINEERING, LLC
CIVIL ENGINEERING • LAND SURVEYING
LAND PLANNING
103 SOUTH UNIVERSITY STREET, SUITE 200, BOX 1462
JONESBORO, ARKANSAS 72402
PH: 870-932-3594 • FAX: 870-935-1263



EROSION CONTROL MEASURES

1. THE SLOPE OF THE EROSION CONTROL MEASURES SHALL BE SUFFICIENT TO PREVENT EROSION AND TO MAINTAIN THE MEASURES IN PLACE FOR THE DURATION OF THE CONSTRUCTION PERIOD. THE MEASURES SHALL BE MAINTAINED THROUGHOUT THE CONSTRUCTION PERIOD AND SHALL BE REMOVED IMMEDIATELY UPON COMPLETION OF CONSTRUCTION.
2. EROSION CONTROL MEASURES SHALL BE MAINTAINED THROUGHOUT THE CONSTRUCTION PERIOD AND SHALL BE REMOVED IMMEDIATELY UPON COMPLETION OF CONSTRUCTION.
3. EROSION CONTROL MEASURES SHALL BE MAINTAINED THROUGHOUT THE CONSTRUCTION PERIOD AND SHALL BE REMOVED IMMEDIATELY UPON COMPLETION OF CONSTRUCTION.
4. EROSION CONTROL MEASURES SHALL BE MAINTAINED THROUGHOUT THE CONSTRUCTION PERIOD AND SHALL BE REMOVED IMMEDIATELY UPON COMPLETION OF CONSTRUCTION.
5. EROSION CONTROL MEASURES SHALL BE MAINTAINED THROUGHOUT THE CONSTRUCTION PERIOD AND SHALL BE REMOVED IMMEDIATELY UPON COMPLETION OF CONSTRUCTION.
6. EROSION CONTROL MEASURES SHALL BE MAINTAINED THROUGHOUT THE CONSTRUCTION PERIOD AND SHALL BE REMOVED IMMEDIATELY UPON COMPLETION OF CONSTRUCTION.
7. EROSION CONTROL MEASURES SHALL BE MAINTAINED THROUGHOUT THE CONSTRUCTION PERIOD AND SHALL BE REMOVED IMMEDIATELY UPON COMPLETION OF CONSTRUCTION.
8. EROSION CONTROL MEASURES SHALL BE MAINTAINED THROUGHOUT THE CONSTRUCTION PERIOD AND SHALL BE REMOVED IMMEDIATELY UPON COMPLETION OF CONSTRUCTION.
9. EROSION CONTROL MEASURES SHALL BE MAINTAINED THROUGHOUT THE CONSTRUCTION PERIOD AND SHALL BE REMOVED IMMEDIATELY UPON COMPLETION OF CONSTRUCTION.
10. EROSION CONTROL MEASURES SHALL BE MAINTAINED THROUGHOUT THE CONSTRUCTION PERIOD AND SHALL BE REMOVED IMMEDIATELY UPON COMPLETION OF CONSTRUCTION.

GENERAL UTILITY NOTES

1. ALL UTILITIES SHALL BE MAINTAINED THROUGHOUT THE CONSTRUCTION PERIOD AND SHALL BE REMOVED IMMEDIATELY UPON COMPLETION OF CONSTRUCTION.
2. ALL UTILITIES SHALL BE MAINTAINED THROUGHOUT THE CONSTRUCTION PERIOD AND SHALL BE REMOVED IMMEDIATELY UPON COMPLETION OF CONSTRUCTION.
3. ALL UTILITIES SHALL BE MAINTAINED THROUGHOUT THE CONSTRUCTION PERIOD AND SHALL BE REMOVED IMMEDIATELY UPON COMPLETION OF CONSTRUCTION.
4. ALL UTILITIES SHALL BE MAINTAINED THROUGHOUT THE CONSTRUCTION PERIOD AND SHALL BE REMOVED IMMEDIATELY UPON COMPLETION OF CONSTRUCTION.
5. ALL UTILITIES SHALL BE MAINTAINED THROUGHOUT THE CONSTRUCTION PERIOD AND SHALL BE REMOVED IMMEDIATELY UPON COMPLETION OF CONSTRUCTION.
6. ALL UTILITIES SHALL BE MAINTAINED THROUGHOUT THE CONSTRUCTION PERIOD AND SHALL BE REMOVED IMMEDIATELY UPON COMPLETION OF CONSTRUCTION.
7. ALL UTILITIES SHALL BE MAINTAINED THROUGHOUT THE CONSTRUCTION PERIOD AND SHALL BE REMOVED IMMEDIATELY UPON COMPLETION OF CONSTRUCTION.
8. ALL UTILITIES SHALL BE MAINTAINED THROUGHOUT THE CONSTRUCTION PERIOD AND SHALL BE REMOVED IMMEDIATELY UPON COMPLETION OF CONSTRUCTION.
9. ALL UTILITIES SHALL BE MAINTAINED THROUGHOUT THE CONSTRUCTION PERIOD AND SHALL BE REMOVED IMMEDIATELY UPON COMPLETION OF CONSTRUCTION.
10. ALL UTILITIES SHALL BE MAINTAINED THROUGHOUT THE CONSTRUCTION PERIOD AND SHALL BE REMOVED IMMEDIATELY UPON COMPLETION OF CONSTRUCTION.

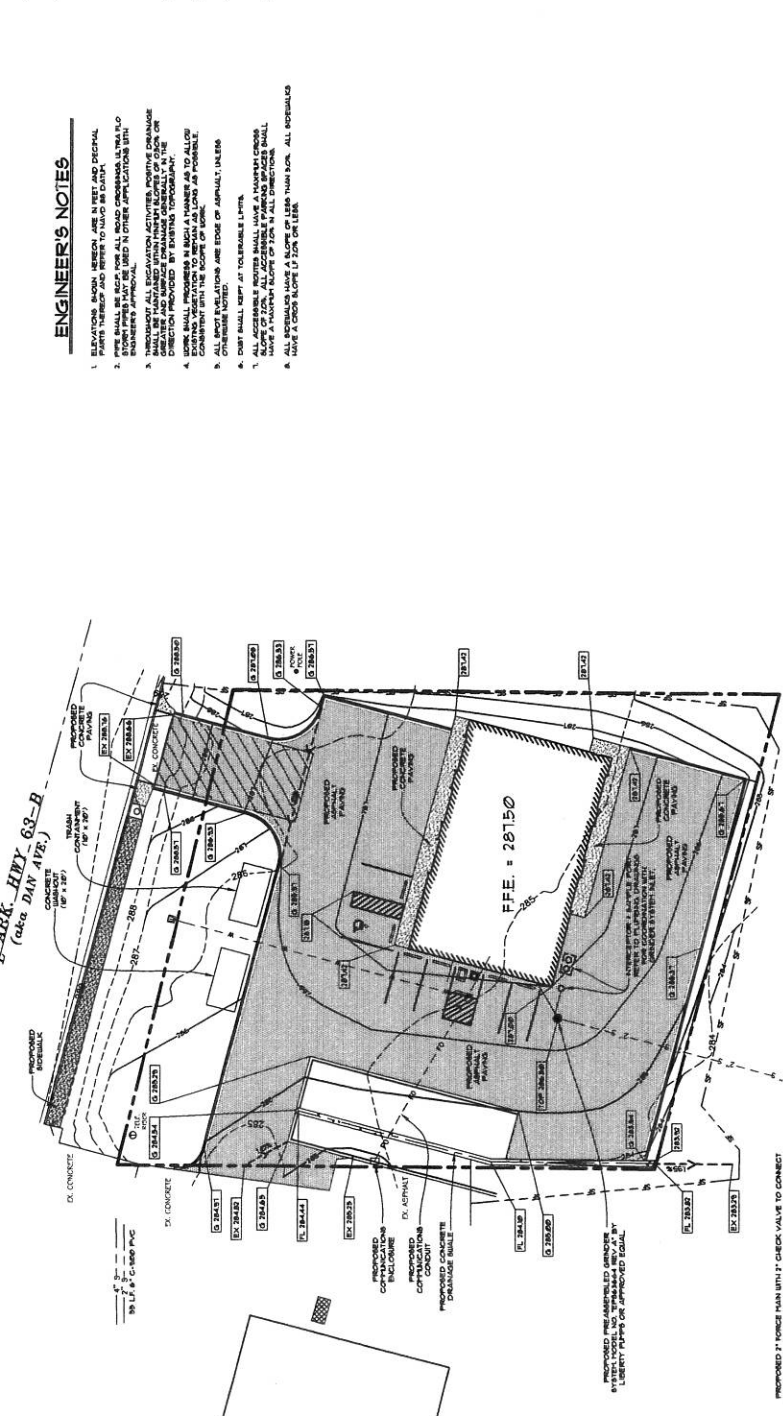
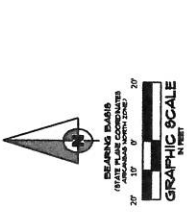

PROPOSED UTILITY LINES SHALL BE MAINTAINED THROUGHOUT THE CONSTRUCTION PERIOD AND SHALL BE REMOVED IMMEDIATELY UPON COMPLETION OF CONSTRUCTION. THE CONTRACTOR SHALL MAINTAIN POSITIVE DRAINAGE DIRECTION THROUGHOUT THE CONSTRUCTION PERIOD AND SHALL BE REMOVED IMMEDIATELY UPON COMPLETION OF CONSTRUCTION.