

**LEGEND:**

- FOUND MONUMENT (AS NOTED)
- SET 5/8" REBAR WITH YELLOW PLASTIC CAP STAMPED "J.W. HARLAN, P.S. 1538"
- UTILITY POLE
- ⊙ TELEPHONE PEDESTAL
- ⊞ WATER METER
- ⊙ SANITARY SEWER MANHOLE

**CERTIFICATE OF SURVEY:**

THIS IS TO CERTIFY THAT FISHER ARNOLD, INC., PROFESSIONAL LAND SURVEYORS, HAVE SURVEYED THE FOLLOWING DESCRIBED PARCEL OF LAND:

A PART OF THE NORTHWEST QUARTER OF THE NORTHWEST QUARTER OF SECTION 8, TOWNSHIP 14 NORTH, RANGE 4 EAST, CRAIGHEAD COUNTY, ARKANSAS, BEING MORE PARTICULARLY DESCRIBED AS FOLLOWS:

COMMENCING AT THE NORTHWEST CORNER OF SECTION 8; THENCE SOUTH 00°53'42" WEST, 360.00 FEET, ALONG THE SECTION LINE TO THE POINT OF BEGINNING PROPER;

THENCE NORTH 89°52'41" EAST 330.00 FEET; THENCE SOUTH 05°17'56" EAST, 157.15 FEET; THENCE SOUTH 10°49'37" WEST, 75.73 FEET; THENCE SOUTH 89°47'41" WEST 333.88 FEET TO THE SECTION LINE; THENCE NORTH 00°53'42" EAST, ALONG THE SECTION LINE 231.38 FEET TO THE POINT OF BEGINNING PROPER;

CONTAINING SOME (78327.47 SQ. FT.) 1.80 ACRES, MORE OR LESS, BEING SUBJECT TO ANY AND ALL RIGHT OF WAY, EASEMENTS, AND RESTRICTIONS OF RECORD.

**SURVEYOR'S NOTES:**

1. SURVEYOR HAS MADE NO INVESTIGATION OR INDEPENDENT SEARCH FOR EASEMENTS OF RECORD OR ANY OTHER FACTS WHICH AN ACCURATE TITLE SEARCH MAY DISCLOSE.
2. BASIS OF BEARINGS: ARKANSAS STATE PLANE, NORTH ZONE (0301)
3. THE FOLLOWING DOCUMENTS WERE USED IN THE CONSTRUCTION OF THIS SURVEY:
  - DEED RECORD 353, PAGE 268-269
  - DEED RECORD 260, PAGE 648
  - ANDERSONS PATRICK STREET ADDITION TO, JONESBORO, ARKANSAS, CLAY KENWOOD PE, LS, 12/07/90.
4. THE UNDERGROUND UTILITIES SHOWN HAVE BEEN LOCATED BY FIELD MEASUREMENTS AND EXISTING UTILITY MAPS. FISHER ARNOLD INC. MAKE NO WARRANTY TO THE EXACT LOCATION OF THE UTILITIES SHOWN OR NOT SHOWN ON THIS DRAWING. IT SHALL BE THE RESPONSIBILITY OF THE CONTRACTOR TO VERIFY ANY AND ALL UTILITIES PRIOR TO CONSTRUCTION. CALL 811 BEFORE YOU DIG!
5. THE SUBJECT PROPERTY LIES WITHIN ZONE X, AREAS DETERMINED TO BE OUTSIDE THE 500 YEAR FLOOD PLAIN, AS SHOWN ON FEMA FLOOD INSURANCE RATE MAP PANEL NO. 0500480044C, EFFECTIVE DATE SEPTEMBER 27, 1991.
6. SUBJECT PROPERTY IS CURRENTLY ZONED R-1.
7. CURRENT BUILDING SETBACKS:
  - STREET SETBACK 25.0'
  - INTERIOR SIDE SETBACK 7.5'
  - REAR SETBACK 25.0'
8. FIELD NOTES ARE RECORDED IN HKB FIELD BOOK 1154, PAGES 18.
9. FIELD WORK WAS COMPLETED ON SEPTEMBER 28TH, 2016.

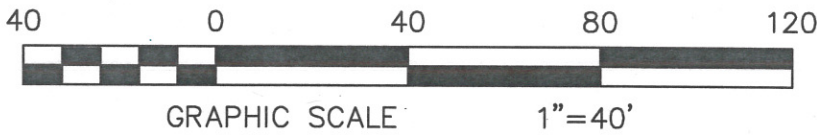

**OWNERS CERTIFICATION:**

I HEREBY CERTIFY THAT I AM THE OWNER OF THE ABOVE DESCRIBED PROPERTY AND I HEREBY REQUEST A REZONING FROM:

(R-1) SINGLE-FAMILY MEDIUM DENSITY DISTRICT TO (RM-8)

SIGNED THIS \_\_\_\_ DAY OF APRIL, 2017.

*Garry Tate*  
GARRY TATE

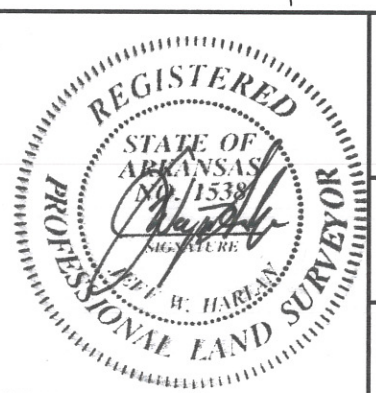
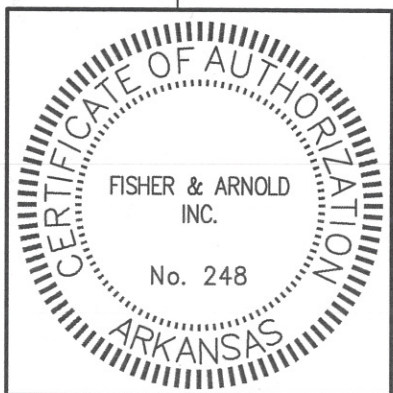

COPYRIGHT 2017, ALL RIGHTS RESERVED

CLIENT  
GARRY TATE

**REZONING PLAT**

JONESBORO, CRAIGHEAD COUNTY, ARKANSAS



1801 Latourette Drive | Jonesboro, Arkansas 72404  
870.932.2019 | Fax: 870.932.1076 | www.fisherarnold.com

REVISIONS		
DATE	BY	DESCRIPTION
SURVEY INDEX CODE		
500-14N-04E-0-08-440-16-1538		
PROJECT NO.		
JB9435-09		
DRAWN BY	CHECKED BY	
JWH	TGB	
SHEET	SCALE	
1 OF 1	1"=40'	
DATE	DRAWING NO.	
01/17/17	56-46	

BASIS OF BEARINGS: ARKANSAS STATE PLANE COORDINATE SYSTEM, NORTH ZONE (0301)