

TO THE CITY COUNCIL OF JONESBORO, ARKANSAS

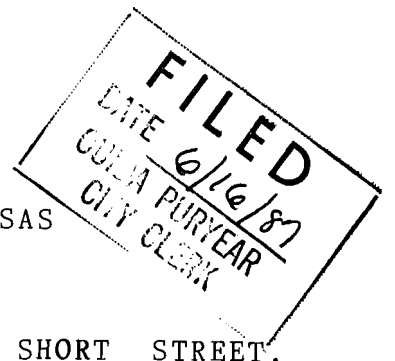

IN THE MATTER OF VACATING AND ABANDONING ALL OF SHORT STREET,
ALSO KNOWN AS BERRY STREET

PETITION TO VACATE AND ABANDON STREETS

Comes now the undersigned petitioners, and for their
Petition, state:

1. Petitioners own land which abuts Short Street, a/k/a
Berry Street.

2. Short Street, a/k/a Berry Street, has been dedicated as
a public street to the City of Jonesboro, Arkansas.

3. Petitioners request that the City of Jonesboro by and
through its City Council abandon and vacate all of Short Street,
a/k/a Berry Street, the same being located North of lots 1 and 2
of Block 10 of Cartwright and French Addition to the City of
Jonesboro, Arkansas, as shown by plat of record which is attached
and incorporated herewith.

4. The petitioners request that Short Street, a/k/a Berry
Street, be abandoned and vacated by the City of Jonesboro through
its City Council.

5. Petitioners request that the City Council by resolution
direct the City Clerk to give notice by publication once a week
for two weeks in the Jonesboro Sun advising property owners
affected that on a day certain the City Council for the City of
Jonesboro, Arkansas, will hear this Petition and determine
whether such public streets should be abandoned and vacated.

This Petition is hereby presented and filed with the City
Clerk for the City of Jonesboro, Arkansas, pursuant to Ark. Stat.
Ann. 19-3814 et. seq.

VERIFICATION

We, the aforementioned property owners, do hereby state under oath that the facts set forth in the Petition are true and correct to the best of our knowledge, information and belief.

R. Dean Pryor

Betty L. Pryor

James H. Sartin

Shirley A. Sartin

Wesley D. Dunks

Paul Dunham

Jimmy Mathershed

Mary Mathershed

PLAT OF
 CARTWRIGHT & FRENCH
 ADDITION
 TO THE CITY OF
 JONESBORO, ARKANSAS.

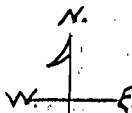

Survey Made by
 Ben Eddins
 County Surveyor.

See Dedication
 on opposite Page 52- J.R. 108
 also Court Order
 County Clerks Office.

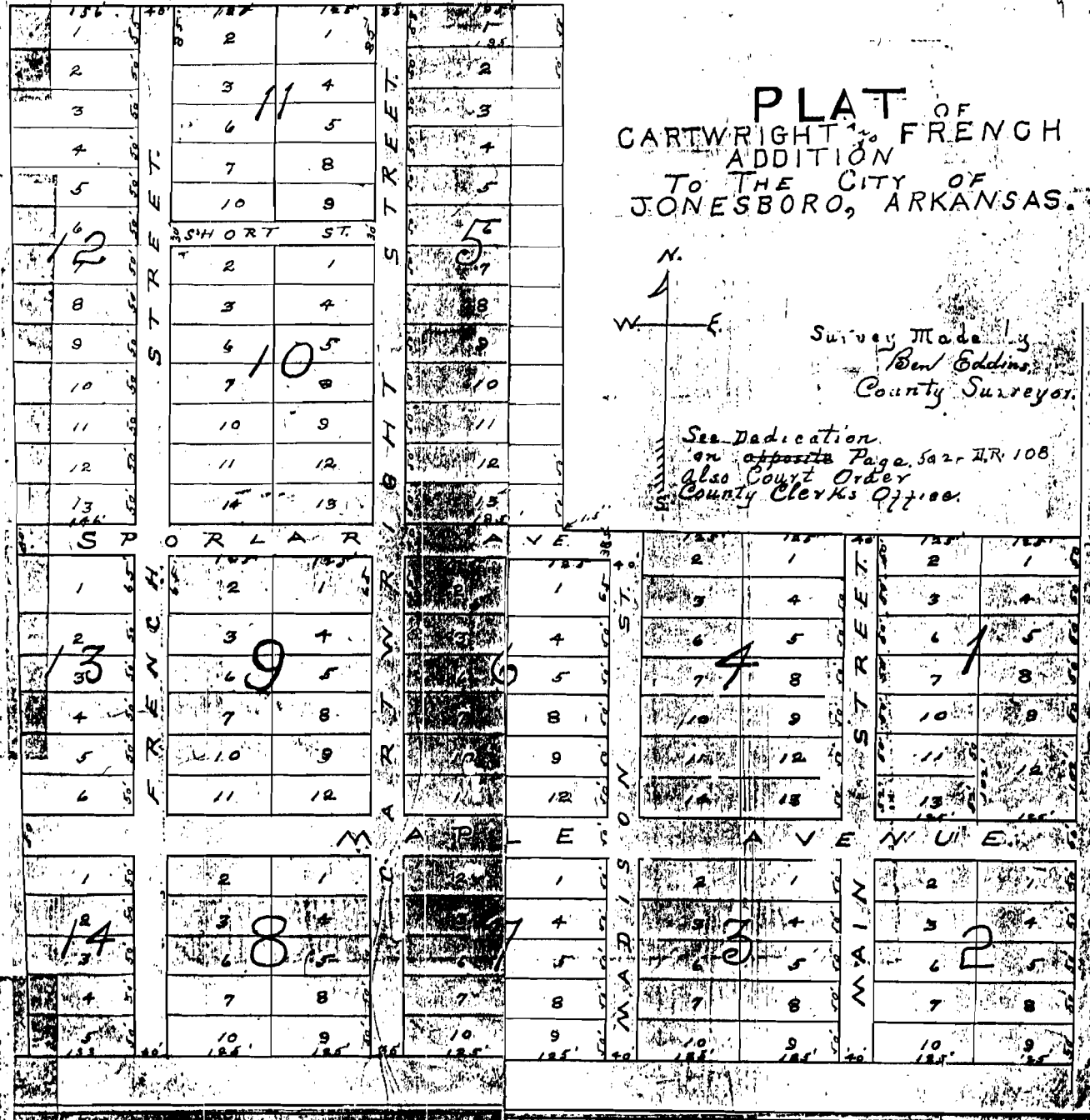

State Of Arkansas
 County of Craighead
 A TRUE COPY I CERTIFY.
 PAT FLEETWOOD, Chancery & Circuit Clerk
 By *[Signature]*