

**DESCRIPTION - TRACT 2**

TRACT 2, 52,093 SQ. FT. 1.20 ACRES. THIS TRACT IS BOUND BY THE WEST LINE OF TRACT 1 TO THE WEST, THE EAST LINE OF TRACT 1 TO THE EAST, THE SOUTH LINE OF TRACT 1 TO THE SOUTH, AND THE WEST LINE OF TRACT 1 TO THE WEST. THE TRACT IS BOUND BY THE WEST LINE OF TRACT 1 TO THE WEST, THE EAST LINE OF TRACT 1 TO THE EAST, THE SOUTH LINE OF TRACT 1 TO THE SOUTH, AND THE WEST LINE OF TRACT 1 TO THE WEST.

**DESCRIPTION - TRACT 1**

TRACT 1, 113.1 ACRES. THIS TRACT IS BOUND BY THE WEST LINE OF TRACT 2 TO THE WEST, THE EAST LINE OF TRACT 2 TO THE EAST, THE SOUTH LINE OF TRACT 2 TO THE SOUTH, AND THE WEST LINE OF TRACT 2 TO THE WEST. THE TRACT IS BOUND BY THE WEST LINE OF TRACT 2 TO THE WEST, THE EAST LINE OF TRACT 2 TO THE EAST, THE SOUTH LINE OF TRACT 2 TO THE SOUTH, AND THE WEST LINE OF TRACT 2 TO THE WEST.

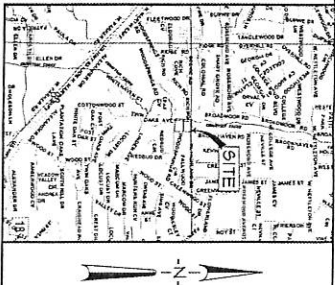
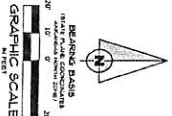

**LEGEND**

- Proposed Lot Line
- Existing Lot Line
- Proposed Well
- Existing Well
- Proposed Structure
- Existing Structure
- Proposed Pond
- Existing Pond
- Proposed Stream
- Existing Stream
- Proposed Road
- Existing Road
- Proposed Utility
- Existing Utility

**SURVEYOR'S NOTES**

1. THIS SURVEY WAS CONDUCTED IN ACCORDANCE WITH THE SURVEYING ACT OF 1968 AND THE SURVEYING REGULATIONS OF THE STATE OF ARKANSAS.
2. THE SURVEY WAS CONDUCTED ON THE DATE INDICATED ON THE TITLE SHEET.
3. THE SURVEY WAS CONDUCTED BY THE SURVEYOR AND HIS ASSISTANTS.
4. THE SURVEY WAS CONDUCTED IN ACCORDANCE WITH THE SURVEYING ACT OF 1968 AND THE SURVEYING REGULATIONS OF THE STATE OF ARKANSAS.
5. THE SURVEY WAS CONDUCTED ON THE DATE INDICATED ON THE TITLE SHEET.
6. THE SURVEY WAS CONDUCTED BY THE SURVEYOR AND HIS ASSISTANTS.

**SURVEYOR'S CERTIFICATION**

I, the undersigned, being a duly licensed and qualified Surveyor in the State of Arkansas, do hereby certify that the foregoing is a true and correct copy of the original survey as shown to me by the client, and that the same is in accordance with the provisions of the Surveying Act of 1968 and the Surveying Regulations of the State of Arkansas.

**MIKE CAMERON**  
WOODSPRINGS ROAD  
SECTION 25, T14N, R3E  
JONESBORO, ARKANSAS

**ASSOCIATED ENGINEERING, LLC**  
CIVIL ENGINEERING • LAND SURVEYING  
LAND PLANNING  
103 SOUTH CHURCH STREET • P.O. BOX 1462  
JONESBORO, AR 72403  
PH: 870-932-3391 • FAX: 870-935-1263

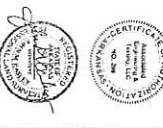

NO.	REVISION	DATE

**REZONING PLAT**

DATE: 11/11/2023  
DRAWN BY: M. CAMERON  
CHECKED BY: M. CAMERON  
SCALE: AS SHOWN  
SHEET: 1 OF 1