

**LINE TABLE:**

| LINE # | DIRECTION   | LENGTH  |
|--------|-------------|---------|
| L1     | S89°26'29"W | 210.00' |
| L2     | N00°46'16"E | 99.88'  |

**LEGEND:**

- ⊙ SET 5/8" REBAR W/ PINK PLASTIC CAP STAMPED "MCNEESE P.S. 1709" (OR AS NOTED)
- UTILITY POLE
- LIGHT POLE
- ⊞ WATER METER
- ⊙ SANITARY SEWER MANHOLE
- STORM DRAIN MANHOLE
- BOUNDARY LINE
- E- OVERHEAD ELECTRIC LINE
- T- OVERHEAD TELECOMMUNICATIONS LINE

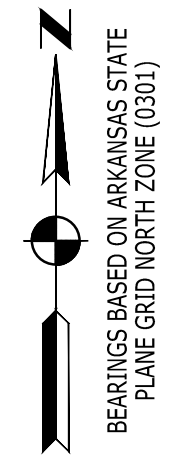

**RIDGE SURVEYING & CONSULTING, PLLC.**  
311 South Church St., Suite H  
Jonesboro, AR 72401 870-203-9940  
www.ridgesurveying.net

**BOUNDARY SURVEY**  
CLIENT: MATH INVESTMENTS, LLC  
LOTS 1, 2, 3, 4, 5 AND 6, BLOCK 2,  
HURLEY AND MOORE ADDITION  
TO THE CITY OF JONESBORO,  
CRAIGHEAD COUNTY, ARKANSAS

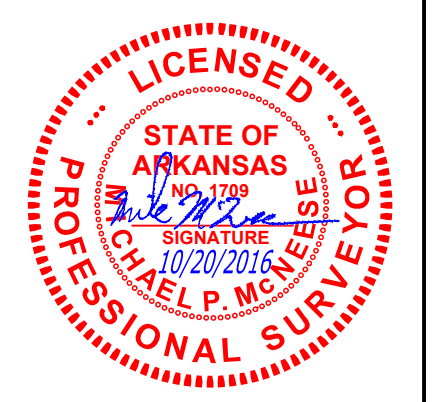

**SURVEYOR'S NOTES:**

- SURVEYOR HAS MADE NO INVESTIGATION OR INDEPENDENT SEARCH FOR EASEMENTS OF RECORD OR ANY OTHER FACTS WHICH AN ACCURATE TITLE SEARCH MAY DISCLOSE.
- BASIS OF BEARINGS: ARKANSAS STATE PLANE GRID NORTH (0301).
- THE FOLLOWING DOCUMENTS WERE USED TO COMPLETE THIS SURVEY:
  - RECORD PLAT, BROOKFIELDS FIRST ADDITION, RECORDED IN BOOK 13, PAGE 101, DATED APRIL 12, 1893.
  - RECORD PLAT, HURLEY AND MOORE ADDITION, RECORDED IN BOOK 15, PAGE 527, DATED NOVEMBER 13, 1896.
  - BOUNDARY SURVEY, BY TROY L. SHEETS, P.S. 596, RECORDED IN BOOK C, PAGE 6, DATED JANUARY 04, 1974.
  - RECORD REPLAT, WAYMON'S REPLAT, BY ROBERT W. NEWELL, P.S. 23, RECORDED IN BOOK B, PAGE 77, DATED JUNE 06, 1991.
  - BOUNDARY SURVEY, BY MICHAEL A. DANIELS, P.S. 1563, SLS DOCUMENT NO. 201005070004, DATED SEPTEMBER 24, 2009.
- THE SUBJECT PROPERTY LIES OUTSIDE THE 100 YEAR SPECIAL FLOOD HAZARD ZONE, AS SHOWN ON FEMA FLOOD INSURANCE RATE MAPS: PANEL NO. 05031C0043C, EFFECTIVE DATE SEPTEMBER 27, 1991.
- SUBJECT PROPERTY IS ZONED I-1, LIMITED INDUSTRIAL DISTRICT.
- I-1 ZONING REQUIREMENTS:  
STREET SETBACK - 25'  
REAR SETBACK - 20'  
SIDE SETBACK - 10'  
HEIGHT RESTRICTION - 45'  
MAXIMUM LOT COVERAGE - 60%
- FIELD WORK WAS COMPLETED ON OCTOBER 11, 2016.

**LEGAL DESCRIPTION (AS-SURVEYED):**

LOTS 1, 2, 3, 4, 5 AND 6, BLOCK 2, HURLEY AND MOORE ADDITION TO THE CITY OF JONESBORO, CRAIGHEAD COUNTY, ARKANSAS, AS SHOWN BY PLAT OF RECORD IN DEED RECORD 15, PAGE 527 AT JONESBORO, ARKANSAS.

**SURVEYOR'S CERTIFICATION:**

I, MICHAEL P. MCNEESE, CERTIFY THAT THE SURVEY SHOWN HEREON WAS MADE IN ACCORDANCE WITH THE REQUIREMENTS OF "ARKANSAS STANDARDS OF PRACTICE FOR PROPERTY BOUNDARY SURVEYS AND PLATS"; AND THAT THE ABOVE DESCRIBED TRACT WAS SURVEYED UNDER MY DIRECT SUPERVISION.

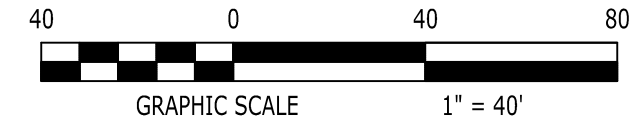

| DRAWING INFO                 |                 |
|------------------------------|-----------------|
| DRAWN BY: JJN                | SCALE: 1" = 40' |
| DATE: 10 / 20 / 2016         | JOB NO: 16266   |
| REVISIONS                    |                 |
|                              |                 |
|                              |                 |
| 500-14N-04E-0-18-240-16-1709 |                 |