

REZONING REQUEST: C-3 REQUESTING RS-7  
 LOTS 21 & 22 BLOCK 'D' OF DUDLEY'S SUBDIVISION OF A PART OF  
 BLOCKS B,C,D,E,F,G OF DUDLEY'S FIRST SUBDIVISION  
 JONESBORO, CRAIGHEAD COUNTY, ARKANSAS

DATE: 10/10/19  
 REV:

DRAWN BY: BGW

BRANDON WOOD, P.E., P.S.  
 ENGINEERING & SURVEYING  
 112 CR 7625  
 BROOKLAND, AR 72417  
 PH: (870) 930-7504  
 FAX: (870) 972-0027  
 BWOOD@WOODENGR.COM  
 WWW.BWOODENGINEERING.COM

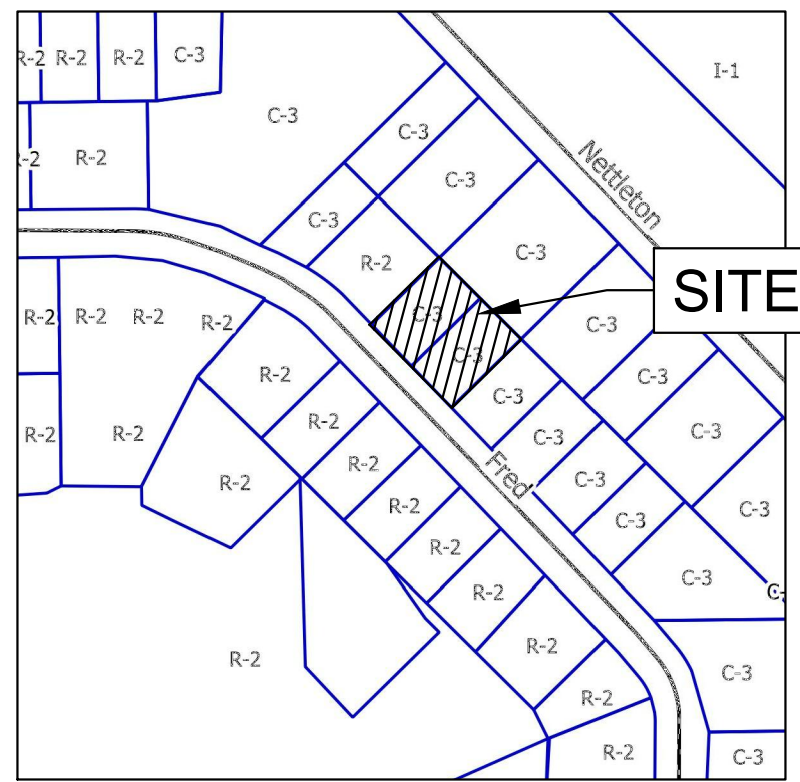

VICINITY MAP  
 (NOT TO SCALE)

DESCRIPTION:  
 LOTS 21 & 22 OF BLOCK 'D' OF DUDLEY'S SUBDIVISION OF A PART  
 OF BLOCKS B,C,D,E,F,G OF DUDLEY'S FIRST SUBDIVISION AS  
 RECORDED IN CRAIGHEAD COUNTY COURTHOUSE CIRCUIT  
 CLERK'S OFFICE, BOOK '123', PAGE '150'.

HAVING AN AREA OF 14,400 SQ.FT. OR 0.32 ACRE MORE OR LESS.

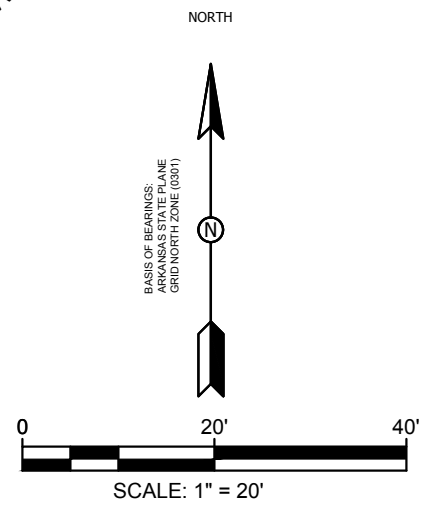
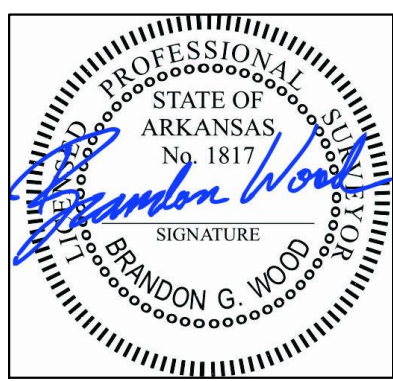

TOTAL AREA  
 14,400 SQ.FT.  
 0.32 ± ACRES  
 ZONED C-3  
 REQUESTING RS-7

LOT 22  
 7,200 SQ.FT.  
 0.16 AC.  
 C-3

LOT 21  
 7,200 SQ.FT.  
 0.16 AC.  
 C-3

LOT 20  
 (NOT INCLUDED)  
 R-2

COOPER REPLAT OF  
 LOTS 6 & 7  
 (NOT INCLUDED)  
 C-3

LOT 23  
 (NOT INCLUDED)  
 C-3

