

LINE	BEARING	DISTANCE
L1	N 75°13'56" E	51.38'
L2	S 88°58'03" W	23.79'
L3	N 89°43'35" R	25.00'
L4	S 00°20'35" W	43.10'
L5	S 36°07'30" E	28.55'
L6	S 88°58'03" W	70.72'
L7	N 00°53'15" E	28.43'
L8	N 00°20'35" E	35.00'
L9	N 89°43'35" E	25.00'
L10	N 00°53'15" E	23.33'

FLOOD INSURANCE NOTE: By graphics plotting only, this property is in ZONE X of the Flood Insurance Rate Map, Community Panel No. 05031C0131 C effective date of SEPT. 27, 1991. Exact designations can only be determined by an Elevation Certificate. Based on the above information, this property IS NOT in a Special Flood Hazard Area.

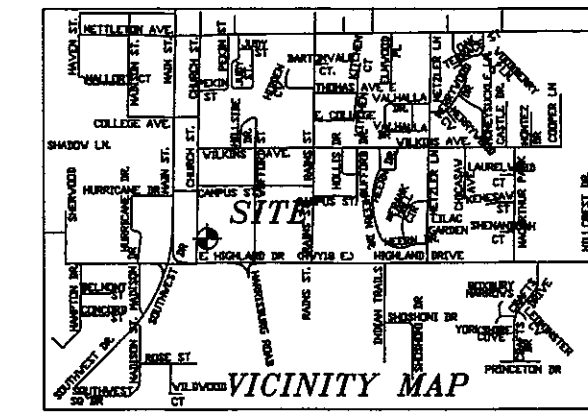
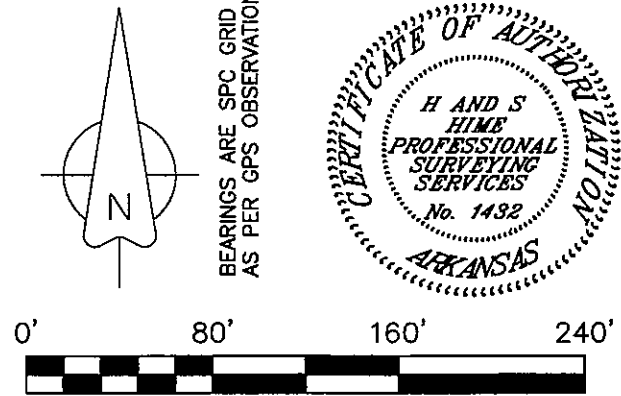

DEED CALL
DEED BK 326 @ PG 407
DEED BK 328 @ PG 799

WALGREENS DRUG STORE MINOR PLAT
PG 137

SOUTH QUARTER CORNER OF SECTION 19, T14N R4E AS PER OLD SURVEY AND WALGREENS MINOR PLAT

MAPPING POINT
N:544138.155
E:1696359.139

City of **Jonesboro** ARKANSAS

DATE **09-21-11** FILE # **MP11-18**

FINAL APPROVAL
 PRELIMINARY (NOT FOR RECORDING)

APPROVED BY: _____

PLANNING DEPT
ENGINEERING DEPT

LINE	BEARING	DISTANCE	CHORD LENGTH	TANGENT
C1	129°33'17"	1.50'	3.39'	3.18'
C2	83°45'40"	5.00'	7.31'	4.48'

LINE	BEARING	DISTANCE
L1	S 89°43'35" W	95.00'
L2	S 00°53'49" W	208.15'
L3	S 88°29'24" W	24.11'
L4	N 00°00'00" W	231.72'
L5	N 50°26'43" W	16.11'
L6	N 39°33'17" E	25.50'
L7	S 50°26'43" E	14.24'
L8	N 00°00'00" W	16.54'
L9	N 90°00'00" E	101.30'
L10	S 00°00'00" E	14.34'
L11	S 00°53'15" W	74.76'
L12	N 00°20'35" E	35.00'
L13	N 00°53'15" E	28.43'

DESCRIPTION: INGRESS & EGRESS EASEMENT
A PART OF LOT 13 OF SENTER & COMPANY'S ADDITION TO THE CITY OF JONESBORO, ARKANSAS AND BEING MORE PARTICULARLY DESCRIBED AS FOLLOWS:
Commencing at the Southwest corner (South Quarter corner of said Section 19) of the Southeast Quarter of said Section 19; thence North 00°20'35" East 35.00 feet; thence North 89°43'35" East 281.55 feet (deed 275.00'); thence North 00°53'15" East 28.43 feet to the North right of way line of Arkansas Highway No. 18, thence continue North 00°53'15" East 206.61 feet to the point of beginning proper; thence South 89°43'35" West 95.00 feet; thence South 00°53'49" West 208.15 feet; thence South 88°29'24" West 24.11 feet; thence North 00°00'00" East 231.72 feet; thence North 50°26'43" West 16.11 feet; thence North 39°33'17" East 25.50 feet; thence South 50°26'43" East 14.24 feet; thence with a curve turning to the left with an arc length of 3.39', with a radius of 1.50'; thence North 00°00'00" East 16.54 feet; thence North 90°00'00" East 101.30 feet; thence South 00°00'00" East 14.33 feet; thence with a curve turning to the left with an arc length of 7.31', with a radius of 5.00'; thence South 00°53'15" West 41.76 feet; to the point of beginning proper, having an area of 12740.64 square feet, 0.29 acres more or less

1807 WOFFORD ST
LOT 7 OF NORRED SUBD. DR
131 @ PG 99

PROPERTY LINE 335' NORTH AND PARALLEL TO SOUTH LINE OF LOT 13

LOT 1
91291.2 SQ. FT.
2.10 ACRES

DEED BK 714 @ PG 846

DRAINAGE NOTE:
DRAINAGE EASEMENTS, STRUCTURES, SWALES AND DETENTION AREAS SHALL BE OWNER MAINTAINED AND SUBJECT TO MAINTENANCE AGREEMENT WITH THE CITY OF JONESBORO, ARKANSAS.

SEE SURVEYS: BK "H" @ PAGE 2 AND ALTA SURVEY BY HKB 7-23-2003

ARK. HWY No. 18 R-O-W
N 89°54'17" W
276.79'

HIGHWAY No. 18 (HIGHLAND DRIVE)

(60' RIGHT OF WAY AS PER PLAT OF NORRIS SUBDIV. D.R. 131 PG 99

WOFFORD STREET

- SURVEY NOTES:
- BEARINGS ARE STATE PLANE GRID BEARINGS (NAD 83 DATUM) AS PER GPS OBSERVATION ON SITE DURING SURVEY AND ARE TO BE USED TO DEFINE THE GENERAL DIRECTION AND TRUE ANGLE AT THE INTERSECTION OF THE PROPERTY AND LAND LINES.
 - PROPERTY IS SUBJECT TO UTILITY SERVICES AND UNDERGROUND UTILITY LINES NOT LOCATED.

DESCRIPTION:
A PART OF LOT 13 OF SENTER & COMPANY'S ADDITION TO THE CITY OF JONESBORO, ARKANSAS AND BEING MORE PARTICULARLY DESCRIBED AS FOLLOWS:
Commencing at the Southwest corner (South Quarter corner of said Section 19) of the Southeast Quarter of said Section 19; thence North 00°20'35" East 35.00 feet; thence North 89°43'35" East 281.55 feet (deed 275.00'); thence North 00°53'15" East 28.43 feet to the North right of way line of Arkansas Highway No. 18, the point of beginning proper; thence continue North 00°53'15" East 144.90 feet; thence South 89°42'53" East 350.08 feet; thence North 00°54'29" East 130.13 feet; thence South 89°43'35" West 494.58 feet; thence South 00°20'35" West 210.00 feet; thence South 89°43'35" West 115.00 feet; thence South 00°20'35" West 43.10 feet; thence South 36°07'30" East 28.55 feet; thence North 88°27'49" East 169.23 feet; thence North 88°58'03" East 70.72 feet; to the point of beginning proper, having an area of 91291.16 square feet, 2.10 acres more or less and being subject to all public and private roads and easements.

OWNER CERTIFICATION:
WE HEREBY CERTIFY THAT WE THE OWNERS OF THE PROPERTY SHOWN AND DESCRIBED HEREON AND THAT WE ADOPT THE PLAN OF THE SUBDIVISION AND DEDICATED PERPETUAL USE OF ALL STREETS AND EASEMENTS AS NOTED AND WE FURTHER CERTIFY THAT WE HAVE READ AND ACKNOWLEDGED THE FOLLOWING STATEMENT.

SURVEYOR'S CERTIFICATION:
THIS IS TO CERTIFY I HAVE ON THIS DATE SURVEYED THE ABOVE DESCRIBED PROPERTY IN ACCORDANCE WITH MONUMENTS FOUND AND THIS PLAT CONFORMS TO THAT SURVEYED.

H&S HIME PROFESSIONAL SURVEYING SERVICES
Pob No. 351
Brookland, Arkansas 72417

STATE CODE: 500-14N-04E-0-19-230-16-1142

EBBERT HIGHLAND DRIVE
MINOR PLAT OF

A PART OF LOT 13 OF SENTER & CO.'S ADDITION TO THE CITY OF JONESBORO, ARKANSAS

drawn: HH
date: 7-10-2011
scale: 1" = 80'

client: EBBERT PROPERTY

H & S HIME PROFESSIONAL SURVEYING SERVICES
POB No. 351
BROOKLAND, ARKANSAS 72417

PHONE: 870 972 1288
FAX: 870 972 1011
E-MAIL: hshime_butch@yahoo.com

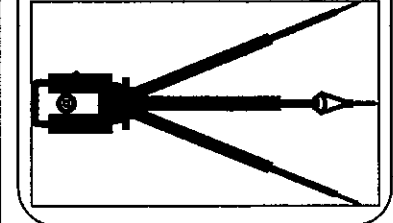

HERBERT C. HIME
REGISTERED PROFESSIONAL LAND SURVEYOR
STATE OF ARKANSAS
SIGNATURE
PLS # 1142