

LEGEND

These standard symbols will be found in the drawing.

- FOUND CORNER AS NOTED
- SET 1/2" REBAR W/ CAP
- ⦿ FD COTTON PICKER SPINDLE
- ▲ HIGHWAY RIGHT OF WAY MARKER
- ⊙ FOUND REBAR
- △ CALCULATED CORNER
- X — X — FENCE LINE
- E — E — ELECTRIC
- ⊙ SET PK NAIL
- ⊘ POWER POLE

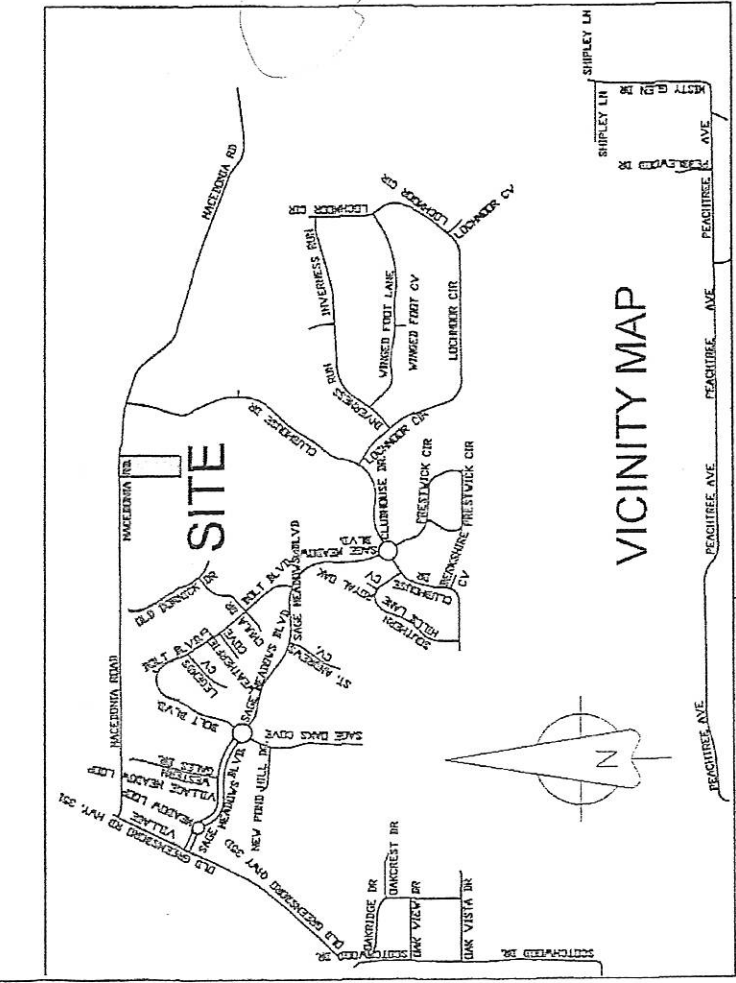

DESCRIPTION:
 THE EAST HALF OF THE NORTHWEST QUARTER OF THE NORTHWEST QUARTER OF SECTION 35, TOWNSHIP 15 NORTH, RANGE 4 EAST, CRAIGHEAD COUNTY, ARKANSAS AND BEING MORE PARTICULARLY DESCRIBED AS FOLLOWS:
 Beginning at the Southeast corner of the Northwest Quarter of the Northwest Quarter of said Section 35;
 thence North 00°05'20" East 1324.24 feet, thence South 89°56'01" West 661.34 feet; thence South 00°01'31" East 1327.53 feet; thence North 69°35'49" East 658.71 feet to the point of beginning proper, having an area of 875101.08 square feet, 20.09 acres more or less and being subject to all public and private roads and easements.

OWNER CERTIFICATION:
 WE HEREBY CERTIFY THAT WE THE OWNERS OF THE PROPERTY SHOWN AND DESCRIBED HEREON AND THAT WE ADOPT THE PLAN OF THE SUBDIVISION AND DEDICATED PERPETUAL USE OF ALL STREETS AND EASEMENTS AS NOTED.

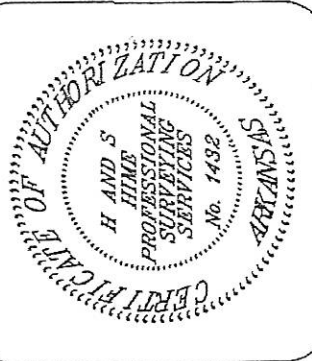

SURVEYOR'S CERTIFICATION:
 THIS IS TO CERTIFY I HAVE ON THIS DATE SURVEYED THE ABOVE DESCRIBED PROPERTY IN ACCORDANCE WITH MONUMENTS FOUND THIS PLAN CONFORMS TO THAT SURVEYED.

H&S HIME PROFESSIONAL SURVEYING SERVICES
 2619 CARAWAY RD. STE. "D"
 JONESBORO, ARKANSAS 72401



H&S HIME PROFESSIONAL SURVEYING SERVICES
 2619 CARAWAY RD - STE. "D"
 JONESBORO, ARKANSAS 72401

PHONE: 870-972-1288
 FAX: 870-972-1011
 E-MAIL: hshime_butch@yahoo.com

ANNEXATION PLAT

drawn:	H. HIME	THE EAST HALF OF THE NORTHWEST QUARTER OF THE NORTHWEST QUARTER OF SECTION 35, TOWNSHIP 15 NORTH, RANGE 4 EAST, CRAIGHEAD COUNTY, ARKANSAS
date:	4-28-2016	client:
scale:	1"= 300'	WINTERS, LLC