

- RM - 8; LUO**
- 1) 1.67 ACRES NET
 - 2) 12 UNITS MAXIMUM
 - 3) DENSITY = 7.2 UNITS/ACRE
 - 4) ALL DWELLING UNITS TO BE DUPLEXES.

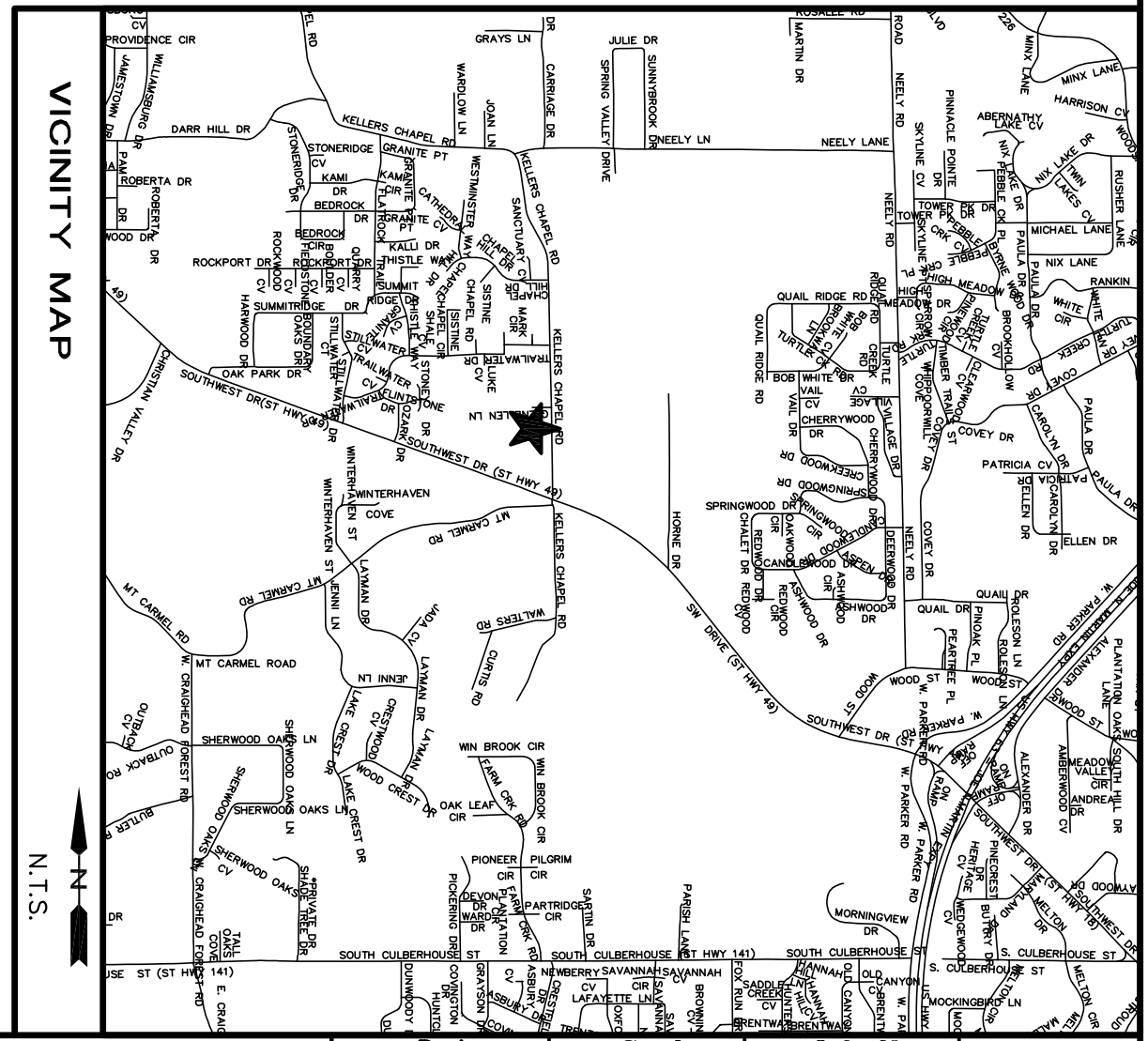
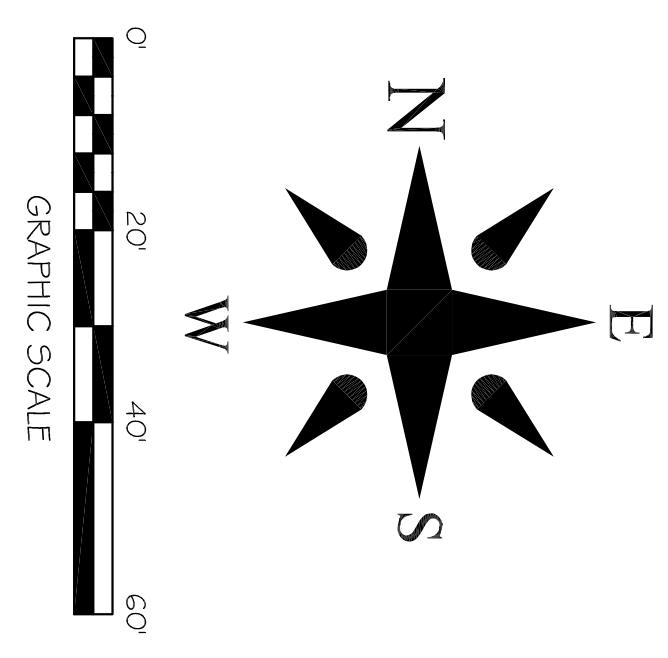

	PROPOSED DEVELOPMENT JONESBORO, ARKANSAS FOR DEVON SCOTT		ENGINEERS	PLANNERS	SURVEYORS	Date 12-19-16	Scale 1"=20'	Job No. 116148	Sheet No.	
	Civilologic						Section 35	Township 14N	Range 03E	County CRAIGHEAD
						Drawn By: RE	Checked by: GH			
203 Southwest Dr.-Jonesboro, AR-(870)932-7880-www.civilologic.net						ONLY COPIES WITH VIOLET COLORED SIGNATURE ARE ORIGINAL CIVILLOGIC COPIES				© 2016, Civilologic

JOB NO.: 116148
SHEET NUMBER
1 of 1