

Zoned R-1

WIMPY LANE

Zoned C-4

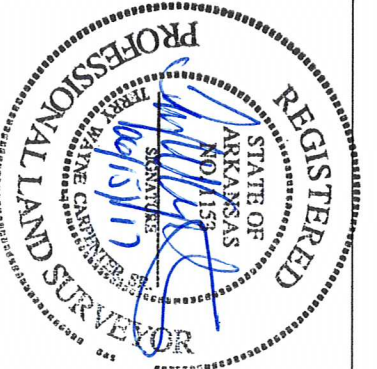

**Surveyor's Certification:**

I hereby certify that USI Consulting Engineers, Inc. has this date made a Rezoning Plat of the hereon described property and that the survey is accurate and correct to the best of my knowledge and belief. There are no apparent above ground encroachments other than as shown or stated hereon and that this survey was made in accordance with the Arkansas Standards of Practice for Property Boundary Surveys and Plats, in effect as of this date.

*Terry W. Carpenter*

Terry W. Carpenter, Sr., Arkansas Professional Surveyor No. 1153

Date 2017-06-15

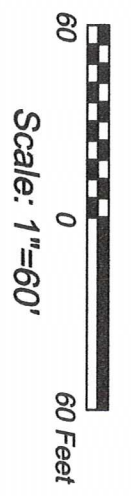

**Owner's Certification:**

We hereby certify that we are the Owners of the property as described hereon and that we request the Zoning change as noted.

Wade S. Carpenter

Katrina Y. Carpenter



**USI Consulting Engineers** Springdale, Arkansas

**REZONING PLAT FOR**

**WADE & KATIE CARPENTER**  
**LOT 8 - CLEAR VALLEY ESTATES**  
**JONESBORO, CRAIGHHEAD COUNTY, ARKANSAS**