

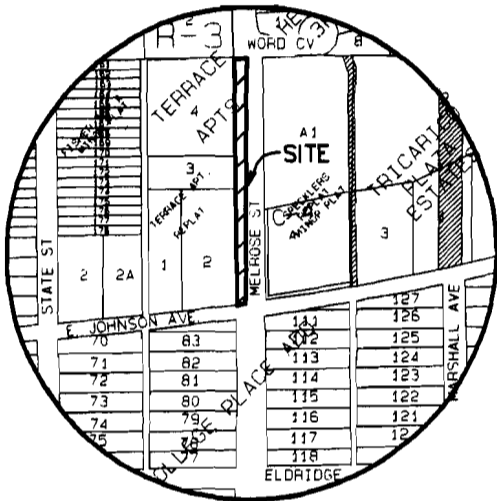

ASSUMED



VICINITY MAP
NTS

NE COR. LOT 97 COLLEGE
PLACE SUBDIVISION
(NE COR. LOT 4 TERRACE APTS.
2nd REPLAT OF PART OF
COLLEGE PLACE SUB.)

N89°35'00"E
15.00'

EXISTING
60'

30' 30'

EXISTING
75'

30' ASPHALT
PAVING

ALLEY

TERRACE APTS.
2nd REPLAT OF
PART OF COLLEGE
PLACE SUB

N00°00'00"E
626.00'

625.37'
S00°00'00"W

CL MELROSE ST.

CHORD:
S87°11'36"W
15.02'
R=2817.32'
L=15.02'

CL JOHNSON
AVE.

LEGAL DESCRIPTION:
THE WEST 15.0' OF MELROSE STREET RIGHT OF WAY LYING ADJACENT TO THE
TERRACE APARTMENTS SECOND REPLAT OF A PART OF COLLEGE PLACE SUBDIVISION
OF JONESBORO, CRAIGHEAD COUNTY, ARKANSAS BEING MORE PARTICULARLY
DESCRIBED AS FOLLOWS:

BEGIN AT THE NORTHEAST CORNER OF LOT 97 OF THE COLLEGE PLACE
SUBDIVISION OF JONESBORO, CRAIGHEAD COUNTY, ARKANSAS, THENCE;
N89°35'00"E - 15.00'; THENCE S0°00'00"W - 625.37 TO A POINT ON
THE NORTH RIGHT OF WAY OF JOHNSON AVENUE BEING ON A CURVE TO THE RIGHT
WHOSE RADIUS EQUALS 2817.83'; THENCE ALONG SAID CURVE (CHORD BEARS
S87°11'36"W - 15.02') A DISTANCE OF 15.02'; THENCE N0°00'00"E -
626.00' TO THE POINT OF BEGINNING CONTAINING 9385.40 SQUARE FEET MORE
OR LESS SUBJECT TO ALL RIGHTS OF WAY AND EASEMENTS OF RECORD.

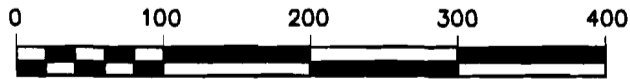

GRAPHIC SCALE 1"=100'

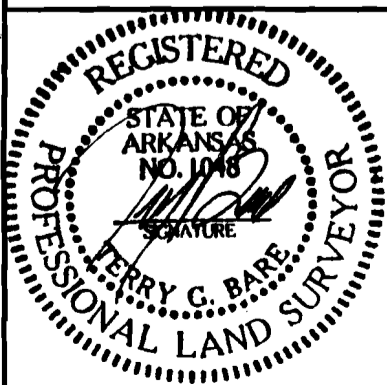

CLIENT
BRIAN GIBBS COMPANIES

STREET ABANDONMENT

THE WESTERLY 15.0' OF STREET RIGHT OF WAY
LYING ADJACENT TO THE TERRACE APARTMENTS
2nd REPLAT OF COLLEGE PLACE SUB. OF
JONESBORO, CRAIGHEAD CO., ARKANSAS

HAYWOOD, KENWARD, BARE & ASSOCIATES, INC.

CIVIL ENGINEERING - SURVEYING - PLANNING
3301 E. HIGHLAND DRIVE
JONESBORO, ARKANSAS 72401
TEL 870-932-2018 FAX 870-932-1078

REVISIONS

DATE	BY	DESCRIPTION

DRAWN BY
J.D.G.

SHEET
1 OF 1

DATE
04/10/00

SCALE
1" = 100'

JOB NO.
200227

DRAWING NO.
Q-107