

CURVE	ARC LENGTH	RADIUS	DELTA ANGLE	CHORD BEARING	CHORD LENGTH
C1	39.27'	25.00'	90°00'00"	N 44°15'19" W	35.36'
C2	39.27'	25.00'	90°00'00"	N 45°44'41" E	35.36'
C3	39.27'	25.00'	90°00'00"	S 44°15'19" E	35.36'
C4	39.27'	25.00'	90°00'00"	S 45°44'41" W	35.36'
C5	15.96'	25.00'	133°39'17"	S 82°25'41" E	5.94'
C6	15.07'	25.00'	34°32'06"	S 58°19'59" E	14.84'
C7	56.16'	49.91'	64°28'29"	S 73°14'15" E	53.25'
C8	44.00'	50.05'	50°22'15"	N 49°22'41" E	42.60'
C9	44.13'	50.15'	50°25'39"	N 01°07'35" W	42.72'
C10	39.78'	50.14'	45°27'43"	N 49°13'01" W	38.75'
C11	57.10'	50.02'	65°24'07"	S 75°18'11" W	54.05'
C12	15.07'	25.00'	34°32'06"	S 58°19'59" W	14.84'
C13	5.96'	25.00'	133°39'17"	S 83°55'03" W	5.94'

DESCRIPTION:
 A PART OF THE SOUTHWEST QUARTER OF THE SOUTHWEST QUARTER OF SECTION 3, TOWNSHIP 13 NORTH, RANGE 3 EAST, CRAIGHHEAD COUNTY, ARKANSAS AN BEING MORE PARTICULARLY DESCRIBED AS FOLLOWS:
 Commencing at the Southeast corner of the Southwest Quarter of said Section 3; thence North 00°18'25" East 466.62 feet; thence North 76°28'26" West 152.19 feet; thence North 30°39'19" West 171.19 feet; thence North 89°15'19" West 1063.04 feet; thence North 00°44'41" East 317.00 feet to the point of beginning proper;
 thence continue North 00°44'41" East 318.99 feet; thence North 89°46'05" East 973.29 feet; thence South 00°38'56" West 18.51 feet; thence South 18°23'53" West 87.63 feet; thence South 17°18'10" East 34.44 feet; thence South 44°05'01" East 53.59 feet; thence South 15°43'07" East 169.76 feet; thence North 89°15'19" West 1043.16 feet; to the point of beginning proper, having an area of 324290.94 square feet, 7.44 acres more or less and being subject to all public and private roads and easements.

- SURVEYOR'S NOTES:**
- BEARINGS ARE STATE PLANE GRID BEARINGS(NAD 83 DATUM)AS PER GPS OBSERVATION ON SITE DURING SURVEY AND ARE TO BE USED TO DEFINE THE GENERAL DIRECTION AND TRUE ANGLE AT THE INTERSECTION OF THE PROPERTY AND LAND LINES.
 - PROPERTY IS SUBJECT TO UTILITY SERVICES AND UNDERGROUND UTILITY LINES NOT LOCATED.

OWNER CERTIFICATION:
 WE HEREBY CERTIFY THAT WE THE OWNERS OF THE PROPERTY SHOWN AND DESCRIBED HEREON AND THAT WE ADOPT THE PLAN OF THE SUBDIVISION AND DEDICATED PERPETUAL USE OF ALL STREETS AND EASEMENTS AS NOTED.

Mark Morris Mark Morris
Jason Willis Jason Willis

SURVEYOR'S CERTIFICATION:
 THIS IS TO CERTIFY I HAVE ON THIS DATE SURVEYED THE ABOVE DESCRIBED PROPERTY IN ACCORDANCE WITH MONUMENTS FOUND AND THIS PLAT CONFORMS TO THAT SURVEYED.

H&S HIME PROFESSIONAL SURVEYING SERVICES
 POB No. 353
 BROOKLAND, ARKANSAS 72417

**MERRELL ESTATES, PHASE II
 PLAT "C" @ PAGE 226**

SETBACK NOTES:
 R-1 ZONING
 25' FRONT SETBACK
 7.5 SIDE YARD SEYBACK
 25' REAR SETBACK

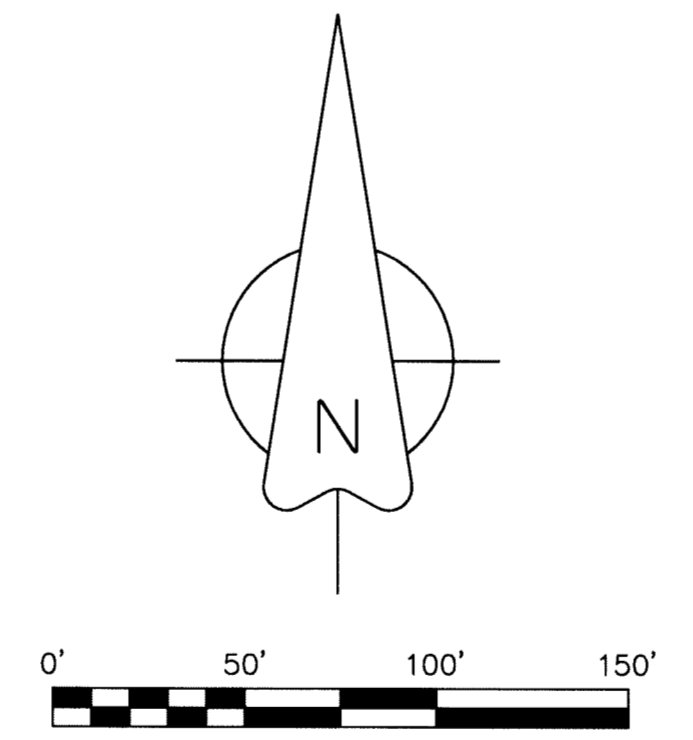

- LEGEND**
- These standard symbols will be found in the drawing.
- FOUND CORNER AS NOTED
 - SET 1/2" REBAR W/ CAP
 - FD COTTON PICKER SPINDLE
 - HIGHWAY RIGHT OF WAY MARKER
 - FOUND REBAR
 - △ CALCULATED CORNER
 - X-X- FENCE LINE
 - E-E- ELECTRIC
 - SET PK NAIL
 - ⊕ POWER POLE

MAPPING POINT
 N528449.959
 E1679024.548

SE CORNER OF THE SOUTHWEST QUARTER OF THE SOUTHWEST QUARTER OF SECTION 3, TOWNSHIP 13 NORTH, RANGE 3 EAST AS MERRELL ESTATES, PHASE I, JONESBORO, AR. PLAT "C" @ PAGE 177

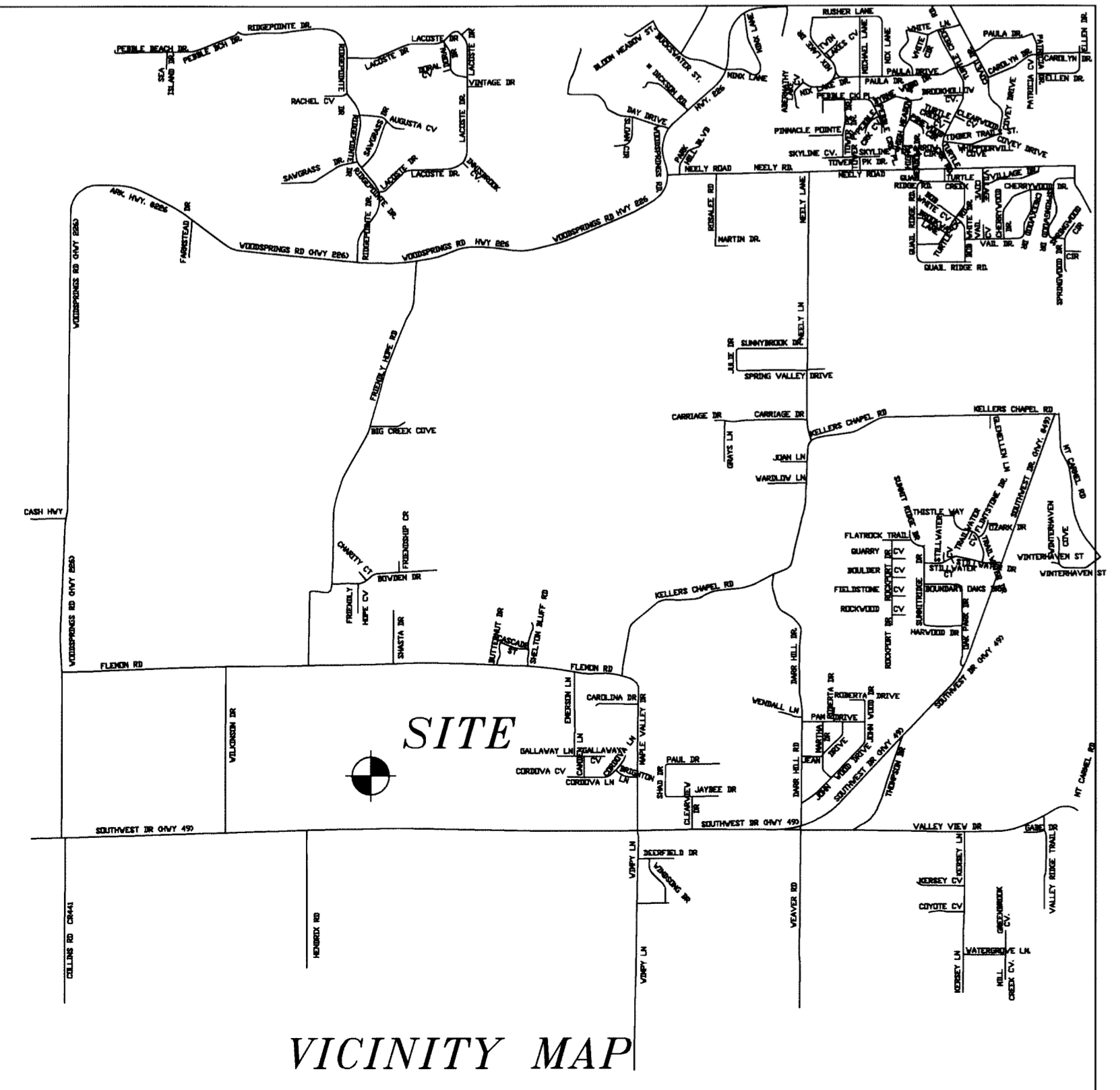

H&S HIME PROFESSIONAL SURVEYING SERVICES
 PHONE: 870-972-1288
 FAX: 870-972-1011
 E-MAIL: hshime_butch@yahoo.com

POB NO. 353
 BROOKLAND, ARKANSAS 72417

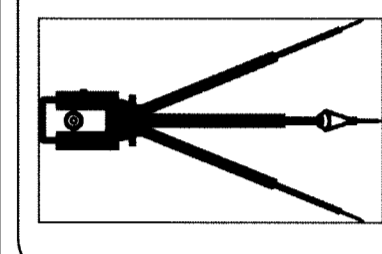

RECORD PLAT
MERRELL ESTATES, PHASE III
JONESBORO, ARKANSAS
 CLEINT: MERRELL ESTATES, LLC.

DATE: 4-29-2013
 REV: 10-29-2013

DRAWN BY: H HIME



HERBERT C. HIME



City of Jonesboro DATE 6/30/13
 FINAL APPROVAL FILE # EP13-03
 FINAL APPROVAL
 PRELIMINARY (NOT FOR RECORDING)
 PLANNING DEPT. APPROVED BY: [Signature]
 ENGINEERING DEPT. APPROVED BY: [Signature]