

**LEGEND**

—	BOUNDARY LINE
- - -	ADJACENT LOT LINE
- · - · -	EASEMENT LINE
○	FOUND IRON PIPE
△	FOUND COTTON PICKER SPINDLE

- SURVEYOR'S NOTES**
1. THIS REZONING PLAT WAS PREPARED FOR JONESBORO CITY WATER AND LIGHT.
  2. NO SEARCH OF THE PUBLIC RECORDS HAS BEEN MADE BY THIS SURVEYOR FOR EASEMENTS, RESTRICTIONS, RESERVATIONS OR RIGHTS-OF-WAY AFFECTING THIS PROPERTY.
  3. SUBJECT PROPERTY IS CURRENTLY ZONED AG-1.
  4. BOUNDARY AND LEGAL DESCRIPTION BY RIDGE SURVEYING AND CONSULTING, JOSH NEELY, P.S.

**OWNER'S CERTIFICATION**

WE HEREBY CERTIFY THAT WE ARE THE OWNERS OF THE PROPERTY AS DESCRIBED HEREON AND THAT WE REQUEST THE CHANGE IN ZONING AS NOTED.

\_\_\_\_\_  
JONESBORO CITY WATER AND LIGHT, OWNER

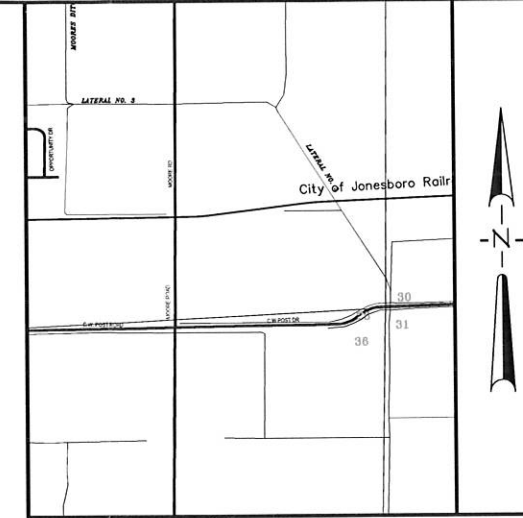

**DESCRIPTION**

LEGAL DESCRIPTION:  
PART OF THE NORTHWEST QUARTER OF THE SOUTHEAST QUARTER OF SECTION 25, TOWNSHIP 14 NORTH, RANGE 04 EAST, JONESBORO, CRAIGHEAD COUNTY, ARKANSAS, BEING MORE PARTICULARLY DESCRIBED AS FOLLOWS:  
BEGINNING AT THE SOUTHWEST CORNER OF THE NORTHWEST QUARTER OF THE SOUTHEAST QUARTER OF SECTION 25, TOWNSHIP 14 NORTH, RANGE 04 EAST, JONESBORO, CRAIGHEAD COUNTY, ARKANSAS; THENCE NORTH 00°53'09" EAST, ALONG THE WEST LINE OF THE NORTHWEST QUARTER OF THE SOUTHEAST QUARTER OF SAID SECTION 25, 10.01 FEET TO THE POINT OF BEGINNING PROPER; THENCE CONTINUE NORTH 00°53'09" EAST, ALONG SAID WEST LINE, 199.83 FEET; THENCE SOUTH 89°40'05" EAST, LEAVING SAID WEST LINE, 533.95 FEET; THENCE SOUTH 06°19'55" WEST, 714.40 FEET TO THE NORTHERLY RIGHT-OF-WAY LINE OF A RAILROAD SPUR; THENCE ALONG SAID NORTHERLY RIGHT-OF-WAY LINE THE FOLLOWING COURSES AND DISTANCES: SOUTH 83°08'41" WEST, 145.90 FEET TO A CURVE TO THE RIGHT; SOUTHWESTERLY ALONG SAID CURVE WITH A CENTRAL ANGLE OF 06°06'12", A RADIUS OF 1874.86 FEET, 199.72 FEET TO A POINT THAT BEARS SOUTH 86°11'49" WEST, 199.62 FEET FROM THE LAST SAID POINT; SOUTH 89°14'55" WEST, 197.38 FEET TO THE POINT OF BEGINNING PROPER, CONTAINING 9.12 ACRES (397,466 SQ. FT.), MORE OR LESS, SUBJECT TO ALL RIGHTS-OF-WAY AND EASEMENTS OF RECORD.

**JONESBORO CITY WATER AND LIGHT**  
MOORE ROAD  
IN SOUTHEAST QUARTER SECT 25, T14N, R4E  
JONESBORO, ARKANSAS

**ASSOCIATED ENGINEERING, LLC**  
CIVIL ENGINEERING • LAND SURVEYING  
LAND PLANNING  
103 SOUTH CHURCH STREET • P.O. BOX 1462  
JONESBORO, AR 72403  
PH: 870-932-3594 • FAX: 870-935-1263

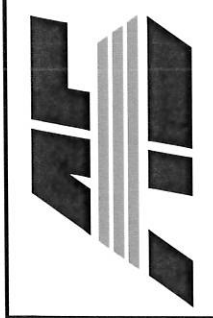

NO.	DESCRIPTION	DATE

**REZONE REQUEST**

DATE: 10/23/2023	DRAWN: JHE
CADD FILE: 23142.001	CHECKED: JHE
DWG# XXXXXXXX.XXXX	SHEET
SCALE: 1" = 50'	1 OF 1