

WANDA TURNER REQUESTS APPROVAL TO PLACE A 10 x 60 MOBILE HOME ON A LOT WITH AN EXISTING HOUSE AT 302 NORTH CULBERHOUSE. SETBACKS AND PETITION REQUIREMENTS ARE SUFFICIENT.

1" = 20'

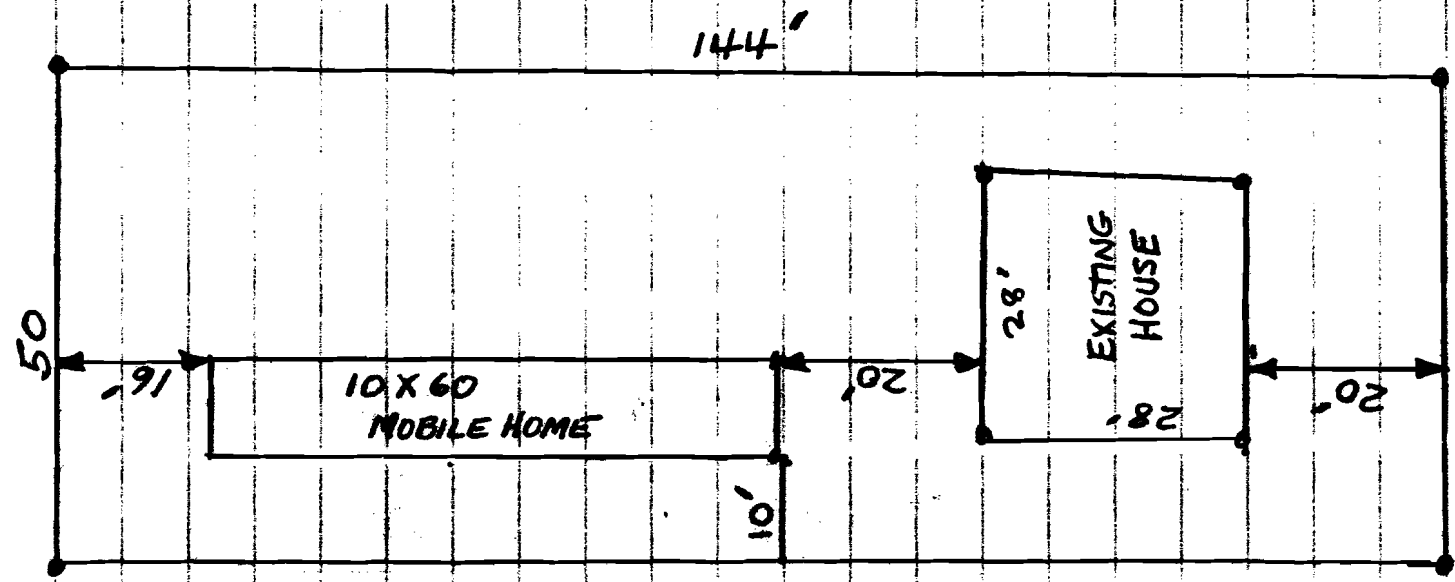

NORTH CULBERHOUSE

14