

LINE #	LENGTH	BEARING
L1	29.00'	N 51°41'00\" W
L2	1.00'	N 31°36'00\" E
L3	31.20'	N 86°45'11\" E
L4	22.60'	S 51°41'00\" E
L5	14.60'	N 03°10'10\" E

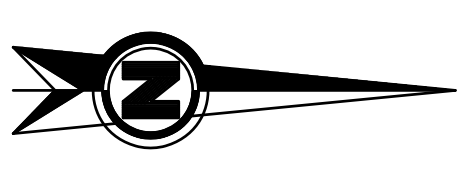

GRAPHIC SCALE
IN FEET

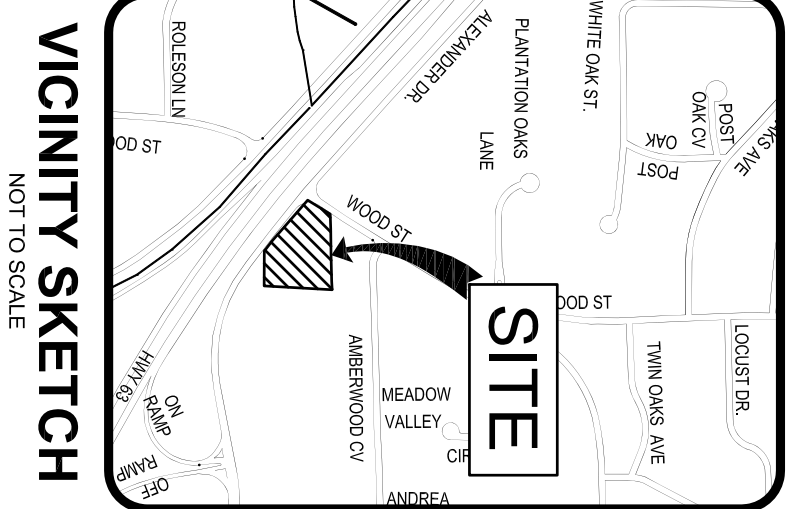

VICINITY SKETCH
NOT TO SCALE

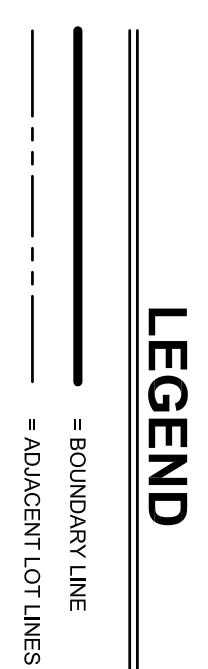

LEGEND

DESCRIPTION

PART OF THE N 1/2 OF S 1/4 OF SECTION 25, TOWNSHIP 14 NORTH, RANGE 3 EAST, BEING MORE PARTICULARLY DESCRIBED AS FOLLOWS:
 TRACT A: BEGIN AT THE WEST CORNER OF LOT 1 OF CATHEDRAL BAPTIST CHURCH ADDITION; THENCE N 51°41' W ON THE NORTHEASTERLY RIGHT-OF-WAY LINE OF U.S. HIGHWAY NO. 63 BYPASS 2B; THENCE N 48°56' W ON SAID RIGHT-OF-WAY LINE 202.45'; TO THE SOUTHEASTERLY LINE OF WOOD STREET U.S. HIGHWAY NO. 63 BYPASS RIGHT-OF-WAY; THENCE N 31°36' E ALONG SAID RIGHT-OF-WAY LINE 100.2' TO A RIGHT-OF-WAY MARKER; THENCE CONTINUE N 31°36' E 1' TO A FENCE; THENCE N 88°54' E ALONG SAID FENCE 55.6'; THENCE N 89°02' E ALONG SAID FENCE 50'; THENCE N 89°16' E ALONG SAID FENCE 50'; THENCE N 89°09' E ALONG SAID FENCE 50'; THENCE N 88°21' E ALONG SAID FENCE 50'; THENCE N 88°45' E ALONG SAID FENCE 31.2' TO THE WEST LINE OF LOT 2 OF CATHEDRAL BAPTIST CHURCH ADDITION; THENCE S 3°10' W ON THE WEST LINE OF AFORESAID LOTS 1 AND 2, 244' TO A CORNER OF SAID LOT 1; THENCE WEST ON A LINE OF SAID LOT 1 - 150.9' TO THE POINT OF BEGINNING, CONTAINING 64,277 SQUARE FEET.
 TRACT B: BEGIN AT THE WEST CORNER OF LOT 1 OF CATHEDRAL BAPTIST CHURCH ADDITION; THENCE S 51°41' E ON THE SOUTHWESTERLY LINE OF SAID LOT 1, 22.6' TO A FENCE; THENCE S 89°46' E ALONG SAID FENCE 132.3' TO A WEST LINE OF SAID LOT 1 PRODUCED SOUTH; THENCE N 3°10' E ON A WEST LINE OF SAID LOT 1 PRODUCED SOUTH 14.6' TO A CORNER OF SAID LOT 1; THENCE WEST ON A LINE OF SAID LOT 1 - 150.9' TO THE POINT OF BEGINNING, CONTAINING 2,024 SQUARE FEET.

SURVEYOR'S NOTES

1. THIS DRAWING WAS PREPARED FOR FIRST BAPTIST CHURCH.
2. THIS DRAWING DOES NOT REPRESENT A BOUNDARY SURVEY.

OWNER'S CERTIFICATION

I HEREBY CERTIFY THAT I AM THE OWNER OF THE ABOVE DESCRIBED PROPERTY AND I HEREBY REQUEST A REZONING FROM:
R-1 TO C-4 LUO
 SIGNED THIS _____ DAY OF _____, 2017. SIGNATURE: _____

BENCHMARK LAND SURVEYING, INC.
 LAND SURVEYING - CONSTRUCTION LAYOUT SERVICES
 2500 ALEXANDER DR., SUITE A
 P.O. BOX 1921 - JONESBORO, AR 72403
 FAX: 870-336-2060 PH: 870-336-2059

REZONING PLAT
FIRST BAPTIST CHURCH
PART OF THE N1/2 OF THE S1/4
SECTION 25 - T14N - R3E
JONESBORO, ARKANSAS

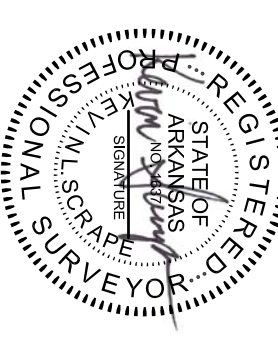
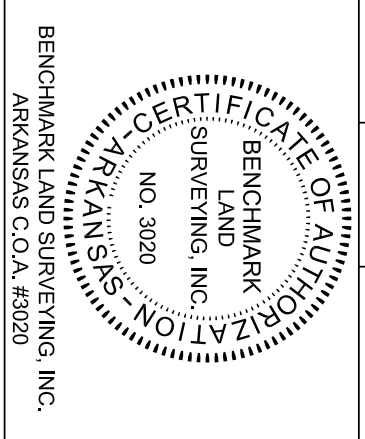

DATE: _____ BY: KEVIN L. SCRAPE
 DESCRIPTION: ARKANSAS PSH1637

CADD FILE: 17133-001 SCALE: 1"=30'
 DATE: 03/31/17 SHEET 1 OF 1
 DWG#: 0314252-0035