

10.0 FOOT DRAINAGE EASEMENT

---

A 10.0 FOOT STRIP OF LAND PARALLEL AND ADJACENT TO THE WEST LINE OF LOT 13 OF THE GREENMEADOW SUBDIVISION LOCATED IN JONESBORO ARKANSAS. SAID STRIP OF LAND IS PRESENTLY RECORDED AS A UTILITY EASEMENT AND SHALL BE USED FOR BOTH UTILITIES AND DRAINAGE.

SIGNED: *Patricia Vanderbilt* DATE: 1-31-05  
\_\_\_\_\_  
DATE \_\_\_\_\_

WITNESS: *Pat Vanderbilt*  
\_\_\_\_\_

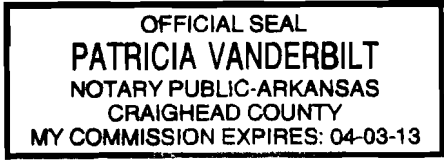

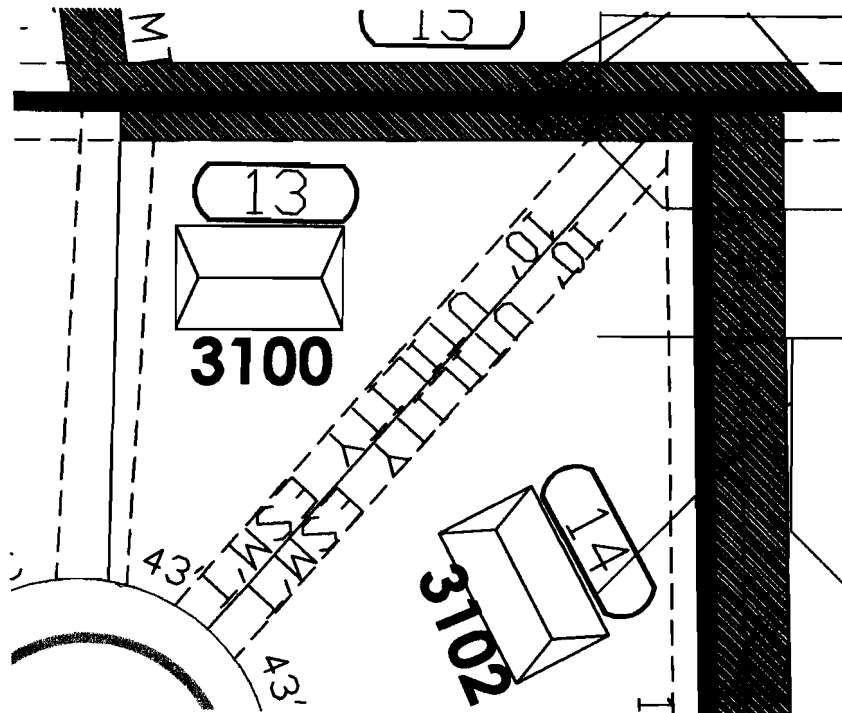

DEED BOOK 707 PAGE 696 - 698  
DATE 10/03/2005  
TIME 09:02:55 AM  
RECORDED IN,  
OFFICIAL RECORDS OF  
CRAIGHEAD COUNTY  
ANN HUDSON  
CIRCUIT CLERK  
RECEIVED # 140775 *Ann Hudson* D.C.