

# HENSON'S MINOR PLAT

## OF

PART OF THE NORTHWEST QUARTER OF THE SOUTHEAST QUARTER OF SECTION 4, TOWNSHIP 13 NORTH, RANGE 4 EAST, CRAIGHEAD COUNTY, ARKANSAS, BEING MORE PARTICULARLY DESCRIBED AS FOLLOWS:  
 BEGIN AT THE NORTHWEST CORNER OF THE NORTHWEST QUARTER OF THE SOUTHEAST QUARTER OF SECTION 4, TOWNSHIP 13 NORTH, RANGE 4 EAST, CRAIGHEAD COUNTY, ARKANSAS; THENCE SOUTH ALONG THE WEST LINE OF THE NORTHWEST QUARTER OF THE SOUTHEAST QUARTER OF SECTION 4, AFORESAID, 480.30 FEET; THENCE NORTH 89°05'00" EAST 57.21 FEET TO THE EAST RIGHT-OF-WAY LINE OF STADIUM BOULEVARD THE POINT OF BEGINNING PROPER; THENCE CONTINUE NORTH 89°05'00" EAST 167.79 FEET; THENCE SOUTH 93.23 FEET; THENCE SOUTH 89°05'00" WEST 167.07 FEET TO THE EAST RIGHT-OF-WAY LINE OF STADIUM BOULEVARD; THENCE NORTH 0°26'33" WEST ALONG SAID RIGHT-OF-WAY LINE 93.22 FEET TO THE POINT OF BEGINNING PROPER, CONTAINING 0.36 ACRES.

NOTE: THIS PROPERTY IS NOT LOCATED IN A FLOOD ZONE ACCORDING TO PANEL 134 OF 200 OF THE NATIONAL FLOOD INSURANCE RATE MAP OF CRAIGHEAD COUNTY, ARKANSAS AND INCORPORATED AREAS, EFFECTIVE DATE SEPTEMBER 27, 1991.

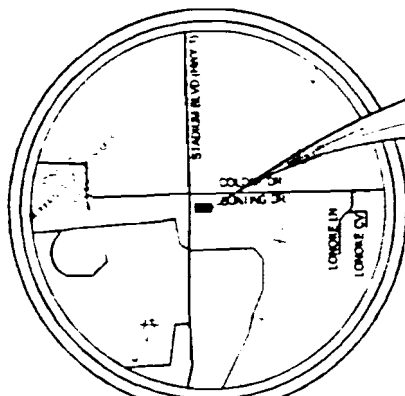
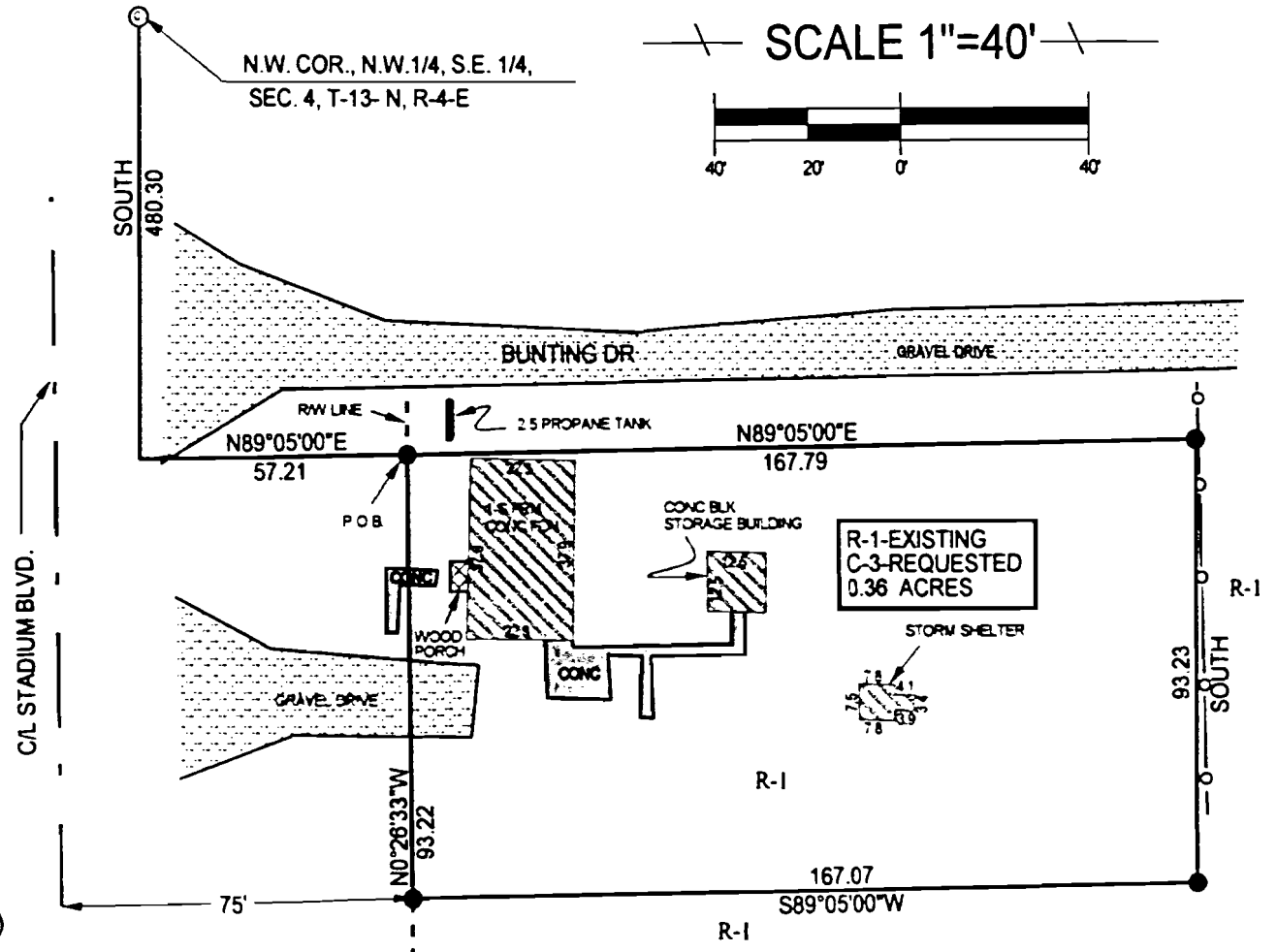

VICINITY MAP  
SCALE 1"=2000'

LEGEND:  
 ○ CHAIN LINK FENCE  
 ⊙ FOUND C.P.S. ● SET PIPE

WE HEREBY CERTIFY THAT WE ARE THE OWNERS OF THE PROPERTY SHOWN AND DESCRIBED HEREON, THAT WE ADOPT THE PLAN OF SUBDIVISION AND DEDICATE PERPETUAL USE OF STREETS AND EASEMENTS AS NOTED.

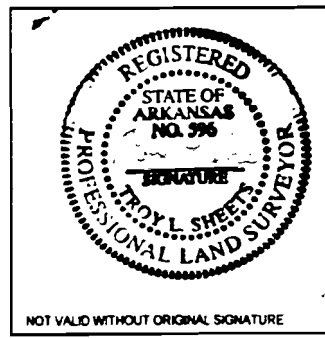
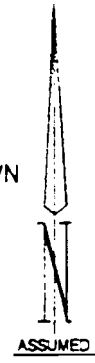

**TROY L. SHEETS SURVEYING**

"WE SURVEY THE EARTH"

205 WARNER \* P.O. BOX 1672  
 JONESBORO, ARKANSAS 72403  
 PH 870/935-2630 FAX 870/935-1263

CLIENT	TERRY HENSON	DRAWN BY	SDG
DATE	8-10-2000	SCALE	1"=40'
		JOB NO.	00106
500-13N-04E-0-04-240-16-0596			

NOT VALID WITHOUT ORIGINAL SIGNATURE

Private Dr.

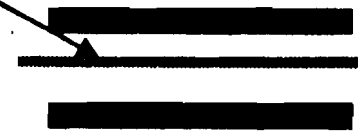









Fox Meadow



Stadium Blvd



Map Key

-  Commercial
-  Residential
-  Open Lot
-  To Be Rezoned
-  Industrial
-  Human Development Center
-  Nonconforming
-  Rail Road Tracks
-  Street/Road

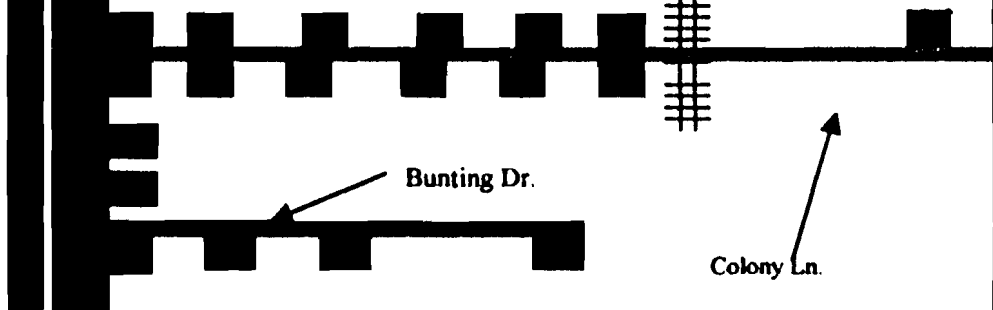

Bunting Dr.

Colony Ln.

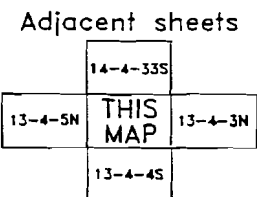
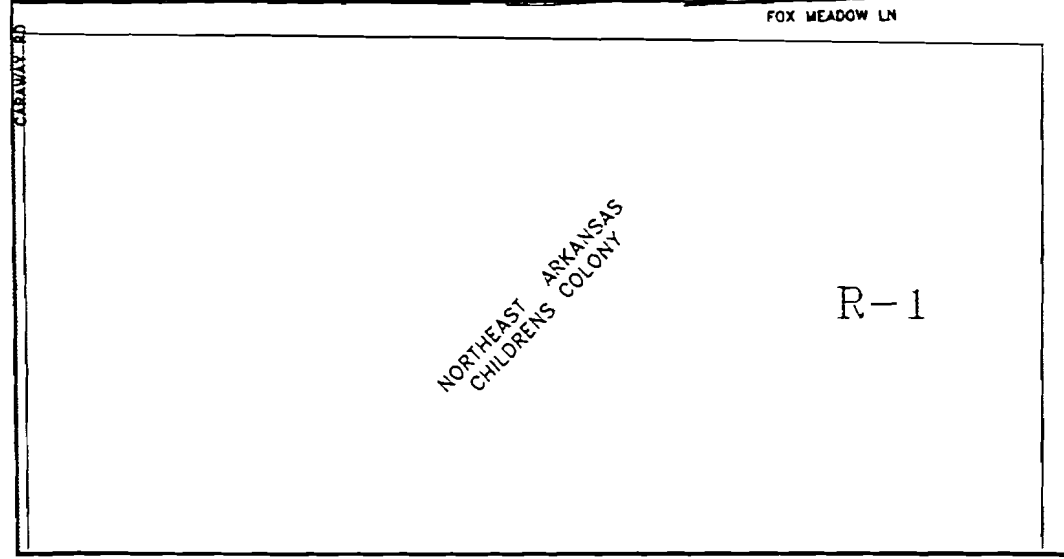
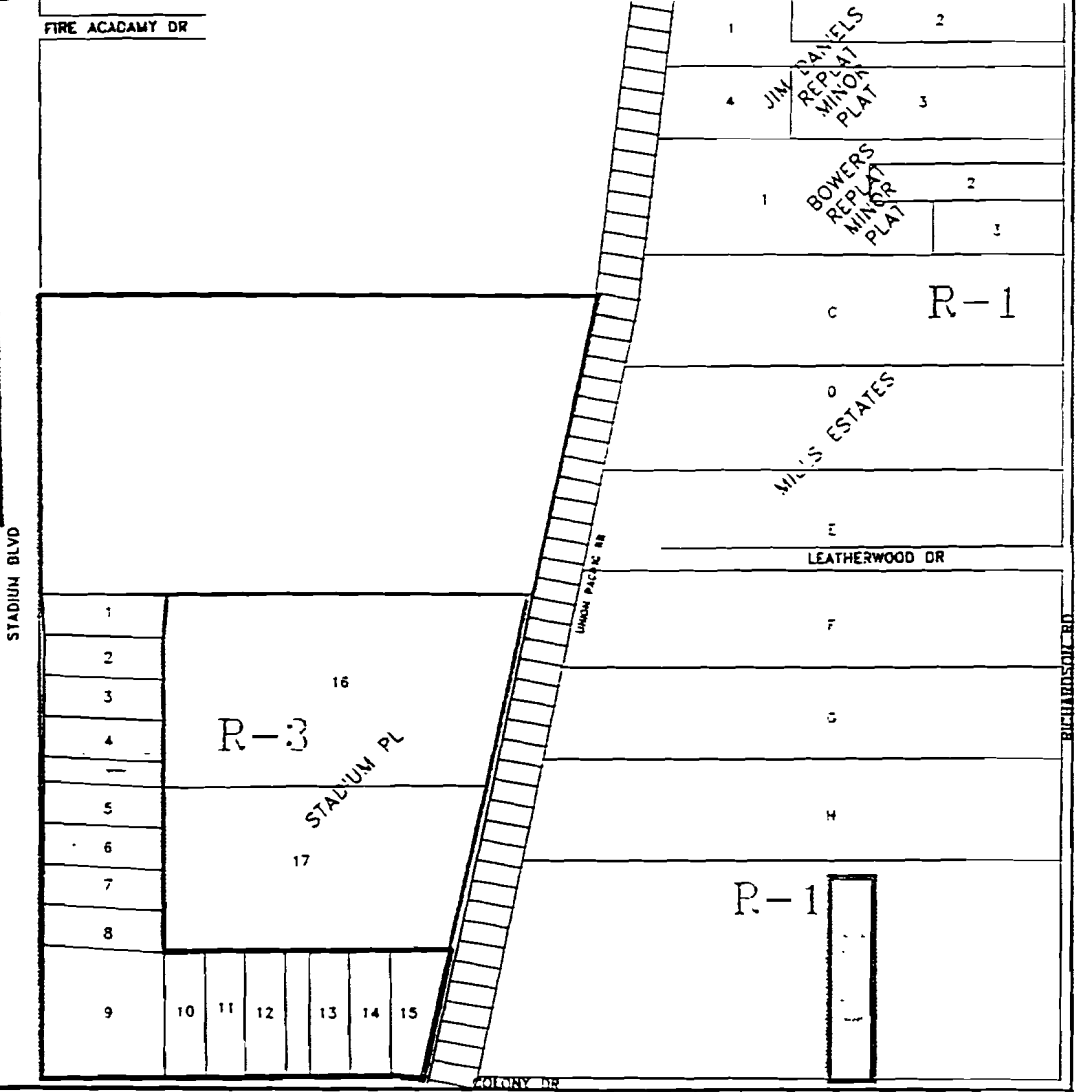
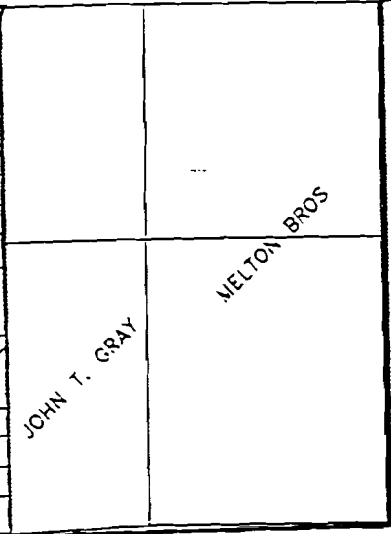
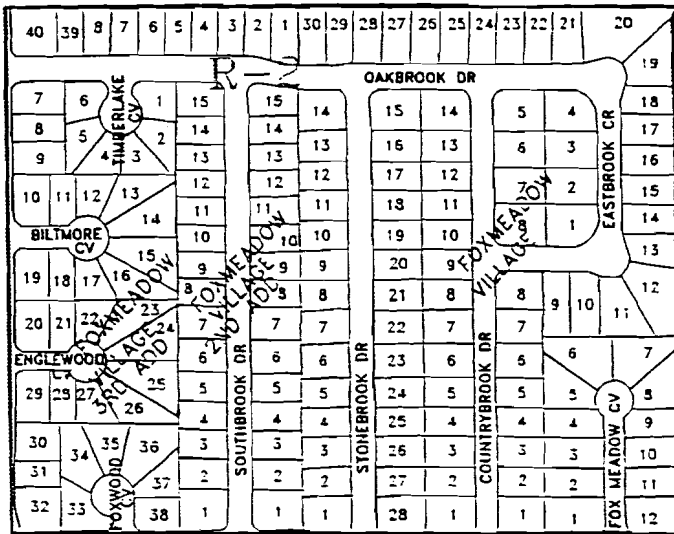

# NORTH HALF SECTION 4

T-13-N , R-4-E

City of Jonesboro

THIS MAP IS FOR PLANNING PURPOSES ONLY

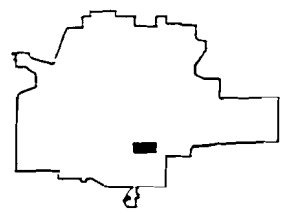

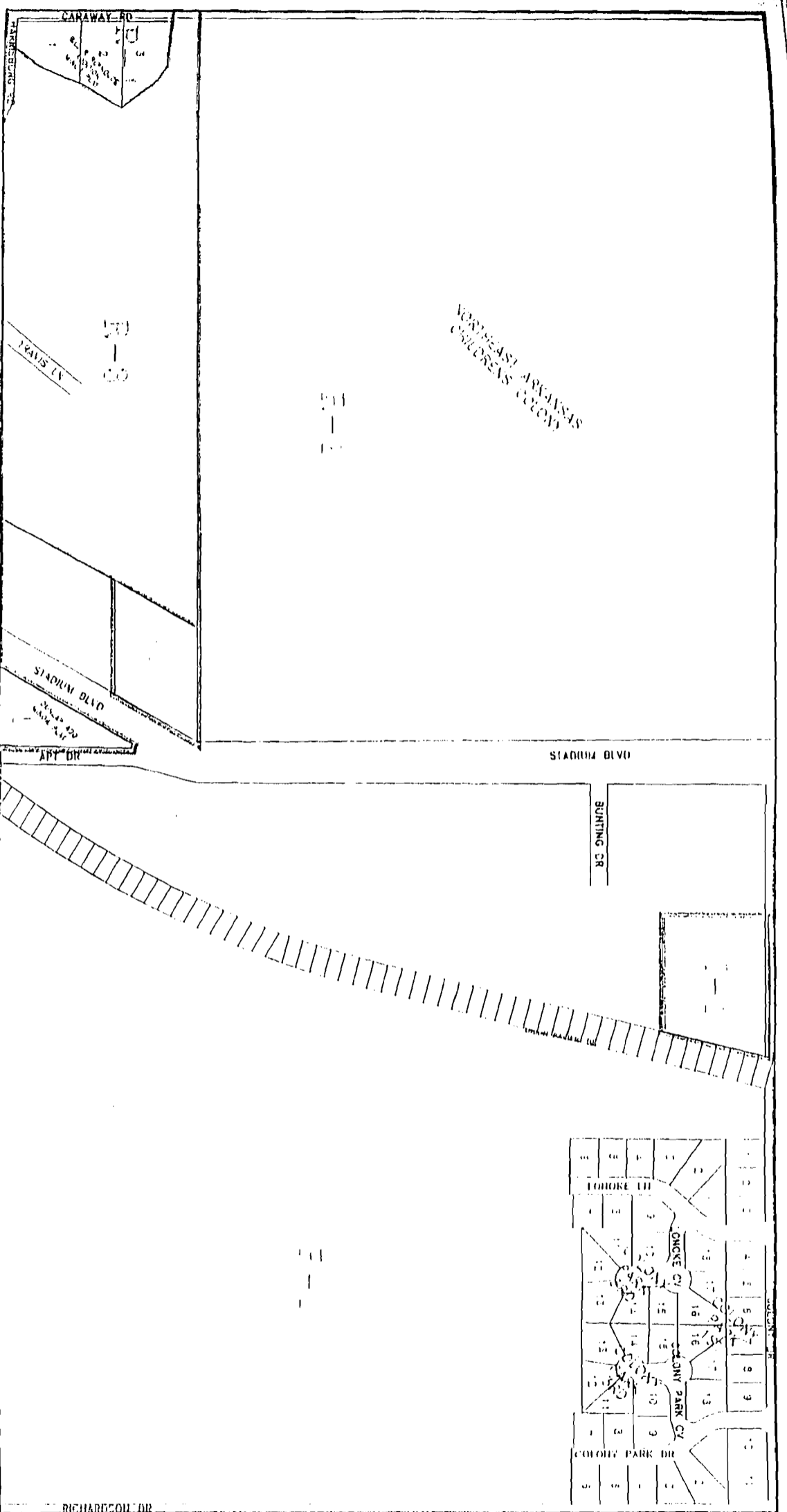

Adjacent sheets

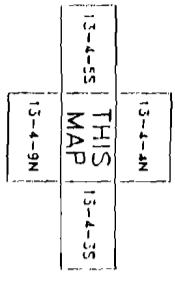

# SOUTH HALF SECTION 4

T-13-N, R-4-E

City of Jonesboro

THIS MAP IS FOR PLANNING PURPOSES ONLY

