

C-3 LUO:

- LIMITED USE TO EXCLUDE:
- ENTERTAINMENT, ADULT

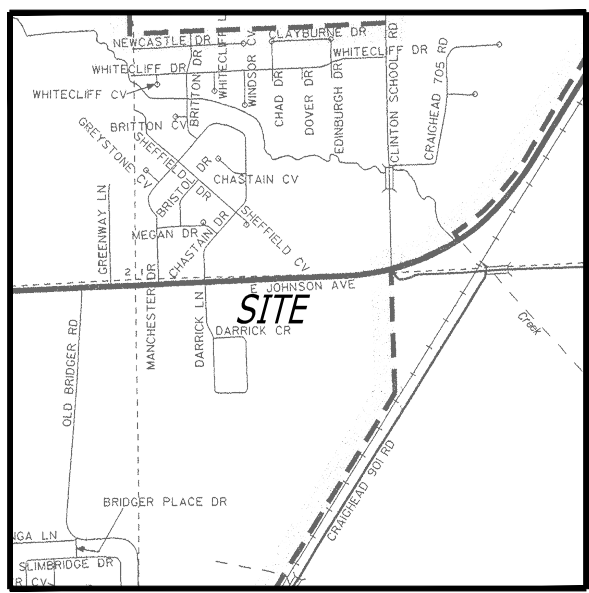

VICINITY MAP
(N.T.S.)



RIDGE SURVEYING & CONSULTING, PLLC.
 311 South Church St., Suite H
 Jonesboro, AR 72401
 870-203-9940
 mike@ridgesurveying.net

REZONING PLAT
CLIENT: SUKUP MANUFACTURING
 A PART OF THE NORTHWEST QUARTER
 OF THE NORTHWEST QUARTER OF SECTION 12,
 TOWNSHIP 14 NORTH, RANGE 04 EAST,
 JONESBORO, CRAIGHEAD COUNTY, ARKANSAS

SURVEYOR'S NOTES:

1. SURVEYOR HAS MADE NO INVESTIGATION OR INDEPENDENT SEARCH FOR EASEMENTS OF RECORD OR ANY OTHER FACTS WHICH AN ACCURATE TITLE SEARCH MAY DISCLOSE.
2. THE FOLLOWING DOCUMENTS WERE USED TO COMPLETE THIS SURVEY:
 - WARRANTY DEED, DEPARTMENT OF INDUSTRIAL DEVELOPMENT TO SUKUP MANUFACTURING COMPANY, RECORDED IN BOOK 460, PAGES 129-131, DATED MAY 06, 1994.
 - WARRANTY DEED, BRIDGER TO BRIDGER, RECORDED IN BOOK 464, PAGES 384-385, DATED JULY 27, 1994.
 - WARRANTY DEED, MALONEY TO SUKUP MANUFACTURING COMPANY, RECORDED IN BOOK 476, PAGE 655, DATED MAY 05, 1995.
 - RECORD PLAT, GOTT SUBDIVISION, RECORDED IN BOOK 123, PAGE 227, DATED FEBRUARY 23, 1965.
 - RIGHT-OF-WAY PLANS, A.H.T.D. JOB NO. 10212, DATED SEPTEMBER 07, 1939.
3. THE SUBJECT PROPERTY IS ZONED R-1, SINGLE-FAMILY MEDIUM DENSITY DISTRICT.
4. R-1 BUILDING SETBACKS:
 25' STREET SETBACK
 7.5' SIDE SETBACK
 20' REAR SETBACK
5. PROPOSED ZONING C-3 LUO, GENERAL COMMERCIAL DISTRICT LIMITED USE OVERLAY.
6. **SITE IS SUBJECT TO AN *ON-THE-GROUND* SURVEY TO VERIFY ANY AND ALL DIMENSIONS OF THE PROPERTY SHOWN, ALSO THE LEGAL DESCRIPTION AS SHOWN IS PER WARRANTY DEED - BOOK 476, PAGE 655**



LEGAL DESCRIPTION: (WARRANTY DEED - BOOK 476, PAGE 655)

THE EAST 115 FEET OF THE NORTH 393.6 FEET OF THE NORTHWEST QUARTER OF THE NORTHWEST QUARTER OF SECTION 12, TOWNSHIP 14 NORTH, RANGE 4 EAST, SUBJECT TO RIGHT OF WAY FOR HIGHWAY NO. 1 ACROSS THE NORTH SIDE THEREOF, BEING SUBJECT TO ANY EASEMENTS OF RECORD.

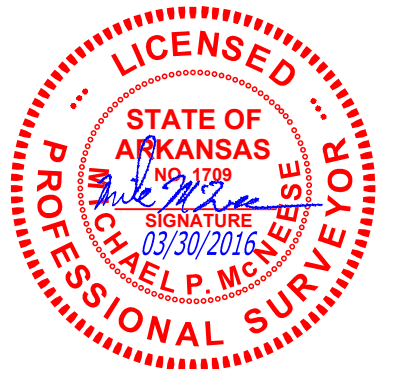

OWNERS CERTIFICATION:

I, HEREBY CERTIFY THAT I AM THE OWNER OF THE ABOVE DESCRIBED PROPERTY AND I HEREBY REQUEST A REZONING FROM:
(R-1) SINGLE-FAMILY MEDIUM DENSITY DISTRICT TO (C-3 LUO) GENERAL COMMERCIAL DISTRICT - LIMITED USE OVERLAY

SIGNED THIS 4TH DAY OF APRIL, 2016.
 SIGNATURE: Maude Bralley



DRAWING INFO	
DRAWN BY: JJN	SCALE: 1" = 100'
DATE: 03 / 30 / 2016	JOB NO: 16152-R
REVISIONS	
500-14N-04E-0-12-440-16-1709	