

MAPPING POINT 'A'  
NORTHING: 532,650.43  
EASTING: 1,685,329.09

**7.88 ACRES**  
**31 LOTS**

**SETBACK NOTES:**  
R-1 ZONING  
25' FRONT SETBACK  
7.5 SIDE YARD SETBACK  
25' REAR SETBACK

**LEGEND**

- These standard symbols will be found in the drawing.
- FOUND CORNER AS NOTED
  - SET 1/2" REBAR W/ CAP
  - ◐ FD COTTON PICKER SPINDLE
  - ▲ HIGHWAY RIGHT OF WAY MARKER
  - ⊙ FOUND REBAR
  - △ CALCULATED CORNER
  - X—X— FENCE LINE
  - E—E— ELECTRIC
  - SET PK NAIL
  - ⊥ POWER POLE

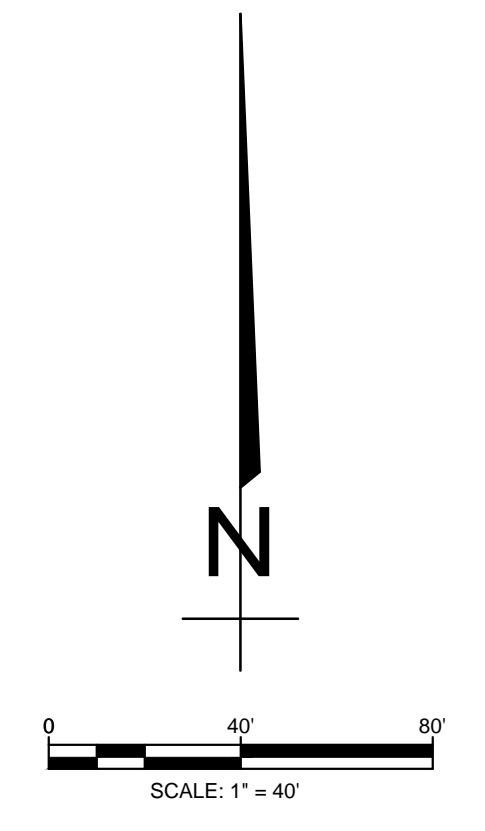

- SURVEYORS NOTES:**
- BEARINGS ARE STATE PLANE GRID BEARINGS/NAD 83 DATUM/AS PER GPS OBSERVATION ON SITE DURING SURVEY AND ARE TO BE USED TO DEFINE THE GENERAL DIRECTION AND TRUE ANGLE AT THE INTERSECTION OF THE PROPERTY AND LAND LINES.
  - PROPERTY IS SUBJECT TO UTILITY SERVICES AND UNDERGROUND UTILITY LINES NOT LOCATED.

**OWNER CERTIFICATION:**  
WE HEREBY CERTIFY THAT WE THE OWNERS OF THE PROPERTY SHOWN AND DESCRIBED HEREON AND THAT WE ADOPT THE PLAN OF THE SUBDIVISION AND DEDICATED PERPETUAL USE OF ALL STREETS AND EASEMENTS AS NOTED.

**SURVEYOR'S CERTIFICATION:**  
THIS IS TO CERTIFY I HAVE ON THIS DATE SURVEYED THE ABOVE DESCRIBED PROPERTY IN ACCORDANCE WITH MONUMENTS FOUND AND THIS PLAT CONFORMS TO THAT SURVEYED.

**H&S HIME PROFESSIONAL SURVEYING SERVICES**  
POB No. 353  
BROOKLAND, ARKANSAS 72417

**JUDE'S CROSSING PHASE 2**  
**JONESBORO, ARKANSAS**  
**PLAT - NOT FOR RECORDING**

DATE:  
REV:  
REVIEWED BY: H. HIME  
DRAWN BY: B. WOOD

**H&S HIME PROFESSIONAL SURVEYING SERVICES**  
PHONE: 870-972-1288  
FAX: 870-972-1011  
E-MAIL: hshime\_butch@yahoo.com

POB NO. 353  
BROOKLAND, ARKANSAS 72417

