



Log In

Links

- [Home](#)
- [My Account](#)
- [Contact Us](#)
- [Help](#)

New Users

- [About our Service](#)
- [Account Signup](#)
- [Test Drive](#)

PARCEL DETAILS

Basic Information

Parcel Number: 01-143144-08400
County Name: Craighead County
Ownership Information: CALVARY CHAPEL OF JONESBORO INC
 JONESBORO, AR
Billing Information [?]: CALVARY CHAPEL
 411 CALVARY COVE
 JONESBORO AR 72401
Total Acres: 4.06
Timber Acres: 0.00
Sec-Twp-Rng: 14-14-03
Lot/Block: 1/
Subdivision: CALVARY CHAPEL CHURCH REPLAT
Legal Description: CALVARY CHAPEL REPLAT OF LOT 1 OF WASHINGTON GROVE ADD PT SE & REPLAT OF LOTS 2-3-4
School District: J JB JONESBORO CITY
Homestead Parcel?: No
Tax Status: Exempt
Over 65?: No

Land Information

Land Divisions:	Land Type	Quantity	Front Width	Rear Width	Depth 1	Depth 2	Quarter
	COMM	4.06 acres [0 sqft]	0	0	0	0	

Valuation Information

	Appraised	Assessed
Land:	30,000	6,000
Improvements:	0	0
Total Value:	30,000	6,000
Taxable Value:		6,000
Millage:		0.0422
Estimated Taxes [?]:		\$253.20
Assessment Year:		2005

What do these
 OBYI
 abbreviations
 mean?



Sales History

Date	Price	Grantor	Grantee	Book	Page	Deed Type
11/24/2004	200,000	MACON ENTERPRISES	CALVARY CHAPEL OF JONESBORO	685	845	OPI(MULTI SALE)



Log In

Links

PARCEL DETAILS

- [Home](#)
- [My Account](#)
- [Contact Us](#)
- [Help](#)

New Users

- [About our Service](#)
- [Account Signup](#)
- [Test Drive](#)

What do these
 OBVI
 abbreviations
 mean?

A Service Of
Apprentice
 Information
 Systems, Inc.

Basic Information

Parcel Number: 01-143144-08300
County Name: Craighead County
Ownership Information: LLJ INVESTMENTS LLC
 1900 W WASHINGTON
 JONESBORO, AR
[Map This Address](#)
Billing Information [?]: LLJ INVESTMENTS LLC
 C/O LORETTA BOOKOUT
 1717 JAMES ST
 JONESBORO AR 72401
Total Acres: 1.85
Timber Acres: 0.00
Sec-Twp-Rng: 14-14-03
Lot/Block: 1/
Subdivision: WASHINGTON GROVE ADD EXTENDED
Legal Description: WASHINGTON GROVE ADDITION EXTENDED REPLAT LOT 1 BLK A WASHINGTON GROVE ADD& PT SE
School District: J JB JONESBORO CITY
Homestead Parcel?: No
Tax Status: Taxable
Over 65?: No

Land Information

Land Divisions:	Land Type	Quantity	Front Width	Rear Width	Depth 1	Depth 2	Quarter
	COMM	1.85 acres [80,586 sqft]	0	0	0	0	

Valuation Information

	Appraised	Assessed
Land:	83,250	16,650
Improvements:	591,050	118,210
Total Value:	674,300	134,860
Taxable Value:		134,860
Millage:		0.0422
Estimated Taxes [?]:		\$5,691.09
Assessment Year:		2012

Sales History

Date	Price	Grantor	Grantee	Book	Page	Deed Type
3/12/2003	85,000	MACON ENTERPRISES	LLJ INVESTMENTS	642	470	WD(WARRANTY DEED)
6/8/1999	120,000	WALDEN ETAL	MACON	576	780	

Improvement Information

Commercial Improvements

Commercial Improvement #1

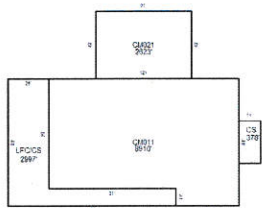

Building Section #: 1

Business Name: ROLLER FARMER UNION FUNERAL HM
Location: 1900 W WASHINGTON
Total SF: 8,910
Stories: 1
Year Built: 2004
Effective Age: 8
Occupancy: Code Description Class Percent



Log In

Links

- [Home](#)
- [My Account](#)
- [Contact Us](#)
- [Help](#)

Reports

- [Parcel Detail](#)
- [Parcel History](#)
- [Legal & Land Use](#)

What do these
 OBVI
 abbreviations
 mean?



PARCEL DETAILS

Basic Information

Parcel Number: 01-143144-01800
County Name: Craighead County
Ownership Information: DOWNTOWN CHURCH OF CHRIST
 JONESBORO, AR
Billing Information [?]: DOWNTOWN CHURCH OF CHRIST

Total Acres: 0.00
Timber Acres: 0.00
Sec-Twp-Rng: 14-14-03
Lot/Block: A/
Subdivision: DOWNTOWN CHURCH OF CHRIST 1ST
Legal Description: DOWNTOWN CHURCH OF CHRIST FIRST REPLAT& ADDITION
School District: J JB JONESBORO CITY
Homestead Parcel?: No
Tax Status: Exempt
Over 65?: No

Land Information

Land Divisions:	Land Type	Quantity	Front Width	Rear Width	Depth 1	Depth 2	Quarter
	RESHS	1 lots [0 sqft]	0	0	0	0	

Valuation Information

	Appraised	Assessed
Land:	7,400	1,480
Improvements:	800,450	160,090
Total Value:	807,850	161,570
Taxable Value:		82,270
Millage:		0.0422
Estimated Taxes [?]:		\$3,471.79
Assessment Year:		2014

Sales History

No sales history available

[1]

Improvement Information

Commercial Improvements

Commercial Improvement #1

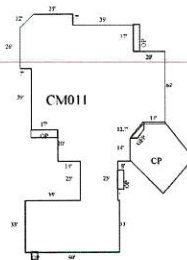

Building Section #: 1
Business Name: DOWNTOWN CHURCH OF CHRIST
Location: WASHINGTON AVE
Total SF: 9,198
Stories: 1
Year Built:
Effective Age: 10
Occupancy:

Code	Description	Class	Percent
323	Fraternal Building	D-3	100%

Structural Elements:

Description	Qty.
Ceilings Acoustic	X
Ceilings Suspension System	X
Electrical Average	X



Log In

Links

- [Home](#)
- [My Account](#)
- [Contact Us](#)
- [Help](#)

Reports

- [Parcel Detail](#)
- [Parcel History](#)
- [Legal & Land Use](#)

PARCEL DETAILS

Basic Information

Parcel Number: 01-143144-01900
County Name: Craighead County
Ownership Information: CRAFT JERRY B
 WASHINGTON
 JONESBORO, AR
Billing Information [?]: JERRY CRAFT INC
 1007 SOUTH GEE
 JONESBORO AR 72401
Total Acres: 0.00
Timber Acres: 0.00
Sec-Twp-Rng: 14-14-03
Lot/Block: 1/
Subdivision: STRATFORD HEIGHTS
Legal Description: STRATFORD HEIGHTS
School District: J JB JONESBORO CITY
Homestead Parcel?: No
Tax Status: Taxable
Over 65?: No

Land Information

Land Divisions:	Land Type	Quantity	Front Width	Rear Width	Depth 1	Depth 2	Quarter
	RESHS	1 lots [0 sqft]	0	0	0	0	

Valuation Information

	Appraised	Assessed
Land:	6,000	1,200
Improvements:	0	0
Total Value:	6,000	1,200
Taxable Value:		1,200
Millage:		0.0422
Estimated Taxes [?]:		\$50.64
Assessment Year:		2013

What do these
 ? OBVI
 abbreviations
 mean?



Sales History

No sales history available

[1]