

DESCRIPTION:
 A PART OF THE EAST 20.5 ACRES OF THE SOUTHEAST QUARTER OF SECTION 35, TOWNSHIP 15 NORTH, RANGE 4 EAST, CRAIGHEAD COUNTY, ARKANSAS AND BEING MORE PARTICULARLY DESCRIBED AS FOLLOWS:
 Beginning at the Southeast corner of said Section 35; thence North 00°10'24" West 546.83 feet (record 546.70"); thence South 89°30'19" West 676.94 feet (record 676.50); thence South 00°13'40" East 546.70 feet; thence North 89°31'00" East 676.50 feet; to the point of beginning proper, having an area of 369977.11 square feet, 8.49 acres more or less and being subject to all public and private roads and easements.

OWNER CERTIFICATION:
 WE HEREBY CERTIFY THAT WE THE OWNERS OF THE PROPERTY SHOWN AND DESCRIBED HEREON AND THAT WE ADOPT THE PLAN OF THE SUBDIVISION AND DEDICATED PERPETUAL USE OF ALL STREETS AND EASEMENTS AS NOTED AND WE FURTHER CERTIFY THAT WE HAVE READ AND ACKNOWLEDGED THE FOLLOWING STATEMENT.

THE SUBDIVIDER OR DEVELOPER MUST, BEFORE THE SALE OF ANY LOT OR LOTS, EITHER COMPLETE THE IMPLEMENTS DESIGNED IN SECTION 15.16.01 OF THE JONESBORO SUBDIVISION REGULATION AND AS SPECIFICALLY IDENTIFIED OF THE RECORD PLAT AND SUPPORT DOCUMENTATION OR FURNISH THE METROPOLITAN AREA PLANNING COMMISSION EVIDENCE THAT AN APPROPRIATED FUNDED ESCROW AGREEMENT IN THE AMOUNT OF CONTRACT COST OF STREET IMPROVEMENTS REQUIRED BY SECTION 16.15.01 THAT ARE NOT COMPLETED AT THE DATE OF SALE OF THE LOT OR LOTS FROM CLOSEST IMPROVED STREET TO AND INCLUDING ALL FRONT FEET OF SAID LOT OR LOTS

SURVEYOR'S CERTIFICATION:
 THIS IS TO CERTIFY I HAVE ON THIS DATE SURVEYED THE ABOVE DESCRIBED PROPERTY IN ACCORDANCE WITH MONUMENTS FOUND AND THIS PLAT CONFORMS TO THAT SURVEYED.

H&S HIME PROFESSIONAL SURVEYING SERVICES
 PMB #283, 2704 SO. CULBERHOUSE STE "L", JONESBORO, ARKANSAS

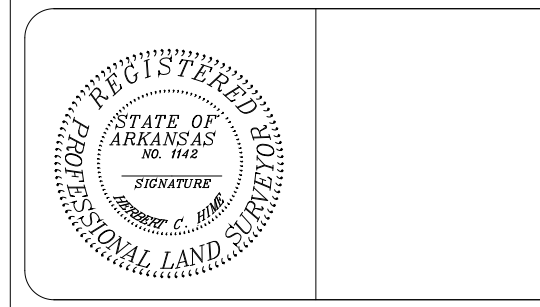

H&S Hime Professional Surveying Services
 PMB #283
 2704 SO. CULBERHOUSE STE "L"
 JONESBORO, ARKANSAS 72401

PHONE: 870 972 1288
 FAX: 870 972 1011
 E-MAIL: hshime_butch@yahoo.com

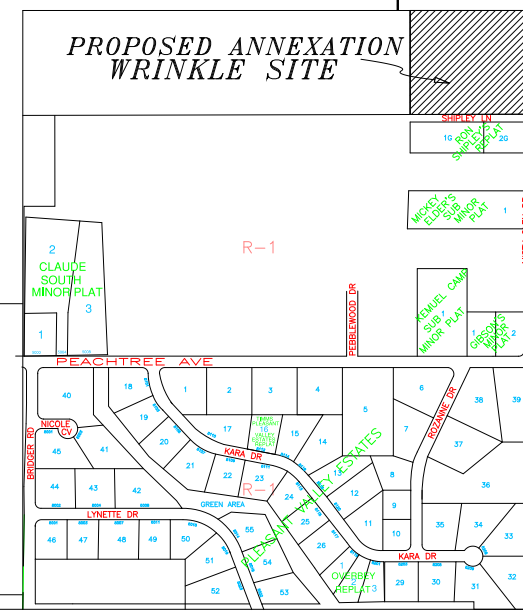
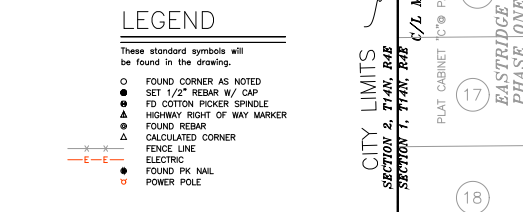

ANNEXATION PLAT

drawn by: HH
 date: 12-03-2007
 scale: 1"=100'

client: RANDY & BECKY WRINKLES

THE SOUTHEAST QUARTER OF SECTION 35,
 TOWNSHIP 15 NORTH, RANGE 4 EAST,
 CRAIGHEAD COUNTY, ARKANSAS