

POINT OF COMMENCEMENT
N.E. CORNER OF
NE 14/8W/4
SECTION 23/14/3

POINT OF BEGINNING

C-3 ZONING
NOT INCLUDED

MANOR HEIGHTS
ADDITION
NOT INCLUDED

EXISTING C-3 ZONING
REQUESTING R-1A ZONING
554,840 SQ. FT.
12.737 ± ACRES

SCALE: 1" = 200'

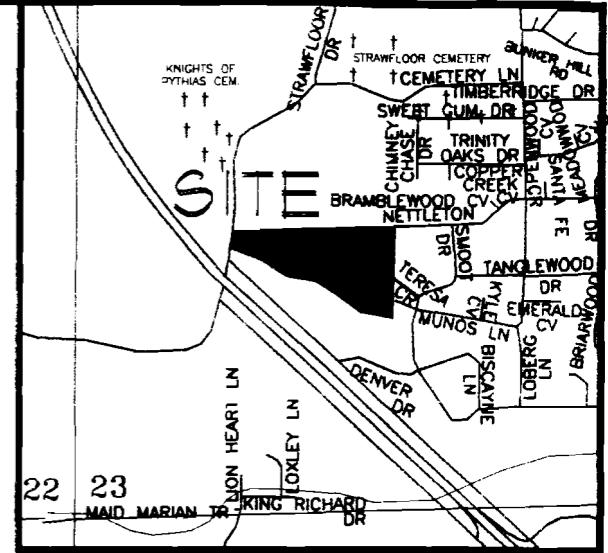
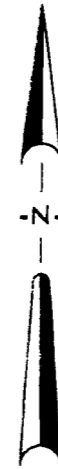

VICINITY SKETCH
NOT TO SCALE

OWNER'S CERTIFICATION

WE HEREBY CERTIFY THAT WE ARE OWNERS OF THE PROPERTY AS DESCRIBED HEREON, AND THAT WE REQUEST THE CHANGE IN ZONING AS SHOWN HEREON.

Alec Farmer, President

FARMER ENTERPRISES
ALEC FARMER, PRESIDENT

ASSOCIATED ENGINEERING AND TESTING, LLC
CIVIL ENGINEERING, LAND SURVEYING AND MATERIALS TESTING
1825 E. NETTLETON AVENUE SUITE 1 - JONESBORO, AR 72401
PH: 870-932-3594 FAX: 870-935-1263

REZONING REQUEST FOR FARMER ENTERPRISES JONESBORO, ARKANSAS

DRAWN: KLS/CADD	CHECKED: KLS	DATE: 12/12/01	SHEET
SCALE: 1" = 200'	CADD FILE: 96106-32	DWG#: 0314233.0003	1 OF 2

GENERAL NOTES

DESCRIPTION ON PAGE 2 OF 2.

LEGEND

- BOUNDARY LINE
- F.I.P. FOUND IRON PIPE
- S.I.P. SET IRON PIPE W/ PLS 166 CAP

© Copyright 2001 A.E. & T., LLC

DATE	REVISIONS	BY

C-3 ZONING
NOT INCLUDED

C-3 ZONING
NOT INCLUDED

R-1 ZONING
BRIARWOOD
4TH ADDITION
NOT INCLUDED

TERESA
CIRCLE
R-2 ZONING
BRIARWOOD
6TH ADDITION
NOT INCLUDED

