

DESCRIPTION
ALL OF LOTS 117, 118, 119, 120, 121, & 122 OF COLLEGE PLACE ADDITION TO THE CITY OF JONESBORO RECORDED IN DEED BOOK 48, AT PAGE 120, IN THE OFFICE OF THE CIRCUIT CLERK FOR CRAIGHEAD COUNTY IN JONESBORO, ARKANSAS.

CERTIFICATION
I HEREBY CERTIFY THAT McALISTER ENGINEERING HAS THIS DATE MADE A BOUNDARY SURVEY OF THE ABOVE DESCRIBED PROPERTY IN COMPLIANCE WITH THE ARKANSAS MINIMUM STANDARDS FOR PROPERTY BOUNDARY SURVEYS AND PLATS AND THAT ALL PROPERTY LINES AND CORNER MONUMENTS HAVE BEEN CORRECTLY ESTABLISHED TO THE BEST OF MY KNOWLEDGE AND BELIEF.

CLARENCE W. McALISTER, PS 1303 _____ DATE _____

OWNER'S CERTIFICATION
WE, ADRIAN PARKER AND DAVID FOWLKES, HEREBY CERTIFY THAT GRACE BAPTIST CHURCH IS THE OWNER OF THE DESCRIBED PROPERTY HEREON AND THAT WE HAVE CAUSED SAME TO BE PLATTED AS SHOWN HEREON; AND WE HEREBY DEDICATE ADDITIONAL RIGHT OF WAY FOR ELDRIDGE STREET AND THE MARION BERRY PARKWAY AS SHOWN FOR THE PERPETUAL USE OF THE PUBLIC.

ADRIAN PARKER, PASTOR _____ DATE _____

DAVID FOWLKES, HEAD DEACON _____ DATE _____

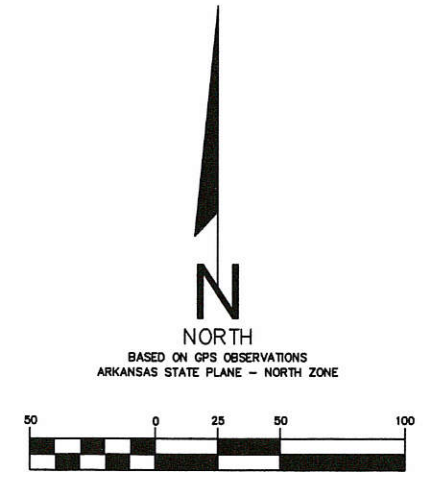

(IN FEET)
1 inch = 50 ft.

LEGEND

- FOUND IRON PIN (1" DIA PIPE)
- SET IRON PIN (1/2" REBAR W/ PS1303 CAP)
- COMPUTED POINT / POINT NOT SET
- FENCE LINE
- LOT LINE TO BE EXTINGUISHED

- NOTES:**
- RIGHT-OF-WAY TO BE ABANDONED - A PART OF AN ALLEY (15'X95' AS SHOWN) IN COLLEGE PLACE ADDITION
 - CLIENT - GRACE BAPTIST CHURCH

- REFERENCE DOCUMENTS:**
- PLAT OF COLLEGE PLACE ADDITION TO THE CITY OF JONESBORO RECORDED IN DEED RECORD BOOK 48, PAGE 120, IN THE OFFICE OF THE CIRCUIT CLERK FOR CRAIGHEAD COUNTY, AR, IN JONESBORO, AR.
 - REPLAT OF PART OF LOTS 123, 124, 125, 126 & 127 OF COLLEGE PLACE ADDITION TO JONESBORO, ARKANSAS RECORDED IN PLAT CABINET "A", PAGE 129, IN THE OFFICE OF THE CIRCUIT CLERK FOR CRAIGHEAD COUNTY, AR, IN JONESBORO, AR.

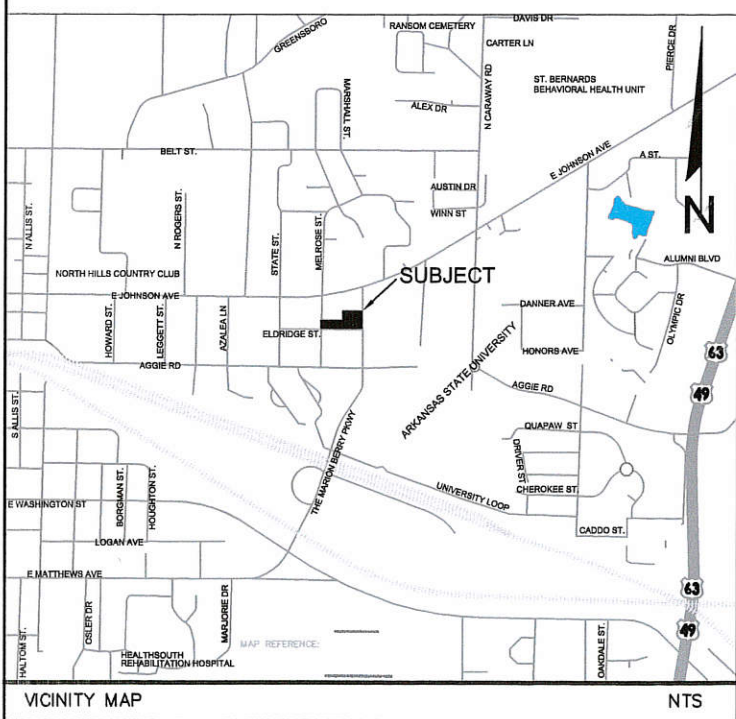

REDUCED COPY

GRACE BAPTIST REPLAT OF LOTS 117 - 122

**COLLEGE PLACE ADDITION
JONESBORO, ARKANSAS
GRACE BAPTIST CHURCH**

McALISTER ENGINEERING
CIVIL ENGINEERING AND LAND SURVEYING
1013 CR 620 JONESBORO, AR 72404
OFFICE: 870-931-1420
FAX: 870-275-7140

DRAWN BY: DM	CHECKED BY: CM
SCALE: 1" = 50'	DATE: 06JAN14
CAD FILE: 1357243-GraceBaptist.dwg	
DWG REF. 04E-14N-17	
JOB NO. 1357243	SHEET 1 / 1
500-14N-04E-0-17-130-16-1303	

CLARENCE W. "MAC" McALISTER, PE, PLS

DATE	REVISION	BY