

CURVE TABLE:

CURVE #	LENGTH	RADIUS	DELTA	CHORD DIRECTION	CHORD LENGTH
C1	14.38'	353.77'	02°19'44"	S88°34'41"W	14.38'

LINE TABLE:

LINE #	DIRECTION	LENGTH
L1	S89°44'33"W	46.93'

C-3 LUO:

- LIMITED USE TO EXCLUDE:
- BILLBOARDS
 - HIGH-VOLUME RETAIL USES SUCH AS CONVENIENCE STORE
 - CAR WASH
 - PAWN SHOP
 - VEHICLE REPAIR - LIMITED
 - VEHICLE REPAIR - GENERAL
 - AGRICULTURE FARMERS' MARKET
 - SERVICE STATION
 - RESTAURANT - FAST FOOD

LEGEND:

- FOUND 5/8" REBAR W/ ORANGE PLASTIC CAP STAMPED "MA DANIELS P.S. 1563"

SURVEYOR'S NOTES:

1. SURVEYOR HAS MADE NO INVESTIGATION OR INDEPENDENT SEARCH FOR EASEMENTS OF RECORD OR ANY OTHER FACTS WHICH AN ACCURATE TITLE SEARCH MAY DISCLOSE.
2. THE SUBJECT PROPERTY LIES OUTSIDE THE 100-YEAR SPECIAL FLOOD HAZARD ZONE, AS SHOWN ON FEMA FLOOD INSURANCE RATE MAP PANEL NO. 05031C0132C, EFFECTIVE DATE JUNE 25, 2007.

CERTIFICATE OF SURVEY:

THIS IS TO CERTIFY THAT HAYWOOD, KENWARD, BARE & ASSOCIATES INC., PROFESSIONAL LAND SURVEYORS HAVE SURVEYED THE FOLLOWING PARCEL OF LAND:

LOT 4 IN BLOCK A OF FAIRVIEW ACRES SUBDIVISION IN THE CITY OF JONESBORO, ARKANSAS, AS SHOWN BY PLAT OF RECORD IN DEED BOOK 123, AT PAGE 126, SUBJECT TO BILL OF ASSURANCE OF RECORD IN BOOK 149, AT PAGE 98, AND EASEMENTS SHOWN ON RECORD PLAT. ALSO KNOWN AS 3012 PARKWOOD, JONESBORO, AR.

OWNERS CERTIFICATION:

I HEREBY CERTIFY THAT I AM THE OWNER OF THE ABOVE DESCRIBED PROPERTY AND I HEREBY REQUEST A REZONING FROM: (R-3) MULTI-FAMILY HIGH DENSITY DISTRICT TO (C-3 LUO) GENERAL COMMERCIAL DISTRICT - LIMITED USE OVERLAY

SIGNED THIS 17TH DAY OF AUGUST 17, 2011

Roger Barnhill
ROGER BARNHILL

BASIS OF BEARING: ARKANSAS STATE PLANE GRID NORTH ZONE (0301),
LAT: 35°49'00.80016"; LONG: 90°40'07.91459"
CON: 0.77456620; CAF: 0.99993597

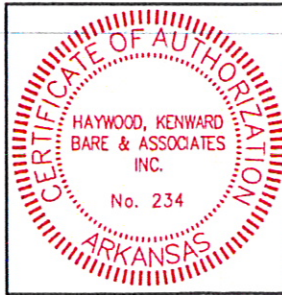
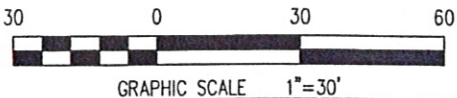

REZONING PLAT

LOT 4, BLOCK A, FAIRVIEW ACRES SUBDIVISION
JONESBORO, CRAIGHEAD COUNTY, ARKANSAS

HAYWOOD, KENWARD, BARE & ASSOCIATES, INC.
CIVIL ENGINEERING - SURVEYING - PLANNING
1801 LATOURETTE DRIVE
JONESBORO, ARKANSAS 72404
TEL 870-932-2019 FAX 870-932-1076

REVISIONS	
DATE	DESCRIPTION
SURVEY INDEX CODE	
PROJECT NO. S063-0002-12	
DRAWN BY JUN	CHECKED BY JHB
SHEET 1 OF 1	SCALE 1"=30'
DATE 08/17/11	DRAWING NO. B-204

COPYRIGHT 2011, ALL RIGHTS RESERVED

CLIENT
JOHN SAWYER

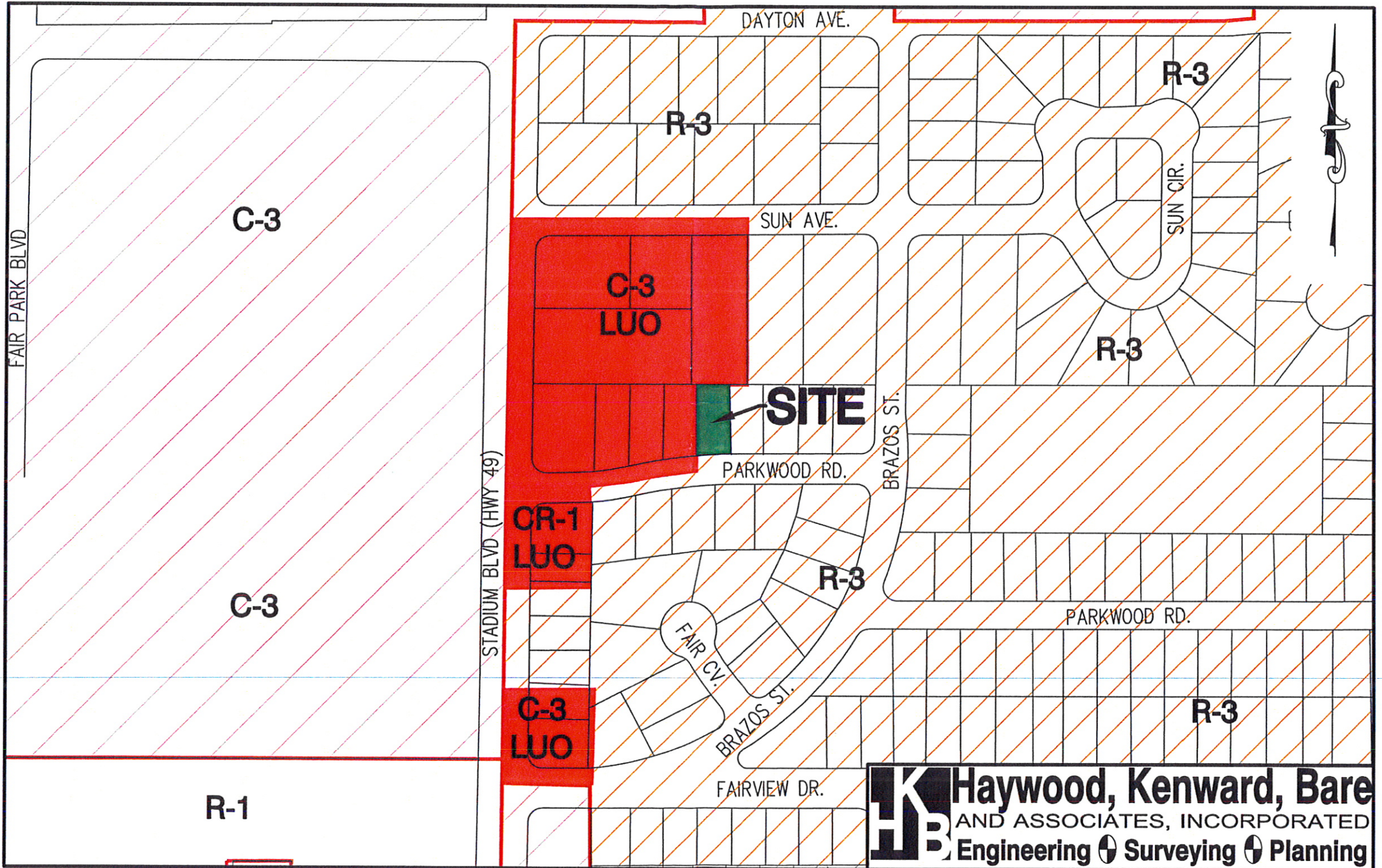

KB Haywood, Kenward, Bare
AND ASSOCIATES, INCORPORATED
Engineering Surveying Planning