

LEGAL DESCRIPTION:

A part of the West Half of the Southwest Quarter of Section 23, Township 14 North, Range 3 East, Craighead County, Arkansas to wit: From the Southeast Corner of the Northwest Quarter of the Southwest Quarter, run S 89°27'37" W a distance of 208.94 ft., to a point; thence N 02°50'30" W a distance of 102.16 ft., to the POINT OF BEGINNING; thence S 01°18'15" E a distance of 282.33 ft., to a point; thence S 87°54'27" W a distance of 210.00 ft., to a point on the South right of way line of Strawfloor Road; thence along a curve to the left, said curve having an arc of 218.36 ft., a radius of 479.63 ft., a chord of 216.48 ft., and a chord bearing of N 68°19'45" E to the POINT OF BEGINNING, containing 1.12 acres.

CERTIFICATE OF SURVEY:

To all parties interested in Title to these premises: I hereby certify that I have prior to this day made a survey of the above described property as shown on the Plat of Survey hereon. The property lines and corner monuments, to the best of my knowledge and ability, are correctly established; Encroachments, if any, as disclosed by Survey, are shown hereon.

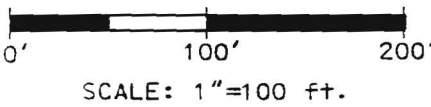

OWNER'S CERTIFICATION:

We hereby certify that we are the owners of the property shown and described hereon, that we adopt the plan of subdivision and dedicate perpetual use of all streets and easements as noted.

Jim Bryant and Shirley Bryant

By George M. Hamman 05-12-04
 R.L.S. PROFESSIONAL SURVEYOR Date
 STATE OF ARKANSAS NO: 1273
 REGISTERED PROFESSIONAL LAND SURVEYOR
 GEORGE M. HAMMAN

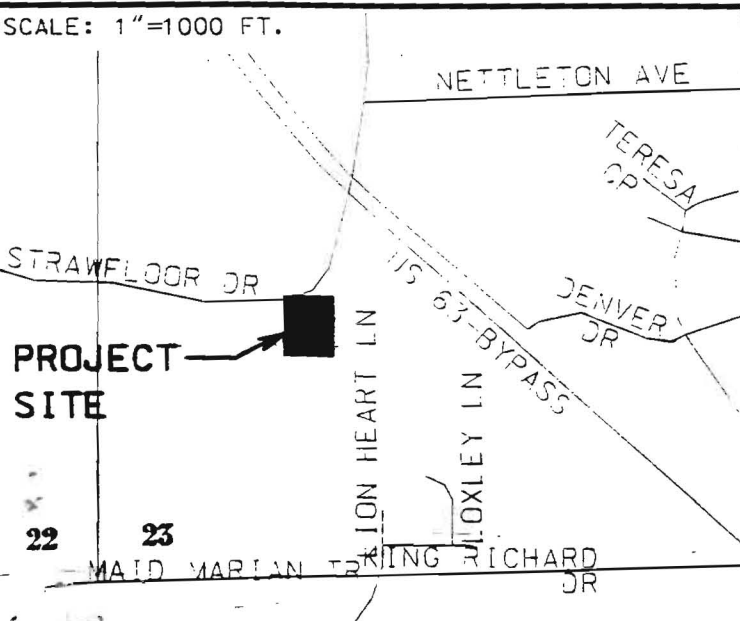

NOTES:

- 1) THIS SURVEY AND PLAT ARE THE PROPERTY OF THE SURVEYOR AND ARE INTENDED FOR THE SOLE USE AND BENEFIT OF THE SURVEYOR & CLIENT.
- 2) THIS SURVEY WAS COMPLETED USING A PENTAX (MODEL NUMBER) AND HAS A CLOSURE PRECISION OF 1' IN 100,000', AND AN ANGULAR ERROR OF 0° PER ANGLE, AND WAS NOT ADJUSTED.
- 3) THE CLOSURE PRECISION OF THE PLAT IS 1' IN 153,846'.
- 4) THE RESEARCH COMPLETED FOR THIS SURVEY INCLUDES LEGAL DESCRIPTION PROVIDED AND OUR OWN RESEARCH AT THE COURTHOUSE.
- 5) ALL PINS SET ARE 1/2" REBAR, UNLESS NOTED OTHERWISE.
- 6) OWNER: JIM & SHIRLEY BRYANT
- 7) FLOOD PLAIN: THIS TRACT DOES NOT LIE WITHIN THE 100-YR FLOOD PLAIN PER FLOOD INSURANCE RATE MAP OF CRAIGHEAD CO., ARK. AND INCORPORATED AREAS. COMMUNITY PANEL NO. 05031C0131 C, DATED 09/27/91. THIS TRACT DOES LIE WITHIN A ZONE "X" FLOOD PLAIN, PER THE MAP REFERENCED ABOVE.

		ENGINEERS - SURVEYORS 2311 E. NETTLETON AVE. JONESBORO, AR 72401 (870) 332-7380	
REZONING PLAT FOR JIM & SHIRLEY BRYANT JONESBORO, ARKANSAS			
JOB NO. 104108		DATE 05-13-04	
© 2004, Hamman Newell Engineering RE			
ONLY COPIES WITH VIOLET COLORED SIGNATURE ARE VALID HNE COPIES			
DRWR 5			