

BEFORE THE METROPOLITAN AREA PLANNING COMMISSION

CHARLES JOHNSON

PETITIONER

PETITION FOR REZONING

Comes now the petitioner and for his petition, states:

1. Petitioner has certain that has now been annexed into the City of Jonesboro. Petitioner now requests that said property be rezoned from the existing R-1 to I-1 zoning. The parcel is described as Parcel #009917. The property is described as:

Beginning at the SW corner of the NW 1/4 of Section 13, Township 14 North, Range 3 East; thence continuing North 825 ft. to the center of lateral #4, Drainage District #30 as the point of beginning; thence North 864 ft. to the south boundary line of Arkansas State Highway 18 and U. S. Highway #63; thence in a southeasterly direction along the south boundary line of said highway 400 ft., thence South to point of the center of lateral #4 of Drainage District #30; thence in a Westerly direction to the point of beginning proper. Said property contains in all 8.11 acres, more or less.

2. The purposes of the zoning is to establish a vehicle pool and for other purposes and the land is contingent with property zoned I-2. The zoning is reasonable and proper.

WHEREFORE, petitioner prays that the zoning be changed from R-1 to I-2 and for all other proper relief.

KEITH BLACKMAN LAW OFFICES
P. O. Box 1233, 512 West Jefferson
Jonesboro, AR 72403
(501) 932-2101

Attorney for Petitioner

Existing R-1
Requesting I-1

Existing
I-2 Zoning

LEGAL DESCRIPTION

Parcel No.
009917
Pt. W 1/2 NW
J' Bono City
Sec. 13
Block 14
Range 3
8.11 ACRES

Parcel No.
009920
Pt. W 1/2 NW.
J' Bono City
Sec. 13
Block 14
Range 3
4.99 ACRES

NE 1/4 NW 1/4

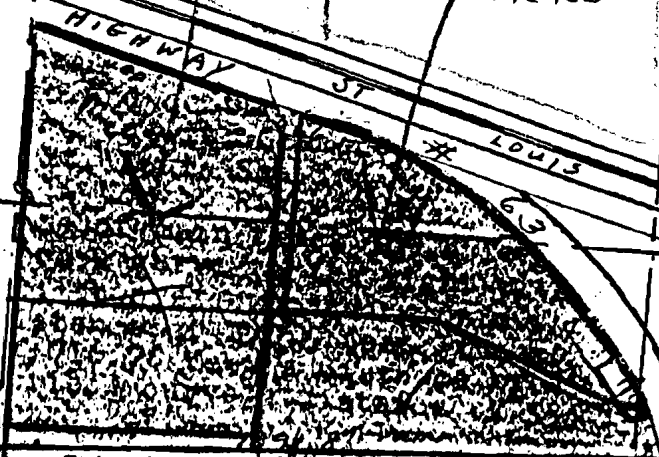

DITCH # 4 DO. # 30

SW 1/4 NW 1/4

SE 1/4 NW 1/4

6

SW CORNER
NW 1/4 13-14-3

1320'

PLAT OF NORTHWEST QUARTER
OF SECTION 13, TOWNSHIP 14 NORTH, RANGE 3 EAST