



City of Jonesboro

Municipal Center
300 S. Church Street
Jonesboro, AR 72401

Meeting Agenda Public Works Council Committee

Tuesday, August 1, 2017

5:00 PM

Municipal Center

1. Call To Order

2. Roll Call by City Clerk Donna Jackson

3. Approval of minutes

[MIN-17:077](#) Minutes for the Public Works Committee Meeting on July 6, 2017

Attachments: [Minutes](#)

[MIN-17:083](#) Minutes for the Special Called Public Works Committee Meeting on July 18, 2017

Attachments: [Minutes](#)

4. New Business

ORDINANCES TO BE INTRODUCED

[ORD-17:061](#) AN ORDINANCE TO AMEND THE JONESBORO CODE OF ORDINANCES SEC. 117-2 AND SEC. 117-107 TO DEFINE AND PROVIDE ZONING CLASSIFICATIONS FOR PHARMACIES, MEDICAL MARIJUANA DISPENSARIES AND MEDICAL MARIJUANA CULTIVATION CENTERS

Sponsors: Metropolitan Area Planning Commission and Planning

Attachments: [Map Locations](#)

RESOLUTIONS TO BE INTRODUCED

[RES-17:102](#) A RESOLUTION TO THE CITY OF JONESBORO, ARKANSAS TO AUTHORIZE THE MAYOR AND CITY CLERK TO ACCEPT A PERMANENT CONSTRUCTION EASEMENT FROM JONESBORO SCHOOL DISTRICT FOR THE PURPOSE OF CONSTRUCTING AND MAINTAINING A SIDEWALK

Sponsors: Engineering

Attachments: [Permanent Constrcution Easement - JPS](#)

[RES-17:109](#) A RESOLUTION TO THE CITY OF JONESBORO, ARKANSAS TO ISSUE A PURCHASE ORDER TO PICKERING TO PERFORM PROFESSIONAL ENGINEERING SERVICES

Sponsors: Engineering

Attachments: [Proposal](#)

RES-17:110 A RESOLUTION TO THE CITY OF JONESBORO, ARKANSAS TO ISSUE A PURCHASE ORDER TO PICKERING TO PERFORM PROFESSIONAL ENGINEERING SERVICES

Sponsors: Engineering

Attachments: [Proposal](#)

RES-17:111 A RESOLUTION TO THE CITY OF JONESBORO, ARKANSAS TO AUTHORIZE THE MAYOR AND CITY CLERK TO ACCEPT A PERMANENT CONSTRUCTION EASEMENT FROM RAYMOND W. HOLLADAY FOR THE PURPOSE OF CONSTRUCTING AND MAINTAINING A SIDEWALK

Sponsors: Engineering

Attachments: [Permanent Construction Easement](#)

RES-17:112 A RESOLUTION TO THE CITY OF JONESBORO, ARKANSAS TO AUTHORIZE THE MAYOR AND CITY CLERK TO ACCEPT A PERMANENT CONSTRUCTION EASEMENT FROM RAYMOND W. HOLLADAY FOR THE PURPOSE OF CONSTRUCTING AND MAINTAINING A SIDEWALK

Sponsors: Engineering

Attachments: [Permanent Construction Easement - Holladay](#)

RES-17:113 A RESOLUTION TO THE CITY OF JONESBORO, ARKANSAS TO AUTHORIZE THE MAYOR AND CITY CLERK TO ACCEPT A PERMANENT CONSTRUCTION EASEMENT FROM NETTLETON PHILLIPS SPECIAL SCHOOL DISTRICT FOR THE PURPOSE OF CONSTRUCTING AND MAINTAINING A SIDEWALK

Sponsors: Engineering

Attachments: [Permanent Construction Easement - Nettleton](#)

5. Pending Items

ORD-17:046 AN ORDINANCE TO CLOSE A PORTION OF MONROE AVENUE AS REQUESTED BY THE ROTARY CLUB OF JONESBORO

Sponsors: Engineering

Attachments: [Conceptual Design Rotary Club FOA.pdf](#)
[Rotary Club.pdf](#)

Legislative History

7/6/17	Public Works Council Committee	Postponed Temporarily
--------	-----------------------------------	-----------------------

6. Other Business

7. Public Comments

8. Adjournment



City of Jonesboro

300 S. Church Street
Jonesboro, AR 72401

Legislation Details (With Text)

File #: MIN-17:077 **Version:** 1 **Name:** Minutes for the Public Works Committee Meeting on July 6, 2017
Type: Minutes **Status:** To Be Introduced
File created: 7/7/2017 **In control:** Public Works Council Committee
On agenda: **Final action:**
Title: Minutes for the Public Works Committee Meeting on July 6, 2017
Sponsors:
Indexes:
Code sections:
Attachments: [Minutes](#)

Date	Ver.	Action By	Action	Result
------	------	-----------	--------	--------

Minutes for the Public Works Committee Meeting on July 6, 2017



City of Jonesboro

Municipal Center
300 S. Church Street
Jonesboro, AR 72401

Meeting Minutes Public Works Council Committee

Thursday, July 6, 2017

5:00 PM

Municipal Center

1. Call To Order

2. Roll Call by City Clerk Donna Jackson

Mayor Harold Perrin was in attendance.

Present 6 - Gene Vance; Chris Moore; John Street; Mitch Johnson; Charles Coleman and Ann Williams

Absent 1 - Darrel Dover

3. Approval of minutes

[MIN-17:063](#)

Minutes for the Public Works Committee meeting on June 6, 2017

Attachments: [Minutes](#)

A motion was made by Councilman Chris Moore, seconded by Councilman Gene Vance, that this matter be Passed . The motion PASSED with the following vote.

Aye: 5 - Gene Vance; Chris Moore; Mitch Johnson; Charles Coleman and Ann Williams

Absent: 1 - Darrel Dover

4. New Business

Ordinances To Be Introduced

[ORD-17:058](#)

AN ORDINANCE TO WAIVE COMPETITIVE BIDDING AND APPROVE THE PURCHASE OF A CASE TRACTOR FOR THE STREET DEPARTMENT, APPROPRIATING FUNDS, AND DECLARING AN EMERGENCY

Chair member Street stated he needed to walk-on ORD-17:058 to Public Works and forward it to full Council. He said the ordinance needed to be declared an emergency because they have a tractor down and it will cost more to fix it just about than they can buy a new one for. It is needed for mowing. Street Department Director Steve Tippitt said the tractor is one of our side-arm tractors that mows the roadside ditches. We had significant repairs done on it last year and the transmission went out on it again this year but it broke some hard parts. It is going to cost \$25,000 to rebuild it. We can get a new one for \$81,000 and get a trade-in with one that they have in their shop now of ours. Council member Moore asked if it is just factu on the Case. I noticed that the State uses John Deere. Mr. Tippitt said they do. If it goes out for bids,

then we are going to have to also purchase the side arm with the tractor. With the new one, the side arm will just pop in. This tractor is tore down in their shop and they couldn't tell us what was wrong with it until they tore it down. I don't see us spending \$45,000 for a seven-year old tractor. Council member Moore said if the implement is specific to the line of tractor, you won't. Is there an ordinance for that? Chair member Street said there is. It is ORD-17:058 and it needs to be walked on to the Council tonight and the emergency clause as well. Council member Moore motioned, seconded by Council member Vance to forward ORD-17:058 to the full Council due to the fact that the emergency being that ours is torn up and we need to get back to mowing. Mr. Tippitt said that we have nine zones that we have to take care of. Two tractors are not going to do it. Chair member Street said he had a motion and second to walk on ORD-17:058 with the emergency clause to the full Council. All voted aye.

A motion was made by Councilman Chris Moore, seconded by Councilman Gene Vance, that this matter be Recommended to Council . The motion PASSED with the following vote.

Aye: 5 - Gene Vance;Chris Moore;Mitch Johnson;Charles Coleman and Ann Williams

Absent: 1 - Darrel Dover

ORD-17:046

AN ORDINANCE TO CLOSE A PORTION OF MONROE AVENUE AS REQUESTED BY THE ROTARY CLUB OF JONESBORO

Attachments: [Conceptual Design Rotary Club FOA.pdf](#)
[Rotary Club.pdf](#)

Chair member Street said the Rotary Club of Jonesboro is looking into acquiring a grant to expand that as a park and put balusters up that would prevent thru traffic. I understand that there is a legal question as to whether that needs to be advertised or not. City Attorney Carol Duncan said she has not been able to find the statute in the last five minutes because she doesn't have Lexis on her ipad like she does at the office. It may not be since we are not abandoning utilities, but I would feel more comfortable actually reading a statute that tells me that. I didn't realize that we would be walking on and trying to waive all the readings and trying to do an emergency clause in one night. When you are closing a street, I think some notice to the public is important no matter what whether you are abandoning the utilities or not. I do understand there are grant deadlines that pose a problem. Chair member Street said that July 31, 2017 is the deadline for grant. If they can't get it, it is my understanding that they will pursue something else. Ms. Duncan stated the question she has is whether they could go ahead and apply for the grant without the official closing yet. I think it may be technically possible on this first grant. They are concerned about it being a waste of time to do that if it ends up not getting abandoned.

Jerry Brackett, with the Rotary Club, said that if this doesn't happen with the two grants that we are applying for where those two grants would certainly assist us, it is not going to stop us from proceeding. We would have to go through other avenues. I am going to be making a presentation to the Council this evening showing what we are proposing to do downtown and I will be happy to answer any questions quickly for this. We are asking to close the street from Church to the alley on Monroe. The alley has to function for garbage for people who live back there. I think the Traffic Committee suggested we make the alley one way north to south. We discussed that. We have talked to property owners through there and we have been working with the City and the Downtown Association. I have met with some of the building owners personally. As long as they have access through that alley, it's not going to be an issue with the people that we talked with. What it does do is create, as you will see in the presentation later, it is going to be quite an improvement for downtown. It is in celebration of the Rotary Club's 100 years in 2019. We have been working on this

probably 18 months to two years to get to the point we are now.

Chair member Street said there is a safety consideration for that too because the kids that perform in various things at the Forum have to walk back and forth across the street. In fact, last year, I called Mayor Perrin about possibly temporarily closing Monroe during the Nutcracker performances. Mayor Perrin said we did put some stuff up during the performances and we had to take them down.

Mr. Brackett said that if you look at site plan, we are also improving with balusters, the traffic down the alley and creating a better space for the kids to come out of the art building which now they step out directly into traffic. We are doing some improvements for safety, but I do want you to understand that this is a plaza or park for the entire City of Jonesboro. It is not for the Foundation of Arts. It is for the Downtown Association and every group we have spoken with that might have an interest in activities downtown. I think you will see in the presentation, it is an excellent location. It is achievable by us as a Rotary Club and that was important that we not take on more than we couldn't achieve. It is going to take some help from the City with utilities and drainage. There is a drainage problem there now. We are trying to solve that problem as well. That is it in a nutshell without showing you my presentation. We will proceed if the grants fall through. The amount of money in those two grants is not going to stop us from proceeding. It may limit some of the things we would like to do.

Council member Moore asked City Attorney Carol Duncan if she wanted to advertise for two weeks. Ms. Duncan said not necessarily. I didn't realize that they were trying to walk it on. I saw the ordinance in Legistar that they wanted to close the road. When the discussion came up a few moments ago about walking it on, waiving all readings, and adding an emergency clause, then City Clerk Donna Jackson and I had a question about notice if you are not abandoning utilities, is the notice the same and it may not be, but I would feel more comfortable if I had a minute to look that up. It may not require a two-week notice. Council member Moore asked if she needed a minute to look it up between the committee meeting and the Council meeting or looking it up sometime this week. Ms. Duncan said no, she would like to look at it tomorrow. She said she tried to look it up earlier and she doesn't have legal research abilities on her ipad. Council member Moore said he hasn't heard any objection to this plan so far. If we read this and Ms. Duncan has adequate notification, Mr. Brackett, do you think it will jeopardize your grant application? Mr. Brackett said the grant application has to be in by the end of July. Beverly Parker said one deadline is the 15th and other is the 30th. We really wanted to try to have our agreement with the City before proceeding with that in terms of our comfort level that this was going to go forward and obviously with the City's time and investing in the grants. Council member Moore said I would assume you would have an answer in two weeks. Ms. Duncan said she thought it could be read two times tonight. Council member Moore said if we read it twice tonight and hold it for a third reading, you will have an answer in two weeks which is July 18, 2017. You would have an answer up or down by that date. Mr. Brackett said he thought that would be good if it did require some kind of notification. Mayor Perrin said that gives her plenty of time. Council member Moore said that way you will have legal standing and you will have the answer you want. Pending any objections which he hasn't heard, you will have both of those on the 18th. Ms. Duncan said we also had a discussion about meeting tomorrow about a memorandum of understanding. We might be able to bring that back also on the 18th and have it all done at once. Mayor Perrin said it would be good if we could do that. Council member Moore said that theoretically someone could challenge that even if we are all in agreement. We just had a discussion about challenges to Council decisions. Without Ms. Duncan giving you that proper safeguard of advertising it, someone might challenge it. City Clerk Donna Jackson said there has to be a Public

Hearing. Ms. Duncan said if it requires a notice. Ms. Jackson said they set a Public Hearing in an open meeting.

Beverly Parker said that in terms of the finances, we can manage without the grants so that is not the big issue. In terms of the street, we really need that street closure in terms of the safety issues Mr. Street had mentioned and really, how we want to improve that whole facility. There is not a lot of space in that park and we really need the street so that once you walk out of the Forum, it looks like one big plaza and it all flows together. Council member Moore said that he doesn't think anyone is arguing that. I think we are just trying to make sure that we are on legal ground here to give you what you want.

Chair member Street said he thought that was a good idea. He would like to walk it on tonight and hold it two times. Council member Moore said that was right and that gives two weeks to advertise it. City Attorney Carol Duncan said that it is important to note that if the two week requirement comes into play, then there is also a Public Hearing requirement that comes into play. So, we will just cross that bridge when we figure it out. If none of that applies, then we should be able to have everything in place on the 18th. Council member Vance wanted to know if we were going to do one reading tonight and two in two weeks or do we do two tonight and one in two weeks. Council member Moore said that we would do one reading tonight with the understanding that we intend to move forward with it. Mayor Perrin said that gives the Rotary Club the deal with us reading it once tonight and then the two. I also agree with Ms. Duncan that she can work on finding out about the law on the notification and the MOU or memorandum of understanding so that we would have all of those documents ready to go. We will notify you.

Chair member Street asked Council member Moore if he made a motion that we walk it on. Council member Moore said that Council member Vance is asking a question about whether we should go ahead and set a Public Hearing and then cancel it if we don't need it, but go on and set the Public Hearings in the two week time span. Chair member Street said that would probably be a good idea. Council member Moore said he concurs with that to go ahead and schedule that and if Ms. Duncan comes back and says it's not needed, then we will cancel it. Someone is fixing to have to make a decision. Council member Vance said it will have to be scheduled during the Council meeting. City Clerk Donna Jackson made the suggestion that she goes and gets the Code Book so that they can look at it. Chair member Street said they will come back to this.

Council member Moore asked City Attorney Carol Duncan to give them one recommendation on what we should do so we can move forward. Ms. Duncan said that in reading the ordinances dealing with vacating streets, I do think this is different than vacating a street because we are not vacating any utilities and we are not changing anything in a permanent nature, and it can be changed back at any moment technically. I would like to find legal authority that gives the Mayor and/or the Council the ability to do that. I don't think that will be hard to find and I don't think that will require a Public Hearing once I find it so I say if you want to walk it on tonight and do the one reading and hopefully, we will be good to go by the next Council meeting. Council member Moore asked Ms. Duncan if she thought there was an ordinance that needs to be passed because right now the Mayor closes a variety of streets for different events and this will have a direct reflection. Ms. Duncan said there has to be something that gives him that authority. Council member Frierson said there is a resolution, not an ordinance. Council member Vance said we are not vacating the street. We are just limiting access to the street. Ms. Duncan said that she just said that we were not vacating a street and that those ordinances do not apply.

Council member Moore said he thinks what they need to do is to give Ms. Duncan a day to come to this conclusion because the answer to this question is also going to answer whether or not the Mayor has the right close Huntington every Thursday night or if he has the right to close any street for a special event. All of this in effect will be a special event that is indefinite. Ms. Duncan said her question is do we do a resolution to close for Barbeque Fest or Thursday night Downtown. Council member Frierson said why don't we limit it to worrying about what we are looking at here. Ms. Duncan said they made the comparison and she is just taking it a little further.

Council member Moore said his recommendation is that they allow Ms. Duncan one day to come back with her recommendation because it is going to have an effect on other events. Ms. Duncan said absolutely. Chair member Street asked what the committee wanted to do with this. Council member Moore said nothing until we hear back from Ms. Duncan. Chair member Street asked if they wanted to postpone temporarily. Council member Moore said postpone temporary. Council member Vance asked which ordinance they were postponing. Chair member said they are temporarily postponing ORD-17:046.

A motion was made by Councilman Chris Moore, seconded by Councilman Gene Vance, that this matter be Postponed Temporarily . The motion PASSED with the following vote.

Aye: 5 - Gene Vance;Chris Moore;Mitch Johnson;Charles Coleman and Ann Williams

Absent: 1 - Darrel Dover

ORD-17:053

AN ORDINANCE AMENDING THE JONESBORO CODE OF ORDINANCES, AND ADOPTING THE CITY OF JONESBORO MASTER STREET PLAN; PROVIDING FOR AMENDMENTS OF ARTICLE III, CHAPTER 101, AND ADOPTING SUCH AMENDMENTS TO THE MASTER STREET PLAN BY REFERENCE

Attachments: [2017 Master Street Plan](#)

Chair member Street asked City Engineer Craig Light if he would address any questions that they might have. Mr. Light said the Master Street Plan Committee met over several months and went over the Master Street Plan that was proposed back in 2015. They looked at the map and the cross section, made some additional changes to the cross sections and a couple of minor changes to the mapping, nothing very major at least in my mind. Mainly in the southwest part of the City, down in the Valley View area, there were some roads that didn't make a whole lot of sense in hindsight so that was modified. It did go through the Master Street Planning Committee. It went for two hearings for the Planning Commission and they voted unanimously to send it on to City Council to consider.

Chair member Street said if we walk it on, we could do it in three readings. There is no rush. Mayor Perrin said there was no rush and in fact, he would prefer if they go ahead and read it three times separately like we did the Land Use Plan. That gives people more time to look at it even though we have had two Public Hearings and it has gone through the MAPC. That way, it would be over a six-week period.

Mr. Light said he did want to state that up in the Greensborough Village area, in the 2015 plan that was not adopted by Council, we showed a road going through the Greensborough Village Development, that is still shown on this map. We realize that the Highway Department is looking at various options for improvements in that area. The Committee chose to leave the map as it is right now until the Highway Department makes a decision on what they are going to do and then change the map at that point. Right now, there are too many questions that we have and too many

options out there to really know what the Highway Department is going to select as the best option in that area. The Committee decided to just kick the can on it for a little while.

Chair member Street said if the Highway Commission is going to do anything, they will hold hearings on their proposed route through that if they do it. Mr. Light and Mayor Perrin said they will. Mayor Perrin said if you all will remember, this is in the STIP on the \$90 million that he has spoken with Commissioner Farmer about. I think Mark Nichols and I are going down to Little Rock next week to meet with Lori Tudor and Scott Bennett to talk about this because this is probably the next one that we want to try to get under contract but you can't do that until you get a plan. They have been working on several alternatives on that. I can come back the next time and have a lot more information than we have tonight. I want to make it clear that what he is saying in the Master Street Plan is that in the 2015 plan that was not approved, they just rolled it over into the 2017 Master Plan. They just left it in there knowing full well that ARDOT, the Arkansas Highway Department, has multiple types of alternatives that they want to do on that and until that is discussed, then we will go back and change that Master Street Plan at that time. It was better to go ahead and forward it to the MAPC and us and just leave it in there. There has been a lot of conversations and a lot of articles in the newspaper about that, but nothing is final on that road in Greensborough. There is a Phase I that is going on now in Greensborough and the development firm of Harpole and Halsey has put up a cash deposit of \$548,430 for the first portion of Phase I only. What you see out there with all of that heavy equipment is only in Phase I of that development. It was said in some part of the paper in some kind of letter that nothing was put up, no surety bond, but that is not correct. It is here and anyone can look at it.

A motion was made by Councilman Chris Moore, seconded by Councilman Gene Vance, that this matter be Recommended to Council . The motion PASSED with the following vote.

Aye: 5 - Gene Vance;Chris Moore;Mitch Johnson;Charles Coleman and Ann Williams

Absent: 1 - Darrel Dover

5. Pending Items

6. Other Business

7. Public Comments

8. Adjournment

A motion was made by Councilman Mitch Johnson, seconded by Councilman Gene Vance, that this meeting be Adjourned . The motion PASSED with the following vote.

Aye: 5 - Gene Vance;Chris Moore;Mitch Johnson;Charles Coleman and Ann Williams

Absent: 1 - Darrel Dover



Legislation Details (With Text)

File #: MIN-17:083 **Version:** 1 **Name:** Minutes for the Special Called Public Works Committee Meeting on July 18, 2017
Type: Minutes **Status:** To Be Introduced
File created: 7/19/2017 **In control:** Public Works Council Committee
On agenda: **Final action:**
Title: Minutes for the Special Called Public Works Committee Meeting on July 18, 2017
Sponsors:
Indexes:
Code sections:
Attachments: [Minutes](#)

Date	Ver.	Action By	Action	Result
------	------	-----------	--------	--------

Minutes for the Special Called Public Works Committee Meeting on July 18, 2017



City of Jonesboro

Municipal Center
300 S. Church Street
Jonesboro, AR 72401

Meeting Minutes Public Works Council Committee

Tuesday, July 18, 2017

4:30 PM

Municipal Center

Special Called Meeting

1. Call To Order

2. Roll Call by City Clerk Donna Jackson

Present 5 - Gene Vance; John Street; Darrel Dover; Charles Coleman and Ann Williams

Absent 2 - Chris Moore and Mitch Johnson

3. New Business

ORDINANCES TO BE INTRODUCED

[ORD-17:065](#)

AN ORDINANCE TO DELETE AND REPLACE THE LANGUAGE OF ORDINANCE 66-6 TO PROVIDE FOR TEMPORARY, LONG TERM OR PERMANENT STREET CLOSURES BY THE CITY OF JONESBORO

Chairperson Street said if you have had a chance to look at that, it allows the Mayor to close streets for special events, not permanently close them, but shut them down for events like "Alive at Five" and the Barbeque Fest. It makes it a little more understandable of temporary closure and if we have a permanent closure, we still have to come back through the City Council.

Council member Vance asked if it needed to be forwarded to the Council tonight. Chairperson Street said no that it did not.

A motion was made by Councilman Gene Vance, seconded by Councilwoman Ann Williams, that this matter be Recommended to Council . The motion PASSED with the following vote.

Aye: 4 - Gene Vance; Darrel Dover; Charles Coleman and Ann Williams

Absent: 2 - Chris Moore and Mitch Johnson

RESOLUTIONS TO BE INTRODUCED

[RES-17:099](#)

A RESOLUTION TO THE CITY OF JONESBORO TO ENTER INTO AN INDEMNIFICATION AGREEMENT WITH WINDOVER HTS

Attachments: [Indemnification Agreement](#)
[Description for Windover Hts Indemnification Agreement](#)

Chairperson Street said RES-17:099 does need to be walked onto the Council

tonight.

Council member Vance said they have an existing sign there that they didn't have permission to have, but it has been there forever. They are trying to update it.

A motion was made by Councilman Darrel Dover, seconded by Councilman Gene Vance, that this matter be Recommended to Council . The motion PASSED with the following vote.

Aye: 4 - Gene Vance;Darrel Dover;Charles Coleman and Ann Williams

Absent: 2 - Chris Moore and Mitch Johnson

RES-17:104

A RESOLUTION TO THE CITY OF JONESBORO, ARKANSAS TO INCREASE PURCHASE ORDER NUMBER 45476 TO KINDER BROTHER EXCAVATING, INC. FOR THE DITCH RECHANNELING PROJECT- JOB NO. 2016:28

Attachments: [Additional Cost](#)

Chairperson Street asked if City Engineer Craig Light would speak about the projects on RES-17:104.

City Engineer Craig Light said that when we were planning this year's budget, we put some money into the budget to do some additional ditch cleaning projects this year. We identified five or six of them that we wanted to do. Unfortunately, we didn't budget enough money to do all five or six. We did for three of them. This would allow us to issue a change order to Kinder Brothers to go ahead and do those three ditches. The ditches are Viney Slough Lateral which we are calling Pete's Ditch that is down by Pete's Western Wear. We did a portion of this ditch channel already. This would take it if from where we stopped all the way to the City limits. The other one is a ditch that is actually the headwaters of L'Anguille River. It is just right there at Valley View Schools. It is one that the school asked us if we could do. The final one is Bridger Creek Lateral, which is out in the Farville Curve area. We have been battling water problems out there for a while now. This would remove all the vegetation from the ditch, which would take that vegetation away from the beavers that keep damming the ditch up. The intent is to remove all of the trees, clean the ditch, and have it open so it is easier to maintain and keep open so the Farville Curve will stop having the water problems that they do have.

Council member Dover asked if these were the projects that were budgeted. Mr. Light said yes. Mayor Perrin asked if they were going to channel that a little bit too. Mr. Light said yes.

Chairperson Street said it was \$140,790 for those three projects. Mayor Perrin said right. Mr. Light said that this contract was \$1.6 million. Mayor Perrin said it was \$1.6 million and there were three other projects that need to be done so we are amending the contract that we already have. Chairperson Street asked if this was urgent or time sensitive. Mr. Light said that it can go to the Council in August. The contractor is working on Murray Creek right now. He wouldn't move in until mid-August anyway. Mayor Perrin said he thought they were waiting on a permit from the Corp of Engineers on one. Mr. Light said they got the permit on that. It was on Murray Creek, the one that they are working on now. It has taken a while. It took about nine months to get the permit from the Corp of Engineers. Chairperson Street asked if we had to get a permit for the L'Anguille. Mr. Light said that the work that we are doing does not require us to get a permit unless we start doing all of the rockwork. With these ditches, we are not planning on rocking. It is just a clearing project above the ordinary high water mark so we are good.

A motion was made by Councilman Gene Vance, seconded by Councilman Charles Coleman, that this matter be Recommended to Council . The motion PASSED with the following vote.

Aye: 4 - Gene Vance;Darrel Dover;Charles Coleman and Ann Williams

Absent: 2 - Chris Moore and Mitch Johnson

4. Adjournment

A motion was made by Councilman Darrel Dover, seconded by Councilman Gene Vance, that this meeting be Adjourned . The motion PASSED with the following vote.

Aye: 4 - Gene Vance;Darrel Dover;Charles Coleman and Ann Williams

Absent: 2 - Chris Moore and Mitch Johnson



Legislation Details (With Text)

File #:	ORD-17:061	Version:	1	Name:	Amend Code of Ordinances Sec. 117-2 and 117-10 concerning pharmacies, medical marijuana dispensaries and medical marijuana cultivation centers
Type:	Ordinance	Status:			To Be Introduced
File created:	7/12/2017	In control:			Public Works Council Committee
On agenda:		Final action:			
Title:	AN ORDINANCE TO AMEND THE JONESBORO CODE OF ORDINANCES SEC. 117-2 AND SEC. 117-107 TO DEFINE AND PROVIDE ZONING CLASSIFICATIONS FOR PHARMACIES, MEDICAL MARIJUANA DISPENSARIES AND MEDICAL MARIJUANA CULTIVATION CENTERS				
Sponsors:	Metropolitan Area Planning Commission, Planning				
Indexes:	Code of Ordinances amendment				
Code sections:	Chapter 117 - Zoning				
Attachments:	Map Locations				

Date	Ver.	Action By	Action	Result
------	------	-----------	--------	--------

AN ORDINANCE TO AMEND THE JONESBORO CODE OF ORDINANCES SEC. 117-2 AND SEC. 117-107 TO DEFINE AND PROVIDE ZONING CLASSIFICATIONS FOR PHARMACIES, MEDICAL MARIJUANA DISPENSARIES AND MEDICAL MARIJUANA CULTIVATION CENTERS
WHEREAS, the State of Arkansas through a vote of the citizens of the state approved the use of medical marijuana; and

WHEREAS, the City of Jonesboro wishes to amend its Code of Ordinances in order to be in compliance with the requirements of state law.

NOW, THEREFORE, BE IT ORDAINED BY THE CITY COUNCIL OF THE CITY OF JONESBORO, ARKANSAS:

SECTION ONE: That the Jonesboro Code of Ordinances Sec. 117-2 shall be amended to add the following definitions:

Pharmacy means a place where medicines are compounded or dispensed.

Medical Marijuana Cultivation Center means an entity that has been licensed by the Arkansas Medical Marijuana Commission to cultivate, prepare, manufacture, process, package, sell, and/or deliver to a dispensary.

Medical Marijuana Dispensary means an entity that has been licensed by the Arkansas Medical Marijuana Commission to dispense medical marijuana.

SECTION TWO: That the Jonesboro Code of Ordinances Sec. 117-107 shall be amended to add Pharmacy and Medical Marijuana Dispensary to the Use Table for Commercial and Industrial Uses as a permitted use in C-3.

SECTION THREE: That the Jonesboro Code of Ordinances Sec. 117-107 shall be amended to add Pharmacy

and Medical Marijuana Cultivation Center to the Use Table for Commercial and Industrial Uses as a permitted use in I-1 and I-2.



Legend

- Jonesboro City Limits
- Zoning as of June 30, 2017**
- C-3
- I-1
- I-2
- Jonesboro Public Schools
- Jonesboro Non-Public Schools
- State Licensed Day Cares
- Churches Properties
- ASU

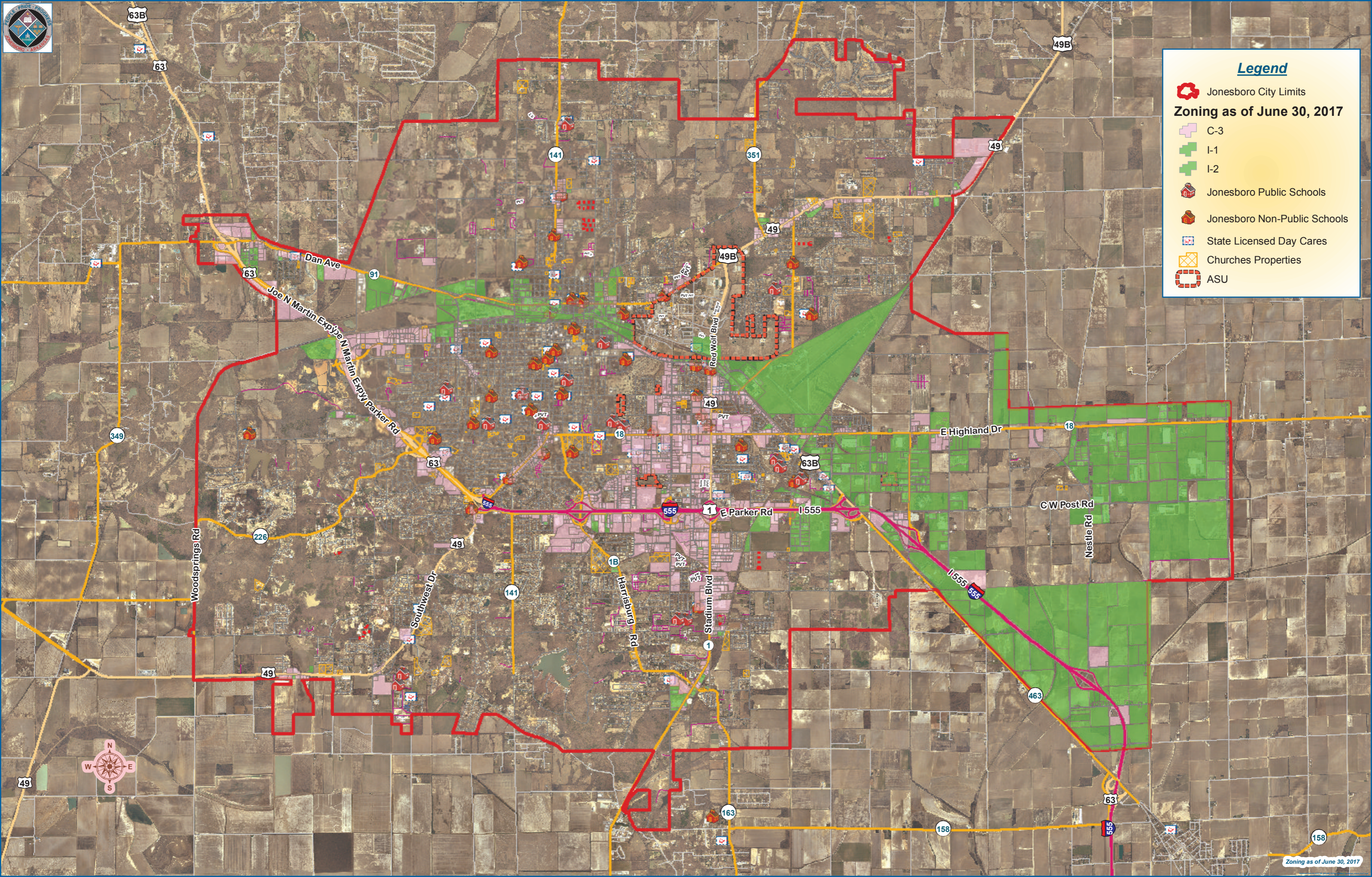



Legislation Details (With Text)

File #:	RES-17:102	Version:	1	Name:	Permanent construction easement from Jonesboro School District to construct and maintain a sidewalk
Type:	Resolution	Status:		Status:	To Be Introduced
File created:	7/10/2017	In control:		In control:	Public Works Council Committee
On agenda:		Final action:		Final action:	
Title:	A RESOLUTION TO THE CITY OF JONESBORO, ARKANSAS TO AUTHORIZE THE MAYOR AND CITY CLERK TO ACCEPT A PERMANENT CONSTRUCTION EASEMENT FROM JONESBORO SCHOOL DISTRICT FOR THE PURPOSE OF CONSTRUCTING AND MAINTAINING A SIDEWALK				
Sponsors:	Engineering				
Indexes:	Easement				
Code sections:					
Attachments:	Permanent Constrcution Easement - JPS				

Date	Ver.	Action By	Action	Result
------	------	-----------	--------	--------

A RESOLUTION TO THE CITY OF JONESBORO, ARKANSAS TO AUTHORIZE THE MAYOR AND CITY CLERK TO ACCEPT A PERMANENT CONSTRUCTION EASEMENT FROM JONESBORO SCHOOL DISTRICT FOR THE PURPOSE OF CONSTRUCTING AND MAINTAINING A SIDEWALK WHEREAS, the City of Jonesboro, Arkansas desires to accept the following described easement for the purpose of constructing and maintaining a sidewalk:

A PART OF LOT 1 OF COBB SURVEY OF THE SOUTHWEST QUARTER OF THE NORTHEAST QUARTER OF SECTION 19, TOWNSHIP 14 NORTH, RANGE 04 EAST, JONESBORO, CRAIGHEAD COUNTY, ARKANSAS, (AS RECORDED IN BOOK 48, PAGE 16), BEING MORE PARTICULARLY DESCRIBED AS FOLLOWS:

BEGINNING AT THE SOUTHEAST CORNER OF THE REPLAT OF THE NORTH 80 FEET OF LOTS 1, 2 & 3 OF COBB SURVEY OF THE SOUTHWEST QUARTER OF THE NORTHEAST QUARTER OF SECTION 19, TOWNSHIP 14 NORTH, RANGE 04 EAST, SAID POINT BEING ON THE WESTERLY RIGHT-OF-WAY LINE OF RAINS STREET; THENCE ALONG SAID WESTERLY RIGHT-OF-WAY LINE THE FOLLOWING COURSES AND DISTANCES: NORTH 89°39'43" EAST, 9.98 FEET; SOUTH 01°38'45" WEST, 128.94 FEET; THENCE NORTH 88°21'15" WEST, LEAVING SAID WESTERLY RIGHT-OF-WAY LINE, 9.93 FEET; THENCE NORTH 01°37'43" EAST, 128.59 FEET TO THE POINT OF BEGINNING, CONTAINING 1281 SQ. FT., MORE OR LESS, SUBJECT TO ALL RIGHTS-OF-WAY AND EASEMENTS OF RECORD.

NOW THEREFORE BE IT RESOLVED BY THE CITY COUNCIL FOR THE CITY OF JONESBORO, ARKANSAS THAT:

Section 1: The Mayor and City Clerk are hereby authorized by the City Council for the City of Jonesboro, Arkansas to accept the easement described above.

Return recorded document to:
CITY OF JONESBORO
300 South Church Street
Jonesboro, AR 72401

The above space is reserved for Craighead County recording information

PERMANENT CONSTRUCTION EASEMENT

KNOW ALL MEN BY THESE PRESENTS:

That JONESBORO SCHOOL DISTRICT, hereinafter referred to as Grantor (whether one or more), does hereby dedicate, grant and convey unto the Public, and that the **CITY OF JONESBORO**, a Municipal Corporation of the State of Arkansas, hereinafter referred to as Grantee, does hereby accept on behalf of the public, for use as a permanent construction easement across the following described real property in Craighead County, State of Arkansas, to-wit:

A PART OF LOT 1 OF COBB SURVEY OF THE SOUTHWEST QUARTER OF THE NORTHEAST QUARTER OF SECTION 19, TOWNSHIP 14 NORTH, RANGE 04 EAST, JONESBORO, CRAIGHEAD COUNTY, ARKANSAS, (AS RECORDED IN BOOK 48, PAGE 16), BEING MORE PARTICULARLY DESCRIBED AS FOLLOWS:

BEGINNING AT THE SOUTHEAST CORNER OF THE REPLAT OF THE NORTH 80 FEET OF LOTS 1, 2 & 3 OF COBB SURVEY OF THE SOUTHWEST QUARTER OF THE NORTHEAST QUARTER OF SECTION 19, TOWNSHIP 14 NORTH, RANGE 04 EAST, SAID POINT BEING ON THE WESTERLY RIGHT-OF-WAY LINE OF RAINS STREET; THENCE ALONG SAID WESTERLY RIGHT-OF-WAY LINE THE FOLLOWING COURSES AND DISTANCES: NORTH 89°39'43" EAST, 9.98 FEET; SOUTH 01°38'45" WEST, 128.94 FEET; THENCE NORTH 88°21'15" WEST, LEAVING SAID WESTERLY RIGHT-OF-WAY LINE, 9.93 FEET; THENCE NORTH 01°37'43" EAST, 128.59 FEET TO THE POINT OF BEGINNING, CONTAINING 1281 SQ. FT., MORE OR LESS, SUBJECT TO ALL RIGHTS-OF-WAY AND EASEMENTS OF RECORD.

This easement and right of way is for the purpose of constructing and maintaining a sidewalk. Any other use of this area, other than by record owners, shall only be granted by record owners, but they are not precluded from using or granting other use, so long as same does not interfere unreasonably with the express purpose intended.

This grant of easement and right of way shall be binding upon the heirs, successors, administrators and assigns of the grantors.

IN WITNESS WHEREOF, the grantors have executed this instrument on the 10th day of July, 2017.

Owner Info
BY:

Signature: Monroe Pointer

Name: MONROE POINTER

Title: DIRECTOR OF FACILITIES

ACKNOWLEDGMENT

STATE OF Arkansas

COUNTY OF Craighead

On this day before me, the undersigned officer, personally appeared Monroe Pointer, to me well known to be the person whose name is subscribed to the foregoing instrument, and acknowledged that he had executed the same for the purpose therein stated and set forth.

WITNESS my hand and seal this 10th day of July, 2017.

Notary Public (Signature): Dawn Merrell

My Commission Expires: 8-29-24



DATE:	REVISION:	BY:

Pickering Firm
 Incorporated
 100 E. Washington, Suite 3
 Jonesboro, AR 72401
 Planning, Architectural, Engineering, Management
 Phone: (870) 619-7916

CITY OF JONESBORO, ARKANSAS
 AHD JOB #100936
JONESBORO RAIN ST. SIDEWALKS (7AP-16)S

RAINS STREET SIDEWALK WEST SIDE
 FROM STA 07+00 TO STA 14+00

DESIGNED:	
CHECKED:	
DRAWN:	
APPROVED:	
SCALE:	
DATE:	
PROJECT:	
SHEET:	

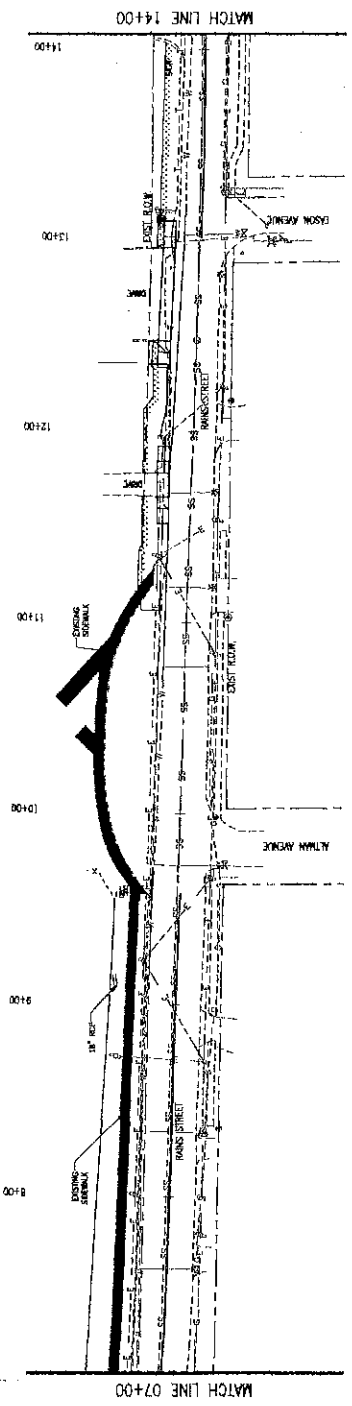
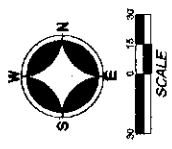

1 EXISTING CONDITIONS - RAINS STREET - STA 7+00 TO STA 14+00

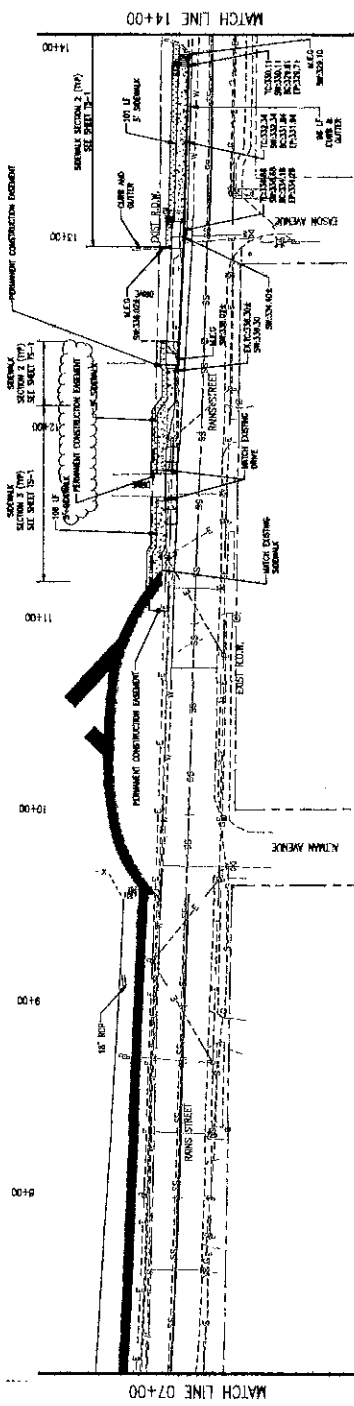

2 PROPOSED CONDITIONS - RAINS STREET - STA 7+00 TO STA 14+00



Legislation Details (With Text)

File #:	RES-17:109	Version:	1	Name:	Purchase order with Pickering for professional services for Lacy Park Access Road improvements
Type:	Resolution	Status:			To Be Introduced
File created:	7/17/2017	In control:			Public Works Council Committee
On agenda:		Final action:			
Title:	A RESOLUTION TO THE CITY OF JONESBORO, ARKANSAS TO ISSUE A PURCHASE ORDER TO PICKERING TO PERFORM PROFESSIONAL ENGINEERING SERVICES				
Sponsors:	Engineering				
Indexes:	Other				
Code sections:					
Attachments:	Proposal				

Date	Ver.	Action By	Action	Result
------	------	-----------	--------	--------

A RESOLUTION TO THE CITY OF JONESBORO, ARKANSAS TO ISSUE A PURCHASE ORDER TO PICKERING TO PERFORM PROFESSIONAL ENGINEERING SERVICES

WHEREAS, the City of Jonesboro desires to issue a purchase order for professional engineering services for the proposed improvements for Lacy Park Access Road from Dan Avenue (SR 91) south to the City Property Line in Jonesboro, Arkansas; and,

WHEREAS, based on annual Statement of Qualifications submitted, the firm selected to perform professional engineering services for the above mentioned project is Pickering; and,

WHEREAS, Pickering has agreed to provide the services detailed in the attached proposal; and,

WHEREAS, funding for the execution of the purchase order shall come from the Capital Improvement budget and compensation shall be paid in accordance with the attached proposal.

NOW THEREFORE BE IT RESOLVED BY THE CITY COUNCIL FOR THE CITY OF JONESBORO, ARKANSAS THAT:

Section 1: That the City of Jonesboro shall issue a purchase order to Pickering to perform professional engineering services for the proposed improvements for Lacy Park Access Road from Dan Avenue (SR 91) south to the City Property Line in Jonesboro, Arkansas.

Section 2: Funding for the execution of the purchase order shall come from the Capital Improvement budget and compensation shall be paid in accordance with the attached proposal.

Section 3: The Mayor is hereby authorized by the City Council for the City of Jonesboro to execute all documents necessary to issue a purchase order.



July 12, 2017

Mr. Craig Light, PE
Chief Engineer
City of Jonesboro
300 South Church
Jonesboro, AR 72401

Re: Professional Services related to Proposed Improvements for Lacy Park Access Road from Dan Avenue (SR 91) south to the City Property Line Jonesboro, Arkansas

Mr. Light:

Pickering Firm, Inc., herein known as Pickering (the "Consultant"), is pleased to submit this Scope of Work and Fee Proposal to the City of Jonesboro, herein known as the City (the "Client"), for providing Professional Engineering services for the development of the referenced project. The project is more specifically defined as the design of a new access road from Dan Avenue (SR 91) south to the City owned property. Improvements will typically consist of a two lane roadway with sidewalks on both sides, and proposed signal modifications. Final design shall be based on a \$300,000 maximum budget based on state weighted unit averages. Our scope of services, schedule, and fee are shown below.

SCOPE OF SERVICES

Task A – Topo Surveys

1. All topography and cross-sections will be obtained using ground, not aerial, mapping methods. Locations, topography, and cross-sections will be performed along project corridor and all adjoining roadways within the project limits. Surveys along the mainline will be a width of 50 feet on each side of the existing centerline, for a total width of 100 feet.
2. The existing right-of-way will be determined on existing side roads (Dan Avenue) and the 60' right-of-way for the proposed road construction will be verified.
3. One Call will be contacted for field locations of underground utilities. These locations will be field located and shown on our plans. Arkansas One Call fees are included in the fees shown.

Task B - Geotechnical Investigation

1. A geotechnical investigation will be performed for the roadway in general accordance with AHTD standard practices. The geotechnical information gathered will be used for design recommendations such as pavement design and areas that may require undercut and select backfill.

Facility Design • Civil Engineering • Surveying • Transportation • Natural / Water Resources

100 E. Huntington, Suite B • Jonesboro, AR 72401 • Phone: 870.819.7918 • Cell: 901.491.0002 • www.pickeringfirm.com

Task C - Roadway Designs

1. Pickering will prepare construction plans in accordance with City standards and design guidelines.
2. The access road will generally consist of a two (2) lane section with 5' sidewalks on both sides. Additional turn lanes at the existing intersection of Dan Avenue will be required. The total distance of the section is approximately 0.12 miles.

No improvements are proposed to existing Dan Avenue. The new access road will tie to the existing conditions.

3. Roadway plans will include some or all of the following sheets: title, index, standard drawings, estimated roadway quantities, typical sections, general notes, special notes, details, standard plan and profile sheets, culvert sections, EPSC, traffic control, signing and pavement marking, roadway cross sections, and storm water pollution prevention plan (SWPPP) if required. A separate set of signal modification plans will be produced for bidding purposes.
4. All designs, plans, details and specifications for relocations of any utility or the addition of new utilities (other than street lighting) will be prepared by the utility owner or negotiated as additional services.

Task D – Signal Modification Design

1. Currently the Arkansas State Highway and Transportation Department (AHTD) has a project to install a RR Signal Upgrade and Traffic Signal located at the intersection of Henson Road and Dan Avenue. This project is scheduled for letting in June 2017 which is prior to the construction of the entrance drive to the park. Using the plans produced by the AHTD which will be furnished electronically, Pickering will produce a standalone set of construction plans and specifications for the signal modifications required to accommodate the new park access road.
2. An as-built survey will not be done when work on the signal project is completed. Features shown on the plans will be considered as as-built conditions for the purposes of the modification design.
3. The signal design will be in accordance with AHTD standards. Signal will be designed to comply with the AHTD and the City of Jonesboro specifications as required.

Task E - Bid Phase

1. Pickering will print plans for project review meetings and approvals. Printing of plans and specification for bidding purposes is not included and will be considered a reimbursable.
2. Bid phase services are not included.

Task F - Construction Phase

1. Construction phase services are not included.

OPTIONAL SERVICES

If the City requires services beyond what is provided in the scope of services listed above, said services can be performed based upon a negotiated lump sum fee agreed to by both of us. Additional services will only be performed after written authorization is received.

PROPOSED PROJECT SCHEDULE

It is our understanding that the City would like to have a construction contract in place to begin construction on this project in early 2018. To facilitate that schedule, Pickering will submit final construction documents by January 31, 2018.

FAILURE TO COMPLETE WORK ON TIME

Time is an essential element of the Agreement and it is important that the work be pressed vigorously to completion in accordance with the proposed project schedule. The cost to the Owner (City of Jonesboro) of the administration of this Agreement will be increased as the time occupied in the work is lengthened. Loss will accrue to the public due to delayed completion of the design and construction documents.

This being the case the Owner reserves the right to withhold payment from the Consultant for failure to perform services in a timely manner as per the mutually agreed upon schedule for factors within the Consultant's control. Payment will be withheld from the Consultant until the Owner is satisfied that the Consultant is progressing towards meeting the agreed upon schedule or upon completion of the project.

The Owner and consultant are aware that many factors outside the Consultant's control may affect the Consultant's ability to complete the services to be provided under this Agreement. The Consultant will perform these services with reasonable diligence and expediency consistent with sound professional practices.

If the Consultant becomes aware of delays due to time allowances for review and approval being exceeded, delay by the Owner, the Owner's consultants, reviews by governing agencies, or any other cause beyond the control of the Consultant, which will result in the schedule for performance of the Consultant's not being met, the Consultant shall promptly notify the Owner. If the Owner becomes aware of delays or other caused that will affect the Consultant's schedule, the Owner shall promptly notify the Consultant. In either event, the Consultant's schedule for performance of its services shall be equitably adjusted.

SUMMARY OF PROJECT FEES (TITLE I)

Design (Labor, Overhead, and Fee)	\$22,542.73
Direct Expenses	
Miscellaneous Expense	\$ 494.50
Ridge Surveying	\$ 1,900.00
Geotechnology, Inc.	\$ 4,803.20
Subtotal Direct Costs	<u>\$ 7,197.70</u>

Total Title I (Not to Exceed)

\$29,740.43

See Appendix A for a detailed scope and man-hour estimates for each of the required tasks.

TERMS AND CONDITIONS

The obligation to provide further services under this Agreement may be terminated by either party upon written notice in the event of substantial failure by the other party to perform in accordance with the terms hereof through no fault of the terminating party. In the event of termination, Pickering Firm, Inc. will be paid for services rendered to the date of termination.

The fees shown in this proposal are based on the Owner agreeing to limit the Professional's liability for all planning, engineering and analytical services to the Owner due to the Professional's negligent acts, errors, or omissions, such that the total aggregate liability of the Professional to all those named shall not exceed the Professional's total fee for services rendered on this project.

This proposal represents the entire understanding between you and us in respect to the "Project" and may only be modified in writing signed by both of us. If it satisfactorily sets for your understanding of the arrangement between us, please sign the acceptance of this proposed Letter Agreement in the space provided below and return it to us.

Please advise if further information is desired.

Sincerely,

PICKERING FIRM INCORPORATED



Michael L. Foster, P.E.
Project Manager

Accepted by: _____ Date: _____

T:\Foster\PROPOSALS - MLF\City of Jonesboro\Lacy and Northside Park\Revised Info\Lacy Park Access Road_053017.doc



**Justification of Fees and Costs
and
Scope of Work
FOR
Lacy Park Access Road
City of Jonesboro, Arkansas**

12-Jul-17

Appendix A

Lacy Park Access Road
City of Jonesboro, Arkansas

TITLE I

Plans Total Labor, Overhead, and Fee	\$ 22,542.73
Direct Expenses	\$7,197.70
Grand Total TITLE I	\$ 29,740.43

TITLE II

Plans Total Labor, Overhead, and Fee	Not Included
Direct Expenses	Not Included
Grand Total TITLE II	Not Included

Appendix A
Justification of Fees and Costs
Lacy Park Access Road
City of Jonesboro, Arkansas
TITLE I

	Estimated Hours							Total Hours
	Principal	Project Manager	Senior Engineer	Engineer	Senior Designer	Engineer Intern	Clerical	
Plan Preparation								
Roadway Design								
1. Project Administration	2	4						6
2. Perform Site Visit to Verify Survey			4			2		6
3. Title Sheet				1		2		3
4. Typical Sections			2		8			10
5. Index, General Notes, Standard Drawings				2	2	8		12
6. Horizontal Alignment			1			2		3
7. Vertical Alignment			1			4		5
8. Summary of Quantities			2		4			6
9. Plan & Profile Sheets (1 Sheets)			1		2	4		7
10. Drainage Design			2	4				6
11. Utility Coordination				4				4
12. Maintenance of Traffic Plans			1			4		5
13. Permanent Pavement Markings and Signs			1			2		3
14. EPSC Plans			1			4		5
15. Cross Sections			1			4		5
16. Permits (SWPPP, STAA, ACOE, etc.)				2				2
17. QA/QC		2	2					4
18. Plan Review Meetings			4	4				8
19. Address Comments from Review Meetings			1			4		5
20. Prepare Bid Book			4				12	16
Signal Modification Design								
1. Project Administration	1	2						3
2. Title Sheet				1		2		3
3. Index of Sheets				2	2	4		8
4. Summary of Quantities & Revisions			1	2	4			7
5. Maintenance of Traffic Plans			1			4		5
6. Permanent Pavement Markings and Signs			1	2		4		7
7. Traffic Signal Quantities			1	2	4			7
8. Traffic Signal Notes			1			2		3
9. System Map			1			2		3
10. Signalization Plan Sheets			1	2		4		7
11. Standard Drawings			1			2		3
12. Plan Review Meetings			4	4				8
13. Address Comments from Review Meetings			1			4		5
14. QA/QC		2	2					4
Totals	3	10	43	32	26	68	12	191

Labor Rates

	\$ 62.00	\$ 50.00	\$ 48.00	\$ 42.00	\$ 35.00	\$ 30.00	\$ 17.00	
Labor Cost	\$ 186.00	\$ 500.00	\$ 2,064.00	\$ 1,344.00	\$ 910.00	\$ 2,040.00	\$ 204.00	\$ 7,248.00
Overhead						%	177.50%	\$ 12,865.20
Total Labor and Overhead								\$ 20,113.20
Fixed Fee						%	12.00%	\$ 2,413.58
FCCM Overhead							0.22%	\$ 15.95
Total Labor, Overhead, and Fee:								\$ 22,542.73

<u>Direct Costs:</u>	Qty.	Unit Price	
Mileage	700	\$ 0.535	\$374.50
Meals	0	\$ 41.00	\$0.00
Lodging	0	\$ 96.00	\$0.00
Postage	0	\$ 100.00	\$0.00
Reproductions: 8 1/2" x 11"	50	\$ 0.10	\$5.00
Reproductions: 11" x 17"	100	\$ 0.15	\$15.00
Reproductions: Full Size	50	\$ 2.00	\$100.00
Ridge Surveying	1	\$ 1,900.00	\$1,900.00
Geotechnology, Inc.	1	\$ 4,803.20	\$4,803.20

Total Direct Costs: **\$7,197.70**

Project Total \$ 29,740.43



311 South Church Suite H
Jonesboro, Arkansas
May 3, 2017

Pickering Engineering, Michael Foster, Jonesboro, AR
RE: Proposal for Surveying Services-Intersection of Dan Ave & Henson Rd.

Thank you for the opportunity to offer you our Professional Surveying Services. Ridge Surveying & Consulting PLLC will perform the following scope of work for a fee of **\$1400.00**. (Estimated Arkansas One Call, not to exceed \$500.00. Not included in our \$1400.00 fee)

- Verify & Establish Site Survey Control.
- Research for project.
- Boundary Ties as needed to determine Right of Way.
- Topo data as discussed.
- Any Easements or Plats as needed for this project.
- Cad drawing with points and line work, as discussed.
- Professional Surveyor Computations & Calculations.
- Professional Surveyor Supervision.

Please note that we anticipate being able to complete this task as outlined above in approximately 15 working days from the time we have received a notice to proceed (depending on weather). If you find this proposal acceptable, please sign & return this document via email.

Name:

Date:

*DIVISION OF MATERIALS AND TESTS
GEOTECHNICAL ENGINEERING SECTION*

GEOTECHNICAL SERVICES

MANHOUR REQUIREMENTS AND COST ESTIMATE

CRAIGHEAD

LACY PARK ACCESS ROAD

INTERSECTION IMPROVEMENT

GEOTECHNOLOGY, INC.

Prepared By: ASHRAF ELSAYED, PH.D., P.E.

Date prepared: 5/4/2017

Federal Project No. N/A

State Project No. N/A

Geotechnical Office No. N/A

Pin No. N/A

Contract No, Work Order No. N/A

<Invoice Number>

ASHRAF ELSAYED, PH.D., P.E.

5501 Kreuger Drive, Suite 110

Jonesboro, AR 72401

<CONTACT ADDRESS>

901-353-1981

a_elsayed@geotechnology.com

Section III
Standard Cost Estimate For Soil And Geological Survey Report
1.00 Drilling Services

County: CRAIGHEAD
Route: LACY PARK ACCESS ROAD
Description: N/A
Project No.: N/A
Geotechnical Office No.: N/A
Consultant: GEOTECHNOLOGY, INC.
Prepared By: ASHRAF ELSAYED, PH.D., P.E.
Date Prepared: 5/4/2017
Contract Number: N/A

For further explanation of Item No. and Description refer to attached "Pay Item Numbers and Methods of Measurement for Cost Estimates".

Item No.	Description	Estimated Quantities	Basis of Payment		Price	Amount
1.01	Mobilization	1	each	@	\$1,200.00	\$1,200.00
1.06	Soil Drilling and Split Barrel Type Sampling on Land	20	vertical foot	@	\$18.50	\$370.00
1.07	Soil Drilling and Thin Wall Tube Type Sampling on Land	1	vertical foot	@	\$70.00	\$70.00
1.09 ^a	Traffic Control		Day	@	\$1,900.00	\$0.00
1.10	Pav. Patching and Site Restoration		each	@	\$75.00	\$0.00
1.13	Pavement Coring		per each	@	\$250.00	\$0.00
Total Estimated Drilling Costs						\$1,640.00

a: Direct Cost

Section III
Standard Cost Estimate for Soil and Geological Survey Report
2.00 Laboratory Services

County: CRAIGHEAD
Route: LACY PARK ACCESS ROAD
Description: N/A
Project No.: N/A
Geotechnical Office No.: N/A
Consultant: GEOTECHNOLOGY, INC.
Prepared By: ASHRAF ELSAYED, PH.D., P.E.
Date Prepared: 5/4/2017
Contract Number: N/A

For further explanation of Item No. and Description refer to attached "Pay Item Numbers and Methods of Measurement for Cost Estimates".

Item No.	Description	Estimated Quantities	Basis of Payment		Rate	Amount
2.01	Atterberg Limits	2	each	@	\$71.00	\$142.00
2.02	Natural Moisture Content	8	each	@	\$7.00	\$56.00
2.03	Particle Size Analysis	1	each	@	\$85.00	\$85.00
2.05	Proctor Density Test	1	each	@	\$180.00	\$180.00
2.06	California Bearing Ratio (per point)	2	each	@	\$150.00	\$300.00
2.10	Triaxial Compression UU	0	strength properties	@	\$369.19	\$0.00
2.12	Unconfined Compression	0	per test strength	@	\$75.00	\$0.00
2.63	CD Direct Shear	0	strength properties	@	\$493.31	\$0.00
Total Estimated Laboratory Services Cost:						\$763.00

Section III
Standard Cost Estimate for Soil and Geological Survey Report

3.00 Manpower Requirements

County: CRAIGHEAD
Route: LACY PARK ACCESS ROAD
Description: N/A
Project No.: N/A
Geotechnical Office No.: N/A
Consultant: GEOTECHNOLOGY, INC.
Prepared By: ASHRAF ELSAYED, PH.D., P.E.
Date Prepared: 5/4/2017
Contract Number: N/A

See "Pay Item Numbers and Methods of Measurement for Cost Estimates" for further description of services required by state.

Item No.	ACTIVITY	PRINCIPAL	SENIOR ENGINEER	STAFF ENGINEER	SENIOR GEOLOGIST	STAFF ENGINEER	SUPERVISIN G DRILLER	STAFF CADD TECHNICIAN	STAFF ENGINEER
		MAN-HOUR	MAN-HOUR	MAN-HOUR	MAN-HOUR	MAN-HOUR	MAN-HOUR	MAN-HOUR	MAN-HOUR
3.10	Project Planning and Coordination				1.0		1.0		
3.20	Field Activities								6.0
3.30	Data Assimilation			1.0					
3.40	Flexible Pavement Design			3.0					
3.50	Final Report Preparation	1.0		8.0				2.0	
3.70	Design-Phase and Post-Design Support	1.0							
Total Estimated Hours		2.0		12.0	1.0		1.0	2.0	6.0
Hourley Wages		\$57.53	\$38.12	\$26.10	\$32.60	\$24.25	\$38.36	\$25.10	\$21.50
Subtotal		\$ 115.06	\$ -	\$ 313.20	\$ 32.60	\$ -	\$ 38.36	\$ 50.20	\$ 129.00
Overhead 205.96%		\$ 236.98	\$ -	\$ 645.07	\$ 67.14	\$ -	\$ 79.01	\$103.39	\$ 265.69
Subtotal		\$ 352.04	\$ -	\$ 958.27	\$ 99.74	\$ -	\$ 117.37	\$153.59	\$ 394.69
Fees		\$ 42.24	\$ -	\$ 114.99	\$ 11.97	\$ -	\$ 14.08	\$ 18.43	\$ 47.36
FCCM 0.84%		\$ 0.97	\$ -	\$ 2.63	\$ 0.27	\$ -	\$ 0.32	\$ 0.42	\$ 1.08
Subtotal of Estimated Man-hour Costs		\$ 395.25	\$ -	\$ 1,075.89	\$ 111.99	\$ -	\$ 131.77	\$172.44	\$ 443.13

Total Estimate of Man-hour Requirements:

\$2,330.48

Section III
 Standard Cost Estimate for Soil and Geological Survey Report
3.00 Manpower Requirements, Hourly Rate Breakdown

County: CRAIGHEAD
 Route: LACY PARK ACCESS ROAD
 Description: N/A
 Project No.: N/A
 Geotechnical Office No.: N/A
 Consultant: GEOTECHNOLOGY, INC.
 Prepared By: ASHRAF ELSAYED, PH.D., P.E.
 Date Prepared: 5/4/2017
 Contract Number: N/A

Hourly Rate Breakdown		PRINCIPAL	SENIOR ENGINEER	STAFF ENGINEER	SENIOR GEOLOGIST	STAFF ENGINEER	SUPERVISING DRILLER	STAFF CADD TECHNICIAN	STAFF ENGINEER
		MAN-HOUR	MAN-HOUR	MAN-HOUR	MAN-HOUR	MAN-HOUR	MAN-HOUR	MAN-HOUR	MAN-HOUR
Direct Pay Rate		\$57.53	\$38.12	\$25.89	\$32.00	\$25.89	\$39.35	\$26.25	\$21.50
Pay Range		\$55-\$60	\$38-\$42	\$23-\$28	\$29-\$34	\$24-\$28	\$37-\$42	\$23-\$29	\$19-\$23
Overhead		105.96	105.96	105.96	105.96	105.96	105.96	105.96	205.96
FCCM		0.84	0.84	0.84	0.84	0.84	0.84	0.84	0.84

Section III
Standard Cost Estimate for Soil and Geological Survey Report
4.0 Other Expenses

County: CRAIGHEAD

Project No.: N/A

Route: LACY PARK ACCESS ROAD

Geotechnical Office No.: N/A

Description: N/A

Contract No: N/A

Prepared By: ASHRAF ELSAYED, PH.D., P.E.

Consultant: GEOTECHNOLOGY, INC.

Date Prepared: 5/4/2017

Distance to Jobsite:

Company Headquarters: <CITY,STATE>	Job Site: <CITY,STATE>
------------------------------------	------------------------

Travel Expenses				
Item No.	Description	Days	Rate*	Total
4.10	Travel Expenses		\$34.50	\$0.00
4.12	Lodging		\$83.00	\$0.00

*Must be in accordance with applicable AHTD Travel Regulations

Milage\Transportation Expenses				
Item No.	Description	Miles	Milage Rate*	Total
4.20	Passenger Truck	166	\$0.42	\$69.72

*Must be in accordance with applicable AHTD Travel Regulations

Equipment Rental				
Item No.	Description	Days	Daily Rate	Total

Plans Reproduction Costs				
Item No.	Description	Units	Unit Price	Total
4.43	Photocopies		\$0.47	\$0.00

Other Expenses				
Item No.	Description	Units	Unit Rate	Total

Total Estimate of Other Expenses:	\$69.72
------------------------------------------	----------------

Section III
Standard Cost Estimate for Soil and Geological Survey Report
SUMMARY OF COST ESTIMATES

County: CRAIGHEAD
Route: LACY PARK ACCESS ROAD
Description: N/A
Project No.: N/A
Geotechnical Office No.: N/A
Consultant: GEOTECHNOLOGY, INC.
Prepared By: ASHRAF ELSAYED, PH.D., P.E.
Date Prepared: 5/4/2017

1.00 Drilling Services	\$1,640.00
2.00 Laboratory Services	\$763.00
3.00 Manpower Requirements	\$2,330.48
4.00 Other Expenses	\$69.72
Total Not-to-Exceed Costs	\$4,803.20



Legislation Details (With Text)

File #:	RES-17:110	Version:	1	Name:	Purchase order to Pickering for professional services for Northside Park Access Road improvements
Type:	Resolution	Status:		Status:	To Be Introduced
File created:	7/17/2017	In control:		In control:	Public Works Council Committee
On agenda:		Final action:		Final action:	
Title:	A RESOLUTION TO THE CITY OF JONESBORO, ARKANSAS TO ISSUE A PURCHASE ORDER TO PICKERING TO PERFORM PROFESSIONAL ENGINEERING SERVICES				
Sponsors:	Engineering				
Indexes:	Other				
Code sections:					
Attachments:	Proposal				

Date	Ver.	Action By	Action	Result
------	------	-----------	--------	--------

A RESOLUTION TO THE CITY OF JONESBORO, ARKANSAS TO ISSUE A PURCHASE ORDER TO PICKERING TO PERFORM PROFESSIONAL ENGINEERING SERVICES

WHEREAS, the City of Jonesboro desires to issue a purchase order for professional engineering services for the proposed improvements for the Northside Park Access Road from North Patrick Street to North Church Street (SR 141) in Jonesboro, Arkansas; and,

WHEREAS, based on annual Statement of Qualifications submitted, the firm selected to perform professional engineering services for the above mentioned project is Pickering; and,

WHEREAS, Pickering has agreed to provide the services detailed in the attached proposal; and,

WHEREAS, funding for the execution of the purchase order shall come from the Capital Improvement budget and compensation shall be paid in accordance with the attached proposal.

NOW THEREFORE BE IT RESOLVED BY THE CITY COUNCIL FOR THE CITY OF JONESBORO, ARKANSAS THAT:

Section 1: That the City of Jonesboro shall issue of purchase order to Pickering to perform professional engineering services for Northside Park Access Road from North Patrick Street to North Church Street (SR 141) in Jonesboro, Arkansas; and,

Section 2: Funding for the execution of the purchase order shall come from the Capital Improvement budget and compensation shall be paid in accordance with the attached proposal.

Section 3: The Mayor is hereby authorized by the City Council for the City of Jonesboro to execute all documents necessary to effectuate this purchase order .



July 12, 2017

Mr. Craig Light, PE
Chief Engineer
City of Jonesboro
300 South Church
Jonesboro, AR 72401

**Re: Professional Services related to Proposed Improvements for Northside Park
Access Road from North Patrick Street to North Church Street (SR 141)
Jonesboro, Arkansas**

Mr. Light:

Pickering Firm, Inc., herein known as Pickering (the "Consultant"), is pleased to submit this Scope of Work and Fee Proposal to the City of Jonesboro, herein known as the City (the "Client"), for providing Professional Engineering services for the development of the referenced project. The project is more specifically defined as the design of a new access road from North Patrick Street to Warren Street, aligned with existing Hickory Street. In addition, Hickory Street will be improved and widened from Warren Street to North Church Street (SR 141). Improvements will consist typically of a two lane roadway with a 10' pedestrian trail, proposed bridge crossing over Lost Creek, and roadway lighting. Final design shall be based on \$3,000,000 maximum budget based on state weighted unit averages. Our scope of services, schedule, and fee are shown below.

SCOPE OF SERVICES

Task A – Topo & Boundary Surveys

1. All topography and cross-sections will be obtained using ground, not aerial, mapping methods. Locations, topography, and cross-sections will be performed along project corridor and all adjoining roadways within the project limits. Surveys along the mainline will be a width of 50 feet on each side of the existing centerline, for a total width of 100 feet.
2. Cross-section and profiles will be gathered on Lost Creek for the required hydraulic analysis. This will include a total six (6) cross-sections from approximately 400' upstream to 400' downstream.
3. In addition to the topographic survey, existing right-of-way will be determined on existing side roads (North Patrick Street, Warren Street, Hickory Street, and North Church Street). This includes a section of right-of-way that exists between the City property and existing Warren Street that is currently unused.
4. A boundary will also be performed on the existing City owned property located on both sides of Lost Creek. In addition to the City property, sufficient boundary work will be performed on adjacent properties to determine the required right-of-way acquisition from

Facility Design • Civil Engineering • Surveying • Transportation • Natural / Water Resources

100 E. Huntington, Suite B • Jonesboro, AR 72401 • Phone: 870.819.7918 • Cell: 901.491.0002 • www.pickeringinc.com

east of the City owned property to North Patrick Street. A legal description and plat will be provided for this acquisition. Additional takes will be shown on the plans if required. If additional takes are necessary, the production of plats and legal descriptions will be considered additional services.

5. One Call will be contacted for field locations of underground utilities. These locations will be field located and shown on our plans. Arkansas One Call fees are included in the fees shown.

Task B - Geotechnical Investigation

1. A geotechnical investigation will be performed for the roadway in general accordance with AHTD standard practices. The geotechnical information gathered will be used for design recommendations such as pavement design, deep foundation recommendations, and a liquefaction analysis. It will also be used to identify areas that may require undercut and select backfill. Field testing will include 5 pavement borings 10 foot deep and two bridge borings; one to 30 feet and another to 80 feet.
2. In addition, two pavement cores will be obtained on the existing section of Hickory Street to determine if the existing section needs to be removed or remain in place and widened. Required traffic control to obtain the pavement cores is included.
3. The City must facilitate access on private land and provide tree removal for access if required.
4. A geotechnical investigation will be performed for the bridge over Lost Creek. The geotechnical information gathered will be used for foundation design and scour analysis.
5. A site specific seismic study is not included.

Task C - Roadway Designs

1. Pickering will prepare construction plans in accordance with City standards and design guidelines.
2. The access road will generally consist of a two (2) lane section with a 10' pedestrian trail on one side. Additional turn lanes at the existing intersections may be required. This includes new construction from North Patrick Street to Warren Street and widening/improving the existing section of Hickory Street from Warren Street to North Church Street. The total distance of the section is approximately 0.50 miles.

No improvements are proposed to existing side roads other than minimum adjustments required to tie to the proposed improvements.

3. Roadway plans will include some or all of the following sheets: title, index, standard drawings, estimated bridge quantities and bridge index, estimated roadway quantities, typical sections, general notes, special notes, details, standard plan and profile sheets, private drive profiles, culvert sections, EPSC, traffic control, signing and pavement marking, roadway cross sections, and storm water pollution prevention plan (SWPPP) if required.
4. All designs, plans, details and specifications for relocations of any utility or the addition of new utilities (other than street lighting) will be prepared by the utility owner or negotiated as additional services.

Task D – Hydraulic Study

1. Pickering will conduct a bridge hydraulic study of the proposed bridge over Lost Creek in accordance with City and FEMA standards. Pickering will obtain the “effective” model from FEMA for use in the study. Pickering will develop a corrected “effective” model using the current field surveyed cross sections with the existing flows published in the FIS. The corrected “effective” model will be validated to address any discrepancies between the WSE’s in the FIS data and the corrected model. The corrected model will then be used to develop the proposed model with the proposed bridge structure.
2. Pickering will review the Corp’s model and coordinate the hydraulic analysis and structure opening with the future plans for Lost Creek.
3. A bridge hydraulic report will be prepared and submitted for review and approval. In addition, a “No-Rise” certificate will be prepared and submitted to the City.
4. If for some reason during the development of the hydraulic study it is determined that a CLOMR or LOMR is required, effort beyond obtaining a “No-Rise” certificate will be considered additional services.

Task E – Bridge Design

1. Pickering will prepare designs for a single span bridge at the Lost Creek crossing. It is assumed the bridge structure will be a single span crossing, founded on piles, reinforced concrete superstructure, spill-through abutments, and prestressed AASHTO concrete beams. The bridge will be designed to current AHTD seismic standards and will be sized to provide no rise to the current channel flow conditions. It will also adhere to AHTD’S specifications and list of required standard drawings.
2. If required due to vertical geometry restrictions, the bridge design will be modified to a 3-span bridge. The modified bridge will include bent design and foundation design. Bent foundations will be coordinated with scour analysis to determine appropriate depth of footings.

Task F – Lighting Designs

1. Pickering will prepare roadway lighting plans and specifications based upon IES RP-8 standards or criteria specified by the owner.
2. Standard City Water & Light poles and fixtures will be used. Data sheets on both the poles and fixtures will be provided by the City.

Task G - Bid Phase

1. Pickering will print plans for project review meetings and approvals. Printing of plans and specification for bidding purposes is not included and will be considered a reimbursable expense.
2. Bid phase services are not included.

Task H - Construction Phase

1. Construction phase services are not included.

OPTIONAL SERVICES

If the City requires services beyond what is provided in the scope of services listed above, said services can be performed based upon a negotiated lump sum fee agreed to by both parties. Additional services will only be performed after written authorization is received.

PROPOSED PROJECT SCHEDULE

It is our understanding that the City would like to have a construction contract in place to begin construction on this project in early 2018. To facilitate that schedule, Pickering will submit final construction documents by January 31, 2018.

FAILURE TO COMPLETE WORK ON TIME

Time is an essential element of the Agreement and it is important that the work be pressed vigorously to completion in accordance with the proposed project schedule. The cost to the Owner (City of Jonesboro) of the administration of this Agreement will be increased as the time occupied in the work is lengthened. Loss will accrue to the public due to delayed completion of the design and construction documents.

This being the case the Owner reserves the right to withhold payment from the Consultant for failure to perform services in a timely manner as per the mutually agreed upon schedule for factors within the Consultant's control. Payment will be withheld from the Consultant until the Owner is satisfied that the Consultant is progressing towards meeting the agreed upon schedule or upon completion of the project.

The Owner and consultant are aware that many factors outside the Consultant's control may affect the Consultant's ability to complete the services to be provided under this Agreement. The Consultant will perform these services with reasonable diligence and expediency consistent with sound professional practices.

If the Consultant becomes aware of delays due to time allowances for review and approval being exceeded, delay by the Owner, the Owner's consultants, reviews by governing agencies, or any other cause beyond the control of the Consultant, which will result in the schedule for performance of the Consultant's not being met, the Consultant shall promptly notify the Owner. If the Owner becomes aware of delays or other caused that will affect the Consultant's schedule, the Owner shall promptly notify the Consultant. In either event, the Consultant's schedule for performance of its services shall be equitably adjusted.

SUMMARY OF PROJECT FEES (TITLE I)

Design (Labor, Overhead, and Fee)	\$145,041.06
Direct Expenses	
Miscellaneous Expense	\$ 1,270.50
Ridge Surveying	\$ 8,200.00
Geotechnology, Inc.	\$ 15,644.08

Subtotal Direct Costs \$ 25,114.58
Total Title I (Not to Exceed) \$170,155.64

See Appendix A for a detailed scope and man-hour estimates for each of the required tasks.

TERMS AND CONDITIONS

The obligation to provide further services under this Agreement may be terminated by either party upon written notice in the event of substantial failure by the other party to perform in accordance with the terms hereof through no fault of the terminating party. In the event of termination, Pickering Firm, Inc. will be paid for services rendered to the date of termination.

The fees shown in this proposal are based on the Owner agreeing to limit the Professional's liability for all planning, engineering and analytical services to the Owner due to the Professional's negligent acts, errors, or omissions, such that the total aggregate liability of the Professional to all those named shall not exceed the Professional's total fee for services rendered on this project.

This proposal represents the entire understanding between you and us in respect to the "Project" and may only be modified in writing signed by both of us. If it satisfactorily sets for your understanding of the arrangement between us, please sign the acceptance of this proposed Letter Agreement in the space provided below and return it to us.

Please advise if further information is desired.

Sincerely,

PICKERING FIRM INCORPORATED



Michael L. Foster, P.E.
Project Manager

Accepted by: _____ Date: _____

T:\Foster\PROPOSALS - MLF\City of Jonesboro\Lacy and Northside Park\Revised Info\Northside Park Access Road_053017.doc



**Justification of Fees and Costs
and
Scope of Work
FOR
Northside Park Access Road
City of Jonesboro, Arkansas**

12-Jul-17

Appendix A

Northside Park Access Road
City of Jonesboro, Arkansas

TITLE I

Plans Total Labor, Overhead, and Fee	\$ 145,041.06
Direct Expenses	\$25,114.58
Grand Total TITLE I	\$ 170,155.64

TITLE II

Plans Total Labor, Overhead, and Fee	Not Included
Direct Expenses	Not Included
Grand Total TITLE II	Not Included

Appendix A
Justification of Fees and Costs
Nothside Park Access Road
City of Jonesboro, Arkansas
TITLE I

	Estimated Hours							Total Hours
	Principal	Project Manager	Senior Engineer	Engineer	Senior Designer	Engineer Intern	Clerical	
Plan Preparation								
Roadway Design								
1. Project Administration	8.0	16.0						24
2. Perform Site Visit to Verify Survey			8.0	8.0		4.0		20
3. Title Sheet				1		2		3
4. Typical Sections			2		8			10
5. Index, General Notes, Standard Drawings				2	2	8		12
6. Horizontal Alignment		1	2		4	4		11
7. Vertical Alignment		1	8		8	8		25
8. Summary of Quantities		2	8		16	8		34
9. Plan & Profile Sheets (6 Sheets)			2	8	8	24		42
10. Drainage Design			4	24	16	16		60
11. Utility Coordination			2	4	8	8		22
12. Maintenance of Traffic Plans			8	8	16	24		56
13. Permanent Pavement Markings and Signs			2	4		12		18
14. EPSC Plans			2			12		14
15. Cross Sections			8		8	24		40
16. Permits (SWPPP, STAA, ACOE, etc.)			4	16	16	24		60
17. Coordination with Bridge Design			4	4				8
18. QA/QC		16	16					32
19. Plan Review Meetings			16	16				32
20. Address Comments from Review Meetings		4	2	8	16	16		46
21. Prepare Bid Book			4				12	16
Hydraulic Design								
1. Effective Model				8				8
2. Corrected Effective Model				24				24
3. Proposed Model (ACOE)		4	8	72				84
4. Certification and Submittal		4	4	8				16
Bridge Design								
1. Project Administration	4	32						36
2. Girder Design			16					16
3. Deck Design			16					16
4. Substructure			8					8
5. Detailed Index			2	4	4			10
6. Summary of Quantities			2	8	8			18
7. Generalized Soil Profile			2	4	4			10
8. End Bents			8	16	8			32
9. End Bent Details			4	8	8			20
10. Interior Bents			8	16	8			32
11. Span Details			8	16	8			32
12. Typical Sections			8	16	8			32
13. Miscellaneous Span Details			2	6	4			12
14. Railing Details			2	4	4			10
15. Quantity Calculations			24		8			32
16. Plan Review Meetings			12	12				24
17. Coordination with Roadway Design			4	4				8
18. QA/QC			24					24
Lighting Design								
1. Project Administration	1	2						3
1. Site Visit			8					8
2. Photometric Calculations			2	4	8			14
3. Plans and Specifications			2	12	16			30
4. QA/QC		2	2					4
Totals	13	84	278	345	222	194	12	1148

Labor Rates

\$ 62.00 \$ 50.00 \$ 48.00 \$ 42.00 \$ 35.00 \$ 30.00 \$ 17.00

Labor Cost \$ 806.00 \$ 4,200.00 \$ 13,344.00 \$ 14,490.00 \$ 7,770.00 \$ 5,820.00 \$ 204.00 \$ 46,634.00

Overhead % 177.50% \$ 82,775.35

Total Labor and Overhead \$ 129,409.35

Fixed Fee % 12.00% \$ 15,529.12

FCCM Overhead 0.22% \$ 102.59

Total Labor, Overhead, and Fee: \$ 145,041.06

Direct Costs:

	Qty.	Unit Price	
Mileage	1,400	\$ 0.535	\$749.00
Meals	2	\$ 41.00	\$82.00
Lodging	2	\$ 96.00	\$192.00
Postage	0	\$ 100.00	\$0.00
Reproductions: 8 1/2" x 11"	100	\$ 0.10	\$10.00
Reproductions: 11" x 17"	250	\$ 0.15	\$37.50
Reproductions: Full Size	100	\$ 2.00	\$200.00
Ridge Surveying	1	\$ 8,200.00	\$8,200.00
Geotechnology, Inc.	1	\$ 15,644.08	\$15,644.08

Total Direct Costs: \$25,114.58

Project Total \$ 170,155.64



311 South Church Suite H
Jonesboro, Arkansas
May 3, 2017

Pickering Engineering, Michael Foster, Jonesboro, AR
RE: Proposal for Surveying Services-Roadway Corridor Patrick St to Church St

Thank you for the opportunity to offer you our Professional Surveying Services. Ridge Surveying & Consulting PLLC will perform the following scope of work for a fee of **\$7200.00**. (Estimated Arkansas One Call, not to exceed \$1000.00. Not included in our \$7200.00 fee)

- Verify & Establish Site Survey Control.
- Research for project.
- Boundary Ties as needed to determine Right of Way.
- Topo data for R/W as discussed.
- Cross Sections & profiles along Lost Creek as discussed.
- Any Easements or Plats as needed for this project.
- Cad drawing with points and line work, as discussed.
- Professional Surveyor Computations & Calculations.
- Professional Surveyor Supervision.

Please note that we anticipate being able to complete this task as outlined above in approximately 15 working days from the time we have received a notice to proceed (depending on weather). If you find this proposal acceptable, please sign & return this document via email.

Name:

Date:

*DIVISION OF MATERIALS AND TESTS
GEOTECHNICAL ENGINEERING SECTION*

GEOTECHNICAL SERVICES

MANHOUR REQUIREMENTS AND COST ESTIMATE

CRAIGHEAD

NORTHSIDE PARK ACCESS ROAD

INTERSECTION IMPROVEMENT

GEOTECHNOLOGY, INC.

Prepared By: ASHRAF ELSAYED, PH.D., P.E.

Date prepared: 5/4/2017

Federal Project No. N/A

State Project No. N/A

Geotechnical Office No. N/A

Pin No. N/A

Contract No, Work Order No. N/A

<Invoice Number>

ASHRAF ELSAYED, PH.D., P.E.

5501 Kreuger Drive, Suite 110

Jonesboro, AR 72401

<CONTACT ADDRESS>

901-353-1981

a_elsayed@geotechnology.com

Section III
 Standard Cost Estimate For Soil And Geological Survey Report
1.00 Drilling Services

County: CRAIGHEAD
 Route: NORTHSIDE PARK ACCESS ROAD
 Description: N/A
 Project No.: N/A
 Geotechnical Office No.: N/A
 Consultant: GEOTECHNOLOGY, INC.
 Prepared By: ASHRAF ELSAYED, PH.D., P.E.
 Date Prepared: 5/4/2017
 Contract Number: N/A

For further explanation of Item No. and Description refer to attached "Pay Item Numbers and Methods of Measurement for Cost Estimates".

Item No.	Description	Estimated Quantities	Basis of Payment		Price	Amount
1.01	Mobilization	1	each	@	\$1,200.00	\$1,200.00
1.02	Standby / Moving between Borings	4	each	@	\$200.00	\$800.00
1.06	Soil Drilling and Split Barrel Type Sampling on Land	160	vertical foot	@	\$18.50	\$2,960.00
1.07	Soil Drilling and Thin Wall Tube Type Sampling on Land	5	vertical foot	@	\$70.00	\$350.00
1.09 ^a	Traffic Control	1	Day	@	\$1,900.00	\$1,900.00
1.10	Pav. Patching and Site Restoration	1	each	@	\$75.00	\$75.00
1.13	Pavement Coring	2	per each	@	\$250.00	\$500.00
Total Estimated Drilling Costs						\$7,785.00

a: Direct Cost

Section III
 Standard Cost Estimate for Soil and Geological Survey Report
2.00 Laboratory Services

County: CRAIGHEAD
 Route: NORTHSIDE PARK ACCESS ROAD
 Description: N/A
 Project No.: N/A
 Geotechnical Office No.: N/A
 Consultant: GEOTECHNOLOGY, INC.
 Prepared By: ASHRAF ELSAYED, PH.D., P.E.
 Date Prepared: 5/4/2017
 Contract Number: N/A

For further explanation of Item No. and Description refer to attached "Pay Item Numbers and Methods of Measurement for Cost Estimates".

Item No.	Description	Estimated Quantities	Basis of Payment		Rate	Amount
2.01	Atterberg Limits	8	each	@	\$71.00	\$568.00
2.02	Natural Moisture Content	42	each	@	\$7.00	\$294.00
2.03	Particle Size Analysis	7	each	@	\$85.00	\$595.00
2.05	Proctor Density Test	1	each	@	\$180.00	\$180.00
2.06	California Bearing Ratio (per point)	2	each	@	\$150.00	\$300.00
2.10	Triaxial Compression UU	0	strength properties	@	\$369.19	\$0.00
2.12	Unconfined Compression	3	per test	@	\$85.00	\$255.00
2.63	CD Direct Shear	0	strength properties	@	\$493.31	\$0.00
Total Estimated Laboratory Services Cost:						\$2,192.00

Section III
Standard Cost Estimate for Soil and Geological Survey Report
3.00 Manpower Requirements

County: CRAIGHEAD
Route: NORTHSIDE PARK ACCESS ROAD
Description: N/A
Project No.: N/A
Geotechnical Office No.: N/A
Consultant: GEOTECHNOLOGY, INC.
Prepared By: ASHRAF ELSAYED, PH.D., P.E.
Date Prepared: 5/4/2017
Contract Number: N/A

See "Pay Item Numbers and Methods of Measurement for Cost Estimates" for further description of services required by state.

Item No.	ACTIVITY	PRINCIPAL	SENIOR ENGINEER	STAFF ENGINEER	SENIOR GEOLOGIST	STAFF ENGINEER	SUPERVISIN G DRILLER	STAFF CADD TECHNICIAN	STAFF ENGINEER
		MAN-HOUR	MAN-HOUR	MAN-HOUR	MAN-HOUR	MAN-HOUR	MAN-HOUR	MAN-HOUR	MAN-HOUR
3.10	Project Planning and Coordination				2.0		2.0		
3.20	Field Activities								20.0
3.30	Data Assimilation			4.0					
3.40	Flexible Pavement Design			3.0					
3.50	Final Report Preparation	2.0		22.0				2.0	
3.70	Design-Phase and Post-Design Support	2.0							
Total Estimated Hours		4.0		29.0	2.0		2.0	2.0	20.0
Hourley Wages		\$57.53	\$38.12	\$26.10	\$32.60	\$24.25	\$38.36	\$25.10	\$21.50
Subtotal		\$ 230.12	\$ -	\$ 756.90	\$ 65.20	\$ -	\$ 76.72	\$ 50.20	\$ 430.00
Overhead 205.96%		\$ 473.96	\$ -	\$ 1,558.91	\$ 134.29	\$ -	\$ 158.01	\$103.39	\$ 885.63
Subtotal		\$ 704.08	\$ -	\$ 2,315.81	\$ 199.49	\$ -	\$ 234.73	\$153.59	\$1,315.63
Fees		\$ 84.49	\$ -	\$ 277.90	\$ 23.94	\$ -	\$ 28.17	\$ 18.43	\$ 157.88
FCCM 0.84%		\$ 1.93	\$ -	\$ 6.36	\$ 0.55	\$ -	\$ 0.64	\$ 0.42	\$ 3.61
Subtotal of Estimated Man-hour Costs		\$ 790.50	\$ -	\$ 2,600.07	\$ 223.97	\$ -	\$ 263.54	\$172.44	\$1,477.12

Total Estimate of Man-hour Requirements:

\$5,527.64

Section III
 Standard Cost Estimate for Soil and Geological Survey Report
3.00 Manpower Requirements, Hourly Rate Breakdown

County: CRAIGHEAD
 Route: NORTHSIDE PARK ACCESS ROAD
 Description: N/A
 Project No.: N/A
 Geotechnical Office No.: N/A
 Consultant: GEOTECHNOLOGY, INC.
 Prepared By: ASHRAF ELSAYED, PH.D., P.E.
 Date Prepared: 5/4/2017
 Contract Number: N/A

Hourly Rate Breakdown		PRINCIPAL	SENIOR ENGINEER	STAFF ENGINEER	SENIOR GEOLOGIST	STAFF ENGINEER	SUPERVISING DRILLER	STAFF CADD TECHNICIAN	STAFF ENGINEER
		MAN-HOUR	MAN-HOUR	MAN-HOUR	MAN-HOUR	MAN-HOUR	MAN-HOUR	MAN-HOUR	MAN-HOUR
Direct Pay Rate		\$57.53	\$38.12	\$25.89	\$32.00	\$25.89	\$39.35	\$26.25	\$21.50
Pay Range		\$55-\$60	\$38-\$42	\$23-\$28	\$29-\$34	\$24-\$28	\$37-\$42	\$23-\$29	\$19-\$23
Overhead		105.96	105.96	105.96	105.96	105.96	105.96	105.96	205.96
FCCM		0.84	0.84	0.84	0.84	0.84	0.84	0.84	0.84

Section III
Standard Cost Estimate for Soil and Geological Survey Report
4.0 Other Expenses

County: CRAIGHEAD

Project No.: N/A

Route: NORTHSIDE PARK ACCESS ROAD

Geotechnical Office No.: N/A

Description: N/A

Contract No: N/A

Prepared By: ASHRAF ELSAYED, PH.D., P.E.

Consultant: GEOTECHNOLOGY, INC.

Date Prepared: 5/4/2017

Distance to Jobsite:

Company Headquarters: <CITY,STATE>	Job Site: <CITY,STATE>
------------------------------------	------------------------

Travel Expenses				
Item No.	Description	Days	Rate*	Total
4.10	Travel Expenses		\$34.50	\$0.00
4.12	Lodging		\$83.00	\$0.00

*Must be in accordance with applicable AHTD Travel Regulations

Milage\Transportation Expenses				
Item No.	Description	Miles	Milage Rate*	Total
4.20	Passenger Truck	332	\$0.42	\$139.44

*Must be in accordance with applicable AHTD Travel Regulations

Equipment Rental				
Item No.	Description	Days	Daily Rate	Total

Plans Reproduction Costs				
Item No.	Description	Units	Unit Price	Total
4.43	Photocopies		\$0.47	\$0.00

Other Expenses				
Item No.	Description	Units	Unit Rate	Total

Total Estimate of Other Expenses:	\$139.44
------------------------------------------	-----------------

Section III
Standard Cost Estimate for Soil and Geological Survey Report
SUMMARY OF COST ESTIMATES

County: CRAIGHEAD
Route: NORTHSIDE PARK ACCESS ROAD
Description: N/A
Project No.: N/A
Geotechnical Office No.: N/A
Consultant: GEOTECHNOLOGY, INC.
Prepared By: ASHRAF ELSAYED, PH.D., P.E.
Date Prepared: 5/4/2017

1.00 Drilling Services	\$7,785.00
2.00 Laboratory Services	\$2,192.00
3.00 Manpower Requirements	\$5,527.64
4.00 Other Expenses	\$139.44
Total Not-to-Exceed Costs	\$15,644.08



Legislation Details (With Text)

File #:	RES-17:111	Version:	1	Name:	Permanent easement from Raymond Holladay to construct a sidewalk
Type:	Resolution	Status:		Status:	To Be Introduced
File created:	7/18/2017	In control:		In control:	Public Works Council Committee
On agenda:		Final action:		Final action:	
Title:	A RESOLUTION TO THE CITY OF JONESBORO, ARKANSAS TO AUTHORIZE THE MAYOR AND CITY CLERK TO ACCEPT A PERMANENT CONSTRUCTION EASEMENT FROM RAYMOND W. HOLLADAY FOR THE PURPOSE OF CONSTRUCTING AND MAINTAINING A SIDEWALK				
Sponsors:	Engineering				
Indexes:	Easement				
Code sections:					
Attachments:	Permanent Construction Easement				

Date	Ver.	Action By	Action	Result
------	------	-----------	--------	--------

A RESOLUTION TO THE CITY OF JONESBORO, ARKANSAS TO AUTHORIZE THE MAYOR AND CITY CLERK TO ACCEPT A PERMANENT CONSTRUCTION EASEMENT FROM RAYMOND W. HOLLADAY FOR THE PURPOSE OF CONSTRUCTING AND MAINTAINING A SIDEWALK WHEREAS, the City of Jonesboro, Arkansas desires to accept the following described easement for the purpose of constructing and maintaining a sidewalk:

A PART OF LOT 5, BLOCK B OF EARL KIECH SECOND ADDITION TO THE CITY OF JONESBORO, CRAIGHEAD COUNTY, ARKANSAS, (AS RECORDED IN BOOK 48, PAGE 218), BEING MORE PARTICULARLY DESCRIBED AS FOLLOWS:

BEGINNING AT THE SOUTHWEST CORNER OF LOT 5, BLOCK B, OF EARL KIECH SECOND ADDITION TO THE CITY OF JONESBORO, CRAIGHEAD COUNTY, ARKANSAS; THENCE NORTH 89°50'29" EAST, ALONG THE NORTHERLY RIGHT-OF-WAY LINE OF RACE STREET, 55.68 FEET TO A POINT ON A CURVE TO THE LEFT, SAID POINT BEING ON THE WESTERLY RIGHT-OF-WAY LINE OF THORN STREET; THENCE ALONG SAID WESTERLY RIGHT-OF-WAY THE FOLLOWING COURSES AND DISTANCES: NORTHEASTERLY ALONG SAID CURVE WITH A CENTRAL ANGLE OF 32°56'57", A RADIUS OF 112.92 FEET, 64.94 FEET TO A POINT THAT BEARS NORTH 43°40'33" EAST, 64.05 FEET FROM THE LAST SAID POINT; NORTH 00°11'54" WEST, 73.10 FEET TO THE POINT OF BEGINNING; THENCE NORTH 44°55'56" WEST, LEAVING SAID WESTERLY RIGHT-OF-WAY LINE, 3.79 FEET; THENCE NORTH 00°04'04" EAST, 24.56 FEET; THENCE NORTH 45°04'04" EAST, 3.59 FEET TO THE WESTERLY RIGHT-OF-WAY LINE OF THORN STREET; THENCE SOUTH 00°11'54" EAST, ALONG SAID EASTERLY RIGHT-OF-WAY LINE, 29.77 FEET TO THE POINT OF BEGINNING PROPER, CONTAINING 71 SQ. FT., MORE OR LESS, SUBJECT TO ALL RIGHTS-OF-WAY AND EASEMENTS OF RECORD.

NOW THEREFORE BE IT RESOLVED BY THE CITY COUNCIL FOR THE CITY OF JONESBORO, ARKANSAS THAT:

Section 1: The Mayor and City Clerk are hereby authorized by the City Council for the City of Jonesboro, Arkansas to accept the easement described above.

Return recorded document to:
CITY OF JONESBORO
300 South Church Street
Jonesboro, AR 72401

The above space is reserved for Craighead County recording information

PERMANENT CONSTRUCTION EASEMENT

KNOW ALL MEN BY THESE PRESENTS:

That RAYMOND W. HOLLADAY, hereinafter referred to as Grantor (whether one or more), does hereby dedicate, grant and convey unto the Public, and that the **CITY OF JONESBORO**, a Municipal Corporation of the State of Arkansas, hereinafter referred to as Grantee, does hereby accept on behalf of the public, for use as a permanent construction easement across the following described real property in Craighead County, State of Arkansas, to-wit:

A PART OF LOT 5, BLOCK B OF EARL KIECH SECOND ADDITION TO THE CITY OF JONESBORO, CRAIGHEAD COUNTY, ARKANSAS, (AS RECORDED IN BOOK 48, PAGE 218), BEING MORE PARTICULARLY DESCRIBED AS FOLLOWS:

BEGINNING AT THE SOUTHWEST CORNER OF LOT 5, BLOCK B, OF EARL KIECH SECOND ADDITION TO THE CITY OF JONESBORO, CRAIGHEAD COUNTY, ARKANSAS; THENCE NORTH 89°50'29" EAST, ALONG THE NORTHERLY RIGHT-OF-WAY LINE OF RACE STREET, 55.68 FEET TO A POINT ON A CURVE TO THE LEFT, SAID POINT BEING ON THE WESTERLY RIGHT-OF-WAY LINE OF THORN STREET; THENCE ALONG SAID WESTERLY RIGHT-OF-WAY THE FOLLOWING COURSES AND DISTANCES: NORTHEASTERLY ALONG SAID CURVE WITH A CENTRAL ANGLE OF 32°56'57", A RADIUS OF 112.92 FEET, 64.94 FEET TO A POINT THAT BEARS NORTH 43°40'33" EAST, 64.05 FEET FROM THE LAST SAID POINT; NORTH 00°11'54" WEST, 73.10 FEET TO THE POINT OF BEGINNING; THENCE NORTH 44°55'56" WEST, LEAVING SAID WESTERLY RIGHT-OF-WAY LINE, 3.79 FEET; THENCE NORTH 00°04'04" EAST, 24.56 FEET; THENCE NORTH 45°04'04" EAST, 3.59 FEET TO THE WESTERLY RIGHT-OF-WAY LINE OF THORN STREET; THENCE SOUTH 00°11'54" EAST, ALONG SAID EASTERLY RIGHT-OF-WAY LINE, 29.77 FEET TO THE POINT OF BEGINNING PROPER, CONTAINING 71 SQ. FT., MORE OR LESS, SUBJECT TO ALL RIGHTS-OF-WAY AND EASEMENTS OF RECORD.

This easement and right of way is for the purpose of constructing and maintaining a sidewalk. Any other use of this area, other than by record owners, shall only be granted by record owners, but they are not precluded from using or granting other use, so long as same does not interfere unreasonably with the express purpose intended.

This grant of easement and right of way shall be binding upon the heirs, successors, administrators and assigns of the grantors.

IN WITNESS WHEREOF, the grantors have executed this instrument on the 18th day of July, 2017.

Owner Info
BY:

Signature: Raymond W. Holladay

Name: RAYMOND W. HOLLADY

Title: OWNER

ACKNOWLEDGMENT

STATE OF Arkansas

COUNTY OF Craighead

On this day before me, the undersigned officer, personally appeared Raymond Holladay, to me well known to be the person whose name is subscribed to the foregoing instrument, and acknowledged that he had executed the same for the purpose therein stated and set forth.

WITNESS my hand and seal this 18th day of July, 2017.

Notary Public (Signature): Laurie Denise Hester

My Commission Expires: 11-13-17

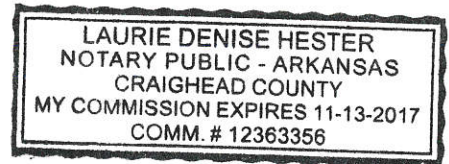

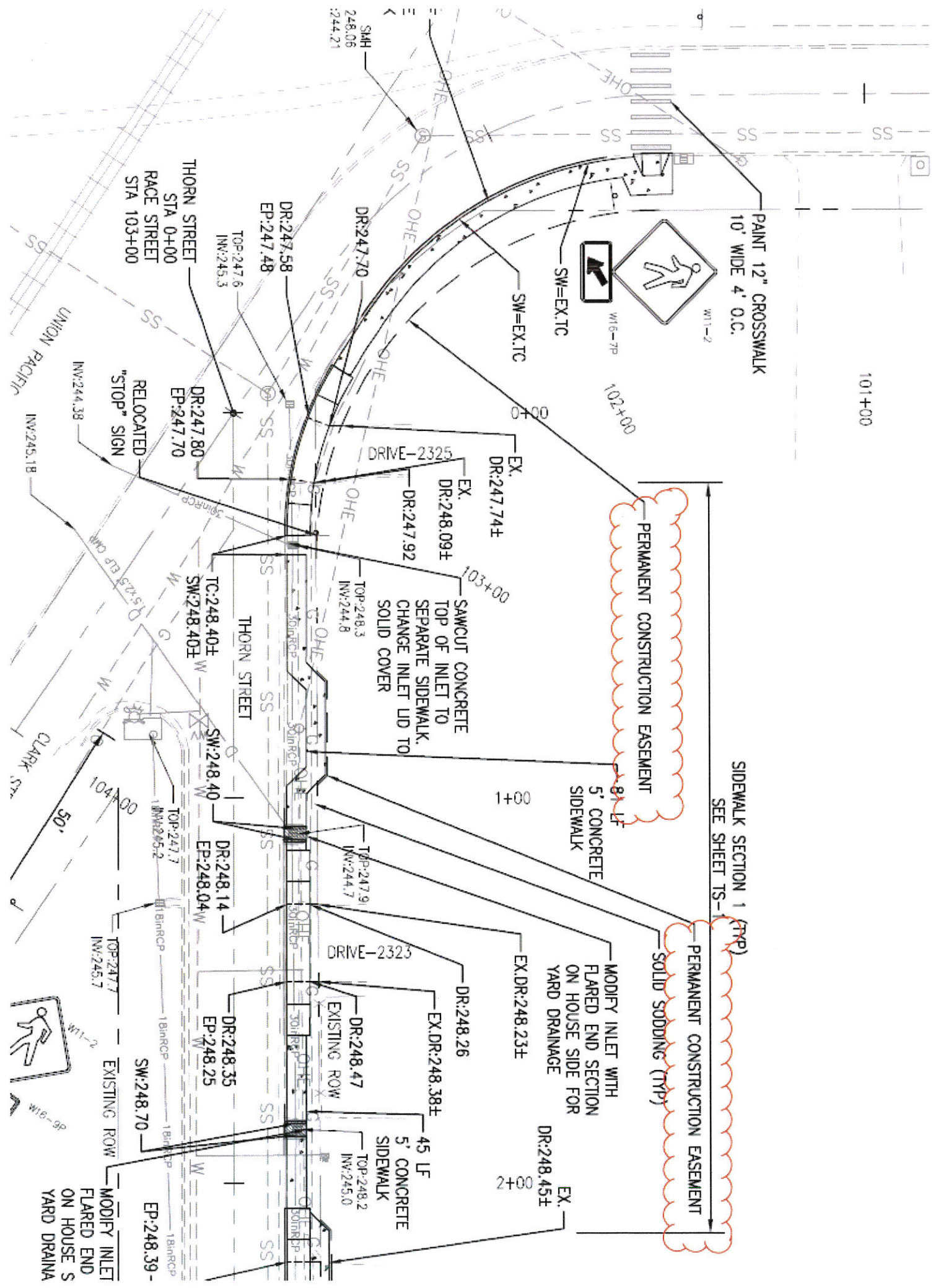

PAINT 12" CROSSWALK
10' WIDE 4' O.C.

101+00

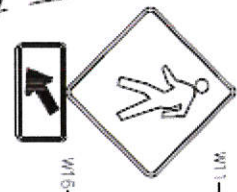

W16-7P

102+00

PERMANENT CONSTRUCTION EASEMENT

SIDEWALK SECTION 1 (TYP)
SEE SHEET TS-

PERMANENT CONSTRUCTION EASEMENT
SOLID SODDING (TYP)

5' CONCRETE
SIDEWALK

81 LF

MODIFY INLET WITH
FLARED END SECTION
ON HOUSE SIDE FOR
YARD DRAINAGE

EX.DR:248.23±

SAWCUT CONCRETE
TOP OF INLET TO
SEPARATE SIDEWALK.
CHANGE INLET LID TO
SOLID COVER

EX.
DR:248.09±

103+00

EX.
DR:248.45±

5' CONCRETE
SIDEWALK

45 LF

DRIVE-2323

EX.DR:248.38±

EXISTING ROW

DR:248.47

TOP:248.2
INV:245.0

TC:248.40±
SW:248.40±

THORN STREET

EP:248.04±

DR:248.14

DR:248.35

EP:248.25

THORN STREET
STA 0+00
RACE STREET
STA 103+00

RELOCATED
"STOP" SIGN

INV:244.38

INV:245.18

104+00

EXISTING ROW

MODIFY INLET
FLARED END
ON HOUSE S
YARD DRAINAGE

EP:248.39-



W11-2

W16-7P

SMH
248.06
244.21

DR:247.58
EP:247.48

TOP:247.6
INV:245.3

DR:247.80
EP:247.70

DRIVE-2325

EX.
DR:247.74±

TOP:248.3
INV:244.8

TOP:247.9
INV:244.7

TOP:247.7
INV:245.7

TOP:247.7
INV:245.7

SW:248.70



Legislation Details (With Text)

File #:	RES-17:112	Version:	1	Name:	Permanent easement from Raymond Holladay to construct a sidewalk
Type:	Resolution	Status:		Status:	To Be Introduced
File created:	7/18/2017	In control:		In control:	Public Works Council Committee
On agenda:		Final action:		Final action:	
Title:	A RESOLUTION TO THE CITY OF JONESBORO, ARKANSAS TO AUTHORIZE THE MAYOR AND CITY CLERK TO ACCEPT A PERMANENT CONSTRUCTION EASEMENT FROM RAYMOND W. HOLLADAY FOR THE PURPOSE OF CONSTRUCTING AND MAINTAINING A SIDEWALK				
Sponsors:	Engineering				
Indexes:	Easement				
Code sections:					
Attachments:	Permanent Construction Easement - Holladay				

Date	Ver.	Action By	Action	Result
------	------	-----------	--------	--------

A RESOLUTION TO THE CITY OF JONESBORO, ARKANSAS TO AUTHORIZE THE MAYOR AND CITY CLERK TO ACCEPT A PERMANENT CONSTRUCTION EASEMENT FROM RAYMOND W. HOLLADAY FOR THE PURPOSE OF CONSTRUCTING AND MAINTAINING A SIDEWALK WHEREAS, the City of Jonesboro, Arkansas desires to accept the following described easement for the purpose of constructing and maintaining a sidewalk:

A PART OF LOT 5, BLOCK B OF EARL KIECH SECOND ADDITION TO THE CITY OF JONESBORO, CRAIGHEAD COUNTY, ARKANSAS, (AS RECORDED IN BOOK 48, PAGE 218), BEING MORE PARTICULARLY DESCRIBED AS FOLLOWS:

BEGINNING AT THE SOUTHWEST CORNER OF LOT 5, BLOCK B, OF EARL KIECH SECOND ADDITION TO THE CITY OF JONESBORO, CRAIGHEAD COUNTY, ARKANSAS; THENCE NORTH 89°50'29" EAST, ALONG THE NORTHERLY RIGHT-OF-WAY LINE OF RACE STREET, 10.01 FEET TO A POINT ON A CURVE TO THE LEFT, SAID POINT BEING THE POINT OF BEGINNING PROPER; THENCE NORTHEASTERLY, LEAVING SAID NORTHERLY RIGHT-OF-WAY LINE, ALONG SAID CURVE WITH A CENTRAL ANGLE OF 90°02'24", A RADIUS OF 90.00 FEET, 141.43 FEET TO A POINT THAT BEARS NORTH 44°49'17" EAST, 127.32 FEET FROM THE LAST SAID POINT, SAID POINT BEING ON THE WESTERLY RIGHT-OF-WAY LINE OF THORN STREET; THENCE ALONG SAID WESTERLY RIGHT-OF-WAY LINE THE FOLLOWING COURSES AND DISTANCES: SOUTH 00°11'54" EAST, 43.86 FEET TO A POINT ON A CURVE TO THE RIGHT; SOUTHWESTERLY ALONG SAID CURVE WITH A CENTRAL ANGLE OF 32°56'57", A RADIUS OF 112.92 FEET, 64.94 FEET TO A POINT THAT BEARS SOUTH 43°40'33" WEST, 64.05 FEET FROM THE LAST SAID POINT, SAID POINT BEING ON THE NORTHERLY RIGHT-OF-WAY LINE OF RACE STREET; THENCE SOUTH 89°50'29" WEST, ALONG SAID NORTHERLY RIGHT-OF-WAY LINE, 45.67 FEET TO THE POINT OF BEGINNING PROPER, CONTAINING 914 SQ. FT., MORE OR LESS, SUBJECT TO ALL RIGHTS-OF-WAY AND EASEMENTS OF RECORD.

NOW THEREFORE BE IT RESOLVED BY THE CITY COUNCIL FOR THE CITY OF JONESBORO,

ARKANSAS THAT:

Section 1: The Mayor and City Clerk are hereby authorized by the City Council for the City of Jonesboro, Arkansas to accept the easement described above.

Return recorded document to:
CITY OF JONESBORO
300 South Church Street
Jonesboro, AR 72401

The above space is reserved for Craighead County recording information

PERMANENT CONSTRUCTION EASEMENT

KNOW ALL MEN BY THESE PRESENTS:

That RAYMOND W. HOLLADAY, hereinafter referred to as Grantor (whether one or more), does hereby dedicate, grant and convey unto the Public, and that the **CITY OF JONESBORO**, a Municipal Corporation of the State of Arkansas, hereinafter referred to as Grantee, does hereby accept on behalf of the public, for use as a permanent construction easement across the following described real property in Craighead County, State of Arkansas, to-wit:

A PART OF LOT 5, BLOCK B OF EARL KIECH SECOND ADDITION TO THE CITY OF JONESBORO, CRAIGHEAD COUNTY, ARKANSAS, (AS RECORDED IN BOOK 48, PAGE 218), BEING MORE PARTICULARLY DESCRIBED AS FOLLOWS:

BEGINNING AT THE SOUTHWEST CORNER OF LOT 5, BLOCK B, OF EARL KIECH SECOND ADDITION TO THE CITY OF JONESBORO, CRAIGHEAD COUNTY, ARKANSAS; THENCE NORTH 89°50'29" EAST, ALONG THE NORTHERLY RIGHT-OF-WAY LINE OF RACE STREET, 10.01 FEET TO A POINT ON A CURVE TO THE LEFT, SAID POINT BEING THE POINT OF BEGINNING PROPER; THENCE NORTHEASTERLY, LEAVING SAID NORTHERLY RIGHT-OF-WAY LINE, ALONG SAID CURVE WITH A CENTRAL ANGLE OF 90°02'24", A RADIUS OF 90.00 FEET, 141.43 FEET TO A POINT THAT BEARS NORTH 44°49'17" EAST, 127.32 FEET FROM THE LAST SAID POINT, SAID POINT BEING ON THE WESTERLY RIGHT-OF-WAY LINE OF THORN STREET; THENCE ALONG SAID WESTERLY RIGHT-OF-WAY LINE THE FOLLOWING COURSES AND DISTANCES: SOUTH 00°11'54" EAST, 43.86 FEET TO A POINT ON A CURVE TO THE RIGHT; SOUTHWESTERLY ALONG SAID CURVE WITH A CENTRAL ANGLE OF 32°56'57", A RADIUS OF 112.92 FEET, 64.94 FEET TO A POINT THAT BEARS SOUTH 43°40'33" WEST, 64.05 FEET FROM THE LAST SAID POINT, SAID POINT BEING ON THE NORTHERLY RIGHT-OF-WAY LINE OF RACE STREET; THENCE SOUTH 89°50'29" WEST, ALONG SAID NORTHERLY RIGHT-OF-WAY LINE, 45.67 FEET TO THE POINT OF BEGINNING PROPER, CONTAINING 914 SQ. FT., MORE OR LESS, SUBJECT TO ALL RIGHTS-OF-WAY AND EASEMENTS OF RECORD.

This easement and right of way is for the purpose of constructing and maintaining a sidewalk. Any other use of this area, other than by record owners, shall only be granted by record owners, but they are not precluded from using or granting other use, so long as same does not interfere unreasonably with the express purpose intended.

This grant of easement and right of way shall be binding upon the heirs, successors, administrators and assigns of the grantors.

IN WITNESS WHEREOF, the grantors have executed this instrument on the 18th day of July, 2017.

**Owner Info
BY:**

Signature: Raymond W. Holladay

Name: RAYMOND W. HOLLADAY

Title: OWNER

ACKNOWLEDGMENT

STATE OF Arkansas

COUNTY OF Craighead

On this day before me, the undersigned officer, personally appeared Raymond Holladay to me well known to be the person whose name is subscribed to the foregoing instrument, and acknowledged that he had executed the same for the purpose therein stated and set forth.

WITNESS my hand and seal this 18th day of July, 2017.

Notary Public (Signature): Laurie Denise Hester

My Commission Expires: 11-13-17





Legislation Details (With Text)

File #:	RES-17:113	Version:	1	Name:	Permanent easement from Nettleton School District to construct a sidewalk
Type:	Resolution	Status:		Status:	To Be Introduced
File created:	7/18/2017	In control:		In control:	Public Works Council Committee
On agenda:		Final action:			
Title:	A RESOLUTION TO THE CITY OF JONESBORO, ARKANSAS TO AUTHORIZE THE MAYOR AND CITY CLERK TO ACCEPT A PERMANENT CONSTRUCTION EASEMENT FROM NETTLETON PHILLIPS SPECIAL SCHOOL DISTRICT FOR THE PURPOSE OF CONSTRUCTING AND MAINTAINING A SIDEWALK				
Sponsors:	Engineering				
Indexes:	Easement				
Code sections:					
Attachments:	Permanent Construction Esasement - Nettleton				

Date	Ver.	Action By	Action	Result
------	------	-----------	--------	--------

A RESOLUTION TO THE CITY OF JONESBORO, ARKANSAS TO AUTHORIZE THE MAYOR AND CITY CLERK TO ACCEPT A PERMANENT CONSTRUCTION EASEMENT FROM NETTLETON PHILLIPS SPECIAL SCHOOL DISTRICT FOR THE PURPOSE OF CONSTRUCTING AND MAINTAINING A SIDEWALK

WHEREAS, the City of Jonesboro, Arkansas desires to accept the following described easement for the purpose of constructing and maintaining a sidewalk:

A PART OF LOT 42 OF COBB AND LEE SURVEY OF THE SOUTHEAST QUARTER OF THE NORTHWEST QUARTER OF SECTION 27, TOWNSHIP 14 NORTH, RANGE 04 EAST, JONESBORO, CRAIGHEAD COUNTY, ARKANSAS, (AS RECORDED IN BOOK 48, PAGE 114), BEING MORE PARTICULARLY DESCRIBED AS FOLLOWS:

BEGINNING AT THE SOUTHEAST CORNER OF LOT 42 OF COBB AND LEE SURVEY OF THE SOUTHEAST QUARTER OF THE NORTHWEST QUARTER OF SECTION 27, TOWNSHIP 14 NORTH, RANGE 04 EAST, JONESBORO, CRAIGHEAD COUNTY, ARKANSAS; THENCE SOUTH 88°44'37" WEST, ALONG THE SOUTH LINE OF SAID LOT 42, 1.30 FEET; THENCE NORTH 00°02'18" WEST, LEAVING SAID SOUTH LINE, 115.45 FEET; THENCE SOUTH 89°32'08" EAST, 2.31 FEET TO THE WESTERLY RIGHT-OF-WAY LINE OF THORN STREET; THENCE SOUTH 00°27'52" WEST, ALONG SAID WESTERLY RIGHT-OF-WAY LINE, 115.41 FEET TO THE POINT OF BEGINNING, CONTAINING 208 SQ. FT., MORE OR LESS, SUBJECT TO ALL RIGHTS-OF-WAY AND EASEMENTS OF RECORD.

NOW THEREFORE BE IT RESOLVED BY THE CITY COUNCIL FOR THE CITY OF JONESBORO, ARKANSAS THAT:

Section 1: The Mayor and City Clerk are hereby authorized by the City Council for the City of Jonesboro, Arkansas to accept the easement described above.

Return recorded document to:
CITY OF JONESBORO
300 South Church Street
Jonesboro, AR 72401

The above space is reserved for Craighead County recording information

PERMANENT CONSTRUCTION EASEMENT

KNOW ALL MEN BY THESE PRESENTS:

That NETTLETON PHILLIPS SPECIAL SCHOOL DISTRICT, hereinafter referred to as Grantor (whether one or more), does hereby dedicate, grant and convey unto the Public, and that the **CITY OF JONESBORO**, a Municipal Corporation of the State of Arkansas, hereinafter referred to as Grantee, does hereby accept on behalf of the public, for use as a permanent construction easement across the following described real property in Craighead County, State of Arkansas, to-wit:

A PART OF LOT 42 OF COBB AND LEE SURVEY OF THE SOUTHEAST QUARTER OF THE NORTHWEST QUARTER OF SECTION 27, TOWNSHIP 14 NORTH, RANGE 04 EAST, JONESBORO, CRAIGHEAD COUNTY, ARKANSAS, (AS RECORDED IN BOOK 48, PAGE 114), BEING MORE PARTICULARLY DESCRIBED AS FOLLOWS:

BEGINNING AT THE SOUTHEAST CORNER OF LOT 42 OF COBB AND LEE SURVEY OF THE SOUTHEAST QUARTER OF THE NORTHWEST QUARTER OF SECTION 27, TOWNSHIP 14 NORTH, RANGE 04 EAST, JONESBORO, CRAIGHEAD COUNTY, ARKANSAS; THENCE SOUTH 88°44'37" WEST, ALONG THE SOUTH LINE OF SAID LOT 42, 1.30 FEET; THENCE NORTH 00°02'18" WEST, LEAVING SAID SOUTH LINE, 115.45 FEET; THENCE SOUTH 89°32'08" EAST, 2.31 FEET TO THE WESTERLY RIGHT-OF-WAY LINE OF THORN STREET; THENCE SOUTH 00°27'52" WEST, ALONG SAID WESTERLY RIGHT-OF-WAY LINE, 115.41 FEET TO THE POINT OF BEGINNING, CONTAINING 208 SQ. FT., MORE OR LESS, SUBJECT TO ALL RIGHTS-OF-WAY AND EASEMENTS OF RECORD.

This easement and right of way is for the purpose of constructing and maintaining a sidewalk. Any other use of this area, other than by record owners, shall only be granted by record owners, but they are not precluded from using or granting other use, so long as same does not interfere unreasonably with the express purpose intended.

This grant of easement and right of way shall be binding upon the heirs, successors, administrators and assigns of the grantors.

IN WITNESS WHEREOF, the grantors have executed this instrument on the ____ day of _____, 20__.

**Owner Info
BY:**

Signature: James Dunivan

Name: JAMES Dunivan

Title: Superintendent

ACKNOWLEDGMENT

STATE OF Arkansas

COUNTY OF Craighead

On this day before me, the undersigned officer, personally appeared James Dunivan, to me well known to be the person whose name is subscribed to the foregoing instrument, and acknowledged that he had executed the same for the purpose therein stated and set forth.

WITNESS my hand and seal this 18th day of July, 2017.

Notary Public (Signature): Judy Pierce

My Commission Expires: 12-12-23





Legislation Details (With Text)

File #: ORD-17:046 **Version:** 1 **Name:** Closing of a portion of Monroe Avenue
Type: Ordinance **Status:** In Committee
File created: 6/15/2017 **In control:** Public Works Council Committee
On agenda: **Final action:**
Title: AN ORDINANCE TO CLOSE A PORTION OF MONROE AVENUE AS REQUESTED BY THE ROTARY CLUB OF JONESBORO
Sponsors: Engineering
Indexes: Parking & Traffic
Code sections:
Attachments: [Conceptual Design Rotary Club FOA.pdf](#)
[Rotary Club.pdf](#)

Date	Ver.	Action By	Action	Result
7/6/2017	1	Public Works Council Committee		

AN ORDINANCE TO CLOSE A PORTION OF MONROE AVENUE AS REQUESTED BY THE ROTARY CLUB OF JONESBORO

WHEREAS, the Rotary Club of Jonesboro is in the planning and fundraising stages of an upgrade to the existing park at Monroe Avenue and Church Street to produce a multi-use park, enhancing downtown Jonesboro by providing a common area to host events and cultural programs.

WHEREAS, the Rotary Club of Jonesboro is requesting for planning, design, and site purposes, advanced agreement from the City of Jonesboro to permanently close a portion of Monroe Avenue to through traffic when physical work is ready to begin at a future date.

WHEREAS, the closure of a portion of Monroe Avenue in front of the Forum will allow the park to have an expanded presence to the front of the Forum plus be more useful and visually appealing in size and scope and will enhance the safety for the children attending events at the Forum.

BE IT ORDAINED by the City Council for the City of Jonesboro, Arkansas, that:

Section 1. The City of Jonesboro, Arkansas hereby agrees to allow the closure of Monroe Avenue from Church Street at a future determined date west to the north-south alleyway located east of 115 East Monroe Avenue except to emergency vehicles. Access for emergencies will be maintained with the use of removable bollards.

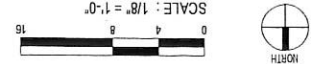
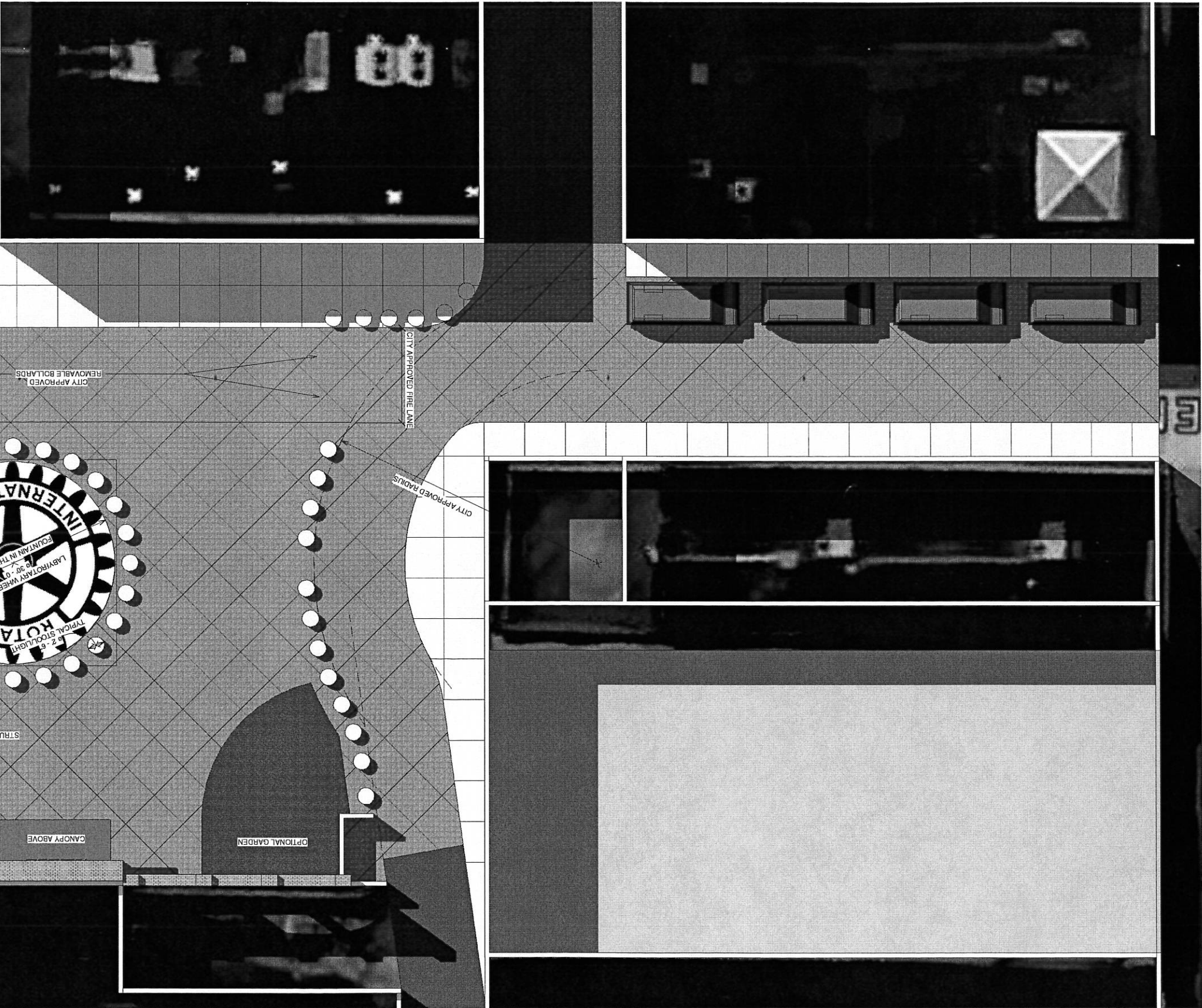

A-1	
Drawing Title	RENDERED SITE PLAN
Issue Date	06/23/2017
Project Number	2017-048

101 south spring street little rock, ar 72201
 501.372.2900
 cromwell.com

505 union street, 2nd flr jonesboro, ar 72401
 870.336.0536

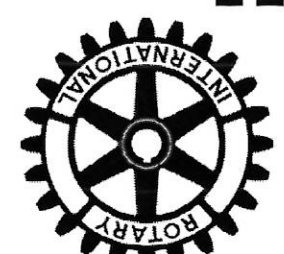

ROTARY CENTENNIAL PLAZA
 ROTARY CLUB OF JONESBORO
 JONESBORO, ARKANSAS

**NOT FOR
 CONSTRUCTION**

~ CONCEPTUAL DESIGN

No.	Date	Description

102' x 10 3/8"
 DROP OFF AREA

CANOPY
 STRUCTURE/
 ENDOR
 LOCATIONS

OPTIONAL
 GARDEN

CANOPY
 ABOVE

Rotary
Rotary Club of Jonesboro, AR
District 6150, Club 2520



June 9, 2017

Mayor Harold Perrin:

As you know, the Rotary Club of Jonesboro wishes to partner with the City of Jonesboro to upgrade the park at Monroe and Church. This project will be completed as a celebration of our club's 100 anniversary in 2019. As a part of our club's history, the Rotary Club of Jonesboro has supported many city improvements, most recently the Rotary Centennial Park at Craighead Forest. We now wish to assist in the revitalization of downtown by providing a much-needed amenity.

You and your staff have graciously worked with our club to create an appealing site plan that will significantly upgrade the existing space. The upgrades will produce a multi-use park, enhancing downtown Jonesboro by providing a common area to host events and cultural programs.

As part of the site plan, we are requesting that the city close a portion of Monroe Avenue. This will allow the park to have an expanded presence to the front of the Forum plus be more useful and visually appealing in size and scope. Importantly, emergency access will be maintained with the use of removable bollards. Access to the adjoining alley will remain open.

As we have discussed, this closure also provides an opportunity to improve the safety of the children frequenting the Forum. There is inadequate space in front of the Forum and crossing the street creates an unnecessary danger for children and other Forum patrons. The street closure will also improve safety by setting grades to accommodate and improve drainage in front of Forum and entire plaza area. A recessed drop off area is planned for Church Street. All improvements will enhance access and walkability.

It is my understanding that this request will be sent to the Traffic Control Committee. Representatives of the club can be available to present this plan. On behalf of the Rotary Club of Jonesboro, I am requesting the partial closure of Monroe Avenue as an essential component of this downtown improvement.

Please let me know if you have questions.

Sincerely,

Beverly Parker
IPP, Rotary Club of Jonesboro
Centennial Celebration Committee

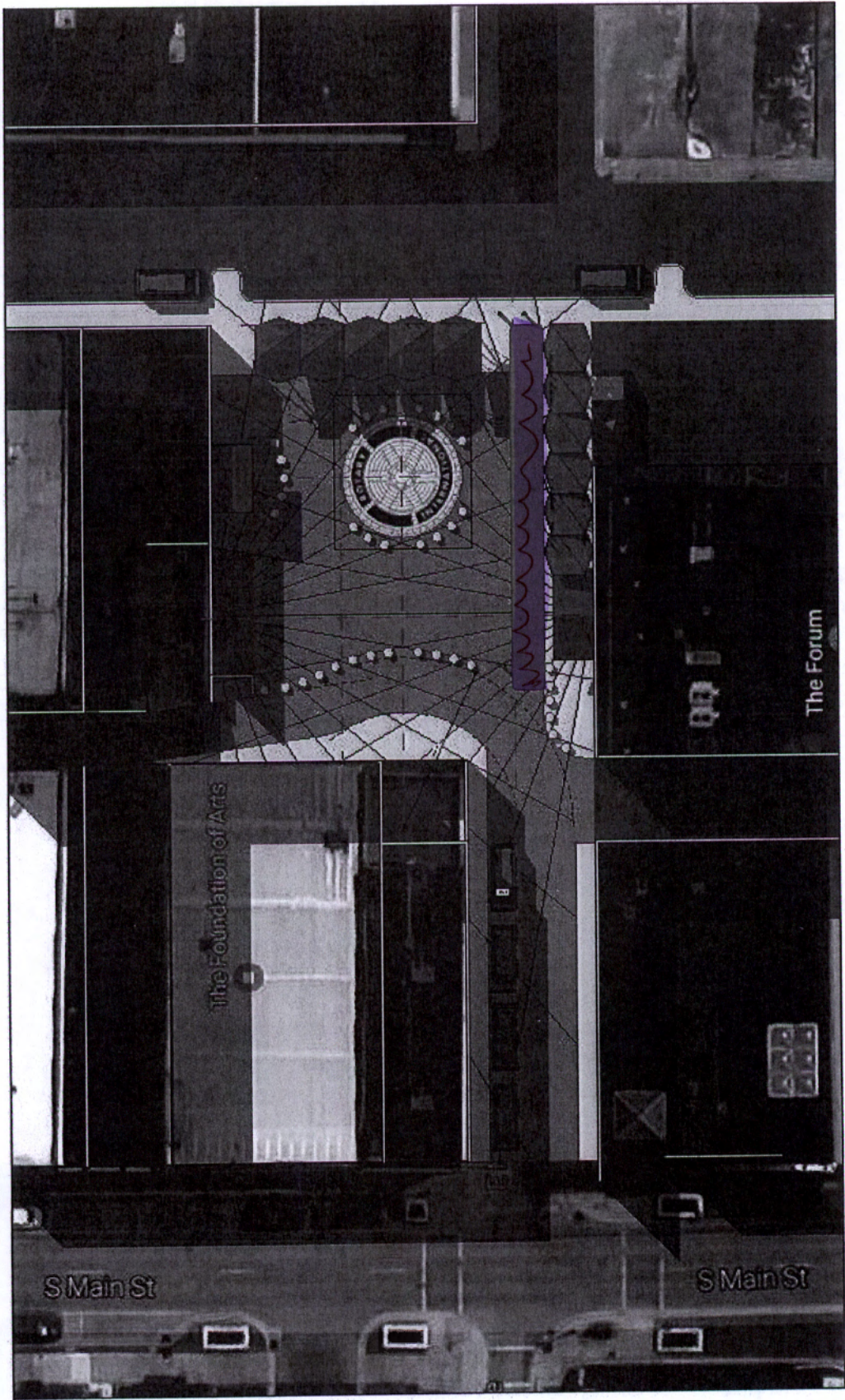

No.	Date	Revisions

CONCEPTUAL DESIGN

NOT FOR CONSTRUCTION

08/05/16

ROTARY CENTENNIAL PARK
 ROTARY CLUB OF JONESBORO
 JONESBORO, ARKANSAS



CROWELL

101 South Spring Street, Suite 1000, # 70201
 501-772-0300
 crowell.com
 Crowell, 2nd Fl Jonesboro, Ar 72401
 870.526.0320

Project Name: 2015-020
 Drawing Title: Unnamed
 Drawing Number: A101

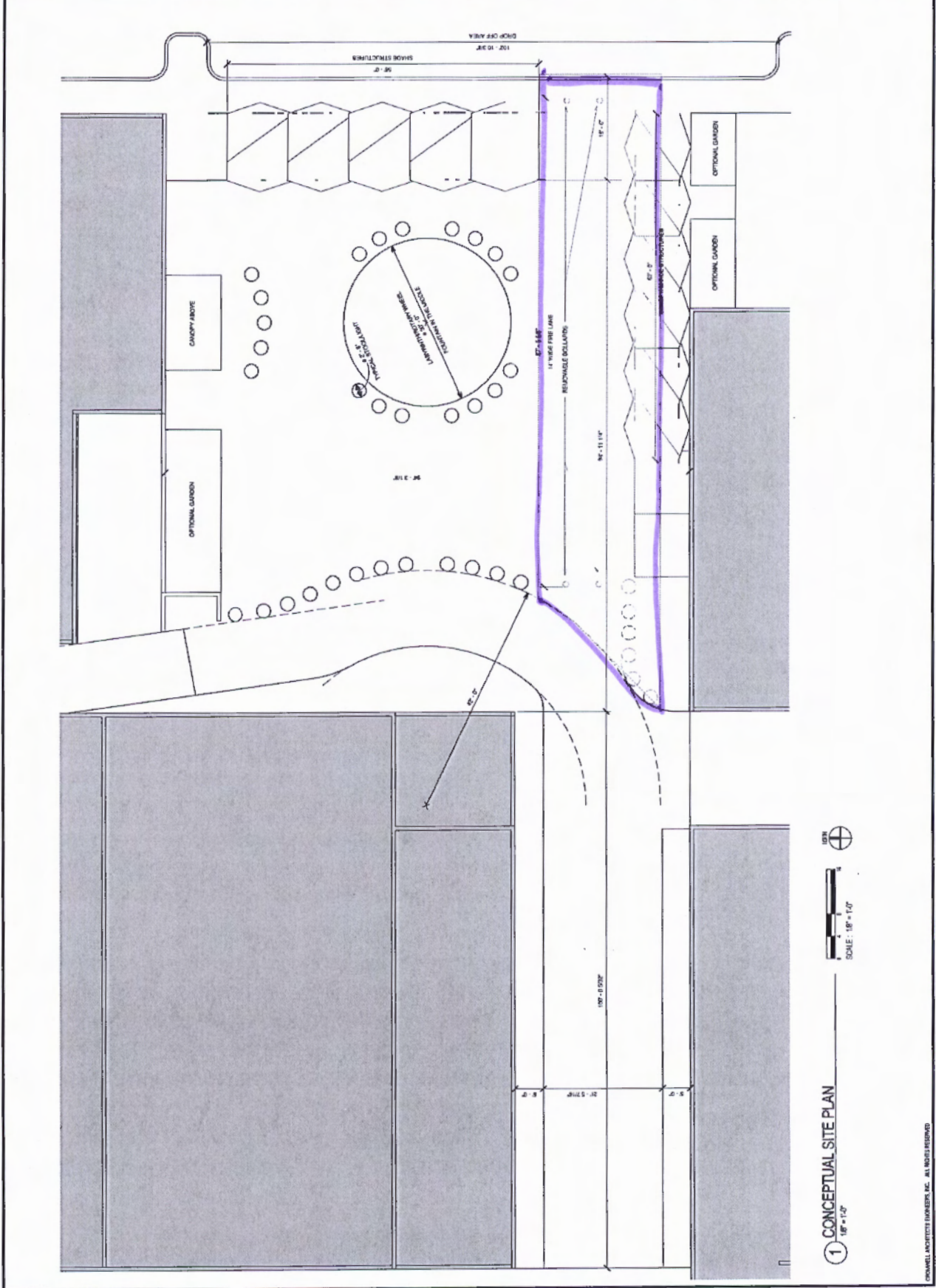

1 CONCEPTUAL SITE PLAN
 1/8" = 1'-0"

CROWELL ARCHITECTS ENGINEERS, INC. ALL RIGHTS RESERVED



The Foundation Of Arts

July 1st, 2017

Dear City Council and Mr. Mayor,

I believe the 30 staff members and teachers, hundreds of volunteers, and thousands of patrons who spend time working, playing, and enjoying the programming at The Foundation of Arts would be best served with the closing of Monroe Avenue from Church St. to the alley. As cast members cross Monroe Avenue to enter The Forum Theater to perform - and students and parents cross Monroe coming and going to class – there is a constant hazard as they dodge vehicles travelling down the street.

With Rotary's project for the Forum Park in its planning stages, there could be no better time than this renovation to include the street's closure in those plans.

The FOA looks forward to a time when citizens can enjoy an event in the park and also be able to enter the front doors of The Forum Theater safely without concern for passing vehicles.

Thank you for your consideration of this needed improvement to downtown, and we anticipate your decision.

Best Regards,

A handwritten signature in cursive script that reads 'Kristi Pulliam'.

Kristi Pulliam
Executive Director
The Foundation of Arts

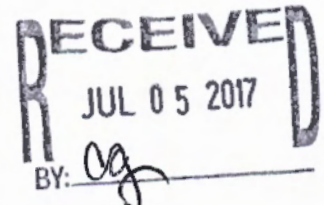

Traffic Control Review Committee Minutes

06/12/2017

Attendance:

Kelly Bagget
Steve Tippitt
Ed Tanner
Mark Nichols
Craig Light
Donnie Gibson
Wixson Huffstedler
Larry Jackson
Tracy Clayton
Mr. Brackett - Rotary
Robert Martin - Cromwell

Special called meeting: 2 items

1.) Request to close section of Monroe from the alley back to the east to Church Street with accomadation to emergency vehicles.

Mr. Brackett with the Rotary Club said the club will be celebrating their 100th year in 2019. They would like to do a project to commemorate this. They would like to close a section of Monroe from the alley to the east to Church Street. It would be a 700,000 – 750,000 dollar project. This area is a good central location and walking distance to most things down town. They would have a concrete pad for emergency vehicles. They are asking for participation from the city to close the street and from CWL to move the utilities that are currently overhead and dangerous to underground. The city will be making drainage improvements to the area as well. There would be a drop off zone for Forum activities. They want to do a mural on one side of the old Noble Hotel (Rotary Club had its first meeting there). There would be a stage area. There would also be vendor spaces with power for events such as Alive after Five, Downtown BBQ, Cinco De Mayo, etc. They would improve the lighting in the area with ballard lighting and by re-locating street lights. They would dim the alley way right in front of Foundation of Arts so that it is safer for people heading right out the front door and into the road. They would make sure the turn radius and ballards would make it possible for emergency vehicles to go through. He said the Rotary is fully committed to this project. They have already communicated with the neighbor on one side and have their cooperation and will communicate with the other neighbors since making this change could possibly affect them. Time line wise the project would begin in early 2018 and last about 18 months. In order for grants to be established in time, this would need to go to Council on July 6th and passed with only one reading and with an emergency clause.

There have not been traffic counts but Mark doesn't think closing the alley way would be a problem as far as traffic counts. The main problem would be that in order to do this, the alley would have to be made one way southbound. This could cause problems for the residences of the alley way and for delivery and garbage trucks. It would especially be a problem when the street is closed off once a month for Alive after Five. Hailey Knight was contacted by speaker phone to get her thoughts. She said she can make contact with the property owners and residences to see how they feel about the alley closure. She wasn't sure if Alive after Five could change their location during the construction period or not. She would have to check with some others on the committee.

The recommendation was made to proceed to Public Works to close the alley as long as there are accommodations made for emergency vehicles and as long as other property owners in the area are not opposed to it.

2.) Bicycle Signs – Bicycles May Use Full Lane

At the last meeting, the committee voted to install "Bicycle may use full lane" signs as requested by cyclists, Steve Eward and Bill Smith on Matthews and at Craighead Forest. Since that time, other cyclists have come forward to say they do not necessarily want the signs changed. Mark printed some research he did about what other cities do and some information from the League of American Cyclist.

There was a discussion as to whether it would put the cyclist in further danger by changing the signs. Eventually it would be better to divert cyclist to Washington instead of Matthews.

Recommendation was made to add language to Impeding Ordinance as what we expect of the cyclist as well as the motorist. They need to ride as far right as possible but can move left enough to make them feel safe. As far as the signs, it was decided to do a presentation to Public Safety recommending leaving the signs the way they are since there is no evidence that the signs make it safer for motorist and since there is evidence that the signs could actually make it more dangerous for cyclist.

Meeting adjourned at 12:07 p.m.