

VICINITY MAP
N.T.S.

TRACT "A"
0.30 ACRES
R-1 TO C-3

ASSUMED

C-3

CARAWAY RD
N00°00'00"E
180.00'

N89°18'00"E
330.00'

SUNNY MEADOW DRIVE

R-1

SW CORNER-NW1/4, NW1/4
SECTION 33, T-14-N, R-4-E
JONESBORO, CRAIGHEAD COUNTY, AR
P.O.B.

APPLICATION FOR REZONING:

WE BEING THE OWNER\AGENT OF THE FOLLOWING DESCRIBED PARCEL OF LAND DO
HEREBY REQUEST THE CITY OF JONESBORO, ARKANSAS TO REZONE SAME FROM
RESIDENTIAL-1 (R-1) TO COMMERCIAL-3 (C-3):

TRACT "A":

A PART OF THE NORTHWEST QUARTER OF THE NORTHWEST QUARTER OF SECTION 33, TOWNSHIP
14 NORTH, RANGE 4 EAST, JONESBORO, CRAIGHEAD COUNTY, ARKANSAS; BEING MORE
PARTICULARLY DESCRIBED AS FOLLOWS:

BEGINNING AT THE SOUTHWEST CORNER OF THE NORTHWEST QUARTER OF THE NORTHWEST
QUARTER OF SECTION 33, TOWNSHIP 14 NORTH, RANGE 4 EAST, JONESBORO, CRAIGHEAD
COUNTY, ARKANSAS; THENCE N00°00'00"E - 180.00'; THENCE N89°18'00"E - 330.00', TO
THE POINT OF BEGINNING PROPER; THENCE N00°00'00"E - 120.00'; THENCE N89°18'00"E
110.00'; THENCE S00°00'00"W - 120.00'; THENCE S89°18'00"W - 110.00', TO THE
POINT OF BEGINNING PROPER; CONTAINING 0.30 ACRES MORE OR LESS; SUBJECT TO ALL
RIGHTS OF WAY AND EASEMENTS OF RECORD.



SIGNED THIS _____ OF _____, 2001

BY: George M. De Roach TITLE: _____

BY: _____ TITLE: _____

BY: _____ TITLE: _____

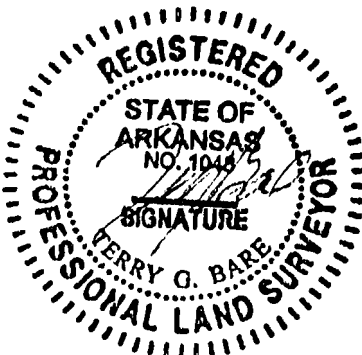

CLIENT
CURTIS SPENCE

REZONING APPLICATION

A PART OF THE NW 1/4 OF THE NW 1/4
SECTION 33, T-14-N, R-4-E
JONESBORO, CRAIGHEAD COUNTY, ARKANSAS

HAYWOOD, KENWARD, BARE & ASSOCIATES, INC.
CIVIL ENGINEERING - SURVEYING - PLANNING

3301 E. HIGHLAND DRIVE
JONESBORO, ARKANSAS 72401
TEL 870-932-2019 FAX 870-932-1078

REVISIONS

DATE	BY	DESCRIPTION
8/17/01	MD	R-Z APPL.
9/26/01	JB	ADD STRUCTURE

DRAWN BY
J.H.B.

SHEET
1 OF 1

DATE
8/17/01

SCALE
1" = 30'

JOB NO.
300523

DRAWING NO.
I-219