

LANDSCAPING

A. NEW CONSTRUCTION.

NEW WIRELESS FACILITIES ON NEW SUPPORT STRUCTURES SHALL HAVE A LANDSCAPED AREA A MINIMUM OF 10 FEET IN WIDTH AROUND THE OUTSIDE PERIMETER OF THE SECURITY FENCE AND SHALL BE PLANTED WITH THE FOLLOWING MATERIALS:

1. ONE ROW OF EVERGREEN TREES WITH A MINIMUM CALIPER OF 1.75 INCHES INSTALLED WITH MAXIMUM SPACING OF 25 FEET.
2. EVERGREEN SHRUBS CAPABLE OF CREATING A CONTINUOUS HEDGE AND OBTAINING A HEIGHT OF 8 FEET SHALL BE PLANTED WITH A MAXIMUM SPACING OF 5 FEET. PLANTS SHALL BE AT LEAST 3-GALLON CONTAINER PLANTS AND BE 36 INCHES TALL AT THE TIME OF PLANTING.
3. ALL PLANTS AND TREES SHALL BE INDIGENOUS TO THIS PART OF ARKANSAS AND SHALL BE DROUGHT RESISTANT.

FENCING

AN OPAQUE FENCE, INCLUDING SLATTED CHAIN LINK, NOT LESS THAN 8 FEET IN HEIGHT, SHALL ENCLOSE ALL WIRELESS FACILITIES. SECURITY FEATURES MAY BE INCORPORATED INTO THE BUFFER AND LANDSCAPING AREAS AROUND THE OUT-SIDE.

OVERALL SITE PLAN 1
SCALE: 1" = 10'-0"

NOTE:
ALL UTILITY SERVICE POINTS OF ENTRY SHALL BE VERIFIED WITH ACTUAL SHELTER MANUFACTURER DRAWINGS PRIOR TO INSTALLATION

7	
6	
5	
4	10/28/13 REVISED FOR PLANNING
3	10/14/13 FINAL CD ISSUED
2	10/9/13 PRELIM CD ISSUED
1	10/4/13 ENLARGED SITE PLAN

CENTRAL ARKANSAS SURVEYING INC.
11708 Kanis Road
Little Rock, AR 72211
Phone: (501)-223-0497
Fax: (501)-223-0496
E-Mail: rsa-cas@swbell.net

WESTOWER COMMUNICATIONS INC
4700 South Bowman Road, Suite 700
Little Rock, AR 72210
PH: (501) 221-6093
FAX: (501) 221-8629

METHODIST HOSPITAL
SITE ADDRESS
EAST PARKER ROAD
JONESBORO, AR 72404
CRAIGHEAD COUNTY
SITE NUMBER: AR1516

STATE OF ARKANSAS
REGISTERED PROFESSIONAL ENGINEER
JAMES H. WILBANKS
FORREST WILBANKS
10/28/13

THE INFORMATION CONTAINED IN THIS SET OF DOCUMENTS IS PROPRIETARY BY NATURE. ANY USE OR DISCLOSURE OTHER THAN THAT WHICH RELATES TO THE CLIENT IS STRICTLY PROHIBITED.

START DATE:	10/4/13
DRAWN BY:	LMR
CHECKED BY:	RSA
SHEET TITLE:	OVERALL SITE PLAN
DRAWING NO.	C-2
REVISION:	4

GENERAL NOTES

1. ALL STRUCTURAL STEEL SHALL BE HOT-DIPPED GALVANIZED AFTER FABRICATION.
2. ALL STRUCTURAL STEEL SHALL BE DESIGNED, FABRICATED, AND ERECTED IN ACCORDANCE WITH AISC SPECIFICATION (LATEST EDITION).
3. FACILITY IS UNMANNED AND NOT FOR HUMAN HABITATION (HANDICAPPED ACCESS NOT REQUIRED).
4. FACILITY WILL NOT BE LIGHTED WITH THE EXCEPTION OF EMERGENCY CONDITIONS.
5. FACILITY HAS NO PLUMBING.
6. TOWER AND ANTENNA INSTALLATION SHALL BE CONDUCTED BY FIELD CREWS EXPERIENCED IN THE ASSEMBLY AND ERECTION OF RADIO ANTENNAS, TRANSMISSION LINES, AND SUPPORT STRUCTURES.
7. CONTRACT COMPANIES AND THEIR EMPLOYEES SHALL OBSERVE AND PRACTICE ALL O.S.H.A. SAFETY GUIDELINES WHILE PERFORMING SERVICE FOR AT&T.
8. WHERE A TOWER DOES NOT HAVE A PERMANENT FALL PROTECTION SYSTEM, THE CONTRACT COMPANY IS RESPONSIBLE FOR PROVIDING A SUITABLE SYSTEM FOR ITS EMPLOYEES.
9. CONTRACTOR SHALL PERFORM A SAFETY INSPECTION PRIOR TO COMMENCING ALL WORK ACTIVITIES AT A AT&T LEASED OR OWNED SITE. AT&T SHOULD BE IMMEDIATELY NOTIFIED OF SAFETY HAZARD(S) FOUND DURING THE INSPECTION THAT COULD CAUSE BODILY HARM OR ENDANGERMENT TO LIFE OR THAT COULD CAUSE DAMAGE TO PROPERTY. ALL WORK SHALL BE HALTED UNTIL SUCH TIME THE REPORTED SAFETY HAZARD CORRECTED. THE SAFETY HAZARD, IF POSSIBLE, SHOULD BE CORRECTED BY THE CONTRACTOR WHILE ON SITE, AFTER THE CONTRACTOR HAS NOTIFIED AT&T OF THE HAZARD AND HAS RECEIVED APPROVAL FROM AT&T TO PERFORM THE CORRECTION.

LEGEND

- CM - CROWN MONITOR
- FP - FLASH POWER BOX
- FB - FLASH BOX
- M - METER
- B - BREAKER
- H - HOFFMAN BOX
- MD - MAIN DISCONNECT
- H - HOFFMAN BOX
- G - GENERATOR POWER

NOTE:
ALL UTILITY SERVICE POINTS OF ENTRY SHALL BE VERIFIED WITH ACTUAL SHELTER MANUFACTURER DRAWINGS PRIOR TO INSTALLATION

TOWER MANUFACTURER'S SPECS, FABRICATION, AND CONCRETE FOUNDATION DESIGN WILL BE PROVIDED BY TOWER VENDOR.
TOWER SHOWN ON THESE PLANS IS REPRESENTATIVE ONLY OF THE TOWER TYPE.

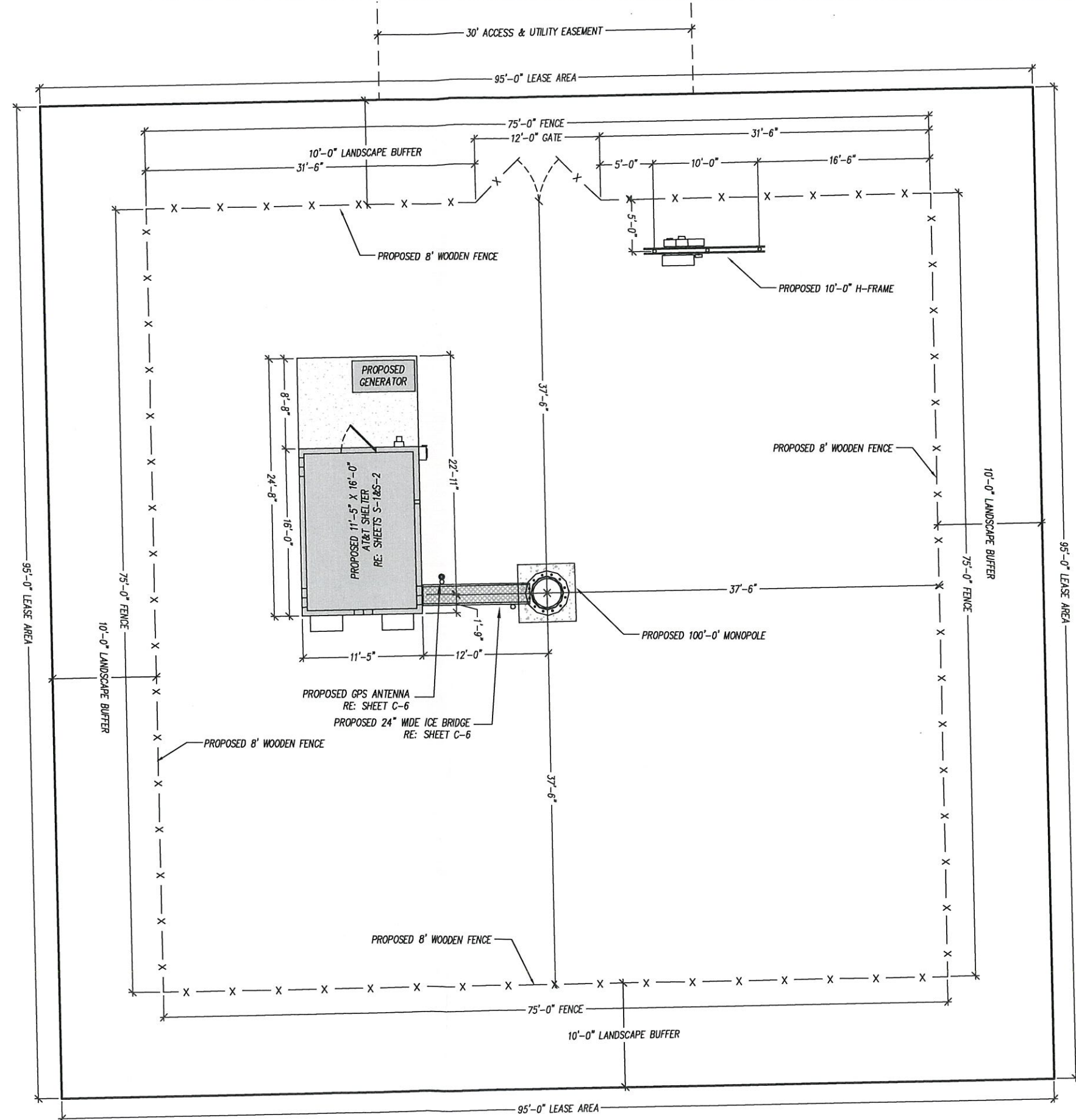

ENLARGED SITE PLAN
SCALE: 3/32" = 1'-0"

1



7	
6	
5	
4	10/28/13 REVISED FOR PLANNING
3	10/14/13 FINAL CD ISSUED
2	10/9/13 PRELIM CD ISSUED
1	10/4/13 ENLARGED SITE PLAN

CENTRAL ARKANSAS SURVEYING INC.
11708 Karlis Road
Little Rock, AR 72211
Phone: (501) 223-0497
Fax: (501) 223-0496
E-Mail: rsa-cas@swbell.net

WESTOWER COMMUNICATIONS INC
4700 South Bowman Road, Suite 700
Little Rock, AR 72210
PH: (501) 221-6093
FAX: (501) 221-8629

METHODIST HOSPITAL
SITE ADDRESS
EAST PARKER ROAD
JONESBORO, AR 72404
CRAIGHEAD COUNTY
SITE NUMBER: AR1516

STATE OF ARKANSAS
REGISTERED PROFESSIONAL ENGINEER
JAMES H. WILBANKS
10/28/13

THE INFORMATION CONTAINED IN THIS SET OF DOCUMENTS IS PROPRIETARY BY NATURE. ANY USE OR DISCLOSURE OTHER THAN THAT WHICH RELATES TO THE CLIENT IS STRICTLY PROHIBITED.

START DATE:	10/4/13
DRAWN BY:	LMR
CHECKED BY:	RSA
SHEET TITLE: ENLARGED SITE PLAN	
DRAWING NO. C-3	REVISION: 4